

PH 000 1554

**NATIONAL REGISTER OF HISTORIC PLACES
INVENTORY - NOMINATION FORM**

(Type all entries - complete applicable sections)

STATE: Delaware	
COUNTY: Sussex	
FOR NPS USE ONLY	
ENTRY NUMBER 71.3.10.0004	DATE 3/24/71

1. NAME

COMMON: Old Sussex County Court House

AND/OR HISTORIC:

2. LOCATION

STREET AND NUMBER:
South Bedford Street

CITY OR TOWN:
Georgetown

STATE Delaware	CODE 10	COUNTY: Sussex	CODE 005
-------------------	------------	-------------------	-------------

3. CLASSIFICATION

CATEGORY (Check One)	OWNERSHIP	STATUS	ACCESSIBLE TO THE PUBLIC
<input type="checkbox"/> District <input type="checkbox"/> Site <input type="checkbox"/> Object <input checked="" type="checkbox"/> Building <input type="checkbox"/> Structure	<input checked="" type="checkbox"/> Public <input type="checkbox"/> Private <input type="checkbox"/> Both	Public Acquisition: <input type="checkbox"/> In Process <input type="checkbox"/> Being Considered <input type="checkbox"/> Occupied <input checked="" type="checkbox"/> Unoccupied <input type="checkbox"/> Preservation work in progress	Yes: <input type="checkbox"/> Restricted <input type="checkbox"/> Unrestricted <input checked="" type="checkbox"/> No
PRESENT USE (Check One or More as Appropriate)			
<input type="checkbox"/> Agricultural <input type="checkbox"/> Commercial <input type="checkbox"/> Educational <input type="checkbox"/> Entertainment	<input type="checkbox"/> Government <input type="checkbox"/> Industrial <input type="checkbox"/> Military <input type="checkbox"/> Museum	<input type="checkbox"/> Park <input type="checkbox"/> Private Residence <input type="checkbox"/> Religious <input type="checkbox"/> Scientific	<input type="checkbox"/> Transportation <input type="checkbox"/> Other (Specify) _____ _____ _____
			<input type="checkbox"/> Comments Museum use plan- ed

4. OWNER OF PROPERTY

OWNER'S NAME:
State of Delaware - Public Archives Commission

STREET AND NUMBER:
Hall of Records

CITY OR TOWN:
Dover

STATE:
Delaware

CODE:
10

5. LOCATION OF LEGAL DESCRIPTION

COURTHOUSE, REGISTRY OF DEEDS, ETC.:
Sussex County Court House - Recorder of Deeds

STREET AND NUMBER:
The Circle

CITY OR TOWN:
Georgetown

STATE:
Delaware

CODE:
10

6. REPRESENTATION IN EXISTING SURVEYS

TITLE OF SURVEY:

DATE OF SURVEY: Federal State County Local

DEPOSITORY FOR SURVEY RECORDS:

STREET AND NUMBER:

CITY OR TOWN:

STATE:

CODE:

SEE INSTRUCTIONS

STATE:

COUNTY:

FOR NPS USE ONLY

ENTRY NUMBER
71.3.10.0004

DATE
3/24/71

7. DESCRIPTION

CONDITION	(Check One)				
	<input type="checkbox"/> Excellent	<input type="checkbox"/> Good	<input checked="" type="checkbox"/> Fair	<input type="checkbox"/> Deteriorated	<input type="checkbox"/> Ruins
	(Check One)		(Check One)		
	<input checked="" type="checkbox"/> Altered	<input type="checkbox"/> Unaltered	<input checked="" type="checkbox"/> Moved	<input type="checkbox"/> Original Site	

DESCRIBE THE PRESENT AND ORIGINAL (if known) PHYSICAL APPEARANCE

The Old Sussex County Court House is a two story and attic frame structure, of five bay width, sheathed in bold cypress shingles. It lacks the decorative detail usual for a public building erected in 1793, giving more the appearance of a roomy but simple private house of late Georgian style. Originally it stood on The Circle, from which it was moved in 1837 to its present location on South Bedford Street a few doors below The Circle. Subsequent use as a private dwelling and later as a printing office has greatly altered the interior. The exterior remains unchanged, although at the time of public reacquisition it had long been poorly maintained. Full restoration is planned.

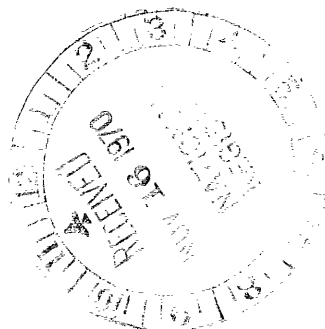

SEE INSTRUCTIONS

6 SIGNIFICANCE

PERIOD (Check One or More as Appropriate)

<input type="checkbox"/> Pre-Columbian	<input type="checkbox"/> 16th Century	<input checked="" type="checkbox"/> 18th Century	<input type="checkbox"/> 20th Century
<input type="checkbox"/> 15th Century	<input checked="" type="checkbox"/> 17th Century	<input checked="" type="checkbox"/> 19th Century	

SPECIFIC DATE(S) (If Applicable and Known) 1793

AREAS OF SIGNIFICANCE (Check One or More as Appropriate)

<input type="checkbox"/> Aboriginal	<input type="checkbox"/> Education	<input checked="" type="checkbox"/> Political	<input type="checkbox"/> Urban Planning
<input type="checkbox"/> Prehistoric	<input type="checkbox"/> Engineering	<input type="checkbox"/> Religion/Philosophy	<input type="checkbox"/> Other (Specify)
<input checked="" type="checkbox"/> Historic	<input type="checkbox"/> Industry	<input type="checkbox"/> Science	_____
<input type="checkbox"/> Agriculture	<input type="checkbox"/> Invention	<input type="checkbox"/> Sculpture	_____
<input type="checkbox"/> Architecture	<input type="checkbox"/> Landscape Architecture	<input type="checkbox"/> Social/Humanitarian	_____
<input type="checkbox"/> Art	<input type="checkbox"/> Literature	<input type="checkbox"/> Theater	_____
<input type="checkbox"/> Commerce	<input type="checkbox"/> Military	<input type="checkbox"/> Transportation	_____
<input type="checkbox"/> Communications	<input type="checkbox"/> Music		
<input type="checkbox"/> Conservation			

SEE INSTRUCTIONS

STATEMENT OF SIGNIFICANCE County

The Old Sussex Court House, completed in 1793, is, like its counterparts in New Castle and Kent Counties, a monument in the history of Delaware as well as of its immediate region. After increasingly bitter friction between the northeastern and southwestern sections of Sussex County over the location of its seat, the General Assembly in 1791 authorized the purchase of a centrally situated parcel of open farmland for the erection of a new, generally accessible court house. The necessary funds were advanced by private citizens who were later reimbursed by the proceeds of a lottery. The simple building became the focal point of the public square of the new community, soon called Georgetown, planned for the accommodation of the courts. It served the county until 1837. It was then sold and moved to make way for a larger brick Court House designed by William Strickland for its site. The latter, recently renovated, is still in use.

The older building is associated with all the cases and public figures, some of them notable, which were before the courts of Sussex County for forty-four years. More importantly, it is a rare physical symbol of a complex situation reaching far beyond its specific date and place. The tensions which forced the creation of this court house and the town to service it grew directly from the century-long conflict of the Lords Baltimore with James Duke of York and his successor the Penn family over their respective Provincial boundaries. The same frictions were involved in the election of the Assemblymen and Ratifying Convention delegates who considered the Federal constitution. They helped shape the travel routes, trading habits, political preferences and sectional loyalties of Sussex Countians and other residents of Delmarva from the early colonial settlers to the living generation. The Old Sussex County Court House is a unique vehicle for interpreting this complicated and significant segment of regional history.

9. MAJOR BIBLIOGRAPHICAL REFERENCES

Historic Houses And Buildings Of Delaware, by Harold Donaldson Eberlein and Courtlandt V.D. Hubbard, Dover, Delaware, 1962, pp. 35-36
History Of Delaware, by J. Thomas Scharf, Philadelphia, 1888, pp. 1207-1208
Delaware A Guide To The First State, by Jeannette Eckman and others, New York, 1955, pp. 381-382

10. GEOGRAPHICAL DATA

LATITUDE AND LONGITUDE COORDINATES DEFINING A RECTANGLE LOCATING THE PROPERTY			O R	LATITUDE AND LONGITUDE COORDINATES DEFINING THE CENTER POINT OF A PROPERTY OF LESS THAN TEN ACRES		
CORNER	LATITUDE	LONGITUDE		LATITUDE	LONGITUDE	
	Degrees Minutes Seconds	Degrees Minutes Seconds		Degrees Minutes Seconds	Degrees Minutes Seconds	
NW	0 ' "	0 ' "		38° 41' 21"	75° 23' 11"	
NE	0 ' "	0 ' "				
SE	0 ' "	0 ' "				
SW	0 ' "	0 ' "				

APPROXIMATE ACREAGE OF NOMINATED PROPERTY: .5

LIST ALL STATES AND COUNTIES FOR PROPERTIES OVERLAPPING STATE OR COUNTY BOUNDARIES

STATE:	CODE	COUNTY	CODE

11. FORM PREPARED BY

NAME AND TITLE:
 Leon deValinger, Jr., State Archivist

ORGANIZATION: Public Archives Commission

DATE: Jan. 27, 1970

STREET AND NUMBER:
 Hall of Records

CITY OR TOWN: Dover

STATE: Delaware

CODE: 10

12. STATE LIAISON OFFICER CERTIFICATION

As the designated State Liaison Officer for the National Historic Preservation Act of 1966 (Public Law 89-665), I hereby nominate this property for inclusion in the National Register and certify that it has been evaluated according to the criteria and procedures set forth by the National Park Service. The recommended level of significance of this nomination is:

National State Local

Name: Leon deValinger, Jr.
 Title: State Archivist
 State Liaison Officer

Date: November 13, 1970

NATIONAL REGISTER VERIFICATION

I hereby certify that this property is included in the National Register.

Ernest A. Connelley
 Chief, Office of Archeology and Historic Preservation

MAR 24 1971

Date: _____

ATTEST:

William J. Bourke
 Keeper of The National Register

Date: FEB 22 1971

SEE INSTRUCTIONS

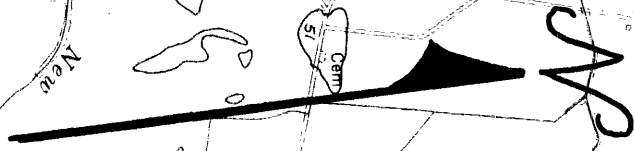
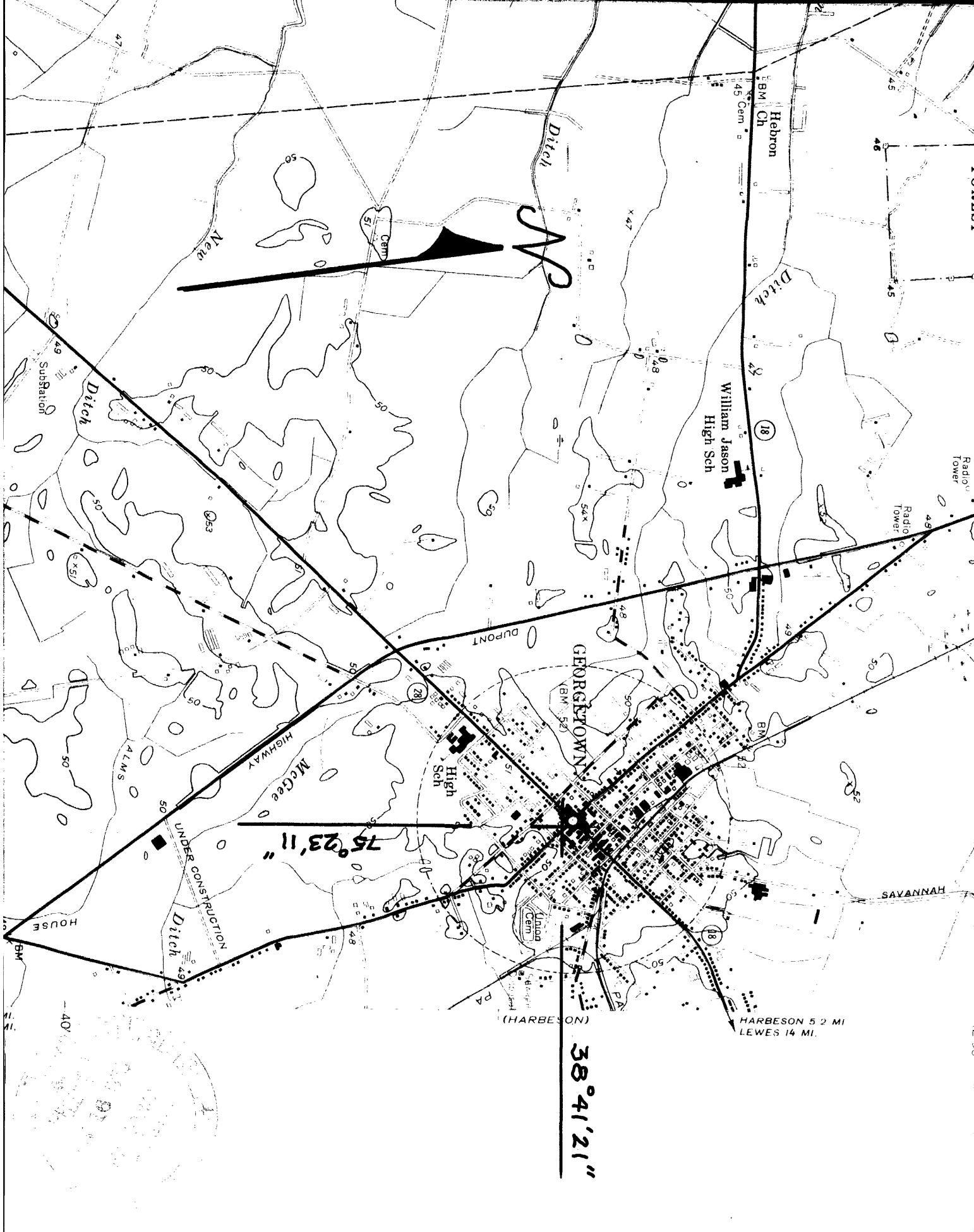

75°23'11"

38°41'21"

GEORGETOWN

William Jason High Sch

High Sch

Hebron

New

McGee

HIGHWAY

DUPONT

NBM 520

18

28

SAVANNAH

(HARBESON)

HARBESON 5.2 MI
LEWES 14 MI.

HOUSE

Union Cem

40'

Radio Tower

Radio Tower

BM Ch

45 Cem

Cem

Substation

ALMS

UNDER CONSTRUCTION

Ditch

Ditch

Ditch

Ditch

47

50

46

45

X 47

48

49

49

50

50

50

50

50

50

50

50

50

50

50

40'

40'

40'