

City, Village or Town: <input checked="" type="checkbox"/> <b>Waukesha</b>		County: <input checked="" type="checkbox"/> <b>Waukesha</b>	Surveyor: <b>HNTB</b>	Date: <b>2/10/82</b>	East Main St. 111
Street Address: <b>111 East Main Street</b>		Legal Description: <b>see Addendum</b>		Acreeage: <b>APPROX. 3.4 acres</b>	
Current Name & Use: <b>St. Matthias Episcopal</b>		Current Owner: <b>St. Matthias Episcopal Church</b>			
Film Roll No. <b>WK 5</b>					
Negative No. <b>19</b>					
Facade Orient. <b>H</b>					
Current Owner's Address: <b>111 East Main Street, Waukesha</b>		Special Features Not Visible In Photographs: UTM: Zone 16 Easting: 400040 Northing: 4762740 USGS Waukesha Quadrangle/Scale: 1:24,000 Interior visited? <input checked="" type="checkbox"/> Yes <input type="checkbox"/> No			

Town Range Section	Original Name & Use: (preferred) <input checked="" type="checkbox"/> <b>St. Matthias Episcopal Church</b>	Source <b>A</b>	Previous Owners	Dates	Uses	Source
	Dates of Construction/Alteration <b>1851 / 1887</b>	Source <b>A/B</b>				
	Architect and/or Builder: <b>1887 Chapel - Eales &amp; Dresden</b>	Source <b>B</b>				

**3** Architectural Significance

Represents work of a master  
 Possesses high artistic values  
 Represents a type, period, or method of construction  
 Is a visual landmark in the area  
 Other: \_\_\_\_\_  None

**4** Historical Significance

Assoc. with lives of significant persons  
 Assoc. with significant historical events  
 Assoc. with development of a locality  
 Other: \_\_\_\_\_  
 None

Architectural Statement: Construction of St. Matthias Episcopal Church was begun in 1851 and completed four years later. The church is a Gothic Revival design, and remains as the best example of this style in Waukesha. The church was constructed of the local limestone, dressed as small blocks and randomly coursed. Simple buttresses divide the nave into four bays, each containing a pointed arch window. Similar arches surround entrances as well as louvered openings on the steeple. The main entrances are contained in the base of the steeple.

Historical Statement: The first Episcopal services in the community were conducted in 1839 or 1840 by the Rev. Lemuel B. Hull who walked out from Milwaukee. In 1843 local Episcopalians erected their first small chapel on Barstow St. north of South Street; however, a formal parish was not organized until April 1844. In October 1848 the Rev. James Abercrombie became the rector in Waukesha. He led the effort to construct a new stone church for the parish.

**5** Sources of Information (Reference to Above)

**A** Lacher, J.H.A., "Pioneer Clergymen Had to Contend With Hardships, Freeman County Centennial pp 26-28, 1934

**6** Representation in Previous Surveys

HABS  NAER  WIHP  NRHP  landmark  
 other: \_\_\_\_\_

**B** Waukesha Freeman Vol XXIX No. 11 March 17, 1887, p.1

**7** Condition

excellent  good  fair  poor  ruins

**C** Cornerstone

**8** District: \_\_\_\_\_

pivotal  contributing  non-contributing  
 initials: \_\_\_\_\_ date: \_\_\_\_\_

**D**

**E**

**9** Opinion of National Register Eligibility

eligible  not eligible  unknown  
 national  state  local initials: **DB/KC**

**F**

which is placed on the northwest corner of the structure. The steeple rises three stories to a band of corbelling which marks the transition to the spire.

A small chapel was appended to the church in 1887. Twentieth century additions include a lannon stone entrance block and parish house (1951) which do not contribute to the significance of the nominated property. (c) The interior of the church retains original woodwork, including the wood ceiling and hammer beam trusses.

Eales and Dresden were listed as the builders for the St. Matthias chapel in a newspaper account from 1887. (B) No additional information about Eales and Dresden is available.

Historical Statement( continued):

Although over \$1,000 was subscribed by 1851, Abercrombie had to return to the east to get another \$4,000 to complete the building. The corner stone was laid in 1851, the church opened in 1853, and dedicated in 1855. With the exception of the Samuel H. Barstow Chapel, the building has remained largely intact since construction. (A)

Architectural Significance:

St. Matthias Episcopal Church provides a fine example of Gothic Revival design within Waukesha and is distinguished by the fine stone work of the exterior. This is the earliest church building remaining in Waukesha and is a significant example of Gothic Revival design.

Addendum: Legal description

Lots 57, 58, 59, and  
SW12' of NW70';

Lot 60 exc NE38' of NW94' &  
Daniel Wells Jr. Plat Pt NW1/4 Sec 2  
T6NR19E V29Deeds P94, V77P40, V292P608, V673 P119 & V1227 P104 Exc V857  
P342.

# ST. MATTHIAS EPISCOPAL CHURCH

--- Nominated Property



Scale: 1" = 50'

E. MAIN ST.

PLEASANT ST.

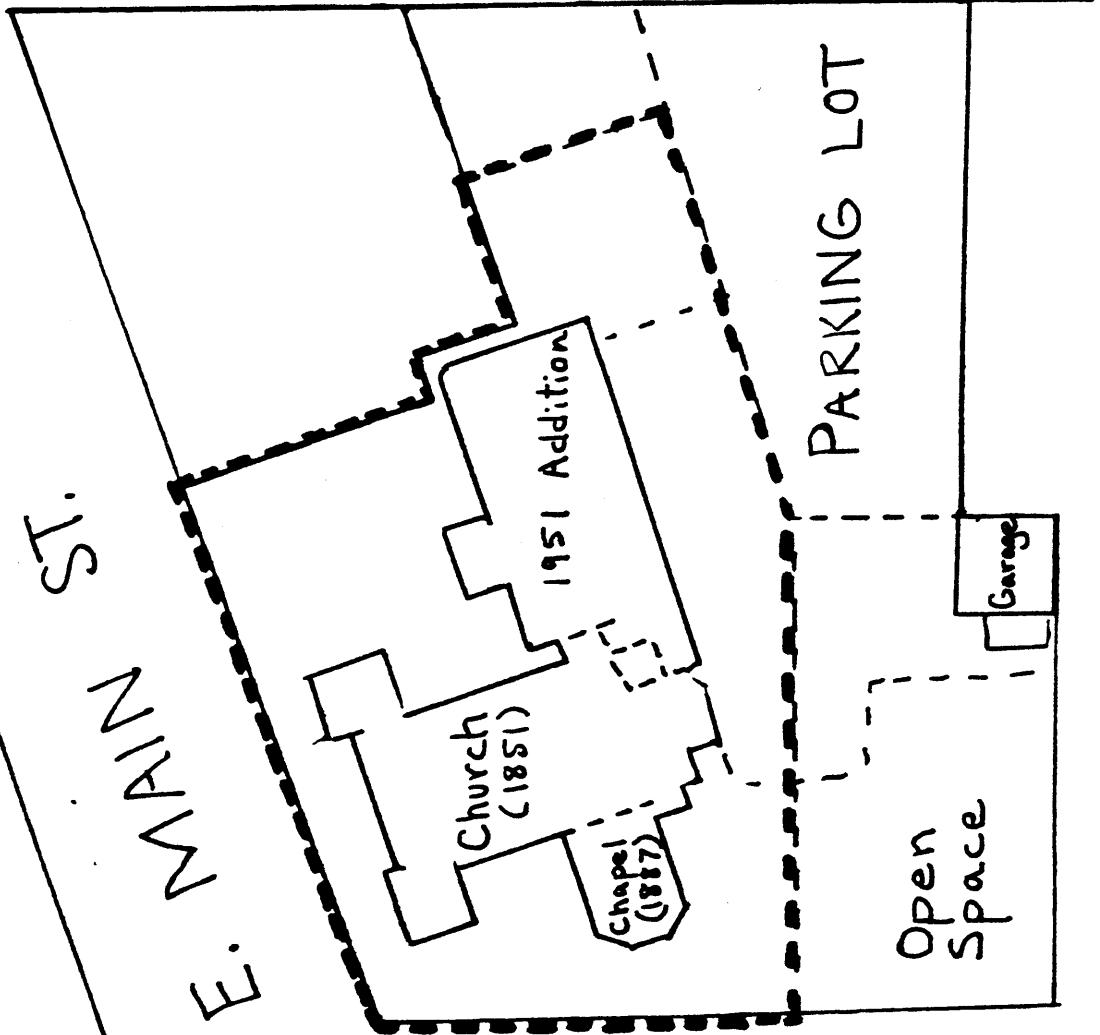

N. EAST AV.