

KENTUCKY HISTORIC RESOURCES INVENTORY

79003534

Wa-116

1. Historic Name (s) Merritt - Hardin House *

Original Owner William W. Merritt, Sr. *

Present Name

3. Owner's Name Wm. H. Fletcher

4. Owner's Address 1129. College St., Richpond

5. Location E. side Rt. 31 W; 1 1/2 m. S. of Rt. 242

6. Open to Public Yes No

7. Visible from road Yes No

8. Ownership Private Local State Federal

9. Local Contact/Organization

22. ADD/County BARTON/WA

23. Zoning Classification Magisterial District

24. U.S.G. S. Quadrant (15'/75') Woodburn

25. UTM Reference 116 542000 4080820

26. Prehistoric Site Historic Site Object Structure Building

27. District Yes No

28. Significance Evaluation NR

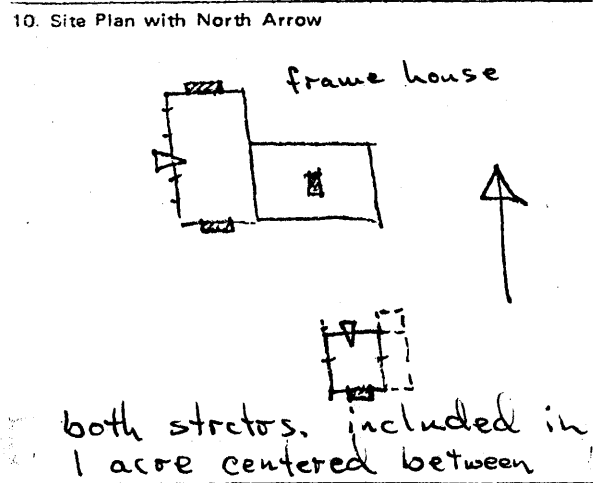

11. Architect

12. Builder

13. Date log - 1st 1/4 19th c. frame - mid-19th c.

14. Style Greek/Fed.

15. Original Use dwellings

16. Present Use dwellings

17. Condition Interior Exterior good

29. Status National Landmark National Register Landmark Certificate Kentucky Survey Local Landmark HABS/HAER

30. Theme architecture - log structures

31. Endangered Yes No

18. Description 2 story - 5 bay frame - two partially exterior end chimneys - (1) square single pen log outbuilding - originally house - brick end chimney - south end - central door north side - central door west side - two windows east - transitional moldings interior - simplified federal style mantels - chimney probably rebuilt

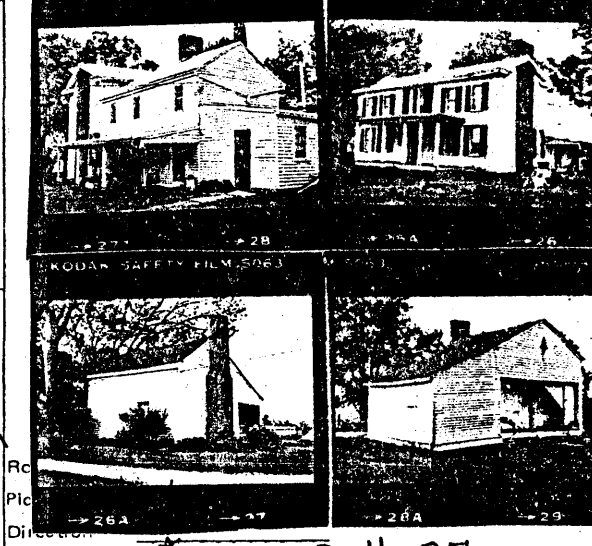

19. History William W. Merritt Sr. purchased this house for his bride in 1844. She was Mary Virginia Kelley of the Kelley-Meybr homestead. - one of their daughters married William Thomas Hardin and J. M. Hardin. This homestead has remained in the family for 130 yrs.

33. Tape No. KTG-JCH Negative No.

34. Prepared by: KTG-JCH

35. Organization KHC

36. Date Spring 1978

37. Revision Dates

38. Staff Review

20. Significance particularly clear illustration of common type and style; structure that embodies an early manner of building

21. Source of Information * Sumpter, An Album of Early Warren County handmarks

Architecture:

116. The two houses on this site represent in well preserved form two of the most popular building types in Warren County domestic architecture: the square, single pen log house and the frame Greek Revival I-house. The square, single pen log house dominated the landscape in the first third of the century and the frame Greek Revival I-house in the second third. The straight-sided chimneys of the frame house were a popular local alternative to shouldered chimneys in the mid-nineteenth century.

