

United States Department of the Interior
National Park Service

National Register of Historic Places
Registration Form

This form is for use in nominating or requesting determinations for individual properties and districts. See instructions in *How to Complete the National Register of Historic Places Registration Form* (National Register Bulletin 16A). Complete each item by marking "x" in the appropriate box or by entering the information requested. If an item does not apply to the property being documented, enter "N/A" for "not applicable." For functions, architectural classification, materials, and areas of significance, enter only categories and subcategories from the instructions. Place additional entries and narrative items on continuation sheets (NPS Form 10-900a). Use a typewriter, word processor, or computer, to complete all items.

1. Name of Property

historic name Tabernacle Methodist Church

other names/site number _____

2. Location

street & number Dentville Road, 4.6 miles North of State Road 28 N/A not for publication

city or town Hazlehurst vicinity

state Mississippi code MS county Copiah code 29 zip code 39083

3. State/Federal Agency Certification

As the designated authority under the National Historic Preservation Act, as amended, I hereby certify that this nomination request for determination of eligibility meets the documentation standards for registering properties in the National Register of Historic Places and meets the procedural and professional requirements set forth in 36 CFR Part 60. In my opinion, the property meets does not meet the National Register criteria. I recommend that this property be considered significant nationally statewide locally. (See continuation sheet for additional comments.)

Kenneth H. P. Pool May 21, 1996
Signature of certifying official/Title Date

Deputy State Historic Preservation Officer
State of Federal agency and bureau

In my opinion, the property meets does not meet the National Register criteria. (See continuation sheet for additional comments.)

Signature of certifying official/Title Date

State or Federal agency and bureau

4. National Park Service Certification

I hereby certify that the property is:

- entered in the National Register. See continuation sheet.
- determined eligible for the National Register See continuation sheet.
- determined not eligible for the National Register.
- removed from the National Register.
- other, (explain:)

Edson H. Beal
Signature of the Keeper

Date of Action
6-28-96

Entered in the
National Register

Tabernacle Methodist Church
Name of Property

Copiah County, Mississippi
County and State

5. Classification

Ownership of Property
(Check as many boxes as apply)

- private
- public-local
- public-State
- public-Federal

Category of Property
(Check only one box)

- building(s)
- district
- site
- structure
- object

Number of Resources within Property
(Do not include previously listed resources in the count.)

| Contributing | Noncontributing | |
|--------------|-----------------|------------|
| <u>1</u> | | buildings |
| | <u>1</u> | sites |
| | | structures |
| | | objects |
| <u>1</u> | <u>1</u> | Total |

Name of related multiple property listing
(Enter "N/A" if property is not part of a multiple property listing.)

Historic and Architectural Resources of
Copiah County, Mississippi

Number of contributing resources previously listed in the National Register

0

6. Function or Use

Historic Functions
(Enter categories from instructions)

Religion: religious facility

Current Functions
(Enter categories from instructions)

Religion: religious facility

7. Description

Architectural Classification
(Enter categories from instructions)

Mid-19th Century

Materials
(Enter categories from instructions)

foundation sandstone
walls weatherboard

roof metal
other _____

Narrative Description

(Describe the historic and current condition of the property on one or more continuation sheets.)

8. Statement of Significance

Applicable National Register Criteria

(Mark "x" in one or more boxes for the criteria qualifying the property for National Register listing.)

- A** Property is associated with events that have made a significant contribution to the broad patterns of our history.
- B** Property is associated with the lives of persons significant in our past.
- C** Property embodies the distinctive characteristics of a type, period, or method of construction or represents the work of a master, or possesses high artistic values, or represents a significant and distinguishable entity whose components lack individual distinction.
- D** Property has yielded, or is likely to yield, information important in prehistory or history.

Criteria Considerations

(Mark "x" in all the boxes that apply.)

Property is:

- A** owned by a religious institution or used for religious purposes.
- B** removed from its original location.
- C** a birthplace or grave.
- D** a cemetery.
- E** a reconstructed building, object, or structure.
- F** a commemorative property.
- G** less than 50 years of age or achieved significance within the past 50 years.

Areas of Significance

(Enter categories from instructions)

Architecture

Period of Significance

1857

Significant Dates

1857

Significant Person

(Complete if Criterion B is marked above)

N/A

Cultural Affiliation

N/A

Architect/Builder

Unknown

Narrative Statement of Significance

(Explain the significance of the property on one or more continuation sheets.)

9. Major Bibliographical References

Bibliography

(Cite the books, articles, and other sources used in preparing this form on one or more continuation sheets.)

Previous documentation on file (NPS):

- preliminary determination of individual listing (36 CFR 67) has been requested
- previously listed in the National Register
- previously determined eligible by the National Register
- designated a National Historic Landmark
- recorded by Historic American Buildings Survey # _____
- recorded by Historic American Engineering Record # _____

Primary location of additional data:

- State Historic Preservation Office
- Other State agency
- Federal agency
- Local government
- University
- Other

Name of repository:

Tabernacle Methodist Church
Name of Property

Copiah County, Mississippi
County and State

10. Geographical Data

Acreage of Property 1.9 acres

UTM References

(Place additional UTM references on a continuation sheet.)

1

| | |
|---|---|
| 1 | 5 |
|---|---|

| | | | | | |
|---|---|---|---|---|---|
| 7 | 3 | 9 | 1 | 2 | 0 |
|---|---|---|---|---|---|

| | | | | | | |
|---|---|---|---|---|---|---|
| 3 | 5 | 3 | 3 | 1 | 1 | 0 |
|---|---|---|---|---|---|---|

3

| | |
|--|--|
| | |
|--|--|

| | | | | | | | | | |
|--|--|--|--|--|--|--|--|--|--|
| | | | | | | | | | |
|--|--|--|--|--|--|--|--|--|--|

| | | | | | | | | | |
|--|--|--|--|--|--|--|--|--|--|
| | | | | | | | | | |
|--|--|--|--|--|--|--|--|--|--|

See continuation sheet

Verbal Boundary Description

(Describe the boundaries of the property on a continuation sheet.)

Boundary Justification

(Explain why the boundaries were selected on a continuation sheet.)

11. Form Prepared By

name/title Brenda R. Crook/Architectural Historian

organization Mississippi Dept. of Archives & History date March 12, 1996

street & number P.O. Box 571 telephone (601) 359-6940

city or town Jackson state MS zip code 39205-0571

Additional Documentation

Submit the following items with the completed form:

Continuation Sheets

Maps

A **USGS map** (7.5 or 15 minute series) indicating the property's location.

A **Sketch map** for historic districts and properties having large acreage or numerous resources.

Photographs

Representative **black and white photographs** of the property.

Additional items

(Check with the SHPO or FPO for any additional items)

Property Owner

(Complete this item at the request of SHPO or FPO.)

name Mississippi Conference of the United Methodist Church

street & number P.O. Box 931 telephone (601) 833-1619

city or town Jackson state MS zip code 39205

Paperwork Reduction Act Statement: This information is being collected for applications to the National Register of Historic Places to nominate properties for listing or determine eligibility for listing, to list properties, and to amend existing listings. Response to this request is required to obtain a benefit in accordance with the National Historic Preservation Act, as amended (16 U.S.C. 470 et seq.).

Estimated Burden Statement: Public reporting burden for this form is estimated to average 18.1 hours per response including time for reviewing instructions, gathering and maintaining data, and completing and reviewing the form. Direct comments regarding this burden estimate or any aspect of this form to the Chief, Administrative Services Division, National Park Service, P.O. Box 37127, Washington, DC 20013-7127; and the Office of Management and Budget, Paperwork Reductions Projects (1024-0018), Washington, DC 20503.

United States Department of the Interior
National Park ServiceNational Register of Historic Places
Continuation SheetTabernacle Methodist Church
Copiah County, MississippiSection number 7 Page 1

7. DESCRIPTION

Located approximately six and one-half miles northwest of downtown Hazlehurst on the old Raymond-Gallatin stagecoach road now known as the Dentville Road, the Tabernacle Methodist Church is a vernacular, frame, gable-front church building constructed in 1857. The church is situated in a clearing of a heavily wooded area and faces south onto the Dentville Road. Directly behind the church is a small cemetery, which contains mostly twentieth century gravestones enclosed by a low cyclone fence.

Resting on sandstone block foundation piers, the church is a two-by-four bay structure crowned by a standing seam metal roof trimmed with a box cornice with incomplete returns. The main (south) facade has two bays, each containing double-leaf, six-panel doors topped by a wide, eight-light transom. A metal awning is above the eastern door. Both side elevations feature four nine-over-nine, double-hung windows. The rear elevation has a central, nine-over-nine, double-hung window protected by four-panel shutters that appear to be original, and on the eastern end of the elevation is a single-leaf, six-panel door with three-light transom. All openings are trimmed with plain narrow surrounds, and although there is evidence that all window openings were at one time protected by shutters, only those on the rear window remain in place.

The one-room interior of the church retains its original pews placed to either side of a central aisle, altar, and curved altar rail with plain newel posts and turned balusters. The altar is situated on a dais and has ornate carved detailing (see Photo Nos. 2 & 3). Apparently around the turn of the century the ceiling and walls were clad in beaded board, and about 25 years ago new hardwood floors were installed. Although the building does not retain its original wall and ceiling finishes, the present finishes were installed about one hundred years ago and do not detract from the character of the building. Overall, the church retains a high degree of architectural integrity.

The cemetery is counted as a noncontributing site because most of the gravestones appear to date from the twentieth century.

United States Department of the Interior
National Park Service

National Register of Historic Places Continuation Sheet

Tabernacle Methodist Church
Copiah County, Mississippi

Section number 8 Page 2

8. STATEMENT OF SIGNIFICANCE

Built in 1857, the Tabernacle Methodist Church is locally significant for its architectural character (Criterion C), being a good example of a vernacular, antebellum, wooden, gable-front church building with two entrances in the gable end. It is one of only two antebellum churches known at this time to survive in Copiah County, the other being the Pleasant Valley Methodist Church (circa 1840), located about 14 miles southwest of Hazlehurst.

The Registration Requirements for Religious Resources are discussed on pages 67-69 of the MPS cover document entitled "Historic and Architectural Resources of Copiah County, Mississippi." (The associated historic context developed in the MPS cover document and represented by this property is "The Plantation Era in Copiah County, 1823-1865.") The Tabernacle Methodist Church was evaluated using the Mississippi Department of Archives and History's guidelines for assessing vernacular churches and was found to be eligible because it is a rare surviving example of an antebellum, gable-front church with two entrances in the gable end and because it displays a high degree of physical integrity. The exterior of the building has not been altered except for the removal of the original shutters from all but the rear window. Although the interior walls and ceiling were clad in beaded board in the 1890s, the interior has its original pews, altar, and altar rail. The building retains integrity of location, and the setting remains as it was historically--a small clearing in a rural, wooded area. The building also retains a high degree of integrity of feeling and association.

The congregation of the Tabernacle Methodist Church is no longer active, but a homecoming is held here annually. The church is under the care of the Cemetery Association and is being well maintained.

United States Department of the Interior
National Park Service

**National Register of Historic Places
Continuation Sheet**

Tabernacle Methodist Church
Copiah County, Mississippi

Section number 9-10 Page 3

9. MAJOR BIBLIOGRAPHICAL REFERENCES

Cawthon, Richard J. "National Register Eligibility Criteria for Churches in Mississippi." Unpublished, January 28, 1994. On file at the Historic Preservation Division, Mississippi Department of Archives and History, Jackson.

Cawthon, Richard, and Crook, Brenda, architectural historians with the Mississippi Department of Archives and History, Jackson. Inspection of Tabernacle Methodist Church, November 17, 1995.

Purser, Woodrow. Interviewed by Brenda R. Crook, architectural historian with the Mississippi Department of Archives and History, Jackson, by telephone on October 30, 1995, and at the Tabernacle Methodist Church on November 17, 1995.

10. GEOGRAPHICAL DATA

Verbal Boundary Description: That portion of Parcel 12 lying east of the Dentville Road, as shown on Map No. 73 in the Copiah County Tax Assessor's Office. The property is located in the NW 1/4 NE 1/4 SE 1/4 of Section 23, Township 1 North, Range 3 West.

Boundary Justification: The boundaries being nominated include 1.9 of the 2.0 acres historically associated with the church and owned by the present property owners. One-tenth acre was excluded from the boundaries being nominated because it is separated from the remainder of the church property by the Dentville Road.

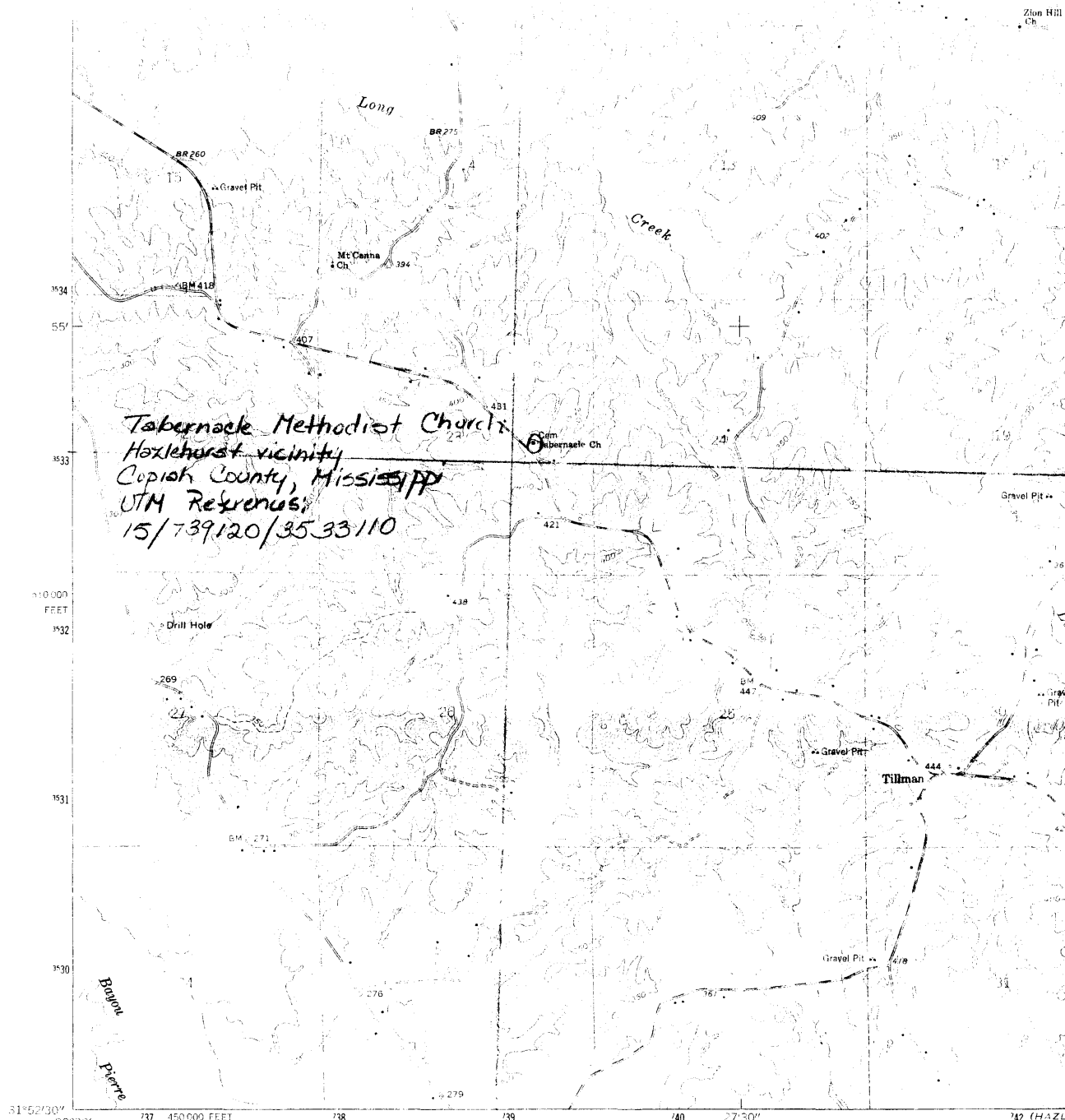

(51°40'N)
2847' SE

Mapped, edited, and published by the Geological Survey
 Control by USGS and USC&GS
 Topography by photogrammetric methods from aerial
 photographs taken 1958. Field checked 1963
 Polyconic projection. 1927 North American datum
 10,000-foot grid based on Mississippi coordinate system, west zone
 10,000-meter Universal Transverse Mercator grid ticks,
 zone 15, shown in blue
 Fine red dashed lines indicate selected fence and field lines where
 generally visible on aerial photographs. This information is unchecked

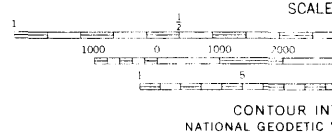
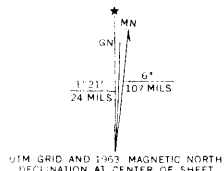

THIS MAP COMPLIES WITH NA
 FOR SALE BY U.S. GEOLOGICAL SURVEY
 A FOLDER DESCRIBING TOPOGRAPHIC MAPS