

**United States Department of the Interior
National Park Service**

**National Register of Historic Places
Continuation Sheet**

Section number _____ Page _____

SUPPLEMENTARY LISTING RECORD

NRIS Reference Number: 93000958

Date Listed: 10/1/93

First National Bank
Property Name

Hardin
County

IA
State

Architectural & Historical Resources of Iowa Falls, Iowa MPS
Multiple Name

This property is listed in the National Register of Historic Places in accordance with the attached nomination documentation subject to the following exceptions, exclusions, or amendments, notwithstanding the National Park Service certification included in the nomination documentation.

for Patrick W. Andrus
Signature of the Keeper

10/1/93
Date of Action

=====
Amended Items in Nomination:

Level of Significance:
The level of significance for this resource is local.

UTM:
The UTM coordinates were omitted from the nomination form. The correct coordinates were obtained from the attached USGS map.

This information was confirmed with Beth Foster of the Iowa SHPO.

DISTRIBUTION:
National Register property file
Nominating Authority (without nomination attachment)

United States Department of the Interior
National Park Service

RECEIVED

AUG 20 1993

NATIONAL REGISTER

National Register of Historic Places
Registration Form

This form is for use in nominating or requesting determinations for individual properties and districts. See instructions in *How to Complete the National Register of Historic Places Registration Form* (National Register Bulletin 16A). Complete each item by marking "x" in the appropriate box or by entering the information requested. If an item does not apply to the property being documented, enter "N/A" for "not applicable." For functions, architectural classification, materials, and areas of significance, enter only categories and subcategories from the instructions. Place additional entries and narrative items on continuation sheets (NPS Form 10-900a). Use a typewriter, word processor, or computer, to complete all items.

1. Name of Property

historic name First National Bank
other names/site number Iowa Falls State Bank

2. Location

street & number 601 Washington Avenue not for publication
city or town Iowa Falls vicinity
state Iowa code IA county Hardin code 083 zip code 50126

3. State/Federal Agency Certification

As the designated authority under the National Historic Preservation Act, as amended, I hereby certify that this nomination request for determination of eligibility meets the documentation standards for registering properties in the National Register of Historic Places and meets the procedural and professional requirements set forth in 36 CFR Part 60. In my opinion, the property meets does not meet the National Register criteria. I recommend that this property be considered significant nationally statewide locally. (See continuation sheet for additional comments.)

[Signature] 8/13/93
Signature of certifying official/Title Date

State Historical Society of Iowa
State of Federal agency and bureau

In my opinion, the property meets does not meet the National Register criteria. (See continuation sheet for additional comments.)

Signature of certifying official/Title Date

State or Federal agency and bureau

4. National Park Service Certification

I hereby certify that the property is:

- entered in the National Register.
 See continuation sheet.
- determined eligible for the National Register
 See continuation sheet.
- determined not eligible for the National Register.
- removed from the National Register.
- other, (explain): _____

Signature of the Keeper

Date of Action

[Signature] 10/1/93
Patricia Andrews

Name of Property

County and State

5. Classification

Ownership of Property (Check as many boxes as apply)

Category of Property (Check only one box)

Number of Resources within Property (Do not include previously listed resources in the count.)

- private, public-local, public-State, public-Federal

- building(s), district, site, structure, object

Contributing Noncontributing
1 buildings
sites
structures
objects
1 Total

Name of related multiple property listing (Enter "N/A" if property is not part of a multiple property listing.)

Number of contributing resources previously listed in the National Register

Architectural & Historical Resources of Iowa Falls, IA 0

6. Function or Use

Historic Functions (Enter categories from instructions)

Current Functions (Enter categories from instructions)

COMMERCE/Financial Institution
COMMERCE/Specialty

COMMERCE/Financial Institution

7. Description

Architectural Classification (Enter categories from instructions)

Materials (Enter categories from instructions)

Late 19th/Early 20th C. Revival

Neo-classical

foundation Concrete

walls Brick

roof Asphalt

other Granite

Terra Cotta

Narrative Description

(Describe the historic and current condition of the property on one or more continuation sheets.)

Name of Property

County and State

8. Statement of Significance

Applicable National Register Criteria

(Mark "x" in one or more boxes for the criteria qualifying the property for National Register listing.)

- Property is associated with events that have made a significant contribution to the broad patterns of our history.
Property is associated with the lives of persons significant in our past.
Property embodies the distinctive characteristics of a type, period, or method of construction or represents the work of a master, or possesses high artistic values, or represents a significant and distinguishable entity whose components lack individual distinction.
Property has yielded, or is likely to yield, information important in prehistory or history.

Criteria Considerations

(Mark "x" in all the boxes that apply.)

Property is:

- owned by a religious institution or used for religious purposes.
removed from its original location.
a birthplace or grave.
a cemetery.
a reconstructed building, object, or structure.
a commemorative property.
less than 50 years of age or achieved significance within the past 50 years.

Areas of Significance

(Enter categories from instructions)

Architecture

Period of Significance

1918

Significant Dates

1918

Significant Person

(Complete if Criterion B is marked above)

N.A.

Cultural Affiliation

N.A.

Architect/Builder

Archt: The Lytle Co., Sioux City

Bldr: Unknown

Narrative Statement of Significance

(Explain the significance of the property on one or more continuation sheets.)

9. Major Bibliographical References

Bibliography

(Cite the books, articles, and other sources used in preparing this form on one or more continuation sheets.)

Previous documentation on file (NPS):

- preliminary determination of individual listing (36 CFR 67) has been requested
previously listed in the National Register
previously determined eligible by the National Register
designated a National Historic Landmark
recorded by Historic American Buildings Survey
recorded by Historic American Engineering Record

Primary location of additional data:

- State Historic Preservation Office
Other State agency
Federal agency
Local government
University
Other

Name of repository:

Name of Property

County and State

10. Geographical Data

Acreage of Property Less than one acre.

UTM References

(Place additional UTM references on a continuation sheet.)

1 15 478310 47107260
Zone Easting Northing
2

3
Zone Easting Northing
4

See continuation sheet

Verbal Boundary Description

(Describe the boundaries of the property on a continuation sheet.)

Boundary Justification

(Explain why the boundaries were selected on a continuation sheet.)

11. Form Prepared By

name/title Molly Myers Naumann, Consultant (515) 682-2743
organization Iowa Falls Historic Preservation Commission date May 1993
street & number City Hall, 321 Stevens telephone (515) 648-2527
city or town Iowa Falls state IA zip code 50126

Additional Documentation

Submit the following items with the completed form:

Continuation Sheets

Maps

A USGS map (7.5 or 15 minute series) indicating the property's location.

A Sketch map for historic districts and properties having large acreage or numerous resources.

Photographs

Representative black and white photographs of the property.

Additional Items

(Check with the SHPO or FPO for any additional items)

Property Owner

(Complete this item at the request of SHPO or FPO.)

name Iowa Falls State Bank
street & number 601 Washington Avenue telephone (515) 648-5171
city or town Iowa Falls state IA zip code 50126

Paperwork Reduction Act Statement: This information is being collected for applications to the National Register of Historic Places to nominate properties for listing or determine eligibility for listing, to list properties, and to amend existing listings. Response to this request is required to obtain a benefit in accordance with the National Historic Preservation Act, as amended (16 U.S.C. 470 et seq.).

Estimated Burden Statement: Public reporting burden for this form is estimated to average 18.1 hours per response including time for reviewing instructions, gathering and maintaining data, and completing and reviewing the form. Direct comments regarding this burden estimate or any aspect of this form to the Chief, Administrative Services Division, National Park Service, P.O. Box 37127, Washington, DC 20013-7127; and the Office of Management and Budget, Paperwork Reductions Projects (1024-0018), Washington, DC 20503.

United States Department of the Interior
National Park Service

National Register of Historic Places Continuation Sheet

Section number 7 Page 1

CFN-259-1116

**First National Bank
Hardin County, Iowa**

Description:

The First National Bank (1918) is a two story brick rectangular building located on the SW corner of Washington Avenue and Stevens Street. It measures 22'x90' with a 22'x32' single story addition at the rear (1957). The primary facade is located on the narrow end of the rectangle which faces Washington. The bank is Neo-classical in style with a temple front. When the bank opened the blue-black exterior was described as being "of Hy-tex Mission Chinchilla face brick with granite and cream full enamel satin finish terra cotta." The main entrance is flanked by monumental terra cotta free-standing Corinthian columns resting on granite bases. Brick pilasters of the same dimensions are located on the corners, and feature terra cotta bases and elaborate Corinthian capitals. The main doorway features a terra cotta surround with a rich variety of Neo-classical details: Egg and dart, bead and reel, rosettes, and a full denticulated entablature above. Windows above this front entrance also feature a terra cotta surround and are crowned by a festooned frieze. The columns appear to support a simple terra cotta cornice, above which is a brick frieze featuring terra cotta rosettes directly above the columns and pilasters. A full entablature with rich Neo-classical detailing completes the temple front. A brick parapet tops the building, broken by a star-patterned balustrade at regular intervals. The granite base, brick parapet, terra cotta cornice, and brick pilaster treatment continue around the secondary facade (east elevation) with two story windows placed between the pilasters. The terra cotta festooned frieze also continues between the pilasters. The side windows have the same terra cotta surrounds found on the front, with star-pattern panels between the two stories. The tall slender first floor windows are separated by fluted pilasters with a hybrid shell capital, and a three paneled frieze above these windows features urns and a foliated design. The terra cotta detailing on this building is so rich that the producer, the American Terra Cotta Company, featured a drawing of one of the capitals in its company publication, Common Clay.

It appears that the only exterior changes are the installation of new front doors and the time/temperature sign. The single story addition to the rear is of the same brick and should not be considered intrusive.

From an historic interior photograph and floor plan, it appears that the major alteration was the moving of the cashiers' counters from the east side to the west side of the lobby at an undetermined date. These counters are of "green veined cream colored marble with a ten inch Westfield green marble" base. The lobby and vestibule walls are wainscoted with the same green veined cream marble. Woodwork is of "Tobasco mahogany". Originally the floor was of ceramic mosaic tile, but this has been carpeted. The ceiling and walls are richly ornamented with plaster beams and relief designs. This lavish plasterwork has been maintained over the years.

In recent years the bank purchased the building immediately to the west. Although the two buildings are now connected by doorways, the integrity of the 1918 building has been retained. The basement, reached by an outside stairway, was originally used as a barber shop and is now a community meeting room. The second floor contains offices.

United States Department of the Interior
National Park Service

National Register of Historic Places Continuation Sheet

Section number 7 Page 2

CFN-259-1116

First National Bank
Hardin County, Iowa

Description (continued):

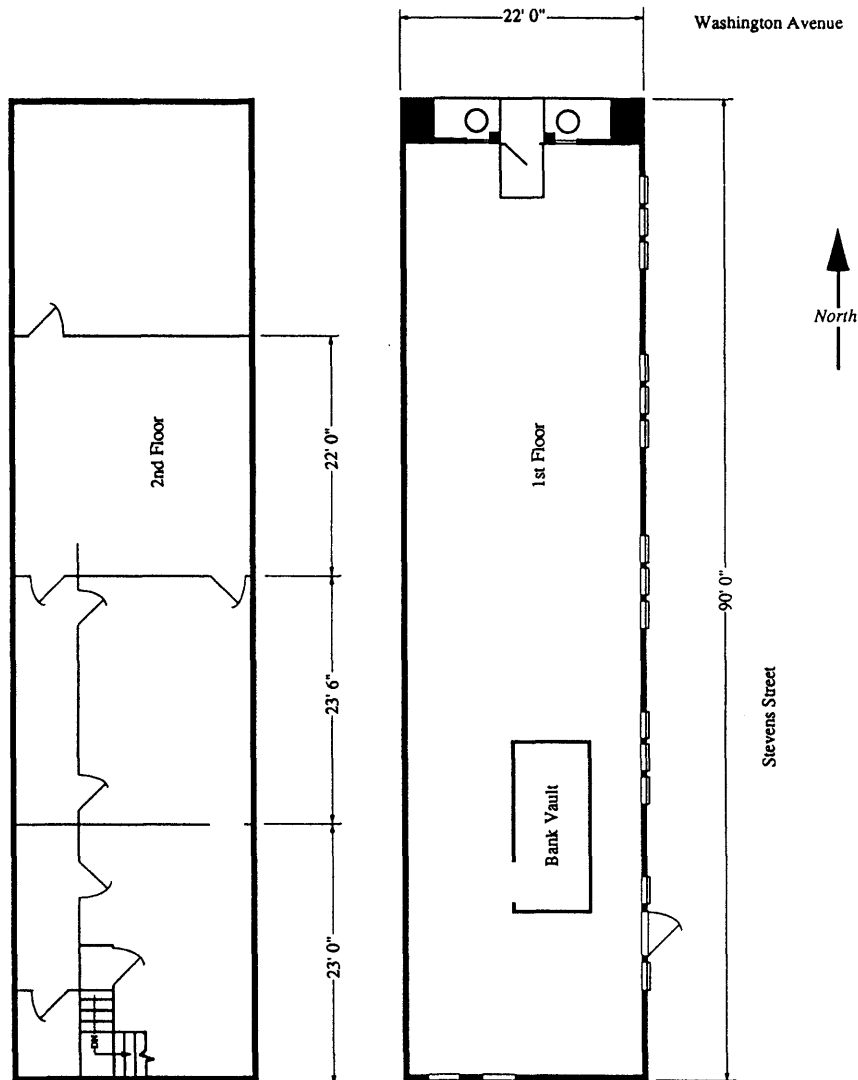

United States Department of the Interior
National Park Service

National Register of Historic Places Continuation Sheet

Section number 7 Page 3

CFN-259-1116

First National Bank
Hardin County, Iowa

Description (continued):

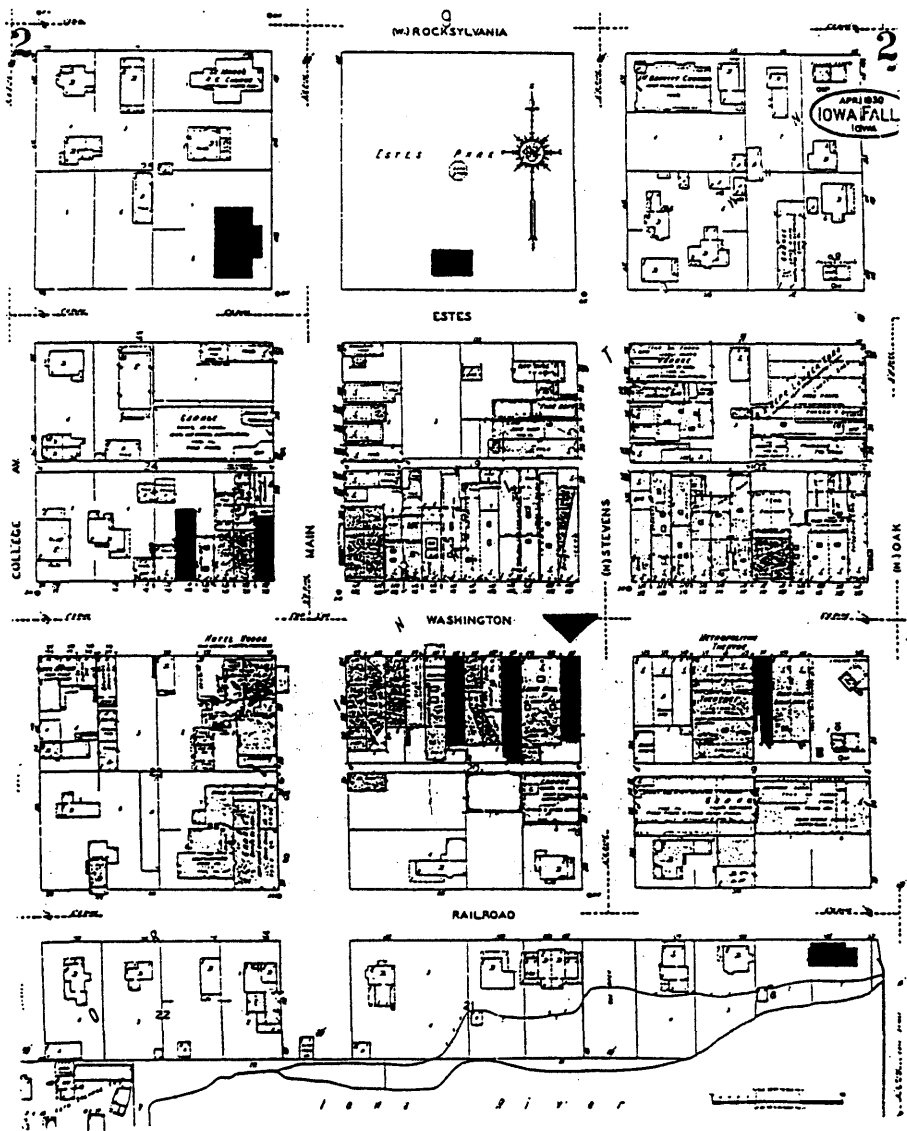

IOWA FALLS BUSINESS DISTRICT

Shaded buildings are those being nominated.

▶ indicates specific building being nominated.

United States Department of the Interior
National Park Service

National Register of Historic Places Continuation Sheet

Section number 7 Page 4

CFN-259-1116

First National Bank
Hardin County, Iowa

Description (continued):

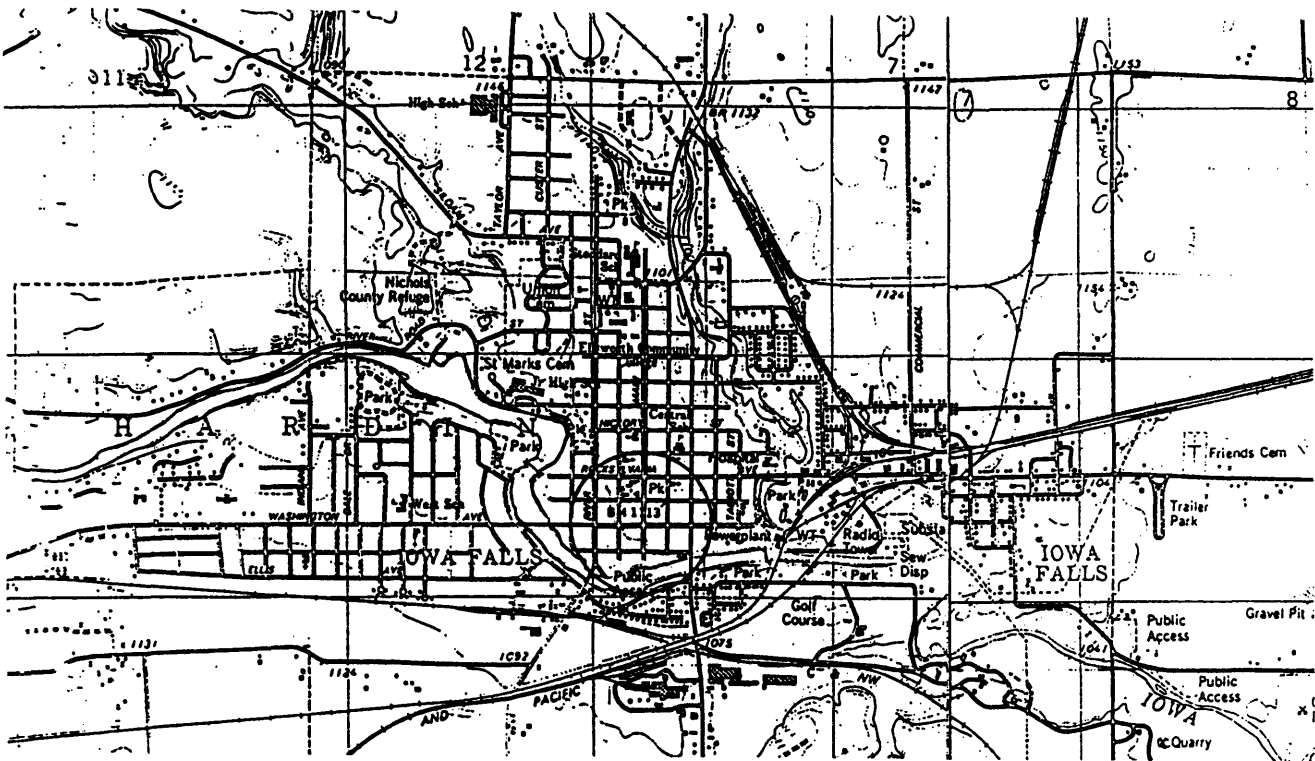

Central Business District is circled.
U.S.G.S. Map

United States Department of the Interior
National Park Service

National Register of Historic Places Continuation Sheet

Section number 8 Page 5

CFN-259-1116

**First National Bank
Hardin County, Iowa**

Significance:

The First National Bank (1918) is locally significant under under Criterion C as a fine, relatively unaltered, example of Neo-classical bank design from the second decade of this century, and is of local historical interest because it demonstrates the strong economic growth in Iowa Falls at that time. The period of significance is the date of construction.

Architecturally this building is a superb example of Neo-classical bank design. The bank selected the Lytle Company of Sioux City as their architectural firm. The Lytle Company specialized in bank designs although they did other building types as well. It is known that they designed at least twenty-five banks, primarily for Iowa communities, but also in Minnesota and South Dakota. One of their highly publicized designs was for the First National Bank of Maquoketa (NRHP), a double-wide building with a full terra cotta facade. While the Lytle Company favored the Neo-classical style for their bank designs, each bank was individually designed. The Iowa Falls bank shares some characteristics with those in Mapleton and Manchester, but the treatment of the side windows and the facade is slightly different on each. The architectural firm was able to achieve a rich surface pattern through the lavish use of terra cotta with special colors of brick.

The Commercial Bank of Iowa Falls was established in 1882, and a brick building constructed for its use in 1884. That building was on the site of the present bank at the SW corner of Washington and Stevens. At that time the name was changed to First National Bank. Original officers and stockholders included such well known Iowa Falls names as L.F. Wisner, E.S. Ellsworth, L.O. Bliss, and Mrs. Helen Nichols. At a later date E.O. Ellsworth served as president for many years. In 1917 it was decided to replace the two story brick building with a more modern one. The bank placed a large ad in the Hardin County Citizen explaining that

We wrecked a perfectly good building...at one time the best business block in the town and which might have been made to answer for many more years...largely for the purpose of carrying out the policy of the management in keeping just a little ahead of the times in civic and public improvement.

Our new building is a milestone in the progress of our city and is just another evidence of our faith in Iowa Falls and the people of this community. We believe in the future of Iowa Falls and feel that with its loyal citizens and thru the assistance of the successful farmers in our surrounding community, our city will grow and continue to grow, reflecting the intelligence, industry and thrift of our people.

This was in the period of growth not only of the business district, but the entire community. The newly paved streets, new bridges across the river, and new residential neighborhoods illustrated the prosperity of the community. There was a new Federal Building, and the Episcopal parish had just built a new church, St. Matthew's by the

United States Department of the Interior
National Park Service

National Register of Historic Places Continuation Sheet

Section number 8 Page 6

CFN-259-1116

First National Bank
Hardin County, Iowa

Significance (continued):

Bridge. The bank was just one of several new commercial buildings along Washington during that decade. The McClanahan Building, the Rex Theater, Cuplin Block, and Dougan's Garage all were part of this growth. This prosperity did not last however, and on December 21, 1932 the First National Bank closed its doors. The city was without a bank until the Iowa Falls State Bank was organized and opened on May 25, 1933, in the building formerly occupied by the First National.

The First National Bank of Iowa Falls is a very good example of bank design from its period and it retains a high level of integrity.

United States Department of the Interior
National Park Service

National Register of Historic Places Continuation Sheet

Section number 9 & 10 Page 7

CFN-259-1116

First National Bank
Hardin County, Iowa

Bibliography:

- Abstract of Title, City of Iowa Falls, Original Plat, Block 20, E 1/3 (22') Lot 1.
Iowa Falls Citizen and Hardin County Times, Centennial Edition, June 14, 1955, Vol. 77.,
Sec. 13, No. 24, pp. 1 & 2.
Iowa Architects File, H.P.B.
Hardin County Citizen, August 24, 1917
June 7, 1918
June 8, 1918
- Nichols, Ira A. Pioneer Days in Iowa Falls, Iowa. Fort Dodge: Messenger Printing Co.,
1944, p 148.
History of Iowa Falls: 1900-1950. Iowa Falls: Hecht Printing Co.,
1956, pp 83, 214, 220-1.
Sanborn Fire Insurance Maps
"Dignity and Convenience Features of This Bank," Building Age, October 1922, p 41.
"The Lytle Company," Common Clay (the American Terra Cotta Co., Chicago), January
1921, pp II-VII.

Verbal Boundary Description:

City of Iowa Falls, Original Plat, Block 20, E 22' Lot 1, except the S 10'.

Boundary Justification:

This is the area historically associated with this resource.