



United States Department of the Interior

NATIONAL PARK SERVICE
1849 C Street, N.W.
Washington, D.C. 20240

The attached property, South Central Aberdeen Historic District, reference number 88000134 was listed in the National Register of Historic Places by the Keeper of the National Register on 04/22/1988, as evidenced by the FEDERAL REGISTER/WEEKLY LIST notice of 04/29/1988. The attached nomination form is a copy of the original documentation provided to the Keeper at the time of listing.



Keeper of the National Register of Historic Places

9/8/2008
Date

United States Department of the Interior
National Park Service

For NPS use only

National Register of Historic Places
Inventory—Nomination Form

received

date entered

See instructions in *How to Complete National Register Forms*
Type all entries—complete applicable sections

1. Name

historic N/A

and/or common South Central Aberdeen Historic District

2. Location

Roughly bounded by Locust St. on the east, Washington St. on the north,
street & number Franklin St. on the west & High St. on the south. N/A not for publication

city, town Aberdeen N/A vicinity of

state Mississippi code 28 county Monroe code 095

3. Classification

<input checked="" type="checkbox"/> district	<input type="checkbox"/> public	<input checked="" type="checkbox"/> occupied	<input type="checkbox"/> agriculture	<input type="checkbox"/> museum
<input type="checkbox"/> building(s)	<input checked="" type="checkbox"/> private	<input type="checkbox"/> unoccupied	<input type="checkbox"/> commercial	<input type="checkbox"/> park
<input type="checkbox"/> structure	<input type="checkbox"/> both	<input type="checkbox"/> work in progress	<input type="checkbox"/> educational	<input checked="" type="checkbox"/> private residence
<input type="checkbox"/> site	Public Acquisition	Accessible	<input type="checkbox"/> entertainment	<input type="checkbox"/> religious
<input type="checkbox"/> object	<input type="checkbox"/> in process	<input type="checkbox"/> yes: restricted	<input type="checkbox"/> government	<input type="checkbox"/> scientific
	<input type="checkbox"/> being considered	<input type="checkbox"/> yes: unrestricted	<input type="checkbox"/> industrial	<input type="checkbox"/> transportation
		<input type="checkbox"/> no	<input type="checkbox"/> military	<input type="checkbox"/> other:

4. Owner of Property

name Multiple Owners

street & number N/A

city, town N/A vicinity of state

5. Location of Legal Description

courthouse, registry of deeds, etc. Chancery Clerk Building

street & number 201 W. Commerce St.

city, town Aberdeen state MS 39730

6. Representation in Existing Surveys

title N/A has this property been determined eligible? yes no

date federal state county local

depository for survey records

city, town state

Description

Condition		Check one	Check one
<input checked="" type="checkbox"/> excellent	<input type="checkbox"/> deteriorated	<input type="checkbox"/> unaltered	<input checked="" type="checkbox"/> original site
<input checked="" type="checkbox"/> good	<input type="checkbox"/> ruins	<input checked="" type="checkbox"/> altered	<input type="checkbox"/> moved date _____
<input checked="" type="checkbox"/> fair	<input type="checkbox"/> unexposed		

Describe the present and original (if known) physical appearance

The South Central Aberdeen Historic District is overwhelmingly residential in character and is comprised of 179 buildings dating from 1848 to the 1970's. The period of significance extends from 1848 to 1937. Utilitarian outbuildings, such as garages and storage sheds, which do not make a distinct contribution to the sense of time and place within the district are not included in the inventory of buildings even if their construction dates from the period of significance. On the other hand, if these types of structures possess architectural and/or historical significance they are included in the inventory. As noted in the cover nomination, the present-day town of Aberdeen is comprised of two original towns each platted individually -- Old Aberdeen to the east of Meridian Street and New Aberdeen to the west. The manmade topography created by these two plats is clearly delineated within the South Central Aberdeen Historic District.

This potential district is roughly L-shaped and includes most of the residential area between Commerce Street and Highway 25. Several historically distinct neighborhoods are located within the boundaries of this district. The late nineteenth century, upper middle class neighborhood known as Silk Stocking Row comprised most of S. Franklin Street. At approximately the same time and two blocks to the east on S. Columbus Street were the comfortable residences of Aberdeen's thriving black middle class. Maple Street, at the eastern edge of the district, retains its appearance as a turn-of-the-century middle-class neighborhood. All of the properties are well-maintained and most are informally landscaped with trees, crepe myrtles and other shrubbery. Even the vacant lots are well cared for. The houses on the west side of S. Franklin Street are situated on some of the largest lots in the district -- three are each over one acre in size. The city ditch enters at the northwest corner of the district, meanders southeasterly and exits the district below Monroe Street east of Hickory Street. It is relatively unobtrusive and, therefore, not an eyesore.

The popular styles of the nineteenth century such as Greek Revival, Second Empire, and Queen Anne are usually articulated in the houses lining the north-south streets, although interspersed among them are bungalows and expressions of the various early twentieth century revival styles. The east-west routes are dominated by bungalows and other styles that were popular in the early twentieth century. Most of the nineteenth century houses on these latter streets are located on the corner lots. This development pattern illustrates how the large lots of nineteenth century residences were subdivided after the turn of the century to accommodate the increased demand for housing.

United States Department of the Interior
National Park Service

**National Register of Historic Places
Inventory—Nomination Form**

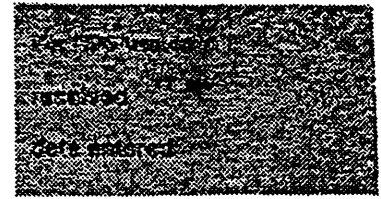

S. Central Aberdeen Hist. Dist.,

Continuation sheet Aberdeen MRA; Monroe Co., MS Item number 7

Page 1

Inventory of Buildings

South Columbus Street

1. 301-303. House. Brick-veneered, ranch-style duplex. Ranch style. Ca. 1965. (NC)
2. 304. House. One-and-one-half story, three by three bay house covered in vinyl siding. It rests on a concrete block foundation and has a steep hip roof pierced by gables and sheathed in embossed metal tiles. The low hip roof of the wraparound front porch is supported by wrought iron posts. Queen Anne. Ca. 1900. (MN)
3. 305. House. One-and-one-half story, three bay wide house sheathed in aluminum siding. The house rests on brick piers with concrete block infill and has a hip roof accented by gables. In the ell created by the projecting gabled bays is a front porch with wrought iron columns and a balustrade. Queen Anne. Ca. 1900. (MN)
4. 306. House. Asymmetrical, one-and-one-half story, five by four bay house with aluminum siding. It rests on a brick foundation and has a complex roof. The front porch located in the ell created by the projecting gabled bay at the house's southwest corner features battered box columns upon brick pedestals supporting a low hip roof. The interior corbelled chimney is stuccoed. Transitional Queen Anne/Bungalow. Ca. 1910. (C)
5. 309. House. One story brick and frame house with a gable roof. Ranch style. (NC)
6. 310. Samuel Blevins House. One-and-one-half story, three by two bay, pyramidal-roofed frame house that is essentially rectangular in form but has projecting gable-roofed bays. The front porch features turned posts, scrollwork brackets and a bracketed frieze with a sawtooth design element. The windows display either a plain surround, a dog ear surround, a pedimented lintel or a bracketed canopy with a frieze with a sawtooth motif. Alterations include the removal of the balustrade from the front porch, a new porch on the side (south) elevation and a shed-roofed, one story addition with a porch on the rear facade. Italianate/Queen Anne. Ca. 1880. (P)
7. 311. House. One-and-one-half story, two by three bay clapboard-

**United States Department of the Interior
National Park Service**

**National Register of Historic Places
Inventory—Nomination Form**

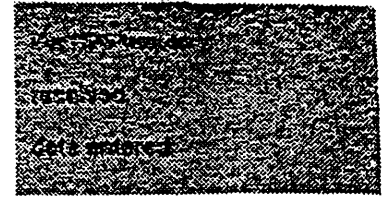

S. Central Aberdeen Hist. Dist.,

Continuation sheet Aberdeen MRA, Monroe Co., MS Item number 7

Page 2

ed bungalow crowned by a side-gabled roof with struts. The roof is dominated by a large shed-roofed dormer with boarded up windows. At the southeast corner of the house is an undercut front porch with a brick parapet and brick piers. A large carport was added to the rear elevation. Bungalow. Ca. 1915. (C)

8. 313. House. One-and-one-half story, three by two bay, shiplap-clad bungalow with a gable roof displaying struts and exposed rafter ends. The full-width, front porch has brick piers with clustered box columns supporting the front gable. Most windows have a six-over-one double hung sash configuration. Bungalow. ca. 1910. (C)
9. 400. House. One story, five by three bay frame house with a side-gabled roof. The front facade consists of a porch with attenuated Tuscan columns and, on the southwest corner of the house, a gabled projecting bay. On the rear elevation is a gable-roofed wing and a shed-roofed addition. Colonial Revival influence. Ca. 1905. (C)
10. 405. House. One-and-one-half story, three by four bay, shiplap-covered bungalow with a roof featuring front and rear gables, struts and exposed rafter ends. The full-width front porch's battered box columns support a gabled roof. The predominant window configuration is vertical three over one double hung sash. Bungalow. Ca. 1920. (C)
11. 407. House. Brick-veneered residence with a gable roof. Ranch style. Ca. 1985. (NC)
12. 500. Lasky House. One-and-one-half story, three by six bay, clapboard house crowned by a truncated hip roof pierced by gables and gabled dormers. The wraparound front porch has a balustrade, Ionic columns and a corner pavilion. The southernmost front bay contains a three-sided bay with diagonal tongue-and-groove beaded board panelling beneath its windows. There are also three-sided bays on the north and south (side) elevations. There is a small addition on the rear elevation. Colonial Revival. Ca. 1910. (C)

South Franklin Street

13. 102. Elsa Gay's Beauty Shop. One story, three by three bay, shiplap clad bungalow with a gabled roof displaying exposed rafter ends and shingled gables with struts. The front porch

1-NC 5-C

United States Department of the Interior
National Park Service

National Register of Historic Places
Inventory—Nomination Form

S. Central Aberdeen Hist. Dist.,

Continuation sheet Aberdeen MRA, Monroe Co., MS Item number 7

Page 3



has new concrete steps with a metal handrail, a wooden deck and battered columns supporting the front gable. On the side (south) elevation is a projecting bay with a gable peak. What appears to be a sun porch was enclosed. Bungalow. Ca. 1925. (C)

14. 104-106. Duplex. One story, four by four bay, shiplap-clad bungalow with a gable roof. Each of the two small wraparound porches with Tuscan columns supporting a front gabled roof terminates on the side elevations at a projecting bay with a gable roof set perpendicular to the main roof ridge. All the gable peaks are accented by tongue and groove beaded board. Bungalow. Ca. 1925. (C)
15. 108. House. One story, three by four bay bungalow covered in aluminum siding. The full-width, front porch has battered box columns on brick pedestals supporting the front gable. On the side (north) elevation, the exterior brick chimney has been dismantled and removed above the roofline. Bungalow. Ca. 1920. (C)
16. 205. William Bismark Watkins House (Watkins Hill). An asymmetrically-massed, two story, frame house that is a variant on the foursquare plan and features Prairie Style influenced design elements. Believed to have originally been built in the Queen Anne style, but underwent a major renovation in the early twentieth century. Prairie Style influence. 1897/ca. 1920 (C)
17. 206. House. One-and-one-half story, three by three bay, shiplap-clad house with a truncated hip roof pierced by gabled dormers. The wraparound front porch, which features Tuscan columns and a balustrade, terminates on the north (side) elevation at a projecting bay with a gable roof. The centrally located front entrance is positioned in a projecting, three-sided, one story bay and this projection is reflected in the porch which curves outward at this point. The rear porch has been enclosed. Free Classic Queen Anne. Ca. 1900. (C)
18. 209. Victoria. Asymmetrical, one-and-one-half story house clad in lap siding and crowned by a complex gabled roof. The front facade displays a delicate Eastlake verandah and two prominent gables featuring board and batten trim and brackets. Eclectic. 1885. (P)
19. 212. House. One-and-one-half story, three by five bay, clapboarded bungalow rests on a stuccoed concrete foundation (an

National Register of Historic Places
Inventory—Nomination Form

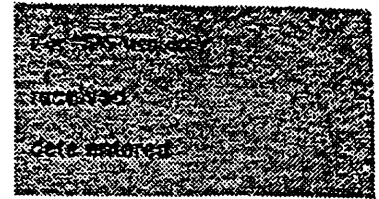

S. Central Aberdeen Hist. Dist.,

Continuation sheet Aberdeen MRA, Monroe Co., MS Item number 7

Page 4

alteration from the original piers) and has a side-gabled roof. The front facade features a projecting, gable-roofed bay and a screened-in porch with concrete stuccoed piers supporting battered, panelled box columns. A front and a rear shed roof dormer mark the main roof. Bungalow. Ca. 1900. (C)

20. 213. House. One-and-one-half story, frame cottage resting on a brick base and crowned by a steep pyramidal roof pierced by gables. A portion of the deck of the wraparound porch has been removed to create a carport. The porch has turned posts and a spindled frieze. Queen Anne. Ca. 1890-1895. (C)
21. 300. House. Two-and-one-half story, three by five bay, clapboard house resting on brick piers with brick infill and topped by a gable-on-hip roof. The roof has three gable-roofed dormers. The wraparound front porch has had its columns replaced by wrought iron posts but still retains an entablature with a dentilled frieze. The frontispiece features a single-leaf door with a beveled glass window, beveled glass sidelights and panelled Ionic pilasters supporting a heavy dentilled cornice. Towards the rear, on the northeast corner of the house is a sun porch with jalousie windows. There are also several rear additions. Colonial Revival. Ca. 1905. (C)
22. 303. Judge Eugene O. Sykes House (Shadow Lawn). A hip-roofed, two story wood frame house with clapboard siding. The front facade is rectangular but asymmetrical, composed in four bays. On the lower story, a semi-hexagonal bay window projects from the southernmost bay. Each face of the bay window contains a one-over-one window flanked by shutters. Its eaves are adorned with paired brackets. The second bay from the south contains an Italianate double-leaf door protected by a small projecting enclosed porch with a shallow peaked roof. Extending from this porch across the two northern bays is an open porch carried by slender posts with Italianate detailing and enhanced by openwork spandrels. On the upper story each bay contains a pair of round-headed, one-over-one windows flanked by shutters. The end walls of the house feature bay windows like the one on the front. A service wing projects from the rear of the house. Italianate. 1863. (P)
23. 304. House. One-and-one-half story, three by five bay, shiplap clad house with a steep pyramidal roof pierced by gables. The wraparound front porch connects two one-story, gable-roofed wings. The porch displays a simple balustrade and Tuscan columns. On the rear elevation is a shed-roofed addition.

United States Department of the Interior
National Park Service

National Register of Historic Places
Inventory—Nomination Form



S. Central Aberdeen Hist. Dist.,

Continuation sheet Aberdeen MRA, Monroe Co., MS Item number 7

Page 5

- sheathed in clapboard. Colonial Revival. Ca. 1910. (C)
24. 305. House. Two-story, three bay wide stuccoed masonry house. On the full-width front porch is an entrance flanked by paired spiral columns (one column from each pair is engaged) which support an overdoor. This spiral treatment is repeated with the surrounds of the paired window in the southernmost front bay. Spanish Eclectic. Ca. 1925-1930. (C)
25. 308. Buena Vista. Two-and-one-half story, two by five bay, clapboarded house capped by a hip roof pierced by gables. A one story, wraparound front porch features a wooden balustrade and Tuscan columns on brick pedestals. Above the front entrance within this porch area is a balcony similar in treatment to the porch. Swags accent the porch frieze below the balcony and the frieze of the balcony itself. Colonial Revival. 1902. (C)
26. 312. Steamboat. Wood frame, one-and-one-half story, one by five bay house with a brick foundation and a truncated hip roof. The front facade is dominated by a one-and-one-half story, five-sided projecting bay crowned by a gable. This central bay is encircled by a one story porch with Doric columns. The front corners of the house are chamfered and capped by small gables. The rear one story wing has a new porch added to it. Queen Anne. 1899. (C)
27. 401. House. Asymmetrical, one-and-one-half story, red brick house with 8/8 and 6/6 double-hung sash windows. On the front facade is a two bay porch with railing across the top of its roof. Georgian Revival. Ca. 1935. (C)
28. 402. House. One-story, brick-veneered house with a front, projecting, gable-roofed wing. A small porch is sheltered by the wing's gable roof. Ranch style. Ca. 1970. (NC)
29. 404. House. One-and-one-half story, four by three bay frame house with a steep hip roof pierced by two interior corbelled brick chimneys and gables. A tower marks the southwest corner of the house. The decorative detailing includes a spindled frieze and turned posts on the front porch, tongue-and-groove beaded board, imbricated shingles, and gables displaying a sunburst motif. Queen Anne. Ca. 1885. (P)
30. 413. John C. Wicks House (Silk Stocking Row). Asymmetrical, two story house sheathed in clapboard and crowned by a mansard roof of patterned slate. On the northeast corner of the house

1-NC 6-C

**National Register of Historic Places
Inventory—Nomination Form**

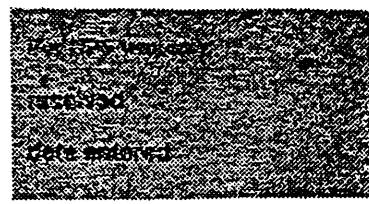

S. Central Aberdeen Hist. Dist.,

Continuation sheet Aberdeen MRA, Monroe Co., MS Item number 7

Page 6

is a polygonal tower with a patterned slate roof and cresting. The main roof has lost its cresting. Many of the windows are segmental arched, 1/1 double-hung sash with pedimented lintels. Originally, the house had a one story front porch which began at the tower and wrapped around the southeast corner of the house. Currently, the porch is gone and the one story southeast portion of the house has been raised to two stories. A projecting front bay features a small porch with Italianate posts supporting an awkwardly designed roof. The entrance within the porch area consists of a single-leaf door with a transom and an Eastlake style surround. Second Empire. Ca. 1895. (C)

- 31. 501. Turnage House. Two-and-one-half story, three by four bay, wood frame house with a hip roof displaying a gabled dormer. The square main block of the house has a two-and-one-half story projecting bay on each of its side elevations and a rear one story section. The two-tiered front gallery features attenuated Tuscan columns and a wood balustrade on its first story and a wood balustrade on its second story. This gallery, which had deteriorated badly, was rebuilt in early 1987. Colonial Revival. Ca. 1905. (C)
- 32. 503. Leftwich House. Asymmetrical, two-and-one-half story, four by three bay frame house crowned by a slate mansard roof. The irregular massing of the house includes a three story tower on its southeast corner, a one story section on the northeast corner, a central, slightly projecting two story bay on the front facade and two projecting polygonal bays. The wraparound front porch features unusual, multi-sided battered posts and delicate incised spandrels. Many of the windows are either round-arched or segmental-arched. Second Empire. 1883. (P)
- 33. 504. House. A one-and-one-half story, three by three bay, square clapboarded house crowned by a pyramidal roof and having hip-roofed wings. A wraparound front porch with brick pedestals supporting battered box columns connects the front and side (north) wings. Within the porch area is a projecting curved bay sheathed in tongue-and-groove beaded board. Vernacular. Ca. 1900. (C)
- 34. 506-508. Duplex. Rectangular, one story, three by two bay, eave-oriented duplex sheathed in shiplap. Two of the entrances are located on small stoops with concrete decks and metal handrails. Two exterior brick chimneys. Ca. 1940. (NC)
- 35. 507. House. One story, brick-veneered house with a hip roof.

1-NC 4-C

United States Department of the Interior
National Park Service

National Register of Historic Places
Inventory—Nomination Form

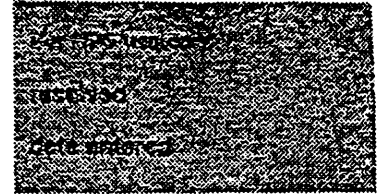

S. Central Aberdeen Hist. Dist.,
Continuation sheet Aberdeen MRA; Monroe Co., MS Item number 7

Page 7

The house is ranch style in form with classically-inspired design elements. Ranch style. Ca. 1970. (NC)

36. 510. House. Asymmetrical, one-and-one-half story, three by three bay house sheathed in aluminum siding and resting on brick piers with concrete block infill. The truncated hip roof is pierced by a dormer and the gable roofs of projecting bays. The wraparound front porch features a balustrade, Ionic columns, a frieze and a cornice. Four interior corbelled brick chimneys. Free Classic Queen Anne. Ca. 1905-1910. (C)
37. 511. Charles Eckford House (Meckford). Asymmetrical, two story, three by three bay, frame house with a hip roof. The front porch features chamfered posts with pierced corner brackets and a decorative sawn frieze. In the southernmost bay of the front facade is a floor-length window which retains its canopy but has lost its balcony. The windows have surrounds incised with naturalistic designs and the front second story windows also have heavily molded, pedimented lintels. Stick Style influence. 1884. (C)
38. 512. House. One story, five-bay wide, brick-veneered house with an undercut front porch and a hip roof. On the north elevation is an attached garage. Ranch style. Ca. 1965. (NC)
- 39a. 514. House. One-and-one-half story, three by three bay, brick-veneered house that is roughly T-shaped in form. The eave-oriented front section of the house features stuccoed gables with decorative half-timbering and a gabled entry porch with round arches. On the side (south) elevation is a projecting bay with a similar gable treatment. Tudor Revival. Ca. 1925. (C)
- 39b. 514. Garage. A small, gable-oriented building similar in wall treatment and gable treatment to the main house. It is "connected" to the rear of the house by a modern structure consisting of a flat roof supported on plain metal posts. Tudor Revival. Ca. 1925. (C)

South Hickory Street

40. 211. House. One-and-one-half story, four by four bay, clapboard bungalow with a side-gabled roof. All the gables have imbricated shingles. Located within the front porch area is a frontispiece with Classical design motifs. Bungalow. Ca. 1910. (C)

2-NC 5-C

**National Register of Historic Places
Inventory—Nomination Form**

S. Central Aberdeen Hist. Dist.,

Continuation sheet Aberdeen MRA, Monroe Co., MS Item number 7

Page 8

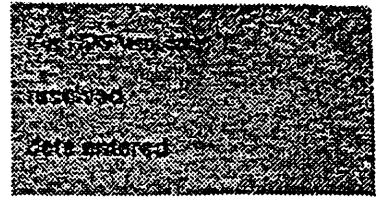

41. 300. Switzer House. One-and-one-half story, four by two bay, frame house on a stucco foundation and crowned by a complex roof with multiple gables. The stucco treatment is repeated on the front stoop piers and on the two interior chimneys. One of the chimneys has a Craftsman style chimney cap. Bungalow. Ca. 1920. (C)
42. 302. House. Originally a one-and-one-half story, eave-oriented, frame bungalow that has recently received a brick veneer. Above the full-width, shed-roofed porch, the front facade is dominated by a gabled dormer sheathed in shiplap. Bungalow. Ca. 1925. (MN)
43. 303. Ernest Lanctot House. Asymmetrical, one-and-one-half story, three by three bay frame house with side gables accented by spindled scrollwork. The house is clad in clapboard and horizontal beaded board. Its most unique features are the two bowed front windows with fixed leaded glass transoms. It is believed that the full-width front porch with its boxed columns is a replacement for an Eastlake style wraparound porch. Queen Anne. Ca. 1895. (C)
44. 306. House. One-story, L-shaped, frame house with a gable roof. At its south elevation is an attached carport. A shallow front gallery features tapered columns. Ranch style. Ca. 1970. (NC)
45. 307. Kirby Lann House. One-and-one-half story, three by six bay, clapboarded bungalow with a side-gabled roof displaying clipped gables. The front half of the roof is dominated by a gabled dormer. Extending beyond the full-width front porch on the north (side) elevation is a porte-cochere. The main roof has an interior brick chimney, exposed rafter ends and struts. Bungalow. 1909. (C)
46. 310. Felix J. Lann, Sr. House. One-and-one-half story, shiplap clad bungalow with a sweeping side-gabled roof dominated by a gabled dormer and accented by struts. The wraparound front porch features battered box columns on brick pedestals which are connected by parapets. The frontispiece displays both Craftsman and Classical influences. Bungalow. 1920. (C)
47. 311. House. One story, three bay wide, eave-oriented, brick house with a two story rear wing. The front entrance is located under a metal awning supported by wrought iron posts. The

2-NC 4-C

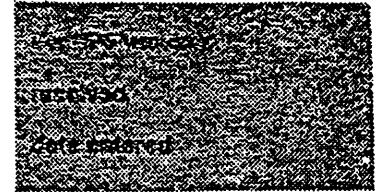
United States Department of the Interior
National Park ServiceNational Register of Historic Places
Inventory—Nomination Form

S. Central Aberdeen Hist. Dist.,

Continuation sheet Aberdeen MRA, Monroe Co., MS Item number 7

Page 9

gables display a stucco treatment and decorative half-timbering. Tudor Revival. Ca. 1935. (C)

48. 400. House. Rectangular, one story, five by three bay house veneered in yellow brick and topped by a gable roof. The house has a single-leaf door and three pairs of 1/1 aluminum sash windows. Ranch style. Ca. 1965-1970. (NC)
49. 401. House. One-and-one-half story, asymmetrical house with a steep hip roof pierced by several gables. The house's clapboard and horizontal beaded board has been covered by vinyl siding. The wraparound porch on the northeast corner of the house has had its turned posts either removed or encased in new aluminum columns. Queen Anne. Ca. 1895. (C)
- 50a. 410. House. Asymmetrical, one-and-one-half story, three by four bay, brick veneered house with a steeply pitched gable roof with front and rear gables. All the gables display a stucco treatment and decorative half-timbering. The front entrance is accented by a Gibbs surround of rusticated quoins. A similar quoin treatment accents the exterior chimney on the front facade. Tudor Revival. Ca. 1925. (C)
- 50b. 410. Garage. The small, one-car garage features the same wall treatment and the same gable treatment as the main house. Tudor Revival. Ca. 1925. (C)
51. 500. House. Two-and-one-half story, three by two bay, frame house covered in aluminum siding and capped by a truncated hip roof accented by hip roofed dormers. The first story front porch has a rusticated concrete block parapet, wooden columns and a dentilled frieze. The second story gallery above it features Ionic columns. The variety of window forms exhibit decorative muntins in their upper sashes. Colonial Revival. Ca. 1910. (C)

High Street

52. 401. House. One story, four by four bay, gable-oriented bungalow clad in shiplap. The front porch features battered box columns on brick pedestals supporting a gable. Bungalow. Ca. 1925. (C)
53. 403. House. One story, four by three bay, gable-oriented bungalow sheathed in narrow clapboard. The central front porch displays brick pedestals with triads of columns supporting a

1-NC Co-C

United States Department of the Interior
National Park Service

National Register of Historic Places
Inventory—Nomination Form



Continuation sheet S. Central Aberdeen Hist. Dist.,
Aberdeen MRA, Monroe Co., Mjstem number 7

Page 10

- gable. On the east (side) elevation is a screened-in porch similar in treatment to the front porch. Bungalow. Ca. 1925. (C)
54. 407. Henry Dugan House. One story, seven bay wide, eave-oriented frame house with a central two story section. This two story section is believed to date from the late nineteenth century. The house with its clipped gable roof and wraparound porch displaying battered box columns on brick pedestals appears to date from the early twentieth century. Bungalow influence. Ca. 1920. (C)
55. 501. House. One-and-one-half story, eave-oriented, brick-veneered house with gables that feature stuccoing and decorative half-timbering. There is an exterior chimney on the front facade. Rear additions. Tudor Revival. Ca. 1935. (C)
56. 503. The Gables. One-and-one-half story house clad in horizontal beaded board with a steeply pitched roof dominated by two large gables on the front facade. The gables exhibit round attic windows and, in their peaks, decorative pierced bargeboard. The front porch, an early twentieth century alteration, features battered box columns resting on brick pedestals. Queen Anne influence. 1898. (C)
57. 505. House. One-and-one-half story, three by three bay, eave-oriented house clad in clapboard. The central front door is flanked by narrow 6/6 windows and capped by an overdoor. Two dormers pierce the front roof line. Exterior brick chimney in the western (side) gable. Ca. 1925. (C)
58. 506. F. S. McKnight House. One-and-one-half story, asymmetrical clapboarded house crowned by a complex roof. Its front porch features turned posts, a balustrade, a spindled frieze and corner pavilion with a conical roof. Many of the gables display decorative pierced bargeboard in their peaks. On the east (side) elevation is a one story addition with a large plate glass window. One story, rear addition. Queen Anne. Ca. 1895. (C)
59. 508. House. One story, gable-roofed bungalow covered in vinyl siding. The front porch has battered box columns on brick pedestals supporting a gable roof. The windows are 9/1 double-hung sash. Bungalow. Ca. 1920. (C)
60. 509. House. Two story, three by three bay, gable-oriented

United States Department of the Interior
National Park ServiceNational Register of Historic Places
Inventory—Nomination FormContinuation sheet S. Central Aberdeen Hist. Dist.,
Aberdeen MRA, Monroe Co., MS Item number 7

Page 11

bungaloid house sheathed in clapboard. The full-width front porch has panelled box columns. The front gable is accented by imbricated shingles and struts. Swiss Chalet/Bungalow. Ca. 1920. (C)

61. 511. Adelia's Dream House. One-and-one-half story, three by four bay frame house with a truncated hip roof pierced by gables and covered in metal shingles. The front central bay contains a large gabled dormer and, on the first story, a projecting multi-sided bay encircled by a curved portico with Ionic columns. Located in this bay is a single-leaf door with a large oval window. Each side elevation features a projecting bay. Colonial Revival. 1907. (C)

South James Street

62. 108. St. Francis of Assisi Catholic Church. One-and-one-half story, one by five bay, stuccoed brick building crowned by a gable roof. The front facade features a round-arched entrance and, in the parapeted gable, a trio of round-arched windows. The side elevations have round-arched windows in their central bays and flat-topped windows with jack arches and brick surrounds in their end bays. Mission Style. 1927. (C)
63. 208. House. Two story clapboarded foursquare with a hip roof displaying a gabled dormer. The full-width front porch features paired box columns. Colonial Revival influence. Ca. 1915. (C)
64. 209. House. Asymmetrical, one-and-one-half story, clapboard-covered house crowned by a truncated roof of irregular form. The wraparound porch with its dentilled frieze and attenuated Tuscan columns connects a projecting front bay with a similar bay on the north (side) elevation. Rear one story section with shed roof. Free Classic Queen Anne. Ca. 1900. (C)
65. 210. House. One-and-one-half story, asymmetrical house sheathed in clapboard and crowned by a steep hip roof. The street (west and south) elevations both feature multiple gables piercing the roof and small entry porches with simple round columns supporting a gable. Free Classic Queen Anne. Ca. 1910. (C)
66. 211. House. One story frame house covered in asbestos siding and topped by a gable roof. The deck of the front porch has been removed and now within the porch area the front doors open

**National Register of Historic Places
Inventory—Nomination Form**

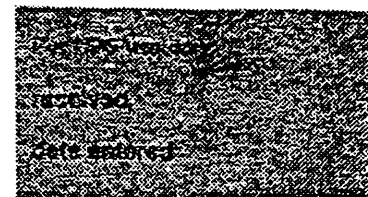

Continuation sheet S. Central Aberdeen Hist. Dist.,
Aberdeen MRA, Monroe Co., MS Item number 7

Page 12

onto a semicircular brick stoop. Ca. 1945. (NC)

67. 300. House. One-story, horizontally-oriented house with a side-gabled roof that is also veneered in brick. Ranch style. Ca. 1960. (NC)
68. 305. House. One-and-one-half story, three by three bay, eave-oriented house sheathed in clapboard. The full-width front porch has box columns supporting a gable set perpendicular to the main roof ridge. On the rear elevation is a shed-roofed addition and a porch. Bungalow. Ca. 1920. (C)
69. 307. House. One story, three by two bay house clad in shiplap and crowned by a hip roof with exposed rafter ends. The screened-in, front porch has a gable roof set perpendicular to the main roof ridge. Bungalow. Ca. 1925. (C)
70. 308. Hogan-Lann House. Two story, three bay wide, one room deep frame house sheathed in clapboard and horizontal beaded board and crowned by a low pitched hip roof. The full-width front porch exhibits panelled box columns on brick pedestals. Rear, one story frame section. Bungalow influence. Ca. 1900. (C)
71. 309. House. One-and-one-half story, three by three bay frame house clad in shiplap and capped by a side-gabled roof. The full width front porch has panelled box columns on brick pedestals supporting a huge gable set perpendicular to the main roof ridge. Bungalow. Ca. 1920. (C)
72. 310. House. One story frame house that sits on a brick foundation and has a gable roof. The gabled entry porch has arched openings. An exterior chimney flanks the entry porch. Ca. 1950. (NC)
73. 311. House. One-and-one-half story, three by three bay, clapboard house with a steep hip roof. A gabled wing extends out from the southern corner of the front facade and in the ell created by this wing is a porch with paired box columns. A breezeway in the rear connects the house to its garage. Ca. 1905. (C)

East Jefferson Street

74. 104. House. One story, four by two bay frame house with a side-gabled roof and a gabled wing on the eastern corner of the

3-NC 5-C

United States Department of the Interior
National Park ServiceNational Register of Historic Places
Inventory—Nomination FormS. Central Aberdeen Hist. Dist.,
Continuation sheet Aberdeen MRA; Monroe Co., MS Item number 7

Page 13

- front facade. The window in this bay is crowned by a heavily molded pedimented lintel with paired brackets. In the ell created by this wing is a porch with brick pedestals supporting wrought iron posts, obviously an alteration. The frontispiece located within the porch area consists of a single-leaf door, a transom with corner lights and sidelights with panelling beneath them. On the rear elevation are several sympathetic additions. Greek Revival/Italianate influence. Ca. 1875. (C)
75. 107. Griffin House. This two story, five by four bay, one room deep, frame house has a central hall plan and a side gabled roof with returns. The full-width front porch with its slender Tuscan columns and the centrally located balcony above it were probably part of a turn of the century remodelling. The balcony's gable is sheathed in imbricated shingles. On the rear elevation is a two story wing (probably an early addition), a one story addition and a small screened-in porch. Greek Revival. 1854. (C)
76. 201. Kirby Lann House. Asymmetrical one-and-one-half story, three by four bay house clad in horizontal beaded board. The wraparound porch on the street (north and west) elevations displays a wooden balustrade, turned posts with pierced corner brackets and a spindled frieze. A chamfered corner of the house within the porch area is marked by a large, single-light window with a stained glass transom. Each of the three main gables features a circular attic window and spindled scrollwork in its peak. Queen Anne. Ca. 1898. (C)
77. 204. House. One story, three bay wide, brick veneered house with low hip roof and aluminum sash windows. Ranch Style. Ca. 1960. (NC)
78. 205. House. One story, three bay wide, brick veneered house with a side gabled roof. The central, front door is located on a small stoop and crowned by an overdoor. Ca. 1955. (NC)
79. 206. House. One-and-one-half story, three by five bay, clapboard-sheathed house crowned by a pyramidal roof pierced by gables. At the west corner of the front facade is a gabled projecting bay. The wraparound front porch with its Tuscan columns begins here and extends around to the east elevation. The majority of the windows have heavily molded architrave lintels. Colonial Revival. Between 1905 and 1910. (C)
80. 208. Capt. P. A. Dulin House. One-and-one-half story,

2-NC 4-C

United States Department of the Interior
National Park Service

National Register of Historic Places
Inventory—Nomination Form

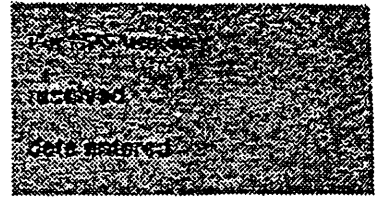

Continuation sheet S. Central Aberdeen Hist. Dist.,
Aberdeen MRA; Monroe Co. MS Item number 7

Page 14

asymmetrical, three by five bay house sheathed in clapboard and crowned by complex roof with numerous gables. The wraparound front porch has fluted Ionic columns and, on its side (east) elevation, a panelled frieze which is probably an alteration. The prominent front gable displays a sunburst motif in its peak. Free Classic Queen Anne. Ca. 1900. (C)

West Jefferson Street

81. 107. House. One story, three by three bay bungalow with a brick wall treatment and an unusual hip roof that extends out into a clipped gable at each of the house's four corners. The central, front bay contains a small stoop with new wrought iron posts supporting a clipped gable with a pent roof and attic window. On the side (west) elevation is a shouldered exterior brick chimney. Bungalow. Ca. 1925. (C)
82. 206. Elkin Family House. Two story, three by five bay frame house covered in aluminum siding and crowned by a truncated hip roof. The two tier, two bay wide front gallery has Tuscan columns and a balustrade and above it, piercing the main roof, is a gable. Originally, the second tier of the gallery had only a balustrade and no columns or roof. Colonial Revival. Ca. 1905. (C)
83. 205. House. One story, three bay wide, frame house covered in vinyl siding. The front porch's box columns support a gable set perpendicular to the main roof ridge. Gable-roofed addition to the rear. Bungalow. Ca. 1940. (NC)
84. 207. A. G. Boyd House. Two story, two by three bay, eave-oriented house clad in clapboard. The full-width front porch has stuccoed pedestals with battered box columns supporting the main roof. A gabled dormer dominates the front half of the roof. Bungalow. Ca. 1915. (C)
85. 301. House. One story, six bay wide, brick veneered house with a hip roof. On the rear elevation is a wing, a carport and an exterior chimney. Ranch style. Ca. 1965. (NC)
86. 302. House. Cross-gable roofed, one story, two by two bay, frame bungalow on stuccoed piers. The house has a gable-roofed, two bay wide front porch with stuccoed piers. Bungalow. Ca. 1920. (C)
87. 303. House. One story, four by four bay, gable-oriented

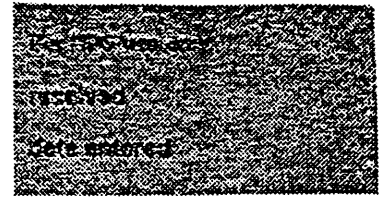
United States Department of the Interior
National Park ServiceNational Register of Historic Places
Inventory—Nomination Form

S. Central Aberdeen Hist. Dist.,

Continuation sheet Aberdeen MRA; Monroe Co., MS Item number 7

Page 15

- bungalow clad in shiplap. Its full-width front porch has pairs or trios of panelled box columns resting on brick pedestals and a gable over the entrance onto the porch. There is a gabled wing on the side (west) elevation. Bungalow. Ca. 1910. (C)
88. 306. House. Cross gable roofed, one story, two by three bay bungalow with a shiplap wall treatment, resting on a brick foundation of Flemish bond construction. The gable-roofed front porch has battered box columns on brick pedestals and a brick parapet. Bungalow. Ca. 1915. (C)
89. 309. House. One story, side-gabled house with a brick wall treatment. On the front facade, two gables are set perpendicular to the main roof ridge. The central, front door is flanked by a tripartite window and a large plate glass window. Ranch style. Ca. 1970. (NC)
90. 310. House. One story, three by three bay bungalow clad in shiplap and crowned by a low hip roof. The front porch features stuccoed pedestals with box columns supporting a gable roof. Bungalow. Ca. 1915. (C)
91. 402. John Sykes House. One story, three by two bay, eave-oriented house clad in clapboard with a rear shed-roofed addition covered in shiplap. Both side gables have an exterior brick chimney. The front, central portico has a gable roof set perpendicular to the main roof. Vernacular. Ca. 1880. (C)
92. 403. House. One-story, gable-oriented frame bungalow with a front, screened-in porch. The porch's gable roof is set off-center into the main gable. Bungalow. Ca. 1925. (C)
93. 404. Tom Sykes House. One-and-one-half story, three by three bay house covered in aluminum siding and crowned by a pyramidal roof with two interior brick chimneys. The wraparound front porch with its brick pedestals supporting box columns terminates at a polygonal bay on the east (side) elevation. Ca. 1900. (C)
94. 410. House. One story, four by three bay, gable-oriented house sheathed in shiplap. The full-width front porch has box columns supporting the front gable. Ca. 1900. (C)
95. 500. Old School House. One story, three by four bay, shiplap-clad house with a side-gabled roof. The house probably originally had a central hall, one room deep plan. Additions include a one-story, gable-roofed rear wing, a rear one story

United States Department of the Interior
National Park Service

**National Register of Historic Places
Inventory—Nomination Form**

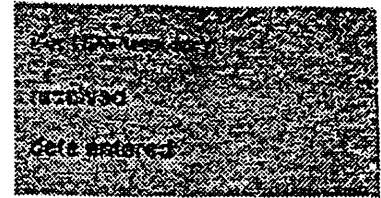

S. Central Aberdeen Hist. Dist.,

Continuation sheet Aberdeen MRA; Monroe Co., MS Item number 7

Page 16

addition with an attached carport, a sun porch on the west (side) elevation and a front porch with Craftsman style design elements. 1847/Ca. 1920. (C)

96. 502. House. One-and-one-half story, three by four bay, eave-oriented bungalow clad in shiplap. A large gable is set perpendicular to the main roof ridge and located within it is the two bay wide front porch with its own gable roof. Craftsman style. Ca. 1915. (C)
97. 504. House. One-and-one-half story, three by four bay, eave-oriented bungalow clad in shiplap. Its front facade is dominated by a full-width front porch and a gabled dormer. Craftsman style. Ca. 1915. (C)
98. 506. House. One story, three bay wide, eave-oriented house covered in composite board. Central front bay consists of a slightly projecting, gabled bay containing the front entrance and an exterior brick chimney. Ca. 1945. (NC)
99. 510. House. One-and-one-half story, three by three bay house with a complex gable roof and covered in aluminum siding. The front porch's box columns rest on brick pedestals and support a large gable set perpendicular to the main roof ridge. A new deck has been built on the rear elevation. Bungalow influence. Ca. 1915. (C)
100. 514. House. Asymmetrical, one-and-one-half story, three by six bay house covered in aluminum siding and crowned by a truncated hip roof pierced by gables. The house has a wraparound front porch with Doric columns and a side porch on the west elevation with new wooden posts (which are probably only temporary replacements). Free Classic Queen Anne. Ca. 1900. (C)
101. 511. House. One-and-one-half story, four by four bay, brick veneered house with a side-gabled roof. The stuccoed side gables feature half-timbering. The front facade is marked by two gable ends (one contains the entrance) with an exterior brick chimney between them. Tudor Revival. Ca. 1925. (C)
- 102a. 513. Clabe Kolb House. One story, three by three bay, stuccoed house with a flat roof and parapet. Below the parapet is a pent roof accented by paired modillions. The wraparound front porch features battered stuccoed piers. Pueblo Style. Ca. 1925. (C)
- 102b. 513. Garage. This one-car garage is similar in design and

United States Department of the Interior
National Park ServiceNational Register of Historic Places
Inventory—Nomination FormS. Central Aberdeen Hist. Dist.,
Continuation sheet Aberdeen MRA, Monroe Co., MS Item number 7

Page 17

materials to the main house. Pueblo Style. Ca. 1925. (C)

South Locust Street

103. 301. House. One story, five by three bay, frame cottage with side gables. The street (east and north) elevations have a full entablature with a dentilled frieze. The central front bay contains a portico with battered box columns supporting a pedimented gable. The entrance located within the portico area has been drastically altered. The sidelights and original transom have been removed. The slightly recessed, single-leaf entrance has a small transom. On the side (north) elevation a porch with metal posts and a pedimented gable has been added. The entrance located within the porch area is similar in treatment to the front porch. Greek Revival. Ca. 1845. (C)
104. 305. House. One-and-one-half story, three by two bay, clapboarded bungalow with a side-gabled roof. The front facade features an almost full-width front porch with box columns and a shed roof dormer with a bank of six-light windows. Bungalow. Ca. 1925. (C)

South Long Street

105. 300. The Presbyterian Manse. Two-and-one-half story, three by two bay, L-shaped frame house with a rear, one story wing and a gable roof. The front porch nestled in the ell of the house has broad, shallow, chamfered posts with capitals, scrollworked corner brackets, trefoil pendants and a frieze accented by paired scrollwork brackets. Many of the 2/2 double-hung sash windows have dog ear surrounds. Italianate. 1883. (C)
106. 303. D. W. Sadler House (Evergreen). One-and-one-half story, three by three bay, clapboarded house crowned by a low hip roof with a hip roofed dormer in front. The full-width, front gallery has panelled box columns. The central, front bay contains a single-leaf door with multi-light sidelights and a transom. This frontispiece is flanked by six/six double-hung sash windows with panelling beneath them and panelled surrounds with a circular motif in their top corner blocks. Greek Revival/Bungalow. 1848/Ca. 1910. (C)
107. 304. House. One-and-one-half story, hip roofed bungalowoid building whose front porch has been enclosed with shiplap and features two horizontal fixed windows. The front entrance is now recessed. Bungalowoid. (MN)

United States Department of the Interior
National Park Service

National Register of Historic Places
Inventory—Nomination Form

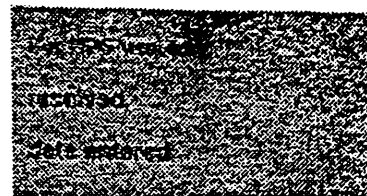

S. Central Aberdeen Hist. Dist.,
Continuation sheet Aberdeen MRA, Monroe Co., MS Item number 7

Page 18

108. 305. House. A roughly L-shaped, one-and-one-half story, five by six bay, brick-veneered house. Its complex roof consists of a truncated hip section and a gable-on-hip portion. The front gable end contains a single-leaf door with a sweeping hip roofed overdoor. An exterior brick chimney also marks the front facade. Tudor Revival influence. 1937. (C)
109. 306. House. One-and-one-half story, three bay wide, eave-oriented house covered in vinyl siding. Its front facade is dominated by a gabled dormer and a full-width porch with a stuccoed parapet and stuccoed piers supporting battered boxed columns. Bungalow. Ca. 1920. (C)
110. 400. House. Low, one-story, five bay wide, brick veneered house with a carport on its north elevation and a low hipped roof. Ranch style. Ca. 1970. (NC)
111. 401. House. One-and-one-half story, three by four bay bungalow rests on a stuccoed foundation and has a side-gabled roof with struts. The side gables and front shed roofed dormer are clad in imbricated shingles. The wraparound front porch has a balustrade connecting stuccoed pedestals with battered box columns. The classically inspired design of the frontispiece includes beveled glass sidelights, pilasters and a cornice. Bungalow. Ca. 1910. (C)
- 112a. 402. House. One-and-one-half story, eave-oriented, brick and frame house. A large gabled dormer with returns is located above the central portico. The porch's two Ionic capitals appear to have been shortened so that they now rest on a parapet of rusticated concrete block construction. The house appears to date from the mid-nineteenth century, but was altered in the early twentieth century. Greek Revival/Colonial Revival. Ca. 1870/Ca. 1905. (C)
- 112b. 402. Livery stable. A one story, frame building with a cross-gabled roof and, on the front facade, three boarded-up entrances. Vernacular. Ca. 1905. (C)
113. 403. John White-Capt. Harvey Fitts House (Carridale). One-and-one-half story, five by six bay, clapboard house with a truncated hip roof. Originally a central hall plan with one room on each side, the house was enlarged in the 1880's. During this renovation a gabled dormer was added to the front facade and porches with heavily molded square posts and pierced

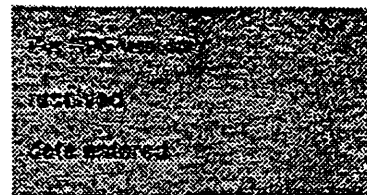
United States Department of the Interior
National Park ServiceNational Register of Historic Places
Inventory—Nomination Form

S. Central Aberdeen Hist. Dist.,

Continuation sheet Aberdeen MRA, Monroe Co., MS Item number 7

Page 19

- spandrels were added to the front and south (side) elevations. A large, rear addition added in the early 1980's connects the house to its original brick kitchen. Greek Revival/Italianate. 1845/Ca. 1885. (C)
114. 406. House. One-and-one-half story, three by five bay, clapboard house with a steep pyramidal roof pierced by gables. The front facade features a projecting gabled bay, a porch with Tuscan columns and a wooden balustrade which is not original. Free Classic Queen Anne. Ca. 1900. (C)
115. 407. House. One-and-one-half story, three bay wide bungalow clad in horizontal beaded board and crowned by a side-gabled roof with struts. The gables have imbricated shingles. The front facade is dominated by a shed-roofed dormer and a full-width front porch with a balustrade connecting brick pedestals supporting battered box columns. The classically inspired design of the frontispiece features pilasters and a dentilled cornice. Bungalow. Ca. 1915. (C)
116. 409. St. John's Rectory (The Old Rectory). Two-and-one-half story, three by three bay clapboard house with a complex roof. The wraparound front porch has new posts and its northernmost section has been enclosed in shiplap. On the south (side) elevation is a two-and-one-half story, projecting bay with chamfered corners. On the rear elevation is a two story and a one story wing. Vernacular. 1901. (C)
117. 503. House. One story, three bay, eave-oriented bungalow clad in shiplap. Its central front porch has box columns on brick pedestals supporting a clipped gable set perpendicular to the main roof ridge. Bungalow. Ca. 1920. (C)
118. 505. House. One-and-one-half story, three by three bay, frame house with a steep pyramidal roof pierced by gables. The front and side gables display imbricated shingles, a dentilled frieze and a rectangular louvred attic vent with an architraval lintel. The wraparound front porch has Doric columns and a dentilled frieze. Free Classic Queen Anne. Ca. 1895. (C)
119. 507. House. One-and-one-half story, four by five bay, clapboard house with a pyramidal roof pierced by gables. The side elevations are covered in aluminum siding. The wraparound front porch has fluted columns which are replacements for the original box columns. Part of the porch has been enclosed. Vernacular. Ca. 1895. (C)

**National Register of Historic Places
Inventory—Nomination Form**

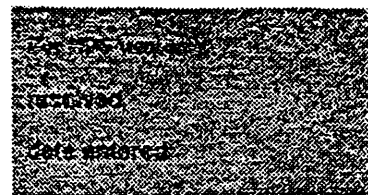

S. Central Abeydeen Hist. Dist.,
Continuation sheet Aberdeen MRA, Monroe Co., MS Item number 7

Page 20

120. 519. George T. Rather House (Wisteria). Two-and-one-half story, four by three bay, asymmetrical house with a shiplap wall treatment. The original hip roof was altered into a gambrel roof with a shed roof dormer. The gables of the projecting bays remain intact. The wraparound front features a balustrade, turned posts, a spindled frieze and a corner pavilion. Queen Anne. 1896. (P)

East Madison Street

121. 204. House. One-and-one-half story, five by two bay, eave-oriented house with a horizontal beaded board wall treatment. The front facade has a gabled dormer and a full-width porch with a balustrade and box columns resting on stuccoed pedestals. Bungalow. Between 1890 and 1894. (C)

West Madison Street

- 122-123. 106-108. Apartment Buildings. Two rectangular, one story, brick veneered apartment buildings. Ca. 1970. (NC)
124. 109. Madison-Whitfield Cottage. One story, five by two bay, clapboard house with a central second story room crowned by a low-pitched cross gable roof. The gables display returns and modillions. This room's front balcony has a balustrade. The front porch features chamfered posts with capitals, pierced spandrels and a dentilled frieze. The wall within the porch area is covered in horizontal flushboard. The windows and front door are capped by pedimented lintels. Italianate. 1866. (P)
125. 304. House. One story, gable-roofed shotgun clad in clapboard and asbestos siding. Two-bay wide, gable-roofed porch on the front facade. Vernacular. This building has been so drastically altered that it is difficult to accurately determine its date of construction. (NC)

South Maple Street

126. 203. House. One story, two by four bay, gable-oriented bungalow clad in narrow shiplap. The front porch has brick piers supporting its gable roof. Bungalow. Ca. 1915. (C)
127. 205. Joe Maxcy Insurance Office. One story, three by two bay, clapboard house with a gable roof. The front facade features a gabled projecting bay and a porch with wide but shallow posts

United States Department of the Interior
National Park ServiceNational Register of Historic Places
Inventory—Nomination FormS. Central Aberdeen Hist. Dist.,
Continuation sheet Aberdeen MRA, Monroe Co., MS Item number 7

Page 21

accented by sawn corner brackets. The house was originally roughly U-shaped on the rear but has had several one story additions. Vernacular. Ca. 1885. (C)

128. Northwest corner of Maple and Jefferson. National Bank of Commerce. One story, brick and glass building with a flat roof. The metal roof extends over the bank's drive-in windows on the north elevation and is supported on pierced brick piers. Ca. 1975. (I)
- 129a. 210. House. Asymmetrical, one story, three by three bay, clapboard cottage with a complex gable roof. The gables are clad in diagonal flushboard. A porch wraps around the street (west and south) elevations and features two sets of stairs with balustrades and newel posts, a balustrade connecting turned posts with corner brackets and a spindled frieze. Queen Anne. Ca. 1890. (C)
- 129b. 210. Outbuilding. Board-and-batten outbuilding with front and rear gables. Vernacular. Ca. 1890. (C)
130. 306. House. One-and-one-half story, three by three bay, clapboard house with a pyramidal roof pierced by gables. The wraparound front porch with its balustrade and fluted Doric columns connects a front projecting bay with a similar bay on the side (north) elevation. Colonial Revival. Between 1905 and 1910. (C)
131. 307. House. One story, three by four bay, shiplap house with a complex gable roof. The front facade displays a projecting gabled bay and a porch with a wood balustrade and brick pedestals supporting battered box columns. In the rear is a shed roofed section. Vernacular. Ca. 1910. (C)
132. 310. House. One-and-one-half story, four by three bay, clapboard house crowned by a hip roof pierced by gables. The gables of the projecting bays on the street (west and south) elevations each have a triad of large fixed windows in their peaks. These windows are an alteration. The projecting bays are connected by a wraparound porch with Ionic columns and engaged columns supporting a plain frieze. This porch has been partially enclosed on the south elevation. Colonial Revival. Between 1905 and 1910. (C)
133. 311. House. One-and-one-half story, four by two bay, clapboard house with a multi-gable roof. The wraparound front porch

National Register of Historic Places
Inventory—Nomination Form



S. Central Aberdeen Hist. Dist.,
Continuation sheet Aberdeen MRA, Monroe Co., MS Item number 7

Page 22

features a wood balustrade and turned posts with decorative corner brackets. Queen Anne. Ca. 1890. (C)

South Meridian Street

134. 207. House. One story, three by three bay, brick veneered bungalow with a side-gabled roof. The two-bay wide front porch has battered box columns on brick pedestals supporting a gable roof set perpendicular to the main roof ridge. A porte-cochere extends from the north (side) elevation and has the same treatment as the front porch. Bungalow. Ca. 1925. (C)
135. 210. House. One-and-one-half story, four by three bay, L-shaped cottage with a pyramidal roof pierced by multiple gables. The house is sheathed in horizontal beaded board. The wraparound front porch with its chamfered turned posts connects two projecting gabled bays. Many of the gables display decorative bargeboard in their peaks. Queen Anne. Ca. 1900. (C)
136. 211. Mississippi Mutual Burial Association, Inc. One story, three by three bay, eave-oriented bungalow clad in shiplap. Central front portico has battered box columns supporting a gable set perpendicular to the main roof ridge. The columns rest on brick parapet walls. Bungalow. Ca. 1920. (C)
137. 300. House. Two story, picturesquely massed, shiplap house crowned by a hip roof pierced by gables. The roof is clad in metal shingles and also retains its cresting. The wraparound front porch has box columns and is partially enclosed on the south elevation. On the rear elevation is a two story sleeping porch, also partially enclosed. Colonial Revival. Ca. 1905. (C)
138. 301. Scuppernong. One-and-one-half story, four bay wide, eave-oriented, frame house with a gabled projecting bay on the front facade and a gabled wing on the rear elevation. The gables display delicate-pierced bargeboard. The front porch features octagonal columns with bases and fluted molded caps and pierced spandrels. The porch ceiling is panelled and the wall within the porch area is clad in horizontal flushboard. The front entrance consists of a panelled Italianate style door with scroll brackets, a transom and sidelights of etched Bohemian glass. This entrance and many of the windows have drip molds. On the side elevations are one story, three-sided bays topped by wood parapets incised with a Gothic motif. The north elevation

United States Department of the Interior
National Park Service

National Register of Historic Places
Inventory—Nomination Form



S. Central Aberdeen Hist. Dist.,

Continuation sheet Aberdeen MRA, Monroe Co., MS Item number 7

Page 23

also has a porch simpler in treatment than the front porch. The house was extensively remodelled in the 1870's, especially on the east (front) facade. The house is currently undergoing a sensitive renovation after a 1985 fire. Most of the damage was confined to the rear wing. Gothic Revival. 1842/Ca. 1875. (P)

139. 304. House. One story, three by four bay, clapboard house crowned by a truncated hip roof pierced by gables. The wraparound front porch, which connects the front, gabled, projecting bay with a similar bay on the north (side) elevation, features fluted Corinthian columns and a dentilled frieze. Free Classic Queen Anne. Ca. 1905. (C)
140. 306. House. One-and-one-half story, frame, hip roofed house that has been brick veneered. Wraparound front porch has aluminum columns. The front gabled dormer has had its window blocked up with plywood. Queen Anne. Ca. 1905/1980? (NC)
141. 310. House. Essentially an L-shaped, one story, clapboard house with a gable roof. The front facade features a projecting gabled bay and a porch with brick pedestals supporting paired box columns. The porch extends beyond the house to create a porte-cochere. Bungalow. Ca. 1900. (C)
142. 311. N. H. Maxwell House. Asymmetrical, one-and-one-half story, five by five bay, clapboard house capped by a pyramidal roof pierced by multiple gables. The wraparound front porch has Tuscan columns and, over its steps, a pedimented gable with imbricated shingles. Free Classic Queen Anne. Between 1905 and 1910. (C)
143. 400. House. One-and-one-half story, six by five bay house covered in aluminum siding and crowned by a pyramidal roof. The pavilion on the northwest corner of the house has a three foot high cast iron finial. The wraparound front porch has a pierced parapet and piers made of rusticated concrete block. Bungalow influence. Ca. 1910. (MN)
- 144a. 401. Charlie Haughton House. One-and-one-half story, three by three bay, gable-oriented brick bungalow with clipped gables. The porch's box columns, which rest on brick pedestals, also support a clipped gable. The gables are stuccoed with half-timbering and exposed purlins. The frontispiece and the upper sashes of many of the windows are in the Craftsman style. Bungalow. Ca. 1928. (C)

United States Department of the Interior
National Park Service



National Register of Historic Places
Inventory—Nomination Form

Continuation sheet S. Central Aberdeen Hist. Dist.,
Aberdeen MRA, Monroe Co., MS Item number 7 Page 24

- 144b. 401. Garage. One story brick garage with side clipped gables that are stuccoed. Craftsman style. Ca. 1928. (C)
145. 406. House. One story, three by three bay, shiplap cottage with a gable roof. One the front facade is a projecting gabled bay and a wraparound porch with a balustrade and turned posts. On the rear elevation is a wing added ca. 1930. Queen Anne. Ca. 1895. (C)
146. 407. Old Hale House (Rosemont). Two-and-one-half story, four by three bay, shiplap house crowned by a hip roof pierced by gables. The wraparound front porch features a rusticated block foundation and pedestals which support fluted Ionic columns. A wooden balustrade connects the pedestals. Above the steps leading to the porch, the porch roof is accented by a low gable with imbricated shingles. Above this gable is a gabled balcony similar in treatment to the porch. Neo-Classical. 1907. (C)
147. 409. Tannery. Two-and-one-half story, clapboard house crowned by a hip and gable roof. The front facade has a two-and-one-half story gabled projecting bay with a semi-hexagonal one story bay and imbricated shingles in its gable. The wraparound front porch has box columns and a sawn balustrade with a molded handrail. This balustrade is a fairly recent alteration. The multi-gabled, full-width extension on the rear of the house appears to be slightly later in date. Queen Anne. Between 1905 and 1910. (C)
148. 410. Mary Frances Gregg House (Gregg-Hamilton). One-and-one-half story, five by four bay clapboard house with a side gable roof. The full-width front porch was altered in the early twentieth century. It now has battered box columns resting on brick pedestals, but still retains its heavily arched soffits. Within the porch area, the frontispiece consists of Italianate style double doors (these were probably an early alteration as it appears a transom was removed to accommodate them) and sidelights. The heavily molded door architrave has a pronounced semi-pedimented cornice capped by piecework volute carvings. The front, first floor windows have the same type of moldings. The front facade's frieze is accented by paired brackets interspaced by lozenge-shaped windows. Each of the side gables features two oval windows. The rear porch is obscured by a shed-roofed, full-width addition. Attached to the northeast corner of the house is a small hipped roof building. Italianate/Gothic Revival influence. Ca. 1850. (P)

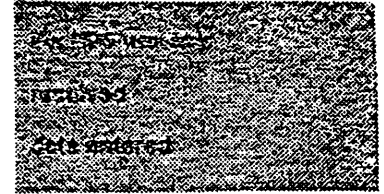
United States Department of the Interior
National Park ServiceNational Register of Historic Places
Inventory—Nomination FormS. Central Aberdeen Hist. Dist.,
Continuation sheet Aberdeen MRA, Monroe Co., MS Item number 7

Page 25

149. 501. Felix G. Henley House (Carrington). One story, three bay wide clapboard cottage resting on a raised basement and crowned by a side gable roof. The central front bay contains a portico with box columns supporting a gable set perpendicular to the main roof ridge. There is a rear addition and, on the north elevation, a latticed one-bay side porch. Greek Revival. 1855. (C)

East Monroe Street

150. 103. House. One story, brick and frame bungalow with a multi-gabled roof. The front porch extends beyond the west elevation and has battered box columns on brick pedestals and a wood balustrade. A redwood deck was added to the side (east) elevation. Some rear windows were bricked up when a rear wing was added. Bungalow. Ca. 1920. (C)
151. 105. Louis Roy House (Serendipity). Asymmetrical, one-and-one-half story, five by three bay, frame house with a side gable roof. According to local tradition, the eastern section was the original house and the western section was added to it in 1874. The wraparound front porch features Italianate style columns and scrollwork corner brackets. The large tower that rose above the front entrance was destroyed and replaced by a gable. Italianate influence. Antebellum/1874. (P)

West Monroe Street

152. 104. Mother Goose Day Care. One story, five bay wide, eave-oriented cottage covered in asbestos siding. Ca. 1945. (NC)
153. 105. House. One-and-one-half story, three by two bay, clapboard house with a pyramidal roof pierced by a projecting gabled bay at its northwest corner. The front porch features battered box columns on brick pedestals. Craftsman style influence. Ca. 1910. (C)
154. 106. House. One-and-one-half story, three by three bay, eave-oriented bungalow clad in shiplap. The porch's brick pedestals and trios of box columns support a gable roof set perpendicular to the main roof ridge. Bungalow. Ca. 1915. (C)
155. 107. T. M. McDuffie House. One-and-one-half story, two by four bay, clapboard house crowned by a truncated hip roof. A wraparound front porch with Tuscan columns and a wood balustrade

National Register of Historic Places
Inventory—Nomination Form



S. Central Aberdeen Hist. Dist.,

Continuation sheet Aberdeen MRA, Monroe Co., MS Item number 7

Page 26

connects the front gabled projecting bay to a similar one on the side (east) elevation. Colonial Revival. Ca. 1905. (C)

156. 210. House. One story, three by three bay, gable-oriented, shiplap bungalow. The front porch's gable roof is set into the main front gable and is supported by paired box columns on brick pedestals. Bungalow. Ca. 1915. (C)
157. 301. House. One-and-one-half story, four by three bay, asymmetrical house clad in horizontal beaded board and clapboard and capped by a truncated hip roof. On the northwest corner of the house is a polygonal, two story tower with a conical roof and a finial. The wraparound front porch, with its attenuated Tuscan columns and balustrade runs from this tower to a projecting one story bay on the side (east) elevation. The porch is currently being renovated. The porch roof is pierced by a small gable displaying the sunburst motif. Free Classic Queen Anne. Ca. 1895. (C)
158. 404. House. One-and-one-half story, three by three bay, eave-oriented bungalow. The house is clad in average-width clapboard up to the continuous sills of the first story windows and in narrower clapboard above these sills. The front facade is dominated by a gabled dormer and a full-width front porch with a wooden balustrade and brick pedestals supporting box columns. Bungalow. Ca. 1915. (C)
159. 501. Crestwood. Two-and-one-half story, three by three bay, irregularly massed house clad in horizontal beaded board and crowned by a hip roof pierced by gabled dormers. The wraparound front porch exhibits a wooden balustrade and panelled wooden pedestals supporting paired attenuated columns. Towards the rear of the east (side) elevation, a gable-roofed wing was added to the house. Free Classic Queen Anne. 1894. (C)
- 160-161. Southeast corner of Monroe and Eckford. Fourplex. Two four-apartment units that have brick veneers and gable roofs. Ca. 1970. (NC)
162. 502. House. One story, brick-veneered, eave-oriented house with side clipped gables. A carport with wrought iron posts extends out from the front facade. Ca. 1955. (NC)
163. 510. House. One story, five by three bay, clapboard bungalow with side clipped gables. The full width front porch features a pierced brick parapet wall and brick pedestals with either

National Register of Historic Places
Inventory—Nomination Form

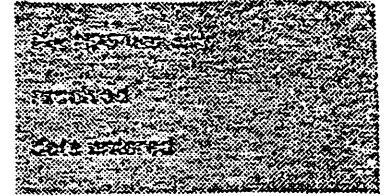

S. Central Aberdeen Hist. Dist.,

Continuation sheet Aberdeen MRA, Monroe Co., MS Item number 7

Page 27

paired columns or a triad of columns supporting a low-pitched gable roof set perpendicular to the main roof ridge. Bungalow. Ca. 1910. (C)

164. 512. House. One story, brick and frame building with a side gable roof. An attached carport is on the side (west) elevation. Ranch style. Ca. 1965. (NC)
165. 513. House. One-and-one-half story, three by three bay, horizontal beaded board cottage crowned by a pyramidal roof pierced by a front gable. The bungalow style porch with its rusticated concrete block pedestals supporting paired columns is a 1920's alteration. The rear sun porch was probably also added at this time. Queen Anne influence. Ca. 1895/Ca. 1920-1922. (C)
166. 514. House. One story, three bay wide, eave-oriented cottage covered in asbestos siding with a central front porch. Ca. 1955. (NC)
167. 515. House. One-and-one-half story, asymmetrical, four by four bay, frame house crowned by a pyramidal roof that is pierced by gables. In the early 1930's, the front porch was altered so that it now features a plain balustrade and brick pedestals with paired box columns. Queen Anne influence. Ca. 1905/Ca. 1930. (C)
168. 516. House. One-and-one-half story, brick veneered house with a side gable roof and, on its side (east) elevation, an attached carport. Ranch style. Ca. 1965. (NC)
169. 519. Parson Gunn House. One story, five by six bay, clapboard house with a low hip roof covered in seamed tin. The central front bay contains a portico which has box columns supporting a pedimented gable. Apparently, the house originally had a central hall plan with one room on each side, but early gabled additions set perpendicular to the facade have created the house's current square shape. Each side elevation has a porch--the eastern one is Italianate in design, while the western porch is of the Queen Anne style. Greek Revival. 1848. (P)
170. 520. House. Two story, five by three bay house covered in clapboard and capped by a low-pitched hip roof. The central, front porch features Tuscan columns, as does the side (west) porch. The front entrance has been altered. On the east

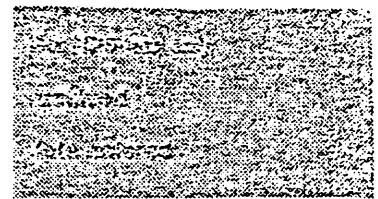

National Register of Historic Places Inventory—Nomination Form

S. Central Aberdeen Hist. Dist.,
Continuation sheet Aberdeen MRA, Monroe Co., MS Item number 7

Page 28

elevation are two one-story sections with steep hip roofs. Originally, this house faced Franklin Street. Free Classic Queen Anne. Ca. 1900. (MN)

West Washington Street

- 171a. 209. Charles Roy-G. H. Watkins House (Greenleaves). Asymmetrical, two-and-one-half story, four by four bay, clapboard house with a truncated hip roof pierced by gables. The wraparound front gallery features chamfered posts with simple capitals and scrollwork corner brackets and paired brackets along the frieze. A balustrade accents the second story of the gallery. The gallery extends beyond the west (side) elevation to create a porte-cochere. The two-and-one-half story projecting bays on the front and side (west) elevations are similar in treatment with a multi-sided, one story bay; diagonal, tongue-and-groove, beaded board panelling; and a pedimented gable. There are two sympathetic rear additions. A bracketed cornice encircles the house. The roof has been altered and now has a shed roof dormer. Italianate influence. 1883. (P)
- 171b. 209. Playhouse. This one story, frame building is similar in design and materials to the main house. Italianate influence. Ca. 1930-1935. (C)
172. 309. House. Two story, three by three bay house constructed of rusticated concrete block and crowned by a gambrel roof with front and rear gables. On the sides the roof is pierced by hip roof dormers. The central front bay contains a semicircular portico with a rusticated concrete block parapet supporting attenuated wooden Ionic columns and a full entablature. Dutch Colonial Revival. Ca. 1915. (C)

Nominated Properties

1 district

1-NC 3-C

Contributing Elements

144 buildings

142

35-NC

United States Department of the Interior
National Park Service

National Register of Historic Places
Inventory—Nomination Form



S. Central Aberdeen Hist. Dist.,
Continuation sheet Aberdeen MRA, Monroe Co., MS Item number

7

Page

29

The properties included within this district have been rated as contributing or non-contributing according to the following rating system:

Contributing Elements

- P - Pivotally Contributing - These properties are of major importance in establishing the character of the district, and would be individually eligible for the National Register if they were not elements of a district.
- C - Contributing - These properties date from the period of significance of the district and possess sufficient integrity to contribute appreciably to its sense of time and place or its architectural or thematic character.

Non-Contributing Elements

- MN - Marginally Non-Contributing - These properties date from the period of significance of the district but have suffered substantial and irreversible impairments to their integrity. They are considered non-contributing in their present state.
- NC - Non-Contributing - These properties do not contribute to the character of the district because their architectural character dates from later than the period of significance of the district or, in the case of a thematically-defined district, they do not contribute to the district's thematic character. Although these properties do not contribute to the district, they are nonetheless relatively compatible with the rest of the district in terms of scale, materials, massing, and setting.
- I - Intrusive - These properties disrupt the visual cohesiveness of the district by being incompatible in design, scale, materials, massing, and/or setting.

8. Significance

Period	Areas of Significance—Check and justify below			
<input type="checkbox"/> prehistoric	<input type="checkbox"/> archeology-prehistoric	<input type="checkbox"/> community planning	<input type="checkbox"/> landscape architecture	<input type="checkbox"/> religion
<input type="checkbox"/> 1400-1499	<input type="checkbox"/> archeology-historic	<input type="checkbox"/> conservation	<input type="checkbox"/> law	<input type="checkbox"/> science
<input type="checkbox"/> 1500-1599	<input type="checkbox"/> agriculture	<input type="checkbox"/> economics	<input type="checkbox"/> literature	<input type="checkbox"/> sculpture
<input type="checkbox"/> 1600-1699	<input checked="" type="checkbox"/> architecture	<input type="checkbox"/> education	<input type="checkbox"/> military	<input type="checkbox"/> social/ humanitarian
<input type="checkbox"/> 1700-1799	<input type="checkbox"/> art	<input type="checkbox"/> engineering	<input type="checkbox"/> music	<input type="checkbox"/> theater
<input checked="" type="checkbox"/> 1800-1899	<input type="checkbox"/> commerce	<input checked="" type="checkbox"/> exploration/settlement	<input type="checkbox"/> philosophy	<input type="checkbox"/> transportation
<input checked="" type="checkbox"/> 1900-	<input type="checkbox"/> communications	<input type="checkbox"/> industry	<input type="checkbox"/> politics/government	<input checked="" type="checkbox"/> other (specify) (black history)
		<input type="checkbox"/> invention		

Specific dates 1848 - ca. 1930 Builder/Architect N/A

Statement of Significance (in one paragraph)

The South Central Aberdeen Historic District is eligible for the National Register under Criteria A & C. The historic district is significant in the areas of exploration/settlement, architecture and black history.

Clearly delineated within the district's borders is the boundary (Meridian Street) between the plat of Old Aberdeen laid out by Robert Gordon and that of New Aberdeen developed by the Hamilton Syndicate. That boundary was dissolved when the two Aberdeens were incorporated into a single town on May 12, 1837. Nevertheless, the topography of the eastern portion of this district still reveals the initial development patterns of the two distinct communities.

The construction dates of the significant elements within this district extend from 1848 to c. 1930. These houses illustrate the architectural styles that were popular during Aberdeen's two greatest periods of prosperity -- the late 1840's to 1850's and ca. 1880 to ca. 1930.

Several architecturally significant houses from Aberdeen's antebellum "flush times" still remain. The Parson Gunn House (519 W. Monroe) and the Felix G. Henley House (501 S. Meridian) are typical of the central hall plan Greek Revival cottages with porticoes being constructed in Aberdeen during this period. The Gregg-Hamilton House (410 S. Meridian) is an unusual example of mid-nineteenth century eclecticism expressed in the planter's cottage house form. The Griffin House (107 E. Jefferson) is Aberdeen's only extant example of an I-house known to date.

Along S. Franklin Street is the town's finest collection of late nineteenth and early twentieth century houses in terms of integrity, quality of design and variety of architectural styles. Local tradition holds that this street became known as Silk Stocking Row in the late nineteenth century because of the upper middle class residential development occurring here at that time. Other architecturally significant houses from this time period are scattered throughout the district.

In the early twentieth century, the bungalow was a popular house type in Aberdeen and many examples are still extant in the South Central Aberdeen Historic District. Early twentieth century revival styles -- Dutch Colonial Revival, Tudor Revival and Swiss Chateau -- are also represented in the district.

Another significant development that occurred in this historic district was the growth of a black middle-class neighborhood centered around the intersection of W. Jefferson and S. Columbus Streets. After the Civil War, the former slave Windsor Reynolds acquired the

United States Department of the Interior
National Park Service

National Register of Historic Places
Inventory—Nomination Form



Continuation sheet S. Central Aberdeen Hist. Dist.,
Aberdeen MRA, Monroe Co., MS Item number 8

Page 1

city block bounded by Jefferson, Long, Washington and Columbus Streets. He and his wife, Ann, subdivided the land into lots and sold them to black people. Other blacks built homes on Columbus between Jefferson and Madison Streets. Generally, these blacks were successful businessmen who provided necessary goods and services to their people. The buildings which housed their shops and businesses, as far as can be determined at this time, are either non-extant or have not retained their architectural integrity.

Little is known about Aberdeen's black neighborhoods at the turn of the century. Besides the one included in this district, others were located to the north around Vine Street, to the south around Chaffie, Burnett and Forrest Streets and also where Jackson Street intersects Chestnut and Locust Streets. More distinct boundaries cannot be determined at this time. These areas were surveyed, but no architecturally significant structures remain. Although the neighborhood centered around Jefferson and Columbus Streets is now predominantly white, it retains the most intact cluster of turn-of-the-century residences for middle-class blacks to be found anywhere in the town (Miriam Sykes Henley, daughter of local black merchant Tom Sykes, interviewed by Susan Enzweiler, architectural historian with the Mississippi Department of Archives and History, Jackson at Aberdeen, Miss., Dec. 17, 1986; Sam Crawford, Something Good About the Thirties. [Aberdeen: Allmond Printing Co., 1983], pp. 237-239 and John Rodabough, Scrapbook of local history articles from The Aberdeen Examiner located in Evans Memorial Library, Aberdeen).

10. Geographical Data

Acreeage of nominated property approx. 150 acres

Quadrangle name Aberdeen MS

Quadrangle scale 1:24000

UTM References

N ^A	1 6	3 5 6 3 3 5	3 7 4 3 6 7 0
Zone	Easting	Northing	
P ^B	1 6	3 5 6 6 6 5	3 7 4 3 4 8 0
R ^B	1 6	3 5 7 4 2 0	3 7 4 3 5 5 0
T ^B	1 6	3 5 6 3 0 5	3 7 4 2 9 1 0

O ^B	1 6	3 5 6 5 4 0	3 7 4 3 6 7 0
Zone	Easting	Northing	
Q ^B	1 6	3 5 6 9 4 0	3 7 4 3 6 1 0
S ^B	1 6	3 5 7 2 6 0	3 7 4 2 8 9 0
U ^B			

Verbal boundary description and justification

SEE CONTINUATION SHEET

List all states and counties for properties overlapping state or county boundaries

state	N/A	code	county	code
state		code	county	code

11. Form Prepared By

name/title Susan M. Enzweiler - Architectural Historian

organization Mississippi Dept. of Archives and History date September 1987

street & number P. O. Box 571 telephone (601) 354-7326

city or town Jackson state MS 39205

12. State Historic Preservation Officer Certification

The evaluated significance of this property within the state is:

national state local

As the designated State Historic Preservation Officer for the National Historic Preservation Act of 1966 (Public Law 89-665), I hereby nominate this property for inclusion in the National Register and certify that it has been evaluated according to the criteria and procedures set forth by the National Park Service.

State Historic Preservation Officer signature Kenneth H. P. Pool

title Deputy State Historic Preservation Officer date January 6, 1988

For NPS use only

I hereby certify that this property is included in the National Register

date

Keeper of the National Register

Attest:

date

Chief of Registration

**National Register of Historic Places
Inventory—Nomination Form**

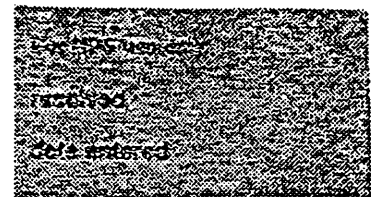

S. Central Aberdeen Hist. Dist.
Continuation sheet Aberdeen MRA; Monroe Co., MS Item number 10

Page 1

The district boundary begins at the northwest corner of the property at 102 S. Franklin and proceeds to the northeast corner of the property at 205 S. Franklin where it follows the northern edge of this property and then turns south and runs along the west (rear) property lines of the houses on the west side of S. Franklin Street. At High Street, the boundary turns east for approximately 190 feet and, at the intersection of High and Franklin, it runs south down the latter street for about two hundred feet and turns east. The district boundary then follows the southern (rear) property lines of the houses on the south side of High Street until it reaches Columbus Street where the boundary heads north until it reaches the intersection of Columbus and High Streets. Here the boundary backtracks west down High Street and then proceeds north up Long Street to the intersection of Long and Monroe where it runs east over Monroe for one block. The district boundary turns south at the intersection of Monroe and Columbus, wraps around the southern and eastern property lines of 500 S. Columbus Street, then proceeds northwesterly back to Columbus Street and heads north up this street until it reaches 400 S. Columbus Street. The boundary wraps around the southern and eastern lines of this property, then runs east over Madison to James Street, heads south down James Street and at the junction of James and Monroe, the boundary turns southwesterly until it reaches the northwest corner of Parcel 108-J-34-025-002. It travels south of the western edge of this property for about 150 feet, then heads due east and subsequently follows the eastern property line north, crosses Monroe Street and proceeds north along the eastern property line of 210 Monroe Street. At the northeast corner of this property, the district boundary heads due east, reaches Hickory Street and travels south through the intersection of Hickory and Monroe Streets. Approximately 75 feet south of the northwest corner of the property at 500 S. Hickory Street, the district boundary turns east and follows the southern property lines of 107 and 105 W. Monroe, 501 S. Meridian (crosses Meridian Street), and 103 and 105 E. Monroe Street. The boundary proceeds north along the eastern property line of 105 E. Monroe Street, continues northeasterly up Maple Street and then heads west along the southern edge of the property at 403 Maple Street. The boundary then continues northeasterly along the western property lines of 403 Maple Street and 103 Madison Street. Upon reaching Madison Street, the boundary heads southeasterly for about one block and then turns northeasterly up Locust Street for approximately one-and-one-half blocks. It then heads west following the northern property lines of the houses on the north side of Jefferson. At Maple

**National Register of Historic Places
Inventory—Nomination Form**



S. Central Aberdeen Hist. Dist.
Continuation sheet Aberdeen MRA; Monroe Co., MS Item number 9, 10

Page 1, 2

Street, the district boundary heads northwesterly to the northeast corner of 203 S. Maple Street. It wraps around the northern and western perimeters of this property, the western property line of 205 S. Maple Street and the northern edges of 104 E. Jefferson and 210 S. Meridian Streets. The boundary crosses Meridian Street and follows the northern, western and southern perimeters of 207 S. Meridian to the western property line of 211 Meridian Street. The boundary continues south on this property line and when it reaches Jefferson Street turns west. At the intersection of Jefferson and Hickory, the district boundary extends northwesterly to include 209 W. Washington Street and St. Francis of Assisi Catholic Church on the northeast corner of James and Washington within the district. The boundary continues south down James Street, then west along the northern property lines of 209 S. James Street and 302 W. Jefferson Street. At the northwest corner of 302 W. Jefferson the boundary heads north and wraps around the eastern, northern and western boundaries of 309 W. Washington Street to the northeast corner of the property at 310 Jefferson Street. The boundary heads west along the northern edge of this property, then turns south down Columbus Street to the intersection of Columbus and Jefferson Streets. From this point the district boundary meanders northwesterly generally following the city ditch. At the northeast corner of 206 S. Franklin, the district boundary heads north and then turns west, following the northern property line of 102 S. Franklin Street until it reaches the point of beginning.

#9 MAJOR BIBLIOGRAPHICAL REFERENCES

Crawford, Sam. Something Good About The Thirties. Aberdeen: Allmond Printing Co., 1983.

Henley, Miriam Sykes, daughter of local black merchant, Tom Sykes. Interviewed by Susan Enzweiler, architectural historian with the Mississippi Department of Archives and History, Jackson at Aberdeen, Miss., Dec. 17, 1986.

Rodabough, John. Scrapbook of local history articles from The Aberdeen Examiner located in Evans Memorial Library, Aberdeen.

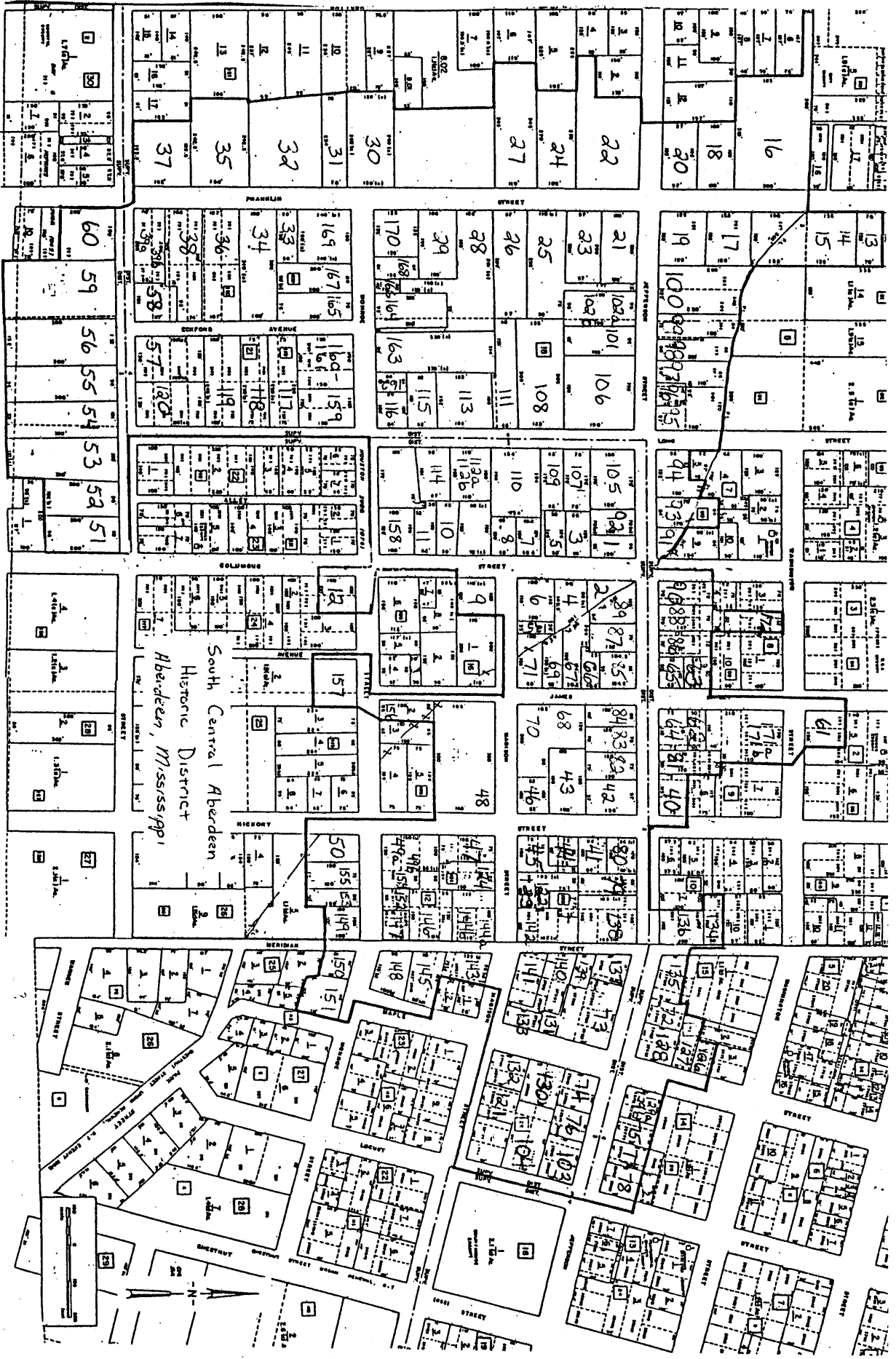

South Central Aberdeen
Historic District
Aberdeen, Mississippi

