

United States Department of the Interior
National Park Service

National Register of Historic Places
Registration Form

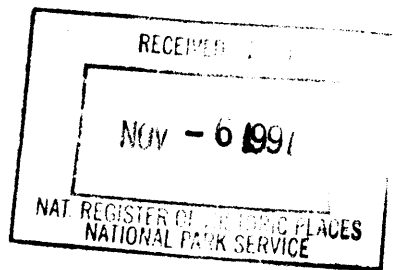

1519

This form is for use in nominating or requesting determinations for individual properties and districts. See instructions in *How to Complete the National Register of Historic Places Registration Form* (National Register Bulletin 16A). Complete each item by marking "x" in the appropriate box or by entering the information requested. If an item does not apply to the property being documented, enter "N/A" for "not applicable." For functions, architectural classification, materials, and areas of significance, enter only categories and subcategories from the instructions. Place additional entries and narrative items on continuation sheets (NPS Form 10-900a). Use a typewriter, word processor, or computer, to complete all items.

1. Name of Property

historic name Watkins House

other names/site number _____

2. Location

street & number 109 North College N/A not for publication

city or town Minden N/A vicinity

state Louisiana code LA county Webster code 119 zip code 71055

3. State/Federal Agency Certification

As the designated authority under the National Historic Preservation Act, as amended, I hereby certify that this nomination request for determination of eligibility meets the documentation standards for registering properties in the National Register of Historic Places and meets the procedural and professional requirements set forth in 36 CFR Part 60. In my opinion, the property meets does not meet the National Register criteria. I recommend that this property be considered significant nationally statewide locally. (See continuation sheet for additional comments.)

Jonathan Fricker 10/30/97
Signature of certifying official/Title Jonathan Fricker, Deputy SHPO, Dept of Culture, Recreation and Tourism Date
State of Federal agency and bureau _____

In my opinion, the property meets does not meet the National Register criteria. (See continuation sheet for additional comments.)

Signature of commenting official/Title Date

State or Federal agency and bureau

4. National Park Service Certification

I hereby certify that the property is:

- entered in the National Register. See continuation sheet.
- determined eligible for the National Register See continuation sheet.
- determined not eligible for the National Register.
- removed from the National Register.
- other, (explain:) _____

Edson H. Beall
Signature of the Keeper

Date of Action

12/8/97

Watkins House

Name of Property

Webster Parish, LA

County and State

5. Classification

Ownership of Property

(Check as many boxes as apply)

- private
- public-local
- public-State
- public-Federal

Category of Property

(Check only one box)

- building(s)
- district
- site
- structure
- object

Number of Resources within Property

(Do not include previously listed resources in the count.)

Contributing	Noncontributing	
_____	_____	buildings
_____	_____	sites
_____	_____	structures
_____	_____	objects
1	0	Total

Name of related multiple property listing

(Enter "N/A" if property is not part of a multiple property listing.)

N/A

Number of contributing resources previously listed in the National Register

0

6. Function or Use

Historic Functions

(Enter categories from instructions)

Domestic - Single Dwelling

Current Functions

(Enter categories from instructions)

Domestic - Single Dwelling

7. Description

Architectural Classification

(Enter categories from instructions)

Colonial Revival

Queen Anne Revival

Materials

(Enter categories from instructions)

foundation concrete

walls brick

roof asphalt

other

Narrative Description

(Describe the historic and current condition of the property on one or more continuation sheets.)

**United States Department of the Interior
National Park Service**

**National Register of Historic Places
Continuation Sheet**

Watkins House, Webster Parish, LA

Section number 7 Page 1

The Watkins House (c. 1903) is a large two-story brick home with a one-story section at the rear. Stylistically, the home combines elements of the Queen Anne and Colonial Revival. It stands on a large corner lot in a residential neighborhood within the Webster Parish seat of Minden. Although the house has received some alterations since construction, it remains eligible for National Register listing.

The Watkins House illustrates the turn-of-the-century tendency of architects and builders to combine elements of different styles. Characteristics of the Queen Anne found in the building include an asymmetrical footprint incorporating two projecting bays, a circular turret (interestingly enough, constructed without the usual conical shaped roof), and textured surfaces on the home's brick walls. These surfaces include several brick belt courses and panels of protruding bricks located on the home's front facing bay. Elements of the Colonial Revival style seen in the Watkins House include:

- 1) a portico with colossal Tuscan columns, a pediment with a raking cornice, an entablature with a modillion cornice, and an oculus,
- 2) additional gables treated as pediments with raking modillion cornices and oculi filled by leaded glass,
- 3) the extension of the portico's entablature and modillion cornice to encircle the house,
- 4) a two-story side porch featuring colossal columns and a Colonial Revival balustrade on the second level, as well as an additional balcony and porch balustrades in the Colonial Revival style on the facade, and
- 5) a front door and Colonial Revival mantel articulated in the manner of the Adam style.

In addition to its Queen Anne and Colonial Revival motifs, the Watkins House exhibits a number of other period architectural details. These include:

- 1) segmentally arched windows and doors suggestive of the Italianate style.

CONTINUED

**United States Department of the Interior
National Park Service**

**National Register of Historic Places
Continuation Sheet**

Watkins House, Webster Parish, LA

Section number 7 Page 2

- 2) two elaborate heavily sculpted mantels with overmantels which present an overall Jacobean flavor. In addition, one of the mantels has an impressive bas relief design incorporated into its surround.
- 3) two sets of pocket doors.
- 4) a winder stair featuring paneling on its lower levels and a beaded board wainscot at higher levels.
- 5) unusual pinnacle-like elements rising from molded baseboards at each corner of every room on both floors.

The house is entered through a large entrance/stair hall which extends into the turret's first floor. From the back of this room a very narrow hallway extends to the rear, one story portion of the home. This hall was apparently used as an office by the home's original owner, for it is outfitted with built-in bookcases. A bedroom is located behind the entrance hall and staircase, while a parlor and dining room are found on the opposite side of the entrance hall and narrow hall/office. The rear one story portion contains a den (behind the dining room) and a closet and bath attached to the bedroom. A kitchen projects toward the rear from the den. The second floor contains a hallway/stair landing, a small turret room, three bedrooms, an early twentieth century sleeping porch (see below), and a bath. In addition, the house has a partial basement--a space which is slightly unusual for Louisiana.

The following alterations have occurred to the Watkins House since its c. 1903 construction:

- 1) the glazing of the second level of the two-story side porch to create the above mentioned sleeping porch, and the enclosure of a former small first floor porch located near the northeast rear corner of the home. In addition, it appears that either an additional porch on the east side of the rear one-story section was enclosed during the 1920s or a small addition was made to the house in that location.

CONTINUED

**United States Department of the Interior
National Park Service**

**National Register of Historic Places
Continuation Sheet**

Watkins House, Webster Parish, LA

Section number 7 Page 3

- 2) several losses of historic material, including:
 - a) a mid-level balcony and rooftop balustrade which originally distinguished the turret,
 - b) part of the front porch balustrade,
 - c) at least two chimneys,
 - d) the removal of a small rear porch and the accompanying closure of a window opening onto it. A smaller casement window was installed nearby.
 - e) the replacement of one original tile firebox surround and hearth with marble,
 - f) the possible removal of two upstairs fireplaces, and
 - g) the loss of the leaded glass within two of the oculi. One remains empty; the other has been filled with a cast iron ornament in a snowflake pattern.
- 3) the addition of several modern features, including a 1970s-era beamed ceiling and stone chimney in one rear room, a louvered door covering the home's Adam-like main entrance door, a carport attached to one side of the historic house, and a garage connected to a corner of the home. The latter was later converted into a room.

Although several of the above listed alterations are regrettable, the house retains almost all of its original character defining elements. Furthermore, the features which make the Watkins House architecturally significant remain. Only the loss of the turret's balcony and rooftop balustrade have any impact on this significance, and this impact is minimal. The feature is still clearly identifiable as a Queen Anne Revival style turret--an element which is rare within Minden and the rest of North-Central Louisiana. In addition, the unusual textured treatment of the exterior walls survives intact, as do the portico and other Colonial Revival style features upon which the building's significance is also based. As a landmark in the late nineteenth-early twentieth century residential heritage of Webster Parish, the Watkins House is an outstanding candidate for National Register listing.

8. Statement of Significance

Applicable National Register Criteria

(Mark "x" in one or more boxes for the criteria qualifying the property for National Register listing.)

- A** Property is associated with events that have made a significant contribution to the broad patterns of our history.
- B** Property is associated with the lives of persons significant in our past.
- C** Property embodies the distinctive characteristics of a type, period, or method of construction or represents the work of a master, or possesses high artistic values, or represents a significant and distinguishable entity whose components lack individual distinction.
- D** Property has yielded, or is likely to yield, information important in prehistory or history.

Criteria Considerations N/A
(Mark "x" in all the boxes that apply.)

Property is:

- A** owned by a religious institution or used for religious purposes.
- B** removed from its original location.
- C** a birthplace or grave.
- D** a cemetery.
- E** a reconstructed building, object, or structure.
- F** a commemorative property.
- G** less than 50 years of age or achieved significance within the past 50 years.

Areas of Significance

(Enter categories from instructions)

Architecture

Period of Significance

c. 1903

Significant Dates

c. 1903

Significant Person

(Complete if Criterion B is marked above)

N/A

Cultural Affiliation

N/A

Architect/Builder

Unknown

Narrative Statement of Significance

(Explain the significance of the property on one or more continuation sheets.)

9. Major Bibliographical References

Bibliography

(Cite the books, articles, and other sources used in preparing this form on one or more continuation sheets.)

Previous documentation on file (NPS): N/A

- preliminary determination of individual listing (36 CFR 67) has been requested
- previously listed in the National Register
- previously determined eligible by the National Register
- designated a National Historic Landmark
- recorded by Historic American Buildings Survey # _____
- recorded by Historic American Engineering Record # _____

Primary location of additional data:

- State Historic Preservation Office
- Other State agency
- Federal agency
- Local government
- University
- Other

Name of repository:

Watkins House
Name of Property

Webster Parish, LA
County and State

10. Geographical Data

Acreege of Property approx. 1 acre

UTM References

(Place additional UTM references on a continuation sheet.)

1

1	5	4	7	3	0	3	0
---	---	---	---	---	---	---	---

3	6	0	8	9	3	0
---	---	---	---	---	---	---

Zone Easting Northing

3

--	--	--	--	--	--	--	--

--	--	--	--	--	--	--	--

--	--	--	--	--	--	--	--

Zone Easting Northing

See continuation sheet

Verbal Boundary Description

(Describe the boundaries of the property on a continuation sheet.)

Boundary Justification

(Explain why the boundaries were selected on a continuation sheet.)

11. Form Prepared By

name/title National Register Staff

organization Division of Historic Preservation date August 1997

street & number P. O. Box 44247 telephone 504-342-8160

city or town Baton Rouge state LA zip code 70804

Additional Documentation

Submit the following items with the completed form:

Continuation Sheets

Maps

A **USGS map** (7.5 or 15 minute series) indicating the property's location.

A **Sketch map** for historic districts and properties having large acreage or numerous resources.

Photographs

Representative **black and white photographs** of the property.

Additional items

(Check with the SHPO or FPO for any additional items)

Property Owner

(Complete this item at the request of SHPO or FPO.)

name Bo & Patsy Drake

street & number 109 North College telephone 318-377-7200

city or town Minden state LA zip code 71055

Paperwork Reduction Act Statement: This information is being collected for applications to the National Register of Historic Places to nominate properties for listing or determine eligibility for listing, to list properties, and to amend existing listings. Response to this request is required to obtain a benefit in accordance with the National Historic Preservation Act, as amended (16 U.S.C. 470 *et seq.*).

Estimated Burden Statement: Public reporting burden for this form is estimated to average 18.1 hours per response including time for reviewing instructions, gathering and maintaining data, and completing and reviewing the form. Direct comments regarding this burden estimate or any aspect of this form to the Chief, Administrative Services Division, National Park Service, P.O. Box 37127, Washington, DC 20013-7127; and the Office of Management and Budget, Paperwork Reductions Projects (1024-0018), Washington, DC 20503.

**United States Department of the Interior
National Park Service****National Register of Historic Places
Continuation Sheet**

Watkins House, Webster Parish, LA

Section number 8 Page 1

The Watkins House is locally significant in the area of architecture as a landmark in the late nineteenth-early twentieth century residential heritage of Webster Parish. Its distinction within this context rests principally upon its status as an important example of the Colonial Revival influence. The house is also significant within North-Central Louisiana as a rare turreted example of the Queen Anne Revival style.

Colonial Revival

The comprehensive parish-wide Standing Structures Survey has recorded some 432 buildings in Webster Parish which are over 50 years old. The vast majority of these date from the late nineteenth or early twentieth centuries. Most are unstyled. Among the styled buildings the bungalow influence predominates, with mostly low-key examples. Finer or more elaborately styled buildings tend to follow the Queen Anne Revival or Colonial Revival traditions. The parish contains a total of 23 examples of the Colonial Revival influence. The Watkins House is conspicuous among this group because it is one of only five examples in the parish which feature colossal columns and one of only two to feature a pedimented portico. The house derives additional grandeur and importance from its encircling entablature with modillion cornice and additional pedimented gables featuring raking cornices and oculi.

Queen Anne Revival

The parishes of Lincoln, Union, Claiborne, Webster, Bienville, Jackson and Ouachita comprise the region known as North-Central Louisiana. This distinctive area, sometimes known as the "Hill Parishes," was mainly characterized by the Upland South culture. During the late nineteenth and early twentieth centuries the Queen Anne Revival was a decidedly urban influence in the region. But the 200-300 examples found there today are fairly humble. Most are cottages with a two or three bay gallery across half the front and perhaps a single projecting polygonal bay under a gable.

The Watkins House is important within this group because of its impressively textured surfaces and, more importantly, because it is one of only about six residences in the region to feature a turret. Generally speaking, it is the use of a turret which distinguishes the grand Queen Anne houses from the lesser examples. A turret contributes much to the elaborateness of a house's massing, something which is very much a part of the Queen Anne Revival aesthetic. Secondly, because a turret contributes very little extra floor space at considerable extra cost, it is certainly a luxury item.

CONTINUED

**United States Department of the Interior
National Park Service**

**National Register of Historic Places
Continuation Sheet**

Watkins House, Webster Parish, LA

Section number $\frac{8}{9}$ Page $\frac{2}{1}$

Historical Note

The house was built for L. K. Watkins after fire destroyed the original house on the site in 1901. It was in place by 1904 because it appears in a promotional tract published that year.

BIBLIOGRAPHY

Historic Standing Structures Survey for Webster Parish, Division of Historic Preservation.

Sanborn Fire Insurance Map for Minden, Louisiana, 1929.

Site visit by National Register staff.

Webster Parish, Louisiana: The Homeseeker's Paradise! The Eden of the New South!! The Promised Land of Peace and Plenty!!!!!! [Sic], n.p., 1904.

**United States Department of the Interior
National Park Service**

National Register of Historic Places Continuation Sheet

Watkins House, Webster Parish, LA
Section number 10 Page 1

Boundary Description: Please refer to enclosed property plat map.

Justification: Boundaries follow property lines.

WILLIAMSON JONES SURVEY (SEMINA

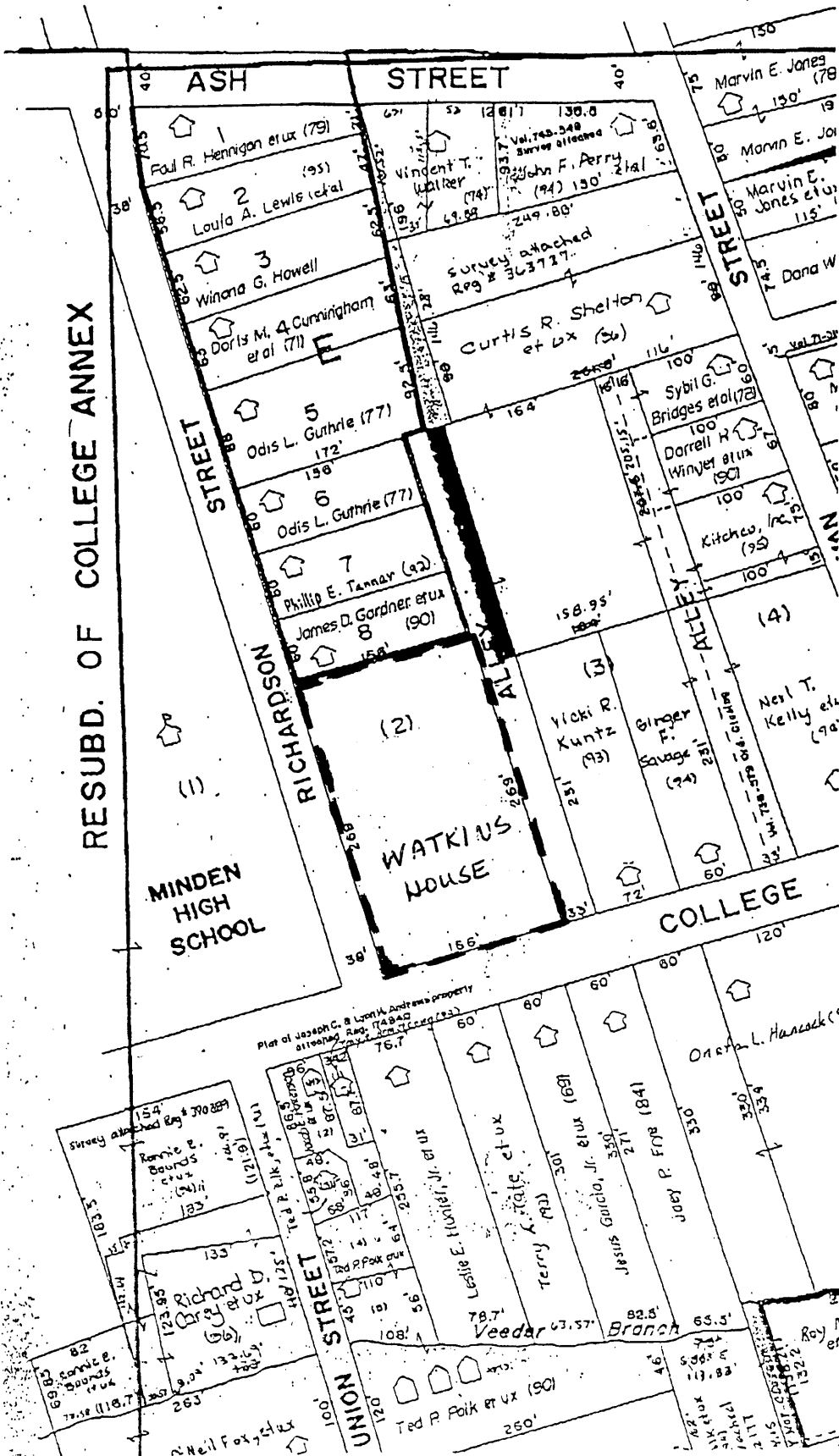

WATKINS
HOUSE

MINDEN,
WEBSTER
PARISH
LA



SCALE: 1" = 140'

BOUNDARY: - - -