

**United States Department of the Interior
Heritage Conservation and Recreation Service**

**National Register of Historic Places
Inventory—Nomination Form**

See instructions in *How to Complete National Register Forms*
Type all entries—complete applicable sections

1. Name

historic First Methodist Church

and/or common Greater New Hope Missionary Baptist Church

2. Location

street & number 630 Jackson Street _____ not for publication

city, town Alexandria _____ vicinity of congressional district 8th - Gillis Long

state Louisiana code 022 county Rapides code 079

3. Classification

Category	Ownership	Status	Present Use	
<input type="checkbox"/> district	<input type="checkbox"/> public	<input checked="" type="checkbox"/> occupied	<input type="checkbox"/> agriculture	<input type="checkbox"/> museum
<input checked="" type="checkbox"/> building(s)	<input checked="" type="checkbox"/> private	<input type="checkbox"/> unoccupied	<input type="checkbox"/> commercial	<input type="checkbox"/> park
<input type="checkbox"/> structure	<input type="checkbox"/> both	<input type="checkbox"/> work in progress	<input type="checkbox"/> educational	<input type="checkbox"/> private residence
<input type="checkbox"/> site	Public Acquisition	Accessible	<input type="checkbox"/> entertainment	<input checked="" type="checkbox"/> religious
<input type="checkbox"/> object	<input type="checkbox"/> in process	<input checked="" type="checkbox"/> yes: restricted	<input type="checkbox"/> government	<input type="checkbox"/> scientific
	<input type="checkbox"/> being considered	<input type="checkbox"/> yes: unrestricted	<input type="checkbox"/> industrial	<input type="checkbox"/> transportation
		<input type="checkbox"/> no	<input type="checkbox"/> military	<input type="checkbox"/> other:

4. Owner of Property

name Greater New Hope Missionary Baptist Church c/o Thomas M. Robinson

street & number 630 Jackson Street

city, town Alexandria _____ vicinity of state Louisiana

5. Location of Legal Description

courthouse, registry of deeds, etc. Rapides Parish Courthouse

street & number

city, town Alexandria _____ state Louisiana

6. Representation in Existing Surveys

title LA Historic Sites Survey has this property been determined eligible? _____ yes no

date 1979 _____ federal state _____ county _____ local

depository for survey records State Historic Preservation Office

city, town Baton Rouge _____ state Louisiana

7. Description

Condition

excellent
 good
 fair

deteriorated
 ruins
 unexposed

Check one

unaltered
 altered

Check one

original site
 moved date _____

Describe the present and original (if known) physical appearance

The First Methodist Church is set on Jackson Street in the downtown area of Alexandria where its four-story tower is something of a landmark.

The heavy masonry structure is faced in Roman brick. The plan consists of a large square two-story nave, and a side wing which contains a kitchen and classrooms. The ceiling is formed by the convergence of two hip roof shapes with exposed trusses. Sliding walls open to adjacent spaces, which adds to the seating capacity of the nave and balcony.

The interior features paneled wainscoting and large opalescent glass windows.

The exterior is mainly characteristic of the turn-of-the-century Romanesque Revival. The gable fronted nave is flanked by square towers with heavy cornices and pyramid roofs. The corner tower is the taller of the two due to its belfry. An arcade runs between the towers and forms the nave entrance. The classroom side wing is set within its own gabled pavilion. The smooth brick exterior is punctuated by crisply cut windows designed to emphasize the massiveness of the walls. Round arch windows are picked out by narrow brick voussoirs.

8. Significance

Period	Areas of Significance—Check and justify below			
<input type="checkbox"/> prehistoric	<input type="checkbox"/> archeology-prehistoric	<input type="checkbox"/> community planning	<input type="checkbox"/> landscape architecture	<input type="checkbox"/> religion
<input type="checkbox"/> 1400–1499	<input type="checkbox"/> archeology-historic	<input type="checkbox"/> conservation	<input type="checkbox"/> law	<input type="checkbox"/> science
<input type="checkbox"/> 1500–1599	<input type="checkbox"/> agriculture	<input type="checkbox"/> economics	<input type="checkbox"/> literature	<input type="checkbox"/> sculpture
<input type="checkbox"/> 1600–1699	<input checked="" type="checkbox"/> architecture	<input type="checkbox"/> education	<input type="checkbox"/> military	<input type="checkbox"/> social/ humanitarian
<input type="checkbox"/> 1700–1799	<input type="checkbox"/> art	<input type="checkbox"/> engineering	<input type="checkbox"/> music	<input type="checkbox"/> theater
<input type="checkbox"/> 1800–1899	<input type="checkbox"/> commerce	<input type="checkbox"/> exploration/settlement	<input type="checkbox"/> philosophy	<input type="checkbox"/> transportation
<input checked="" type="checkbox"/> 1900–	<input type="checkbox"/> communications	<input type="checkbox"/> industry	<input type="checkbox"/> politics/government	<input type="checkbox"/> other (specify)
		<input type="checkbox"/> invention		

Specific dates 1907 **Builder/Architect** W. E. Matthews, Architect

Statement of Significance (in one paragraph) Criterion C

The First Methodist Church is important in the architectural heritage of downtown Alexandria. It is the city's only monumental example of the Romanesque Revival. Other churches are designed in the Gothic or Classical style. Other buildings have Romanesque features, but these are merely commercial buildings with applied features. Unlike the church they do not have towers, arcades, or the proper Romanesque massing.

The building was originally occupied by the First Methodist Church of Alexandria. Its cornerstone was laid on October 20, 1907. The architect was W. E. Matthews and the contractor L. H. Baldwin. Four different congregations have occupied this building. It is currently occupied by the Greater New Hope Baptist Church.

9. Major Bibliographical References

Alexandria Daily Town Talk, 7 January 1978.
 Records of the First United Methodist Church of Alexandria

10. Geographical Data

UTM NOT VERIFIED

Acreeage of nominated property approx. .9 acres
 Quadrangle name _____

ACREAGE NOT VERIFIED
 Quadrangle scale _____

UMT References

A	1 5	5 5 2 5 0 0	3 4 6 3 9 4 0
	Zone	Easting	Northing
C			
E			
G			

B			
	Zone	Easting	Northing
D			
F			
H			

Verbal boundary description and justification

See attached sketch map.

List all states and counties for properties overlapping state or county boundaries

state	code	county	code
state	code	county	code

11. Form Prepared By

name/title Greater New Hope Missionary Baptist Church c/o Thomas M. Robinson

organization _____ date _____

street & number 329 - 16th Street telephone _____

city or town Alexandria state Louisiana

12. State Historic Preservation Officer Certification

The evaluated significance of this property within the state is:

national state local

As the designated State Historic Preservation Officer for the National Historic Preservation Act of 1966 (Public Law 89-665), I hereby nominate this property for inclusion in the National Register and certify that it has been evaluated according to the criteria and procedures set forth by the Heritage Conservation and Recreation Service.

State Historic Preservation Officer signature *D. Bernard Lamar*

title State Historic Preservation Officer date 3/27/80

For HCRS use only I hereby certify that this property is included in the National Register	
<i>James Gully G. Odell</i> Keeper of the National Register	date <u>6/6/80</u>
Attest: <i>Beth Grosvenor</i> Chief of Registration	date <u>6/3/80</u>

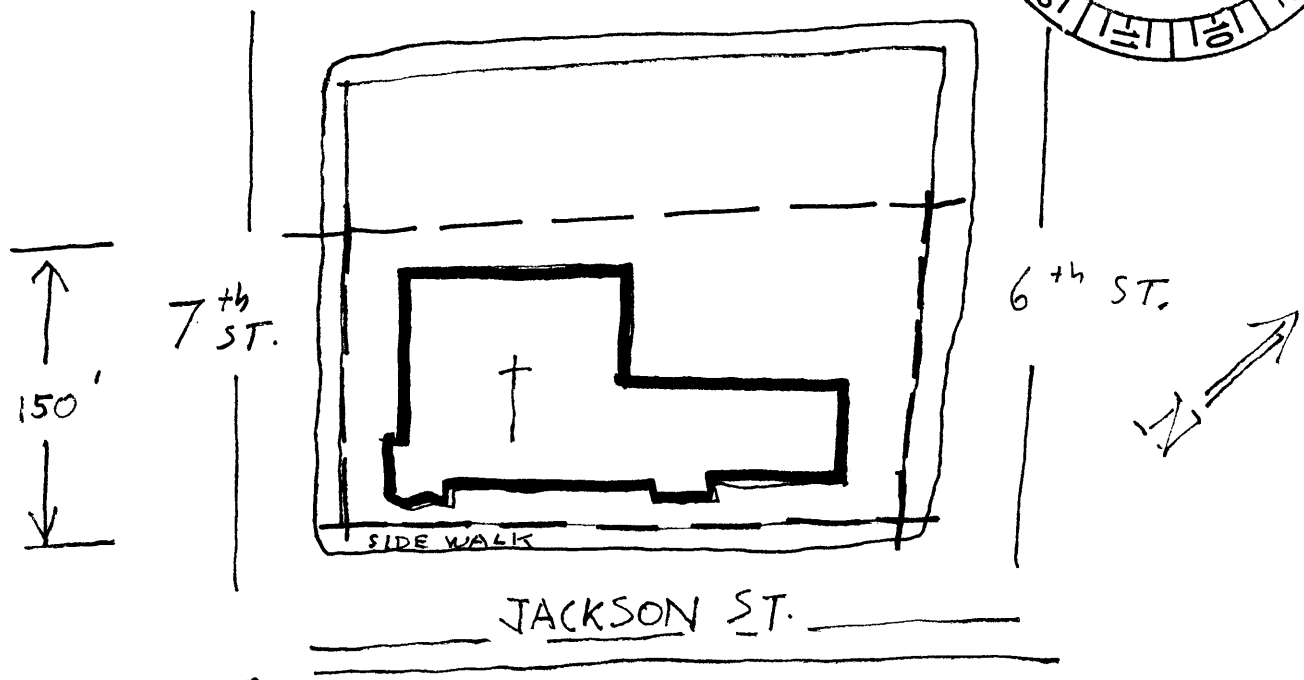
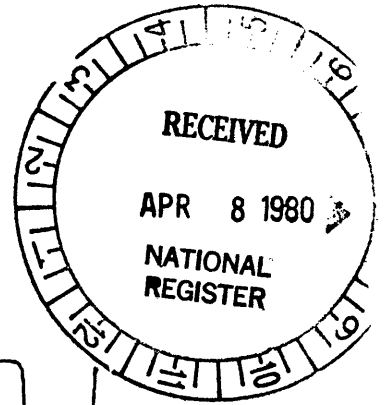

PHOTO ↗

BOUNDARIES FOLLOW INSIDE EDGE OF THE SIDEWALK ON 3 SIDES OF THE BLOCK. THE FOURTH SIDE RUNS PARALELL TO THE JACKSON ST SIDEWALK 150 FEET NORTH WEST OF THE INSIDE EDGE.