

FORM B - BUILDING

ref no. 20000628

In Area no.	Form no.
	132-A

MASSACHUSETTS HISTORICAL COMMISSION
Office of the Secretary, State House, Boston

2. Photo (3x3" or 3x5")
Staple to left side of form
Photo number _____

Roll 20

4. Map. Draw sketch of building location
in relation to nearest cross streets and
other buildings. Indicate north.

1. Town Worcester
 Address 130 Plantation Street
 Name Benjamin Flagg II Homestead
 Present use residence
 Present owner Arthur and Helen Carrier

3. Description:
 Date ca. 1717-1718
 Source see Bibliography
 Style timber-frame vernacular
 Architect probably none
 Exterior wall fabric shingle
 Outbuildings (describe) none
 Other features hammered granite founda-
 tion, central chimney, center-
 entrance facade with one window on
 each side of entry, 6/9 sash
 sash added-----ca. 1970
 Altered chimney par- Date mid-19th
tially capped century
 Moved no Date _____

UTM
19/270640/4682220

5. Lot size: Lot 19 10,378 sq.ft.
 One acre or less Over one acre _____
 Approximate frontage 80'
 Approximate distance of building from street
30'

6. Recorded by W. & H. Seaman
ed. B.R. Pfeiffer
 Organization Worc. Heritage Pres. Soc.
 Date January 1978

(over)

7. Original owner (if known) Benjamin Flagg II
 Original use residence (farmhouse)
 Subsequent uses (if any) and dates same

8. Themes (check as many as applicable)

Aboriginal	<input type="checkbox"/>	Conservation	<input type="checkbox"/>	Recreation	<input type="checkbox"/>
Agricultural	<input type="checkbox"/>	Education	<input type="checkbox"/>	Religion	<input type="checkbox"/>
Architectural	<input checked="" type="checkbox"/>	Exploration/ settlement	<input checked="" type="checkbox"/>	Science/ invention	<input type="checkbox"/>
The Arts	<input type="checkbox"/>	Industry	<input type="checkbox"/>	Social/ humanitarian	<input type="checkbox"/>
Commerce	<input type="checkbox"/>	Military	<input checked="" type="checkbox"/>	Transportation	<input type="checkbox"/>
Communication	<input type="checkbox"/>	Political	<input type="checkbox"/>		<input type="checkbox"/>
Community development	<input type="checkbox"/>				<input type="checkbox"/>

9. Historical significance (include explanation of themes checked above)

One of the oldest houses in Worcester, the Benjamin Flagg II Homestead is of the locally popular central-chimney, center-entrance, three-window facade type of house built by a number of the city's earliest settlers. Recently restored, the Flagg House now appears as it does in nineteenth-century photographs except for the addition of a Colonial Revival door (facade) and a large multi-paned window (south). As early as 1833 a map of Worcester noted the construction date of 136 Plantation Street as 1718, recognizing the house as one of the town's oldest. According to secondary sources, Benjamin Flagg II, the son of Benjamin Flagg I of Watertown, later of Auburn, was born in Watertown, Mass., in 1691. Beginning in 1717-1718, Benjamin Flagg II bought extensive tracts of land in Worcester. A carpenter by trade, Flagg is believed to have built the Plantation Street house around this time; by 1725 Flagg was a selectman, in 1729 served as local schoolmaster, and in 1751 as sheriff of the county. For reasons not clearly explained, Benjamin Flagg II had the title of captain.

Benjamin Flagg III, whose name is most often associated with this house, was born in Worcester in 1724. Having served in the French and Indian War, Benjamin III marched with Col. Timothy Bigelow's company of Minute Men on April 19, 1775. During the Revolution Flagg rose to the rank of captain and in 1777 to that of lieutenant colonel. Upon his death in 1818 Benjamin III left four children, forty-two grandchildren and eighty-three great-grandchildren.

(cont.)

10. Bibliography and/or references (such as local histories, deeds, assessor's records, early maps, etc.)

1833 Map of Worcester

Nutt, C. History of Worcester, vol. I, pp. 110-111 (Flagg genealogy)
p. 146 (photo)

Wall, C. Eastern Worcester; Its First Settlers (1891) p.46.

Wall, C. Map of Earliest Settlers (1877)

Wall, C. Reminiscences... pp. 106-108 (Flagg family)

INVENTORY FORM CONTINUATION SHEET

MASSACHUSETTS HISTORICAL COMMISSION
Office of the Secretary, Boston

Community: Worcester	Form No: 132-A
Property Name: Benjamin Flagg II Homestead	

Indicate each item on inventory form which is being continued below.

91

Marked on the 1833 map as the property of Richard Flagg, the Plantation Street house was occupied by Aaron Flagg, son of Benjamin IV, until his death in 1836. After having been rented out by Flagg's heirs, the house was sold in 1850 to George S. Howe who, according to Caleb Wall, remodelled the building. The extent of this remodelling is unknown. Further, without examination of the structure, it is unclear if the whole building dates from ca.1718, or whether the original structure was enlarged during the eighteenth century.

Staple to Inventory form at bottom

Property Worcester Multiple Resource Area (Partial Inventory)

State MA (Worcester) Working Number 8.30.79.2060

TECHNICAL

Photos 383 + 13
Maps 2, 63

CONTROL

Excellent multiple resource nomination for the entire city of Worcester. Both the general description & statement of significance & the individual inventory sheets are well done. Each type of property included is well justified & reasons are listed for not including others at this time (e.g. 3-deckers). Opposition is high. Minor problems with some properties are listed on attached sheets.

HISTORIAN
Call/Accept
Lightner
10.30.79

Concur with Bruce's comments on 102-L-3, 116-CBD-11, 117-E, and 130-CBD-50 and 44. Integrity and/or boundaries need to be addressed specifically on individual forms. DOUBLE

ARCHITECTURAL HISTORIAN

ARCHEOLOGIST

116-CBD-11 - Destroyed, cannot be listed.
130-CBD-44 - I am not convinced this has lost integrity. See attached.
102-L-3 - Period of significance and categorization of 1800s need to be discussed with State.

With 3 exceptions all properties appear to me to meet the criteria and the forms are adequate. ~~Both~~ ^{Both} technically and to determine significance. Although some of the forms did not contain strong statements of significance the resource categories were thoroughly discussed in the body of the nomination; therefore significance was established. VBDs were not necessary because

OTHER
ALEST
AKC/DOH
2/28/80

of the scale maps and clearly delineated boundaries. Presence was missing on some properties but is now included after the 2/11/corrections.

HAER

The only properties that I do not recommend listing are

Inventory _____
Review _____

- ✓ 116-CBD-13 - DESTROYED BY FIRE MA - 16 CBD-11
- 130-CBD-44 - DOES NOT RETAIN INTEGRITY FOR INDIVIDUAL ELIGIBILITY

- ✓ 102-L-3 I ~~am~~ ^{am} not convinced about boundaries BUT BELIEVE THEY COULD BE OK. ~~AMSD~~ ON ADDITIONAL DOCUMENTATION SUBMITTED - I DEFER JUDGEMENT.

REVIEW UNIT CHIEF

Recommend listing all properties ^{now} except these 3. Return 116-CBD-11 to State (not eligible); ~~to discuss further~~ w/NR staff + State. DOUBLE
Return 102-L-3 to State for correction; DOUBLE
HOLD 130-CBD-44 for info from State

BRANCH CHIEF 3/3/80

Staff conference 3/5/80 - agreed to action as noted below:

KEEPER

Accept with exception of 116-CBD-11 (official notification of fire & clean from State), 102-L-3 (returning to state for revision - also returning 116-CBD-11) and 130-CBD-44 (Eldridge from State)

Spedder
3/5/80

National Register Write-up _____ Send-back _____ Entered MAR 5 1980
Federal Register Entry 2.3.81 Re-submit _____



Flagg, Benjamin. Base
Worcester NRA, Ala

132-A

30 AUG 1979

136 Plantation
St.

West elevation

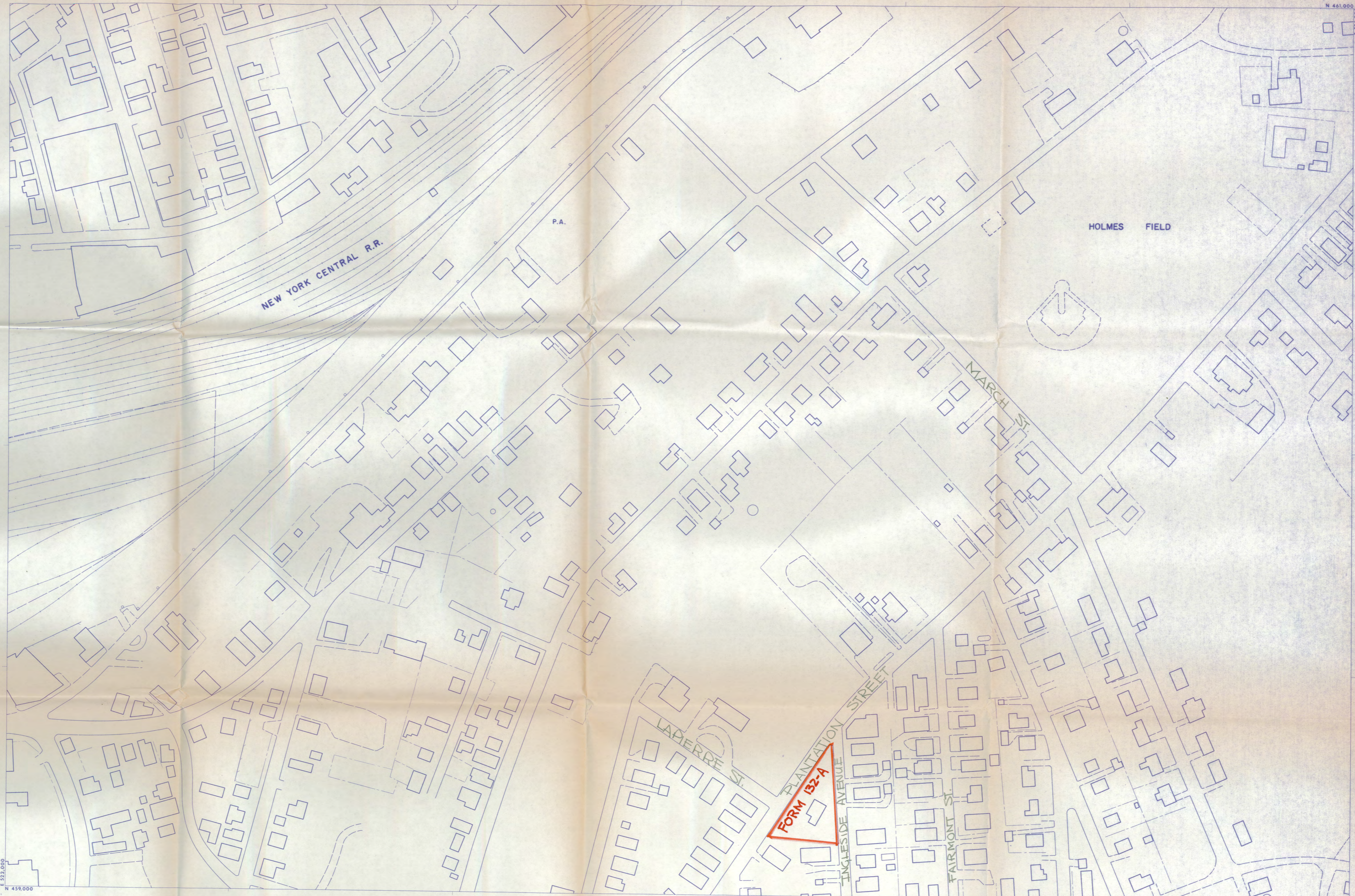

COMPILED BY PHOTOGRAMMETRIC METHODS
moore survey & mapping corp.
 CONTROL BY MASS. GEODETIC SURVEY, U.S.C. & G.S., & M.S.&M. CORP.
 UPDATED BY _____ DATE: _____

THIS MAP REPRODUCED FROM MAPPING MEETING NATIONAL MAP ACCURACY STANDARDS AT A SCALE OF 1"=200'

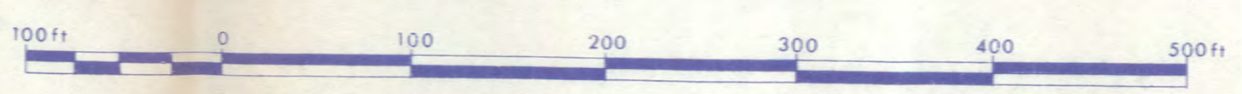

500 FOOT GRID BASED ON MASS RECTANGULAR COORDINATE SYSTEM

INDEX

117	118	119
131		133
143	144	145

CITY OF WORCESTER
 MASSACHUSETTS
 PLANIMETRIC BASE MAP

PROJECT: M.S.M. 2517 DATE OF PHOTOGRAPHY: 6-12-75
 SHEET 132 OF 220 SHEETS



