

MAY 23 1989

728

FORM B - BUILDING

MASSACHUSETTS HISTORICAL COMMISSION
80 BOYLSTON STREET
BOSTON, MA 02116

AREA	FORM NO.
D	290

Town Wakefield

Address 371 Main Street

Historic Name Wakefield Trust Company

Use: Present Bank

Original Bank

Photo (3"x3" or 3"x5", black and white) Indicate address of property on back of photo. Staple to left side of form.

DESCRIPTION

Date 1924

Source History of Wakefield

Style Neo-Classical

Architect NA

Exterior Wall Fabric Limestone

Outbuildings None

Sketch Map: Draw map showing property's location in relation to nearest cross streets and/or geographical features. Indicate all buildings between inventoried property and nearest intersection(s). Indicate north

Major Alterations (with dates) 1960s Addition on west; sidewalk window on north; main entry replaced. 1940s

Condition Good

Moved NA Date NA

Acreage Under 1 acre.

Setting Faces east on corner lot in downtown center.

UTM REFERENCE 19/329800/4707580

USGS QUADRANGLE Reading, Mass.

SCALE 1:25,000

Recorded by Architectural Preservation Associates
Organization Wakefield Historical Commission

Date March 1985

NATIONAL REGISTER CRITERIA STATEMENT (if applicable)

Meeting a design standard already set by the Beebe Library (1922) and closely followed by the town Post Office (1936), the Wakefield Trust Co. building is a classically inspired building lending dignity to the downtown commercial area. It retains integrity of location, setting, design, materials, workmanship, feeling and association, and meets Criterion C of the NRHP on the local level.

ARCHITECTURAL SIGNIFICANCE Describe important architectural features and evaluate in terms of other buildings within the community.

Together with the library and post office, this building forms a trio of historicizing institutional buildings which use classical elements to lend dignity to their appearance. This is a two story limestone building whose east facade has four columns in antis supporting a pedimented portico beneath which is an arched entry. Pilasters separate the remaining bays on east and north facades topped by a full entablature in which "Wakefield Trust Company" is inscribed on both facades. Flower medallions and a strygil pattern ornament the frieze as well.

HISTORICAL SIGNIFICANCE Explain the role owners played in local or state history and how the building relates to the development of the community.

Banking as a business began in South Reading at approximately the same time as industries began settling in the town. An early start was made by South Reading Mechanical and Agricultural Institution formed in 1833, but it was later closed. In 1856 rattan manufacturing began and in 1854 the South Reading Bank, the forebearer of this bank, was organized as a state bank with historian Lilley Eaton as cashier. In 1865 it was reorganized as the National Bank of South Reading and in 1902 belatedly changed its name to reflect the town's name change as the Wakefield National Bank. Once again the bank was reorganized, this time in 1926 when it became the Wakefield Trust Company as it is known today.

The bank building which went up in 1924 for \$300,000 met the architectural standard set by the Beebe Library of 1922. The Post Office of 1936 provided a third building of high standards, thereby creating a town center with three classically derived, substantial buildings as its core.

BIBLIOGRAPHY and/or REFERENCES

- Eaton, Wm. and History Committee. History of Wakefield, Massachusetts, Wakefield, 1944.
- Wakefield Library, Vertical File, "Downtown Wakefield".
- Wakefield Expansion Board. Wakefield, Massachusetts, n.d.

United States Department of the Interior
National Park Service

National Register of Historic Places
Continuation Sheet

Section number _____ Page _____

Multiple Resource Area
Thematic Group

Name Wakefield MRA
State Middlesex County, MASSACHUSETTS

Nomination/Type of Review

Date/Signature

81. Wakefield Park *H.D.* Substantive Review Keeper Beth L. Savage 3/2/90
Attest _____

82. Wakefield Rattan Company Substantive Review Keeper Beth L. Savage 7/6/89
Attest _____

83. Wakefield Savings Bank Clock
Substantive Review Keeper _____ R
DOE/OWNER OBJECTION
Attest _____

84. Wakefield Trust Company
Entered in the National Register Keeper Arlene Byer 7/6/89
Attest _____

85. Wakefield Upper Depot
Entered in the National Register Keeper Arlene Byer 7/6/89
Attest _____

86. Warren, H.M., School
Entered in the National Register Keeper Arlene Byer 7/6/89
Attest _____

87. West Ward School
Entered in the National Register Keeper Arlene Byer 7/6/89
Attest _____

88. Winn Street Railroad Bridge
Substantive Review Keeper _____ R
Attest _____

89. Winn, Suell, House
Entered in the National Register Keeper Arlene Byer 7/6/89
Attest _____

90. Winship, Charles, House
Keeper Beth L. Savage 7/6/89
Attest _____

UNITED STATES DEPARTMENT OF THE INTERIOR
NATIONAL PARK SERVICE

NATIONAL REGISTER OF HISTORIC PLACES
EVALUATION/RETURN SHEET

REQUESTED ACTION: NOMINATION

PROPERTY NAME: Wakefield Trust Company

MULTIPLE NAME: Wakefield MRA

STATE & COUNTY: MASSACHUSETTS, Middlesex

DATE RECEIVED: 5/23/89 DATE OF PENDING LIST: 6/06/89
DATE OF 16TH DAY: 6/22/89 DATE OF 45TH DAY: 7/07/89
DATE OF WEEKLY LIST:

REFERENCE NUMBER: 89000728

NOMINATOR: STATE

REASONS FOR REVIEW:

APPEAL: N DATA PROBLEM: N LANDSCAPE: N LESS THAN 50 YEARS: N
OTHER: N PDIL: N PERIOD: N PROGRAM UNAPPROVED: N
REQUEST: N SAMPLE: N SLR DRAFT: N NATIONAL: N

COMMENT WAIVER: N

ACCEPT RETURN REJECT 7/6/89 DATE

Entered in the
National Register

ABSTRACT/SUMMARY COMMENTS:

RECOM./CRITERIA _____
REVIEWER _____
DISCIPLINE _____
DATE _____

DOCUMENTATION see attached comments Y/N see attached SLR Y/N

CLASSIFICATION

count resource type

STATE/FEDERAL AGENCY CERTIFICATION

FUNCTION

historic current

DESCRIPTION

architectural classification
 materials
 descriptive text

SIGNIFICANCE

Period Areas of Significance--Check and justify below

Specific dates Builder/Architect
Statement of Significance (in one paragraph)

summary paragraph
 completeness
 clarity
 applicable criteria
 justification of areas checked
 relating significance to the resource
 context
 relationship of integrity to significance
 justification of exception
 other

BIBLIOGRAPHY

GEOGRAPHICAL DATA

acreage verbal boundary description
 UTM's boundary justification

ACCOMPANYING DOCUMENTATION/PRESENTATION

sketch maps USGS maps photographs presentation

OTHER COMMENTS

Questions concerning this nomination may be directed to

_____ Phone _____

Signed _____ Date _____



D 290

371 Main St.

Wakfield Trust Company

Wakfield MRA, Ma.

NOTE: Lot numbers with pre.

11

371 MAIN STREET

↑ N
SCALE: 1"=80'

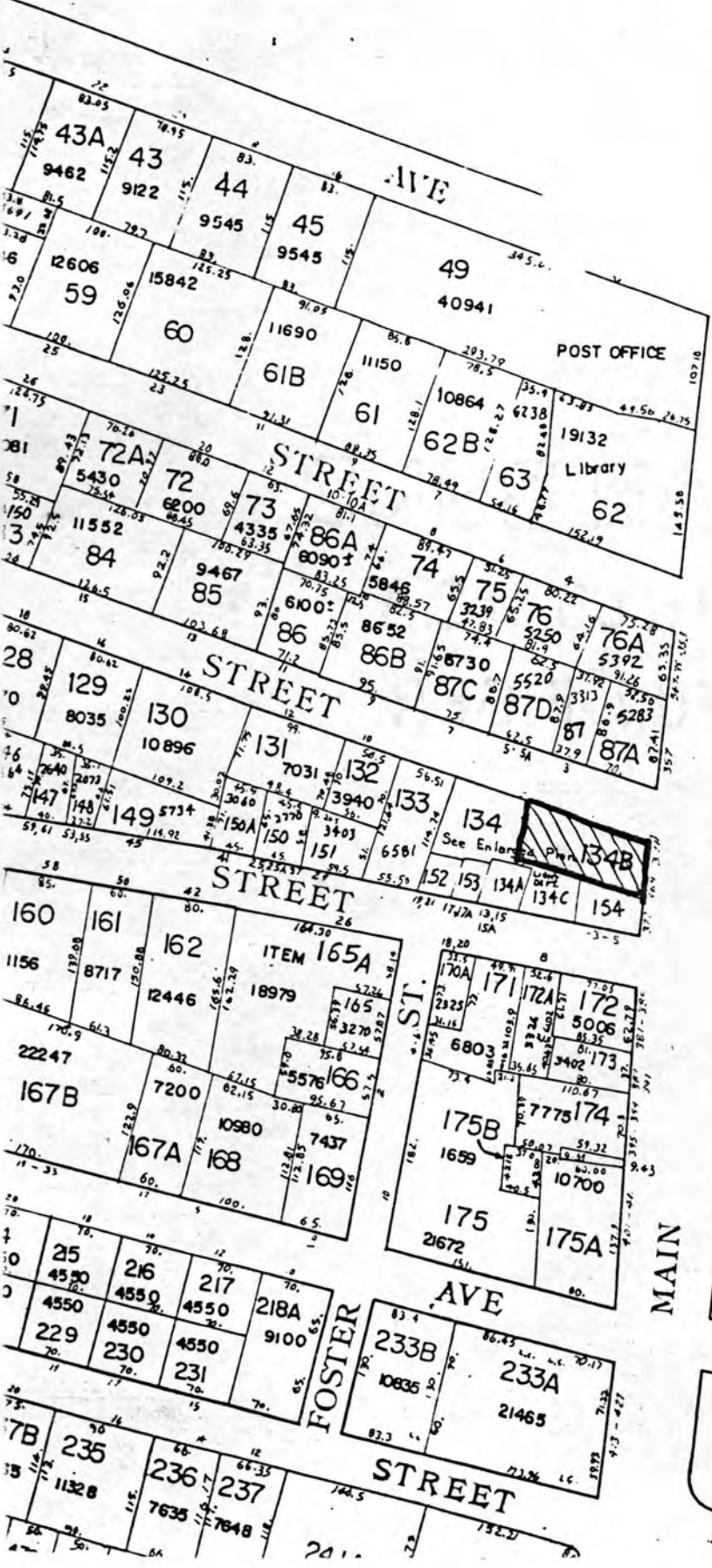

STREET

17

MAIN

FOSTER

STREET

Please refer to the map in the
Multiple Property Cover Sheet
for this property

Multiple Property Cover Sheet Reference Number: 64000300