

**United States Department of the Interior  
Heritage Conservation and Recreation Service**

**National Register of Historic Places  
Inventory—Nomination Form**

See instructions in *How to Complete National Register Forms*  
Type all entries—complete applicable sections



**1. Name**

historic John Lee Webber House

and/or common The Webber Place

RECEIVED  
SEP 1

**2. Location**

street & number 6610 Webber Street \_\_\_\_\_ not for publication

city, town Yountville \_\_\_\_\_ vicinity of \_\_\_\_\_ congressional district Second

state California code 06 county NAPA code 055

**3. Classification**

<b>Category</b>	<b>Ownership</b>	<b>Status</b>	<b>Present Use</b>
<input checked="" type="checkbox"/> district	<input checked="" type="checkbox"/> public	<input checked="" type="checkbox"/> occupied	_____ museum
<input checked="" type="checkbox"/> building(s)	<input checked="" type="checkbox"/> private	_____ unoccupied	_____ park
_____ structure	_____ both	_____ work in progress	_____ private residence
_____ site	<b>Public Acquisition</b>	<b>Accessible</b>	_____ religious
_____ object	_____ in process	<input checked="" type="checkbox"/> yes: restricted	_____ government
	_____ being considered	_____ yes: unrestricted	_____ industrial
		_____ no	<input checked="" type="checkbox"/> transportation
			_____ other: <u>Country Inn</u>

**4. Owner of Property**

name Loren K. Holte

street & number P.O. BOX 2873

city, town Yountville \_\_\_\_\_ vicinity of \_\_\_\_\_ state California 94599

**5. Location of Legal Description**

courthouse, registry of deeds, etc. Napa County Courthouse

street & number Courthouse

city, town Napa \_\_\_\_\_ state California 94558

**6. Representation in Existing Surveys**

title Napa Co. Historic Resources Inventory has this property been determined eligible? \_\_\_\_\_ yes \_\_\_\_\_ no

date August 28, 1978 \_\_\_\_\_ federal  state  county  local

depository for survey records Office of Historic Preservation

city, town P.O.Box 2390 Sacramento \_\_\_\_\_ state California 95811

## 7. Description

Condition (house)	Check one	Check one
<input checked="" type="checkbox"/> excellent /	<input type="checkbox"/> deteriorated	<input type="checkbox"/> original site
<input checked="" type="checkbox"/> good (barn)	<input checked="" type="checkbox"/> unaltered	<input checked="" type="checkbox"/> moved
<input type="checkbox"/> fair	<input type="checkbox"/> altered	date <u>ca. 1860's</u>
<input type="checkbox"/> ruins	<input type="checkbox"/> unexposed	

### Describe the present and original (if known) physical appearance

Situated on a corner lot bounded by Webber and Jefferson Streets in Yountville is the John Lee Webber House, a two storey frame farmhouse built prior to 1859 in the simplified Greek Revival style prevalent in pioneer dwellings. It was originally located on the Finnell Ranch, less than a mile to the east of its present location, and moved to the present site in the 1860's. The Webber House assumed its present appearance in 1907-08 when it was enlarged by the Webber family.

The clapboard farmhouse of the 1850's was one and 1/2 storeys with a gable roof and central brick chimney. It had a one storey rear addition serving as a kitchen. The front entrance, in the non-gable facade, remains the main entrance today.

In 1907-08, a gabled second storey room with clapboard siding was added and cantilevered from the front of the house over the front porch. The rear kitchen wing was extended to the north with an enclosed back porch. An indoor bathroom was built between the kitchen and the porch. The space between the back porch and a brick well was enclosed with screening. A second storey with shingle siding completed the expanded rectangular wing to the north which formed an L with the original house. Doublehung sash windows remain in the original house and in the rear extension. On the second storey, some vertical casement windows have replaced the doublehung sash. When remodelled in 1907-08, the Webber House consisted of kitchen, dining room, back bedroom and front and back parlors on the first floor; bedrooms were on the second floor. Rooms downstairs were wall-papered; in the upstairs extension rooms had tongue-and-groove panelling.

In 1905, John Webber had the Barn built which opens directly onto Webber Street. Two horses and a cow lived in it and a buggy and surrey were stored there. The Barn is a two storey structure with shiplap siding. In the gable end facing Webber Street are sliding frame double-doors; above them in the gable end are a rectangular door and square windows. The Barn remains unaltered and is presently used for storage.

Yountville at the turn-of-the-century was rural. Beyond the Barn on Webber Street was a vineyard; across the street from House and Barn was pasture. Small cottages have filled in this streetscape, yet Yountville still retains the character of a small country village. Between the Webber House and Barn, where there was originally a large garden and strawberry patch, a small rectangular cottage (c.1930) was built. It has lap siding and a gable roof with a gabled porch. It is scheduled for removal from the site to another location.

Renovation of the Webber House was completed in 1979 and it currently serves as a country inn. The present owner retained the room divisions of the early 20th century replacing where necessary the woodwork with wainscoting, panelling, etc. consistent with the period. The building was reinforced structurally maintaining the features ca. 1907-08. Renovation of the Barn is planned with conversion of the interior space for lodging. Removal of the intervening cottage, a non-contributing structure, is scheduled.

## 8. Significance

Period	Areas of Significance—Check and justify below			
<input type="checkbox"/> prehistoric	<input type="checkbox"/> archeology-prehistoric	<input type="checkbox"/> community planning	<input type="checkbox"/> landscape architecture	<input type="checkbox"/> religion
<input type="checkbox"/> 1400-1499	<input checked="" type="checkbox"/> archeology-historic	<input type="checkbox"/> conservation	<input type="checkbox"/> law	<input type="checkbox"/> science
<input type="checkbox"/> 1500-1599	<input type="checkbox"/> agriculture	<input type="checkbox"/> economics	<input type="checkbox"/> literature	<input type="checkbox"/> sculpture
<input type="checkbox"/> 1600-1699	<input type="checkbox"/> architecture	<input type="checkbox"/> education	<input type="checkbox"/> military	<input type="checkbox"/> social/
<input type="checkbox"/> 1700-1799	<input type="checkbox"/> art	<input type="checkbox"/> engineering	<input type="checkbox"/> music	<input type="checkbox"/> humanitarian
<input checked="" type="checkbox"/> 1800-1899	<input type="checkbox"/> commerce	<input checked="" type="checkbox"/> exploration/settlement	<input type="checkbox"/> philosophy	<input type="checkbox"/> theater
<input checked="" type="checkbox"/> 1900-	<input type="checkbox"/> communications	<input type="checkbox"/> industry	<input checked="" type="checkbox"/> politics/government	<input type="checkbox"/> transportation
		<input type="checkbox"/> invention		<input type="checkbox"/> other (specify)

Specific dates c.1859; c.1907

Builder/Architect Unknown

### Statement of Significance (in one paragraph)

The Webber House is a significant historical link to two families who have had a major impact upon the development of Napa County: 1) the Grigsby family, pioneer settlers of the Yountville region of Napa County in 1845 and descendants of Capt. John Grigsby, active in the Bear Flag War and 2) the Webber family, active in Napa government for two generations, including Napa County Supervisor John Lee Webber (1904-1912) and his sons, Napa County Assessor Samuel Webber and Superintendent Eugene Webber of the Napa County Infirmary. The Webber House also reflects the common practice of moving buildings in the 19th century and its incorporation into a larger farmhouse of the turn-of-the-century which remains essentially unaltered from that period.

The original core of the Webber House, a one and 1/2 storey Greek Revival house, located on the Finnell Ranch east of Yountville in the 1850's, was occupied by Sylvester and Polly Grigsby. Capt. John Grigsby, leader of a major wagon train party which brought many of the earliest pioneer families to Napa County in 1845, settled in the Napa Valley east of Yountville. He subsequently served in the Bear Flag <sup>Revolt</sup> with Capt. Fremont and escorted the Vallejos to Sutter's Fort under guard. He returned East in 1861, but his son, Sylvester Grigsby, a farmer, remained. Nancy Jane Grigsby, daughter of Sylvester and Polly Grigsby, was born in the Greek Revival house in 1859 on the Finnell Ranch. There were also four Grigsby sons: John, Sam, Fred and Guy.

John Lee Webber moved to Napa County in 1876. He was born in Maine in 1849 and had moved to Virginia City, Nevada in 1870 prior to arriving in Napa County. He married Nancy Jane Grigsby in 1880. John Webber served as foreman of the Hopper Ranch west of Yountville and then leased the Boyce Ranch 3 miles south of Yountville. There for 16 years he engaged in the mixed agriculture of the period: hay and grain, vegetables and livestock. He ran a butcher business for many years with wagons running from Oak Knoll to Rutherford. He also operated a thresher.

In 1904, John Webber was elected Supervisor for the Napa County district including Yountville. He continued as Supervisor until his death in 1912, when his son, Sam Webber, was appointed to fill his term. Sam Webber continued as Napa County Assessor for more than 40 years. The Webber family moved from the ranch to Yountville in 1905 when John Webber retired from ranching and devoted full-time to his Supervisor duties. His particular interest as Supervisor was in transportation in the County, particularly the roads and bridges. He advocated the replacement of wood bridges with stone and as a result of his efforts and those of a few Supervisors, Napa County became known as the "County of Stone Bridges", many of which remain today.

The Webber family moved into the house in Yountville in 1905 which had been moved to the site from the Finnell Ranch in the 1860's. The Webbers enlarged the house and added the barn. The Webber House would remain in the family until Nancy Jane Grigsby Webber died in 1929. The House and Barn, long known as the Webber Place, retain a turn-of-the-century character and clearly illustrate the evolution of a residence from the mid-19th century to the early 20th. The Webber name, well-known in Napa County, has been given to the street which runs in front of the Webber House and Barn.

# 9. Major Bibliographical References

Interview with Mrs. Laura Mae Webber Tarver, June 28, 1980  
 Gregory, Tom. History of Solano and Napa Counties (1912), 726.  
 Slocum & Bowen. History of Napa and Lake Counties (1881), 316.  
 Yountville Cemetery  
 /Napa Register: 7-5-1895

ACREAGE NOT VERIFIED  
 DATA NOT VERIFIED

# 10. Geographical Data

Acreege of nominated property 100' x 160' (16,000 sq.ft.) 0.367 acre  
 Quadrangle name Yountville Quadrangle scale 1:24000

UMT References

A	<u>10</u>	<u>555</u>	<u>650</u>	<u>425</u>	<u>670</u>	B			
	Zone	Easting	Northing				Zone	Easting	Northing
C						D			
E						F			
G						H			

### Verbal boundary description and justification

A rectangular parcel of land (AP#36-053-04) in Yountville extending 100' north on Jefferson St., 160' east, then 100' south to Webber St. and then 160' west to the corner of Jefferson and Webber Streets.

List all states and counties for properties overlapping state or county boundaries

state	code	county	code
state	code	county	code

# 11. Form Prepared By

name/title Judith A. Munns (P.O.Box 2893 Yountville, CA 94599 707-963-7611)  
 organization (for owner) Loren K. Holte date August 28, 1980  
 street & number P.O.Box 2873 telephone (707) 944-8384  
 city or town Yountville state California 94599

# 12. State Historic Preservation Officer Certification

The evaluated significance of this property within the state is:

national  state  local

As the designated State Historic Preservation Officer for the National Historic Preservation Act of 1966 (Public Law 89-665), I hereby nominate this property for inclusion in the National Register and certify that it has been evaluated according to the criteria and procedures set forth by the Heritage Conservation and Recreation Service.

State Historic Preservation Officer signature K. M. Ellison

title State Historic Preservation Officer date 10-13-81

For HCRS use only

I hereby certify that this property is included in the National Register

William H. Abraham date 1-19-82

Keeper of the National Register

Attest: Patricia Andrus date 1/19/82

Chief of Registration

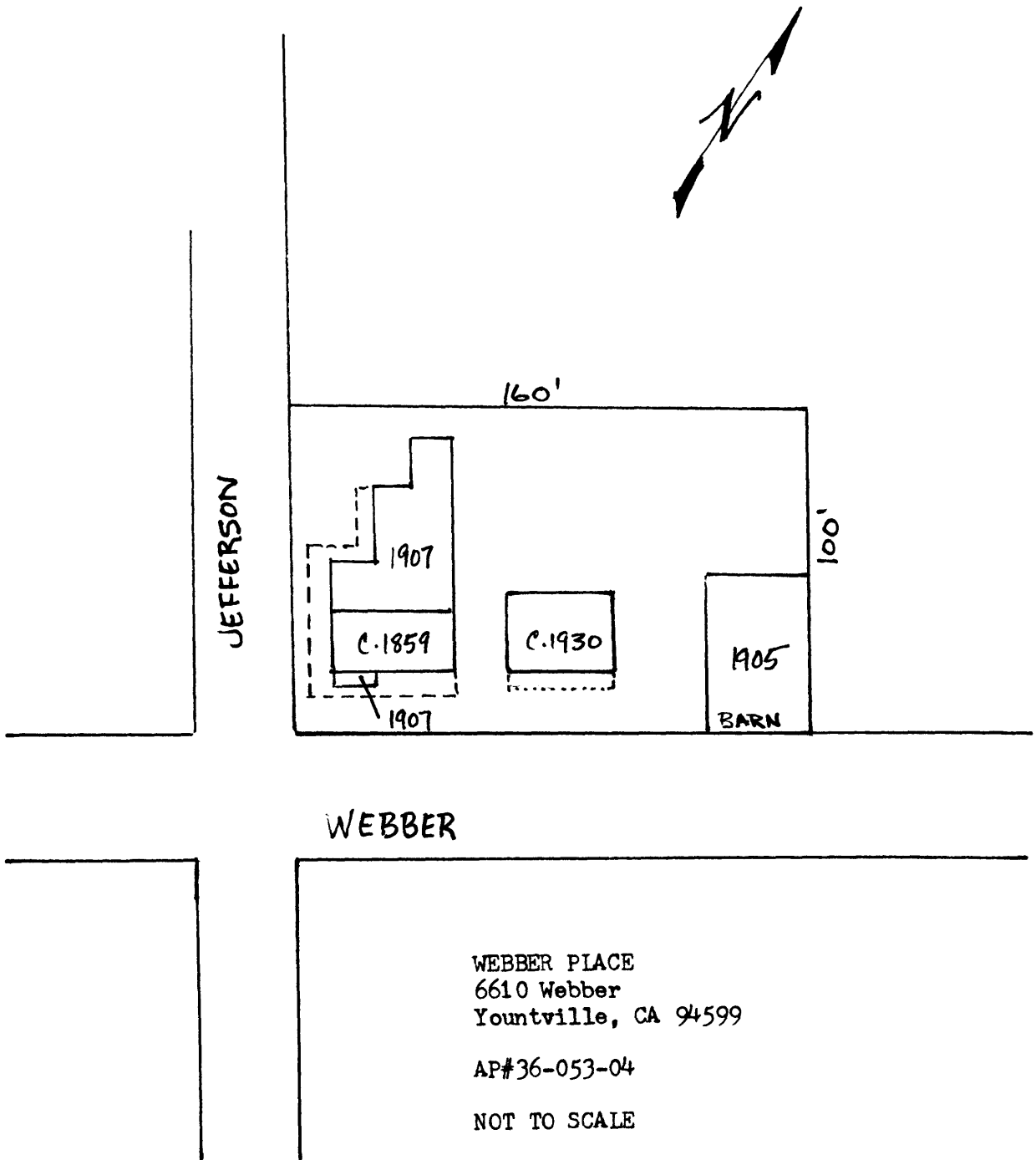

WEBBER

WEBBER PLACE  
6610 Webber  
Yountville, CA 94599

AP#36-053-04

NOT TO SCALE

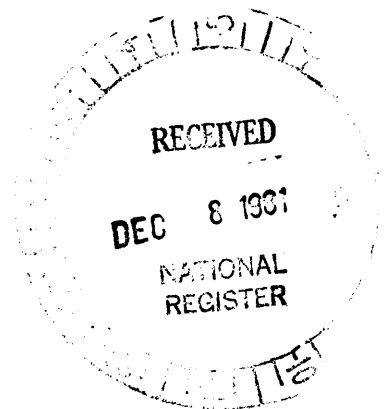

JAN 19 1982