

13. CATLIN WILSON HOUSE
237 Wilson Ave.

Mrs. Cecil R. Glass and Mr. William R. Ward
237 Wilson Ave.
Eutaw, AL 35462

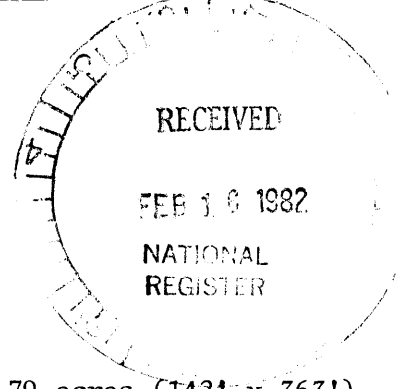

Part of Lot 186 Tax Map 35-18-08-33-4-7-12 .79 acres (142' x 363')

Latitude: 32° 50' 17"

Longitude: 87° 53' 17"

mid 1840s Builder/Architect unknown
mid 19th century ell addition

SIGNIFICANCE: Catlin Wilson was a dry goods merchant in Eutaw, selling in addition groceries; spices and wines. His home was both large and stylish and it has been maintained in proper repair since. It exists now in almost pristine original condition with many of its old dependencies. It, along with the Hale House (#13) are Eutaw's prime examples of the story-and-a-half house.

DESCRIPTION: The Catlin Wilson House is about a foot wider and 3 feet deeper than the front block of the Hale (#13) House. Their porticoes are practically identical in size, though the Wilson House has flush boards rather than plaster on the wall, a transom across the doorway, and it lacks panels under the windows. It retains its original Doric columns. The staircase in the transverse hall has an open well; it rises against the south wall to a landing that crosses at the rear, and another flight continues toward the middle of the house to the second floor. The generous size of the triple windows to the two upper chambers is remarkable: they reach from floor to ceiling and are about half the width of the outer walls. The four lower rooms are nearly of a size. The parlor and dining room, on the south side, open to a small porch on the right flank; and an open gallery spanned the back of the house, only the south end may have been enclosed as a pantry off the dining room. Wood trim resembles that of the Hale House.

REMODELING: An ell was built at an early date, perhaps for Thomas H. Herndon, who bought the place from Wilson for \$6,000 on November 20, 1858, or by George H. Dunlap, who purchased it from Herndon for \$3,500 on December 10, 1869. The ell contains two bedrooms and a gallery along the south side. Details, such as the pilastered chimney-pieces, resemble those in the main part of the house. Inasmuch as the two brick dependencies - a double storehouse connected by a dogtrot, and a kitchen-laundry building - are integral with a walk system expanded from the wing, they probably were built in the same improvement program. The quarters, farther back, are less related, and being larger, and of wood, perhaps date from the time of the original house. Stable, carriage house and privies probably were on the north side of the lot, but nothing remains of them.

CATLIN WILSON HOUSE CONTINUED

HISTORICAL NOTES: Notice should be taken of the concave curve of the front fence with its turnip-shaped pickets, posts and lattice gates. An old photograph showing George H. Dunlap standing at the entrance reveals the early posts a little higher and without balls on top. The old walk circled a mound between the gate and portico. It looks as though trees were planted in balance across the central axis. Such landscaping was considered proper in Eutaw. William Courson, who had worked here at least since the summer of 1839, was both a builder and landscape architect. In the mid 1850's he advertised as engaging in "ORNAMENTAL" work on front grounds in the best manner.

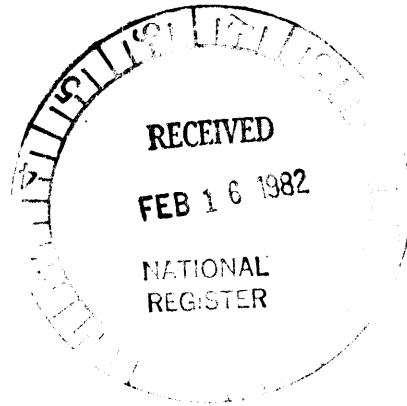

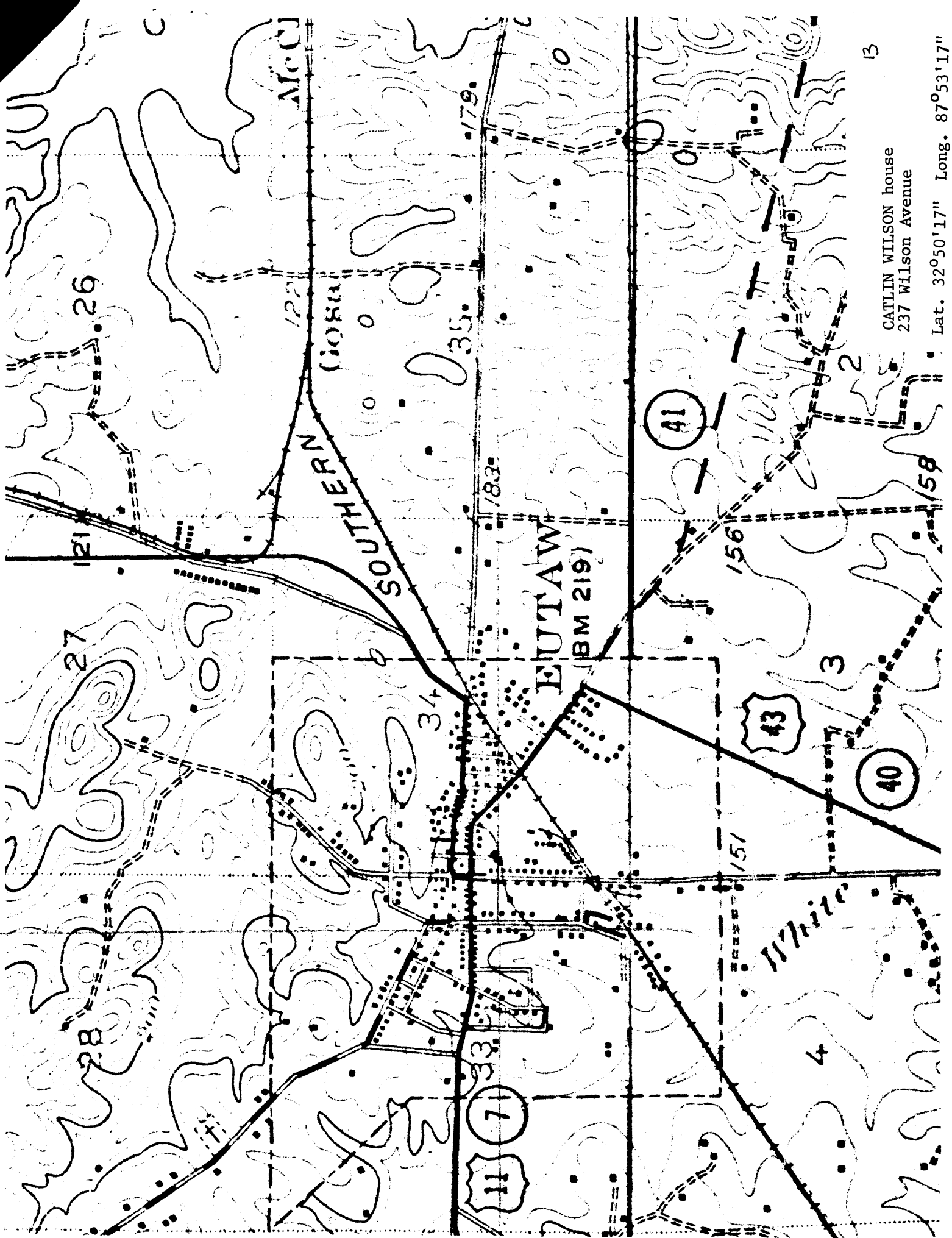

CARLIN WILSON house
237 Wilson Avenue

13

Lat. 32°50'17" Long. 87°53'17"