

United States Department of the Interior
National Park Service

National Register of Historic Places
Inventory—Nomination Form

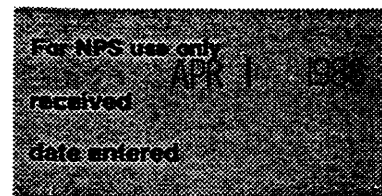

Continuation sheet

Item number¹, 2, 4, 7, 8, 10

Page 47

1. Name: Antonio Torres House, survey number 84
2. Location: approximately 200' north of Highway 90 immediately west of Mimbres River bridge
4. Owner: Antonio Torres, 1310 E. Belmont Ave., Anaheim, Ca. 92805
7. Description: Photo 46; map 10; stone rubble foundation; stuccoed adobe; corrugated metal hipped roof with gabled entrance porch; 6/6 double hung windows; single door. A contemporaneous wooden shed stands to the side of the house.
8. Significance: Built about 1930 by Antonio Torres and his wife Josefina Ancheta, a descendent of N.Y. Ancheta. They operated the Black Range station, half a mile east on Highway 90, for thirty years starting in the late 1920s. Although the house uses the locally typical adobe and corrugated roofing it has a rectangular plan and facade symmetry derived from turn-of-the-century Classicism which gave rise to a modest type in New Mexico which the Building Inventory Manual calls the Hipped Box. The house meets Criterion C as a good example of this historic building type.
10. Geographical Data: Approximate Acreage: less than one.
Quadrangle Name: San Lorenzo, N.M. Scale: 1: 62,500
UTM References: 13 226800 3631700
Verbal boundary: A rectangle, roughly 40' by 50', as shown in map 10, formed by lines parallel to and ten feet from the north, south and west sides of the house and the east side of the shed. Since this is an unplatted area, this boundary has been created to include only the house and shed.

10. Antonio Torres House (84)
Historic Resources of the
Mimbres Valley, 1987

N ↑ Photo 

Not to Scale

Boundary - - - - -

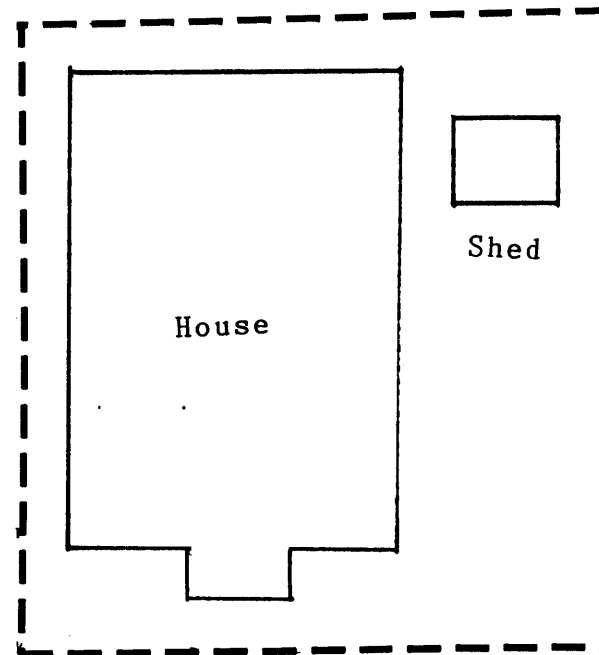

45

United States Department of the Interior
National Park Service

National Register of Historic Places
Continuation Sheet

Section number 4 Page 6

Clyde A. Bloodgood House

Joyce Biebelle
Route 15, Box 1850
San Lorenzo, NM 88057

Luciana B. Grijalva House

John Justus
Box 38
Peralta, NM 87042

Menard-Galaz House

Robert Galaz
Route 15, Box 2375
San Lorenzo, NM 88057

Acklin Store

Santa Fe Mountaineering Center
Route 4, Box 34c
Santa Fe, NM 87501

Antonio Torres House

Antonio Torres
1310 E. Belmont Ave.
Anaheim, Ca. 98205

Mauricio Portillo Homestead

Santiago & Bersabe V. Hinojosa
Box 121
Hanover, NM 88041

Jesus Valencia House

Refugio Valencia
San Lorenzo, NM 88057

George O. Perrault Compound

Charles Disert
Route 15, Box 800
San Lorenzo, NM 88057

San Juan Teacherage

Charles Disert
Route 15, Box 800
San Lorenzo, NM 88057

NAN Ranch

W.B. Hinton, NAN Ranch
Route 15, Box 1425
Faywood, NM 88034

United States Department of the Interior
National Park Service

APR 1 1988

National Register of Historic Places Continuation Sheet

Section number _____ Page _____

Multiple Resource Area
Thematic Group

Name Mimbres Valley MRA
State Grant County, NEW MEXICO

Nomination/Type of Review

Date/Signature

- DOE/OWNER OBJECTION**
- | | | | |
|---------------------------------|-------------------------------------|--------|---|
| 11. Bloodgood, Clyde A., House | Substantive Review | Keeper | <u>Determined Eligible</u>
<u>Eligible - Beth Boland 5/16/88</u> |
| | | Attest | _____ |
| 12. Grijalva, Luciana B., House | Entered in the
National Register | Keeper | <u>Melrose Byrum 5/16/88</u> |
| | | Attest | _____ |
| 13. Menard--Galaz House | Entered in the
National Register | Keeper | <u>Melrose Byrum 5/16/88</u> |
| | | Attest | _____ |
| 14. Acklin Store | Entered in the
National Register | Keeper | <u>Melrose Byrum 5/16/88</u> |
| | | Attest | _____ |
| 15. Torres, Antonio, House | Entered in the
National Register | Keeper | <u>Melrose Byrum 5/16/88</u> |
| | | Attest | _____ |
| 16. Portillo, Mauricio, House | Substantive Review | Keeper | <u>Beth Boland 5/16/88</u> |
| | | Attest | _____ |
| 17. Valencia, Jesus, House | Entered in the
National Register | Keeper | <u>Melrose Byrum 5/16/88</u> |
| | | Attest | _____ |
| 18. Perrault, George O., House | Entered in the
National Register | Keeper | <u>Melrose Byrum 5/16/88</u> |
| | | Attest | _____ |
| 19. San Juan Teacherage | Entered in the
National Register | Keeper | <u>Melrose Byrum 5/16/88</u> |
| | | Attest | _____ |
| 20. NAN Ranch | Entered in the
National Register | Keeper | <u>Melrose Byrum 5/16/88</u> |
| | | Attest | _____ |