

United States Department of the Interior
National Park Service

National Register of Historic Places Inventory—Nomination Form

See instructions in *How to Complete National Register Forms*
Type all entries—complete applicable sections

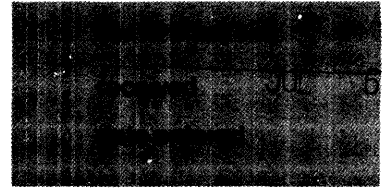

1. Name

historic George Parker Long House

and/or common Same

2. Location

street & number 1401 Maple Street N/A not for publication

city, town Winnfield N/A vicinity of ~~congressional district~~ 5th - Jerry Huckaby

state LA code 22 ~~county~~ parish Winn code 127

3. Classification

Category	Ownership	Status	Present Use
<input type="checkbox"/> district	<input type="checkbox"/> public	<input checked="" type="checkbox"/> occupied	<input type="checkbox"/> agriculture
<input checked="" type="checkbox"/> building(s)	<input checked="" type="checkbox"/> private	<input type="checkbox"/> unoccupied	<input type="checkbox"/> commercial
<input type="checkbox"/> structure	<input type="checkbox"/> both	<input type="checkbox"/> work in progress	<input checked="" type="checkbox"/> private residence
<input type="checkbox"/> site	Public Acquisition	Accessible	<input type="checkbox"/> religious
<input type="checkbox"/> object	<u>N/A</u> in process	<input checked="" type="checkbox"/> yes: restricted	<input type="checkbox"/> scientific
	<u>N/A</u> being considered	<input type="checkbox"/> yes: unrestricted	<input type="checkbox"/> transportation
		<input type="checkbox"/> no	<input type="checkbox"/> other:

4. Owner of Property

name Dr. and Mrs. Randolph L. Williams

street & number 1401 Maple Street

city, town Winnfield N/A vicinity of state LA 71483

5. Location of Legal Description

courthouse, registry of deeds, etc. Winn Parish Courthouse

street & number located on Main Street
no specific mailing address or street address

city, town Winnfield state LA 71483

6. Representation in Existing Surveys

title LA Historic Sites Survey has this property been determined eligible? yes no

date 1981 federal state county local

depository for survey records Louisiana State Historic Preservation Office

city, town Baton Rouge state LA

7. Description

Condition		Check one	Check one
<input type="checkbox"/> excellent	<input type="checkbox"/> deteriorated	<input type="checkbox"/> unaltered	<input checked="" type="checkbox"/> original site
<input checked="" type="checkbox"/> good	<input type="checkbox"/> ruins	<input checked="" type="checkbox"/> altered	<input type="checkbox"/> moved date <u>N/A</u>
<input type="checkbox"/> fair	<input type="checkbox"/> unexposed		

Describe the present and original (if known) physical appearance

The George P. Long House (c.1905) is a large frame 1-1/2 story Queen Anne Revival residence. It is located in an outlying, well treed residential area of Winnfield and is encompassed by a cast-iron fence. The only alteration since construction has been the sheetrocking of the interior walls, which were originally covered with canvas and then wallpapered. This type of alteration is common among residences of this period and should be regarded as minor.

The Long House has a central hall plan with two rooms on each side and a rear kitchen wing. The front two-thirds of the house is encompassed within a twelve bay Colonial Revival gallery with curved corners. The wide central hall has a pair of freestanding Tuscan columns on bases which frame an imperial staircase. The four main rooms have corner fireplaces which feed into two chimneys set either side of the hall. Two of the downstairs rooms have semioctagonal bays and one has a corner turret. (The turret does not extend above the roofline.)

The complex roofline consists of a pitched roof with two massive gablet dormers which have a broad arched balcony between them. This configuration is surrounded by a skirting roof. The side gables have flared jerkins set within the peaks. The two dormers have very unusual two sided bay windows.

The surface is well textured with imbricated shingles, framing boards, and narrow gauge clapboards.

Aside from the grand staircase, the interiors are relatively plain, featuring some wainscoting and catalog ordered oak mantels.

Integrity: See Summary Paragraph

8. Significance

Period	Areas of Significance—Check and justify below			
<input type="checkbox"/> prehistoric	<input type="checkbox"/> archeology-prehistoric	<input type="checkbox"/> community planning	<input type="checkbox"/> landscape architecture	<input type="checkbox"/> religion
<input type="checkbox"/> 1400–1499	<input type="checkbox"/> archeology-historic	<input type="checkbox"/> conservation	<input type="checkbox"/> law	<input type="checkbox"/> science
<input type="checkbox"/> 1500–1599	<input type="checkbox"/> agriculture	<input type="checkbox"/> economics	<input type="checkbox"/> literature	<input type="checkbox"/> sculpture
<input type="checkbox"/> 1600–1699	<input checked="" type="checkbox"/> architecture	<input type="checkbox"/> education	<input type="checkbox"/> military	<input type="checkbox"/> social/ humanitarian
<input type="checkbox"/> 1700–1799	<input type="checkbox"/> art	<input type="checkbox"/> engineering	<input type="checkbox"/> music	<input type="checkbox"/> theater
<input type="checkbox"/> 1800–1899	<input type="checkbox"/> commerce	<input type="checkbox"/> exploration/settlement	<input type="checkbox"/> philosophy	<input type="checkbox"/> transportation
<input checked="" type="checkbox"/> 1900–	<input type="checkbox"/> communications	<input type="checkbox"/> industry	<input type="checkbox"/> politics/government	<input type="checkbox"/> other (specify)
		<input type="checkbox"/> invention		

Specific dates c. 1905 **Builder/Architect** Builder - George P. Long

Statement of Significance (in one paragraph) Criterion C

The George P. Long House is architecturally significant on the local level as a superior example of a Queen Anne Revival residence within the context of the town of Winnfield. This can be demonstrated by comparing it with other houses of the period in the town. Even the largest turn-of-the-century houses in Winnfield are no more than enlarged cottages with a single forward facing gable off to the side, a single semioctagonal bay, and a three to five bay gallery.

In contrast, the Long House has:

1. An imposing curved twelve bay gallery. (This feature is customarily found on only some of the grandest period residences in the state.)
2. An extra wide hall and an imperial staircase which is unmatched elsewhere in Winnfield.
3. Two semioctagonal bays and a turret. Most Queen Anne Revival residences in Winnfield, and indeed Louisiana, have no turrets and only one semioctagonal bay.
4. The most elaborate and distinctive roofline in Winnfield. Significant features in this regard include the four gables, the arched balcony, the flared eaves set under the side gables, and the highly unusual two-sided bay windows set in the front dormers.

Historical Sketch

George P. Long built the house c.1905 and resided there during the remainder of his life. He was born in Mississippi in 1849, and ten years later his parents moved to Winn Parish.

Long's first venture into the business world came in 1884, when he opened a general store in Winnfield. After several years as a prosperous merchant, Long sold out and devoted much of his time to real estate operations. He sold a great many farms and handled most of the land within the town limits of Winnfield. He individually built a number of houses and at one time owned or controlled 48 dwellings in Winnfield. In the parish rolls of 1900, eighteen Longs were listed as landowners, the largest holder being George P., with 2,300 acres. He was one of the largest stockholders of the Bank of Winnfield and Trust Company when the firm was organized in 1901 and was a member of the original Board of Directors and president of the bank from 1902 to 1907. Long was also associated with the organization of the Continental Bank and Trust Company of Shreveport.

9. Major Bibliographical References

Williams, T. Harry. Huey Long. New York: Alfred A Knopf, 1970.

Chambers, Henry E. History of Louisiana. Volume 3. American Historical Society, 1925.
(continued)

10. Geographical Data

Acree of nominated property approx. .8 acre

Quadrangle name Winnfield, LA

Quadrangle scale 1:62,500

UMT References

A

1	5	5	3	5	2	5	0	3	5	3	2	2	2	5
Zone			Easting				Northing							

B

Zone			Easting				Northing							

C

Zone			Easting				Northing							

D

Zone			Easting				Northing							

E

Zone			Easting				Northing							

F

Zone			Easting				Northing							

G

Zone			Easting				Northing							

H

Zone			Easting				Northing							

Verbal boundary description and justification

See attached sketch map.

List all states and counties for properties overlapping state or county boundaries

state	N/A	code	county	code

state	code	county	code

11. Form Prepared By

name/title Dr. and Mrs. Randolph L. Williams

organization N/A

date March 1981

street & number 1401 Maple Street

telephone (318) 628-2734

city or town Winnfield

state LA 71483

12. State Historic Preservation Officer Certification

The evaluated significance of this property within the state is:

national state local

As the designated State Historic Preservation Officer for the National Historic Preservation Act of 1966 (Public Law 89-665), I hereby nominate this property for inclusion in the National Register and certify that it has been evaluated according to the criteria and procedures set forth by the National Park Service.

State Historic Preservation Officer signature

Robert B. DeBlieux

title State Historic Preservation Officer

date June 25, 1982

For NPS use only

I hereby certify that this property is included in the National Register



date 8-11-82

Keeper of the National Register

Attest:

date

Chief of Registration

**United States Department of the Interior
Heritage Conservation and Recreation Service
National Register of Historic Places
Inventory—Nomination Form**



Continuation sheet George P. Long House

Item number 9

Page 2

BIBLIOGRAPHY (CONTINUED)

Research Report Prepared by Owners. Located in George P. Long House National Register File, Louisiana State Historic Preservation Office, Baton Rouge.

George P. Long House

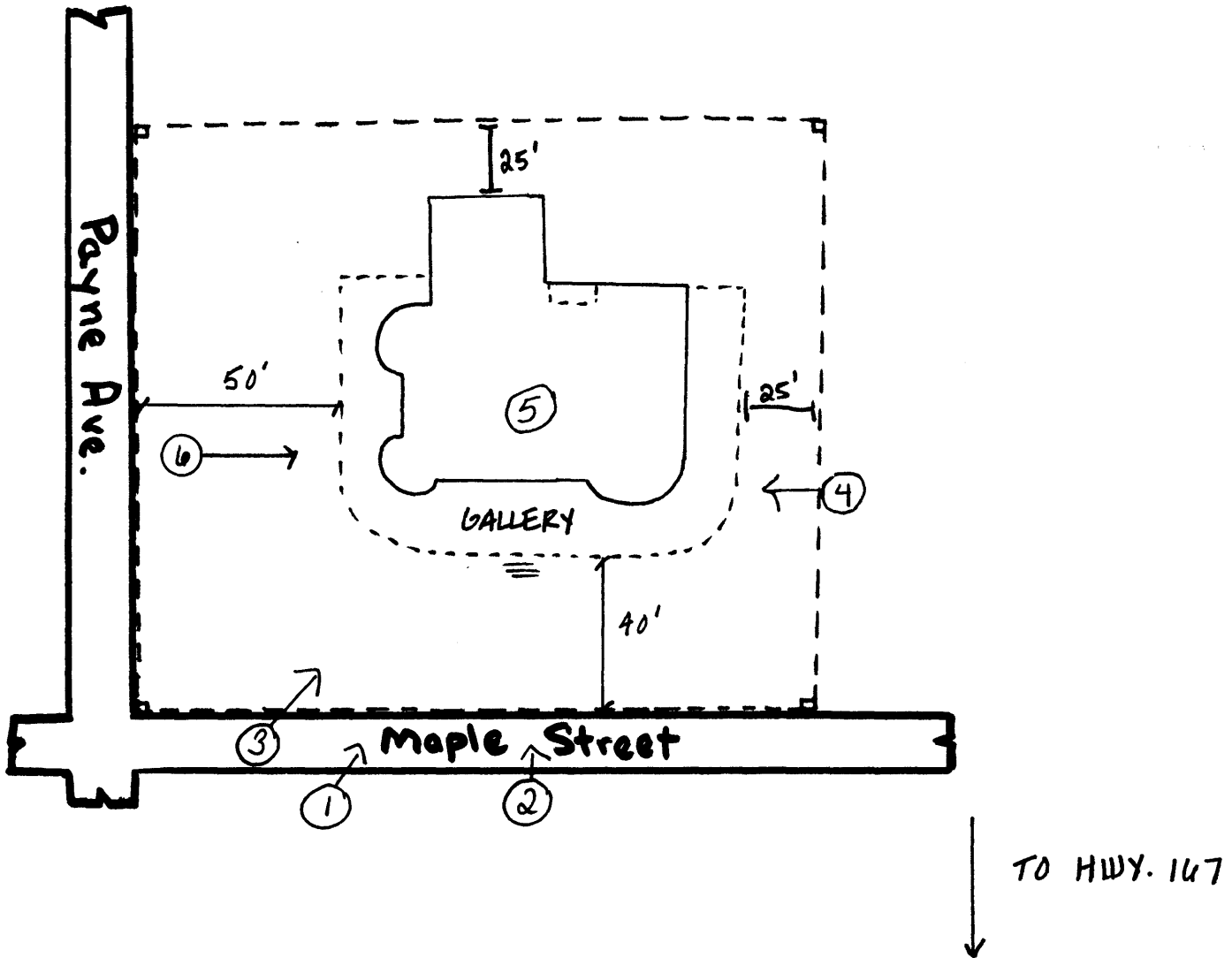

NOTE: SITE BOUNDARIES PARALLEL BLDG. FACADES AND STREETS, FOLLOWING INSIDE CURBLINES, AND AT DISTANCES SHOWN.

N
↑
SCALE 1" = 50' APPROX.