

50

AUG 21 1989

FORM B - BUILDING

MASSACHUSETTS HISTORICAL COMMISSION
80 BOYLSTON STREET
BOSTON, MA 02116

NATIONAL REGISTER

WALTHAM, MA MRA
Waltham, Massachusetts

Town Waltham, MA MRA

Address 23-25 Taylor Street

Historic Name N/A

Leonard W. Stanley House

Use Present private residential

Original private residential

Photo (3"x 3" or 3"x5", black and white) Indicate address of property on back of photo. Staple to left side of form.

DESCRIPTION

Date ca. 1855 - 1856

Source deed research

Style late Federal/Italianate

Architect unknown

Exterior Wall Fabric clapboard

Outbuildings garage NC

Major Alterations (with dates) late

19th century rear additions

Condition good

Moved no - Date -n/a

Acreage 9,166 sq. ft. 0.21A. 69-17-5

Setting Situated on rise, bordered

on 3 sides by rubblestone retaining

wall.

Sketch Map: Draw map showing property's location in relation to nearest cross streets and/or geographical features. Indicate all buildings between inventoried property and nearest intersection(s). Indicate north

UTM REFERENCE 19/315840/4693040

USGS QUADRANGLE NEWTON

SCALE 1:25,000

Recorded by Edward W. Gordon

Organization Waltham Hist. Comm.

Date June, 1986

revised C. Jenkins 2/88

NATIONAL REGISTER CRITERIA STATEMENT (if applicable)

#23/25 Taylor Street ranks among the oldest houses on Waltham's South Side. Built ca. 1855-1856, this house represents an unusual blend of late-Federal form and Italianate elements. For many years it was the home of Leonard W. Stanley, policeman. This house possesses integrity of location, design, materials, workmanship, feeling and associations, and meets criterion C of the National Register of Historic Places.

ARCHITECTURAL SIGNIFICANCE Describe important architectural features and evaluate in terms of other buildings within the community.

23/25 Taylor Street represents an interesting example of a house which might be mistaken for a center-hall-plan Federal farm house, were it not for certain Italianate features such as its deep cornice, segmental-arch attic windows, and steeply-pitched gable roof, with return eaves. The house rises 2 stories, from a low granite-block foundation to a gable roof. In general, its center entrance and windows are simply enframed and contain 6/6 wood sash. A fascia board runs above the second floor windows of the main facade. The house is U-shaped in plan. Its western ell dates to ca. 1870's, while the east ell postdates 1886. The ell windows are all simply enframed.

HISTORICAL SIGNIFICANCE Explain the role owners played in local or state history and how the building relates to the development of the community.

This house ranks among the oldest houses on Waltham's South Side; and more specifically, it is one of the oldest buildings east of Moody Street. In 1854, Pine, Taylor and Cushing Streets were the only streets located east of Moody Street. #23/25 Taylor Street's lot appears on the 1854 map as part of the large, vacant area on the South side of Taylor Street, between the house of L. Green (or Gray?) and W. Maynard. On September 1st, 1855, Ebenezer D. Gordon of Waltham, manufacturer, sold #23/25 Taylor Street's land to Leonard W. Stanley, policeman, for \$450.00 (see Middlesex Deed - 627:119). At the time of Stanley's purchase, the South Side had only been a part of Waltham for six years. #23/25's section of Taylor Street falls outside the boundaries of the watch factory neighborhood, west of Moody Street, and is not really a part of the chemistry neighborhood, which evolved to the east around this property until at least 1911.

BIBLIOGRAPHY and/or REFERENCES

Maps/Atlases - 1036, 1854, 1874, 1811, 1886, 1900
Middlesex Deeds - 627:119; 717:454
Waltham Directories - 1870's - 1890's

United States Department of the Interior
National Park Service

AUG 21 1989

National Register of Historic Places
Continuation Sheet

Section number _____ Page _____

Multiple Resource Area
Thematic Group

Name Waltham MRA
State Middlesex County, MASSACHUSETTS

Nomination/Type of Review

Date/Signature

Sub

- | | | | | |
|-----|--|------------|-----------------------|----------------|
| 81. | St. Mary's Roman Catholic Church Complex
Substantive Review | for Keeper | <u>Betty L. Swane</u> | <u>9/28/89</u> |
| | | Attest | _____ | _____ |
| 82. | Stanley, Leonard W., House
Entered in the
National Register | for Keeper | <u>Arlene Byers</u> | <u>9/28/89</u> |
| | | Attest | _____ | _____ |
| 83. | Stark Building
Entered in the
National Register | for Keeper | <u>Arlene Byers</u> | <u>9/28/89</u> |
| | | Attest | _____ | _____ |
| 84. | Stark, Robert M., House
Entered in the
National Register | for Keeper | <u>Arlene Byers</u> | <u>9/28/89</u> |
| | | Attest | _____ | _____ |
| 85. | Stearns, Amos, House
Entered in the
National Register | for Keeper | <u>Arlene Byers</u> | <u>9/28/89</u> |
| | | Attest | _____ | _____ |
| 86. | Stewart, Henry, House
Entered in the
National Register | for Keeper | <u>Arlene Byers</u> | <u>9/28/89</u> |
| | | Attest | _____ | _____ |
| 87. | Swasey, James, House
Entered in the
National Register | for Keeper | <u>Arlene Byers</u> | <u>9/28/89</u> |
| | | Attest | _____ | _____ |
| 88. | Tyler, Frank J., House
Entered in the
National Register | for Keeper | <u>Arlene Byers</u> | <u>9/28/89</u> |
| | | Attest | _____ | _____ |
| 89. | United States Watch Company
Entered in the
National Register | for Keeper | <u>Arlene Byers</u> | <u>9/28/89</u> |
| | | Attest | _____ | _____ |
| 90. | Waltham Gas Light Company
Entered in the
National Register | for Keeper | <u>Arlene Byers</u> | <u>9/28/89</u> |
| | | Attest | _____ | _____ |

UNITED STATES DEPARTMENT OF THE INTERIOR
NATIONAL PARK SERVICE

NATIONAL REGISTER OF HISTORIC PLACES
EVALUATION/RETURN SHEET

REQUESTED ACTION: NOMINATION

PROPERTY NAME: Stanley, Leonard W., House

MULTIPLE NAME: Waltham MRA

STATE & COUNTY: MASSACHUSETTS, Middlesex

DATE RECEIVED: 8/21/89 DATE OF PENDING LIST: 9/05/89
DATE OF 16TH DAY: 9/21/89 DATE OF 45TH DAY: 10/05/89
DATE OF WEEKLY LIST:

REFERENCE NUMBER: 89001509

NOMINATOR: STATE

REASONS FOR REVIEW:

APPEAL: N DATA PROBLEM: N LANDSCAPE: N LESS THAN 50 YEARS: N
OTHER: N PDIL: N PERIOD: N PROGRAM UNAPPROVED: N
REQUEST: N SAMPLE: N SLR DRAFT: N NATIONAL: N

COMMENT WAIVER: N

ACCEPT RETURN REJECT 9/28/89 DATE

Entered in the
National Register

ABSTRACT/SUMMARY COMMENTS:

RECOM./CRITERIA _____
REVIEWER _____
DISCIPLINE _____
DATE _____

DOCUMENTATION see attached comments Y/N see attached SLR Y/N

CLASSIFICATION

count resource type

STATE/FEDERAL AGENCY CERTIFICATION

FUNCTION

historic current

DESCRIPTION

architectural classification
 materials
 descriptive text

SIGNIFICANCE

Period Areas of Significance--Check and justify below

Specific dates Builder/Architect
Statement of Significance (in one paragraph)

summary paragraph
 completeness
 clarity
 applicable criteria
 justification of areas checked
 relating significance to the resource
 context
 relationship of integrity to significance
 justification of exception
 other

BIBLIOGRAPHY

GEOGRAPHICAL DATA

acreage verbal boundary description
 UTM's boundary justification

ACCOMPANYING DOCUMENTATION/PRESENTATION

sketch maps USGS maps photographs presentation

OTHER COMMENTS

Questions concerning this nomination may be directed to

_____ Phone _____

Signed _____ Date _____



Stanley, Leonard W., (hus)

MHC # 50

23-25 Taylor St
Waltham MA - MRA



Stanley, Leonard W., (Case

MA #50

23-25 Taylor St.

Waltham, MA MA

WALTHAM, MA MRA

Leonard W. Stanley House #50
23-25 Taylor Street
1" = 100'
1975; updated to 1987
Waltham Engineering Dept.

lot #69-17-5

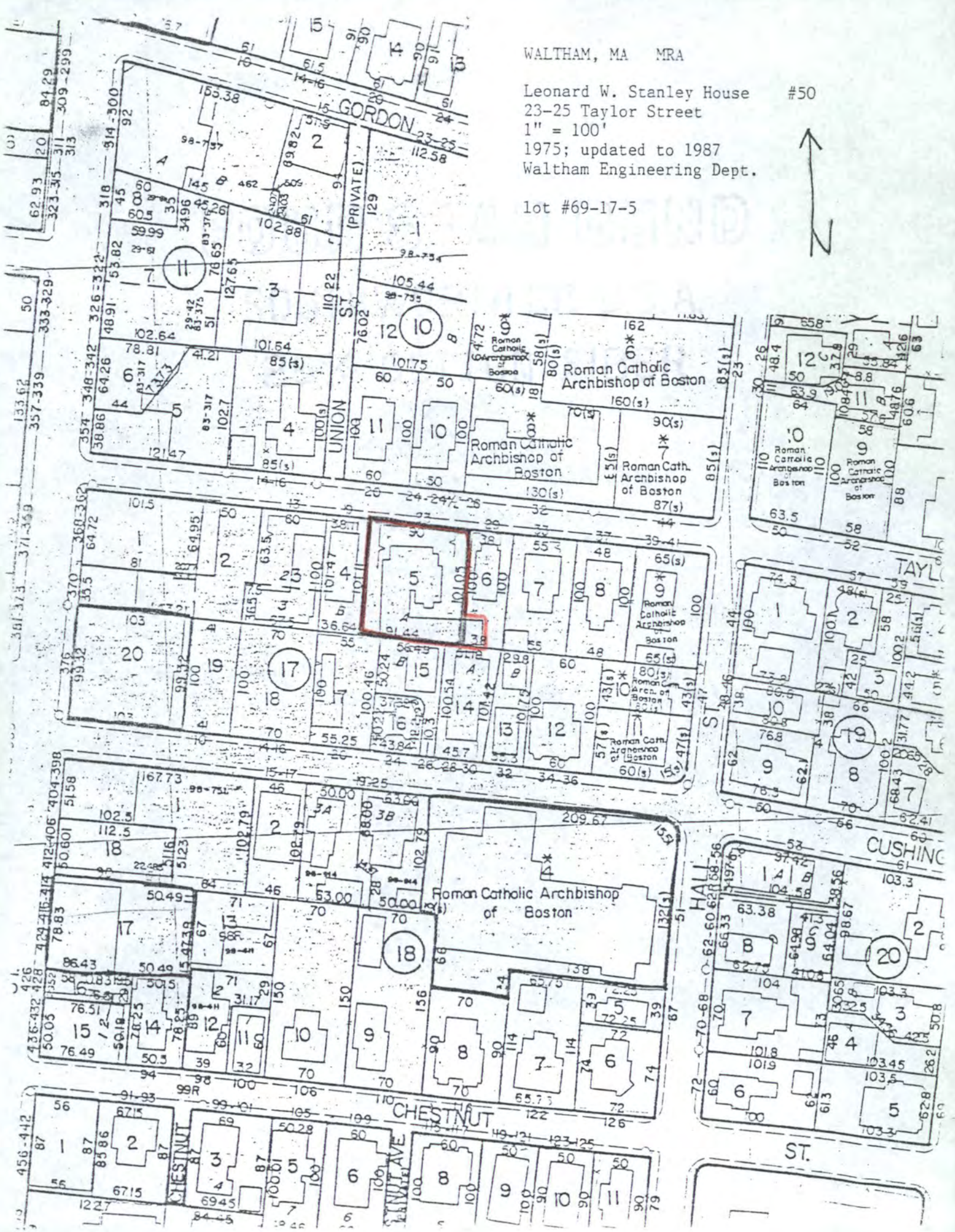

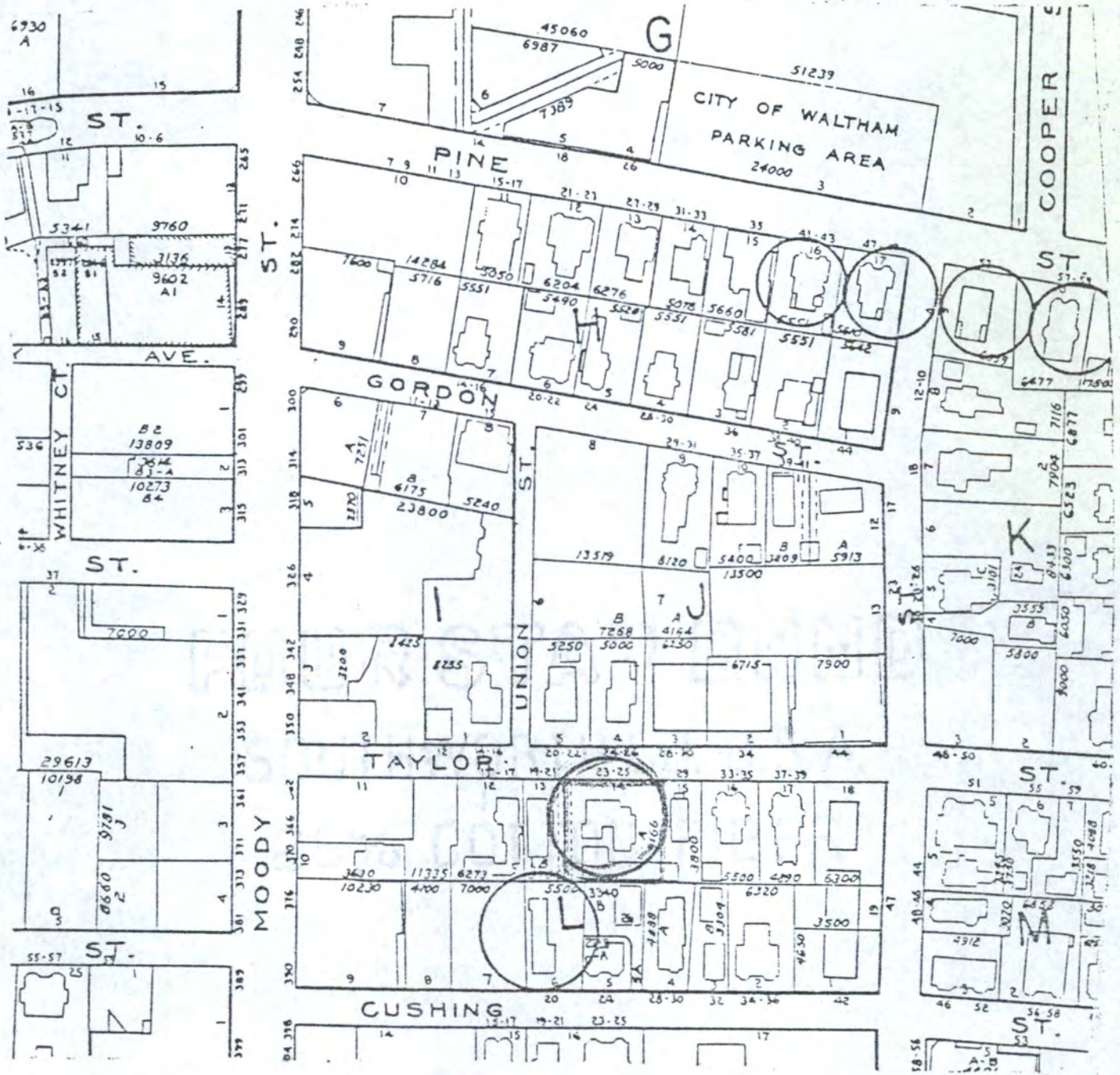

1970 Atlas, City of Waltham
 Compiled by the Waltham
 Engineering Division
 Scale: 1 inch = 140 Feet

Waltham, MA MRA
 23-25 TAYLOR ST
 Leonard Stanley House
 4-L-14, MHC #50

Please refer to the map in the
Multiple Property Cover Sheet
for this property

Multiple Property Cover Sheet Reference Number: 64000301