

**United States Department of the Interior
Heritage Conservation and Recreation Service**

**National Register of Historic Places
Inventory—Nomination Form**

See instructions in *How to Complete National Register Forms*
Type all entries—complete applicable sections

1. Name

historic Chestnut Ridge, Christian Hoopman House
and/or common Chestnut Ridge (preferred)

2. Location

street & number 3850 West Chapel Road n/a not for publication
city, town Aberdeen vic. n/a vicinity of congressional district First
state Maryland code 24 county Harford County code 025

3. Classification

Category	Ownership	Status	Present Use
<input type="checkbox"/> district	<input type="checkbox"/> public	<input checked="" type="checkbox"/> occupied	<input type="checkbox"/> agriculture
<input checked="" type="checkbox"/> building(s)	<input checked="" type="checkbox"/> private	<input type="checkbox"/> unoccupied	<input type="checkbox"/> commercial
<input type="checkbox"/> structure	<input type="checkbox"/> both	<input type="checkbox"/> work in progress	<input type="checkbox"/> educational
<input type="checkbox"/> site	Public Acquisition	Accessible	<input checked="" type="checkbox"/> private residence
<input type="checkbox"/> object	<input type="checkbox"/> in process	<input checked="" type="checkbox"/> yes: restricted	<input type="checkbox"/> religious
	<input type="checkbox"/> being considered	<input type="checkbox"/> yes: unrestricted	<input type="checkbox"/> scientific
	<input checked="" type="checkbox"/> not applicable	<input type="checkbox"/> no	<input type="checkbox"/> transportation
			<input type="checkbox"/> other:

4. Owner of Property

name Dr. and Mrs. Richard A. Mones
street & number 3850 West Chapel Road
city, town Aberdeen n/a vicinity of state Maryland 21001

5. Location of Legal Description

courthouse, registry of deeds, etc. Harford County Courthouse
street & number 40 South Main Street
city, town Bel Air, Maryland state

6. Representation in Existing Surveys

title 1. Maryland Historical Trust Historic Sites Inventory
2. Historic American Bldg. Survey has this property been determined eligible? yes no
date 1. 1983
2. 1936 federal state county local
depository for survey records 1. Maryland Historical Trust, 21 State Circle, Annapolis, MD 21401
2. Department of the Interior, Washington, D. C.
city, town 1. Annapolis state Maryland
2. Washington state D. C.

7. Description

HA-664

Condition		Check one	Check one
<input type="checkbox"/> excellent	<input type="checkbox"/> deteriorated	<input type="checkbox"/> unaltered	<input checked="" type="checkbox"/> original site
<input checked="" type="checkbox"/> good	<input type="checkbox"/> ruins	<input checked="" type="checkbox"/> altered	<input type="checkbox"/> moved date _____
<input type="checkbox"/> fair	<input type="checkbox"/> unexposed		

Describe the present and original (if known) physical appearance

DESCRIPTION SUMMARY

Chestnut Ridge is a c. 1810 two-story brick dwelling with an earlier frame wing located near Aberdeen in Harford County, Maryland. The house is three bays wide and one room deep, with a center-hall plan. The principal (south) facade is laid in Flemish bond, and features a central entrance with a six-panel door surmounted by a 4-light transom and flanked on either side by a 6/9 sash window in a flat-arched opening. A one-story porch spans this facade; with turned columns and scrollwork brackets, this porch represents an addition made in the third quarter of the 19th century. The second story is lighted by three evenly-spaced 6/9 windows. The gable ends are laid in common bond; the east wall has a basement entrance and two 4-light attic windows. A three-course corbeled cornice defines the roofline. The west end shows evidence of alteration to its fenestration, and is currently pierced by a 6/9 window on both stories, offset to the left, and french doors on the right. Both gables have an interior chimney. A 1½-story frame wing extends from the northwest corner; this section, two bays wide by one bay deep with a central chimney, predates the brick section. The house retains considerable integrity and is noteworthy for its vernacular Federal woodwork which remains substantially intact, and for the Greek Revival trim in the east parlor which reflects an early renovation. The house is currently undergoing restoration. Also on the property is a stone springhouse which is being restored. The site of an 18th-century mill, and a marker from the original survey of the tract, also survive on the property.

GENERAL DESCRIPTION

Chestnut Ridge, located on the east side of West Chapel Road, about ½ mile southeast of Aldion Road (Rt. 156), comprises about two acres of landscaped grounds, with five acres of woodland to the east. Bounding the visible acreage is Swan Creek on the south; West Chapel Road on the west; a hedgerow separating this property from Winsted, a National Register site on the north, and a stone wall on the east that runs perpendicular to the hedgerow then turns 90 degrees in an east-west direction back to the woods. Two large Norway spruce trees shade the brick facade year round and a variety of other shrubs, including azaleas, rhododendron, ornamental fruit trees and a large Eastern hemlock offer an attractive view of the landscape. A number of small boxwoods line both sides of a brick path that branches midway to lead to the front and side entrances to the house.

This Federal period house, c. 1800-1810, consists of two sections: a brick section and a frame section. The brick section lies in an east-west direction with the front facing south; the frame section lies in a north-south direction and joins the brick portion at the northwest corner. The brick facade contains a screened porch running almost the full width of the house, with the porch lying just below the second story windows. Turned posts with curvilinear spandrels date the porch c. 1850-60.

United States Department of the Interior
National Park ServiceNational Register of Historic Places
Inventory—Nomination Form

HA-664

For NPS use only

received

date entered

Continuation sheet Chestnut Ridge
Harford County, Maryland Item number 7 Page 1

GENERAL DESCRIPTION

The brick section is 3 bays wide and 1 room deep; 2 stories high with an attic and basement. The front facade is laid in Flemish bond, while the sides and back are common (American) bond. There is a stepped, 3-brick cornice surrounding the brick portion, with two end chimneys. The windows are six over nine with a flat arch above. On the west side is a doorway measuring 3'7½" x 7'6½", thought to be original, but now has 2 french-doors occupying it. The doorway also has a flat arch above it, as do two windows on that side which are directly above each other at the first and second levels. The principal entrance to the brick section is through a 6-panel wooden door with a 4-light transom. The interior is laid out with a center hall floor plan, with a room to the east and west of the hall. A 3-flight stairway has 2 landings with six over six windows at the top of each landing. A small landing is present where the stairs lead to the attic. The handrail is supported by plain, rectangular ballusters, turned newels, and the railing forms an acute angle where it turns to go to the attic stairs. Most of the chair-rail is original in the upstairs, the south wall of the west room of the brick section and the southern room of the frame section. No chair-rail is present in the kitchen. The chair-rail has a ½" bead at the bottom and a bullnose molding at the top of a flat board 3 3/4" high. Window frames throughout both sections have a ½" bead on the inner surface and applied moldings on the outer surface. The moldings in the frame section are slightly smaller in scale. Baseboard is found throughout both sections measuring 6" high with a ½" bead at the top and shoe-molding at the base.

The east room in the brick section has bullseye moldings with fluted frames around the north and south windows and the interior of the door frame. Most of the doors throughout the house have 6-panels, with the exception of batten doors in the room above the kitchen.

The frame section is 1½ stories with a gabled roof and central chimney. It is two rooms in line extending north from the northwest corner of the brick section. Each of the upper rooms has a dormer on the east and west sides, with six lights on the east; nine lights on the west. Windows on the first level are six over six. Walls are plastered throughout the house, with the exception of the west wall of the kitchen where a doorway, not original, was closed.

Fireplaces are found in all but the room above the kitchen, however the fireplace in the upstairs west bedroom in the brick section has been plastered over at some earlier time. All but two fireplaces have wooden mantels with a shelf, while the kitchen fireplace and second level room in the southern section frame portion have only the shelf and plaster surround.

**United States Department of the Interior
National Park Service**

HA-664

**National Register of Historic Places
Inventory—Nomination Form**

For NPS use only

received

date entered

Continuation sheet Chestnut Ridge Item number 7 and 10 Page 2
Harford County, Maryland

GENERAL DESCRIPTION (Continued)

Floors are random width pine floors, with the exception of the south room, first level frame portion which has 2" wide oak boards. The floor in the west room of the first level brick section has unusual plugged, pine floor boards, somewhat uniform in width measuring average 5-6" and containing plugs about 1¼" diameter, in addition to the natural knotholes sporadically positioned in the floorboards. There are as many as four plugs in some boards with no obvious pattern. The room above the kitchen has unusually wide boards, ranging from 7-12" in areas.

Rafters in the attic are visible, with the original roof supports having numbered members in Roman numerals and are jointed in mortise and tenon style. The roof is asphalt shingle.

Spring-House Outbuilding

An original, fieldstone spring-house with an original, stone-lined well lies about 30 feet east of the frame section of the house. The spring-house measures approximately 6 feet 4 inches high by 9 feet 9 inches long, although it is not exactly square. The interior reveals the original trough running along the north and east walls. The building has no roof at present.

Garage

Also on the property is a 1½ story, gambrell-roofed stone garage dating from ca. 1950, which does not contribute to the significance of the resource.

BOUNDARY JUSTIFICATION

The nominated property, approximately two acres, encompasses the resource within its immediate landscaped setting. Boundaries are defined by Swan Creek on the south, West Chapel Road on the west; a hedgerow and stone wall on the north, and a tree line on the east. The boundaries exclude approximately five acres of undeveloped woodland to the east and north, which does not contribute to the significance of the resource.

8. Significance

Period	Areas of Significance—Check and justify below			
<input type="checkbox"/> prehistoric	<input type="checkbox"/> archeology-prehistoric	<input type="checkbox"/> community planning	<input type="checkbox"/> landscape architecture	<input type="checkbox"/> religion
<input type="checkbox"/> 1400-1499	<input type="checkbox"/> archeology-historic	<input type="checkbox"/> conservation	<input type="checkbox"/> law	<input type="checkbox"/> science
<input type="checkbox"/> 1500-1599	<input type="checkbox"/> agriculture	<input type="checkbox"/> economics	<input type="checkbox"/> literature	<input type="checkbox"/> sculpture
<input type="checkbox"/> 1600-1699	<input checked="" type="checkbox"/> architecture	<input type="checkbox"/> education	<input type="checkbox"/> military	<input type="checkbox"/> social/ humanitarian
<input type="checkbox"/> 1700-1799	<input type="checkbox"/> art	<input type="checkbox"/> engineering	<input type="checkbox"/> music	<input type="checkbox"/> theater
<input checked="" type="checkbox"/> 1800-1899	<input type="checkbox"/> commerce	<input checked="" type="checkbox"/> exploration/settlement	<input type="checkbox"/> philosophy	<input type="checkbox"/> transportation
<input type="checkbox"/> 1900-	<input type="checkbox"/> communications	<input type="checkbox"/> industry	<input type="checkbox"/> politics/government	<input type="checkbox"/> other (specify)
		<input type="checkbox"/> invention		

Specific dates 1800-1810 **Builder/Architect** Christian Hoopman

Statement of Significance (in one paragraph)

SIGNIFICANCE SUMMARY

Applicable Criteria: A, C

Chestnut Ridge derives significance from several sources. It represents a type of architecture which is now rare in Harford County: probably fewer than a dozen brick Federal-style houses survive in the county, and of these Chestnut Ridge is a particularly fine example, unusual for its Flemish bond facade with scored joints and for the quantity of original decorative trim that it retains. Other houses of this type in Harford County have generally been heavily restored; Chestnut Ridge has escaped this fate, and current restoration plans emphasize sensitivity and restraint. The 18th century frame portion of the house is also rare in the area. The house derives additional significance from its historical association with the Hoopman family, who were among the earliest and most influential settlers of the Aberdeen area.

HISTORY AND SUPPORT

Christian Hoopman, a brick-molder and artisan, built Chestnut Ridge, as well as building other fine brick structures in the Harford County community. With few existing examples of such architecture today, Chestnut Ridge represents a building that contains many original features of the period, with some alterations being done to maintain the internal and external integrity of the house.

The Chestnut Ridge tract was bought by Christian Hoopman in 1797. Christian and his brother Peter Hoopman, a brick molder and millwright, respectively, both made the bricks for the house and ran a mill on the property, with the contour of the land showing evidence of the millrace.

According to an account written by Jacob P. Walker, grandson of Christian Hoopman, the Hoopman brothers acquired large tracts of land in increments of 500 acres and that by the late 1790's had holdings extending from Swan Creek below Post Road to Hopewell Church and included the land on which the Church stands, as well as the land on which this house stands.

Christian Hoopman is attributed to donating the land and building Wesleyan Chapel, located near the bottom of West Chapel Road on Paradise Road (Rt. 462). He also has been credited with building a larger brick house, now known as Winsted, presently listed as a National Register site, neighboring this property.

The frame part of this house, located on West Chapel Road near a bend in Swan Creek, matches measurements given in the 1798 Federal Tax List. The 1814 tax assessment is incomplete for the Fifth Election District, but it is thought that the brick section was built about 1800-1810.

9. Major Bibliographical References

HA-664

Federal Direct Tax of 1798

Maryland Tax List, 1814

Historical research by Dr. Joseph Sternberg, former owner. (Copy in MHT files, Annapolis).

Walker, Jacob P. "History of Wesleyan Chapel." 1926. (Copy in Md. Hist. Trust files).

10. Geographical Data

Acreege of nominated property approximately 2 acres

Quadrangle name Aberdeen, Maryland

Quadrangle scale 1:24,000

UMT References

A	1 8	3 9 8 5 1 0	4 3 7 9 3 1 0
	Zone	Easting	Northing

B				
	Zone	Easting	Northing	

C			
	Zone	Easting	Northing

D			
	Zone	Easting	Northing

E			
	Zone	Easting	Northing

F			
	Zone	Easting	Northing

G			
	Zone	Easting	Northing

H			
	Zone	Easting	Northing

Verbal boundary description and justification

Boundaries are indicated on the attached map; for boundary justification, see Continuation Sheet #2.

List all states and counties for properties overlapping state or county boundaries

state	n/a	code	county	code
-------	-----	------	--------	------

state	code	county	code
-------	------	--------	------

11. Form Prepared By

name/title	1. Pamela Mones, owner
	2. Michael Trostel, A.I.A. (historical architect)

organization	date	July 1983
--------------	------	-----------

street & number	1. 3850 West Chapel Road	telephone
	2. 1307 Bolton Street	

city or town	1. Aberdeen	Maryland	21001
	2. Baltimore	Maryland	21217

12. State Historic Preservation Officer Certification

The evaluated significance of this property within the state is:

national state local

As the designated State Historic Preservation Officer for the National Historic Preservation Act of 1966 (Public Law 89-665), I hereby nominate this property for inclusion in the National Register and certify that it has been evaluated according to the criteria and procedures set forth by the Heritage Conservation and Recreation Service.

State Historic Preservation Officer signature	<i>J. Mitta</i>	10-27-83
---	-----------------	----------

title	STATE HISTORIC PRESERVATION OFFICER	date
-------	-------------------------------------	------

For HCRS use only	
I hereby certify that this property is included in the National Register	
<i>J. Delores Byers</i>	Entered in the National Register
Keeper of the National Register	date 12/1/83
Attest:	date
Chief of Registration	

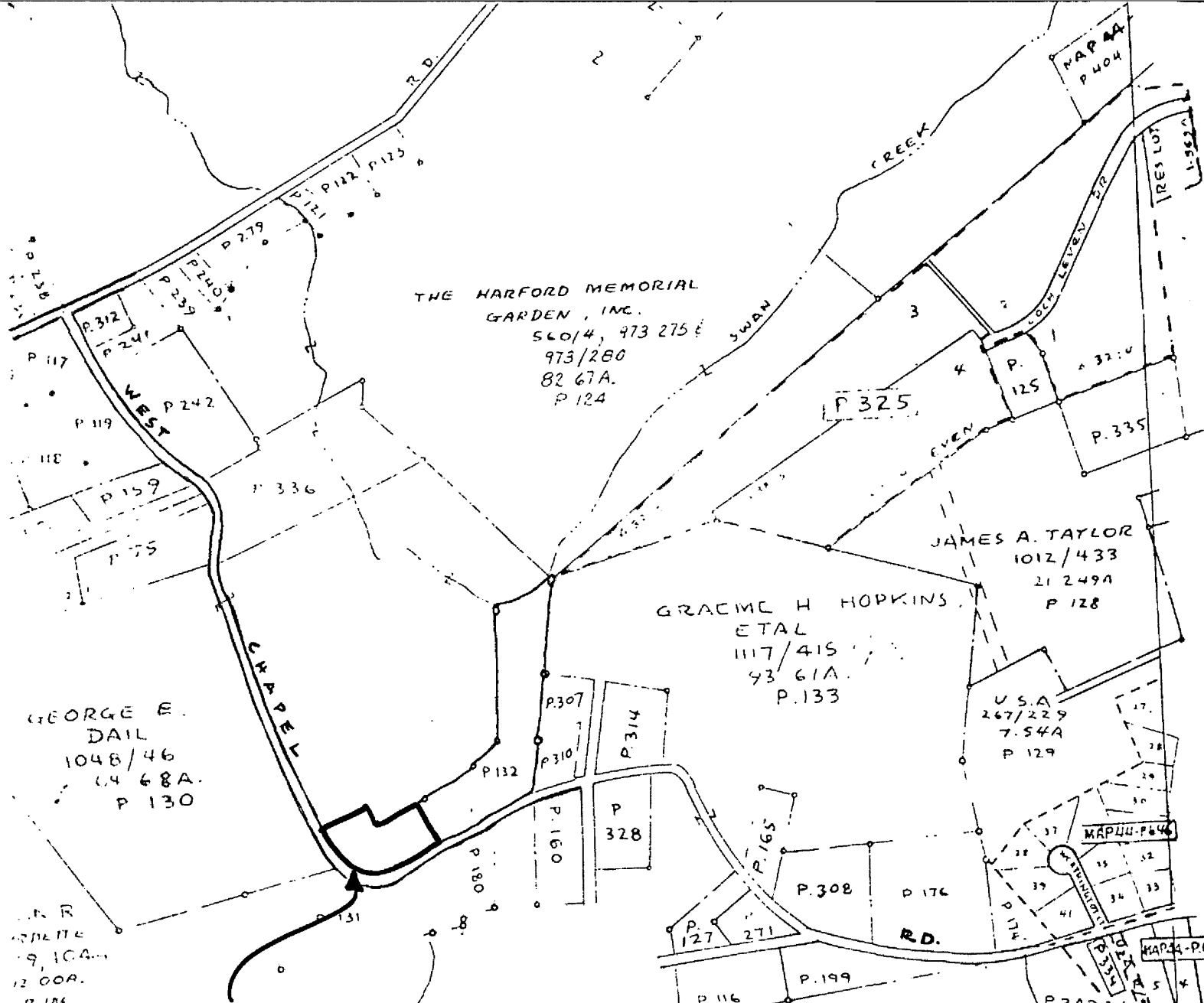

**NATIONAL REGISTER
BOUNDARY**

**CHESTNUT RIDGE (HA-664)
HARFORD COUNTY, MARYLAND**

**OCTOBER 1983
SCALE: 1" = 600'**

SAMUEL T. JONES
1004/517
244.74A
P. 155

ANDREW C. NOPLOCK
489/380
147.49A.
P. 157



SCALE: 1" = 600'

Assessment Of