

PH002-7770

Form 10-300  
(July 1969)

UNITED STATES DEPARTMENT OF THE INTERIOR  
NATIONAL PARK SERVICE

NATIONAL REGISTER OF HISTORIC PLACES  
INVENTORY - NOMINATION FORM

(Type all entries - complete applicable sections)

STATE: Indiana	
COUNTY: Marion	
FOR NPS USE ONLY	
ENTRY NUMBER	DATE
	FEB 20 1973

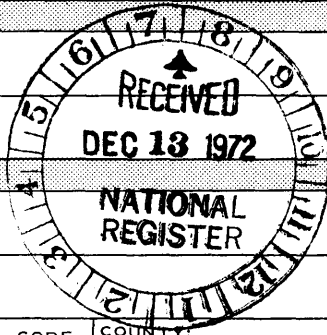

1. NAME

COMMON:  
Morris - Butler House

AND/OR HISTORIC:  
Morris - Butler House

2. LOCATION

STREET AND NUMBER:  
1204 North Park Avenue

CITY OR TOWN:  
Indianapolis,

STATE: Indiana      CODE: 18      COUNTY: Marion      CODE: 097

3. CLASSIFICATION

CATEGORY (Check One)	OWNERSHIP	PUBLIC ACQUISITION	STATUS	ACCESSIBLE TO THE PUBLIC
<input type="checkbox"/> District <input checked="" type="checkbox"/> Building <input type="checkbox"/> Site <input type="checkbox"/> Structure <input type="checkbox"/> Object	<input type="checkbox"/> Public <input checked="" type="checkbox"/> Private <input type="checkbox"/> Both	<input type="checkbox"/> In Process <input type="checkbox"/> Being Considered	<input checked="" type="checkbox"/> Occupied <input type="checkbox"/> Unoccupied <input type="checkbox"/> Preservation work in progress	Yes: <input checked="" type="checkbox"/> Restricted <input type="checkbox"/> Unrestricted <input type="checkbox"/> No
PRESENT USE (Check One or More as Appropriate)				
<input type="checkbox"/> Agricultural <input type="checkbox"/> Commercial <input type="checkbox"/> Educational <input type="checkbox"/> Entertainment	<input type="checkbox"/> Government <input type="checkbox"/> Industrial <input type="checkbox"/> Military <input checked="" type="checkbox"/> Museum	<input type="checkbox"/> Park <input type="checkbox"/> Private Residence <input type="checkbox"/> Religious <input type="checkbox"/> Scientific	<input type="checkbox"/> Transportation <input type="checkbox"/> Other (Specify)	<input type="checkbox"/> Comments

4. OWNER OF PROPERTY

OWNER'S NAME:  
Historic Landmarks Foundation of Indiana

STREET AND NUMBER:  
3402 Boulevard Place

CITY OR TOWN: Indianapolis      STATE: Indiana      CODE: 18

5. LOCATION OF LEGAL DESCRIPTION

COURTHOUSE, REGISTRY OF DEEDS, ETC.:  
City-County Building

STREET AND NUMBER:

CITY OR TOWN: Indianapolis      STATE: Indiana      CODE: 18

6. REPRESENTATION IN EXISTING SURVEYS

TITLE OF SURVEY:  
Historic American Buildings Survey - Indianapolis

DATE OF SURVEY: Summers 1970 & 1971       Federal       State       County       Local

DEPOSITORY FOR SURVEY RECORDS:  
Library of Congress

STREET AND NUMBER:

CITY OR TOWN: Washington      STATE: D.C.      CODE: DC-11

SEE INSTRUCTIONS

STATE: Indiana

COUNTY: Marion

FOR NPS USE ONLY

ENTRY NUMBER: FEB 20 1973

DATE:

**7. DESCRIPTION**

CONDITION

(Check One)	
<input checked="" type="checkbox"/> Excellent	<input type="checkbox"/> Good <input type="checkbox"/> Fair <input type="checkbox"/> Deteriorated <input type="checkbox"/> Ruins <input type="checkbox"/> Unexposed
(Check One)	
<input checked="" type="checkbox"/> Altered	<input type="checkbox"/> Unaltered <input type="checkbox"/> Moved <input checked="" type="checkbox"/> Original Site

DESCRIBE THE PRESENT AND ORIGINAL (if known) PHYSICAL APPEARANCE

French mansard style; red brick walls; grey slated roofs (both mansard & gable); limestone arch at main entrance; wooden front and side porches, dormers and cornice work; limestone foundation walls.

Overall plan dimensions: 46'-0" X 71'-10". Cellar, two principal stories, and attic. Four story tower. Exterior walls and most interior partitions are brick bearing walls. Wood joist floor system; wooden roof construction.

Central hall floor plan with service ell at rear connected by a "breezeway" to a brick summer kitchen. Summer kitchen was reconstructed during late 1960's following original design.

House has been restored by the Historic Landmarks Foundation of Indiana. The interiors are appropriately furnished and decorated with many valuable Victorian furnishings and a small number of suitable modern reproductions where necessary. Some modifications have been made at the second and attic floor to provide a caretaker's apartment and storage spaces. The cellar has been finished to provide meeting rooms for community use.

The lot is surrounded by a black metal fence reproducing one seen in early photographs of the house. The site is well landscaped, including a flower garden.



SEE INSTRUCTIONS

**8. SIGNIFICANCE**

PERIOD (Check One or More as Appropriate)

- |  |                                       |  |                                       |
|--|---------------------------------------|--|---------------------------------------|
| <input type="checkbox"/> Pre-Columbian | <input type="checkbox"/> 16th Century | <input type="checkbox"/> 18th Century            | <input type="checkbox"/> 20th Century |
| <input type="checkbox"/> 15th Century  | <input type="checkbox"/> 17th Century | <input checked="" type="checkbox"/> 19th Century |                                       |

SPECIFIC DATE(S) (If Applicable and Known) 1864

AREAS OF SIGNIFICANCE (Check One or More as Appropriate)

- |  |   |  |  |
|--|---|--|--|
| <input type="checkbox"/> Aboriginal              | <input type="checkbox"/> Education              | <input type="checkbox"/> Political           | <input type="checkbox"/> Urban Planning        |
| <input type="checkbox"/> Prehistoric             | <input type="checkbox"/> Engineering            | <input type="checkbox"/> Religion/Philosophy | <input type="checkbox"/> Other (Specify) _____ |
| <input type="checkbox"/> Historic                | <input type="checkbox"/> Industry               | <input type="checkbox"/> Science             | _____  |
| <input type="checkbox"/> Agriculture             | <input type="checkbox"/> Invention              | <input type="checkbox"/> Sculpture           | _____  |
| <input checked="" type="checkbox"/> Architecture | <input type="checkbox"/> Landscape Architecture | <input type="checkbox"/> Social/Humanitarian | _____  |
| <input type="checkbox"/> Art                     | <input type="checkbox"/> Literature             | <input type="checkbox"/> Theater             | _____  |
| <input type="checkbox"/> Commerce                | <input type="checkbox"/> Military               | <input type="checkbox"/> Transportation      | _____  |
| <input type="checkbox"/> Communications          | <input type="checkbox"/> Music                  |  |  |
| <input type="checkbox"/> Conservation            |   |  |  |

STATEMENT OF SIGNIFICANCE

The house was built in 1864 for John D. Morris, an Indianapolis businessman who was one of the five sons of Morris Morris the pioneer. Noble C. Butler, who bought the house in 1881, was a vice president of the Capitol National Bank and toward the end of the century was active in a local literary society.

It is believed that D. A. Bohlen, a prominent Indianapolis architect, designed the house (Agnes M. Hanna, Indianapolis Star, 7 Apr. 1929). The house is a significant example of the period and, in its present condition as a museum of the decorative arts of the period circa 1875, is an important landmark. It is one of the few houses of its type still standing in Indianapolis.

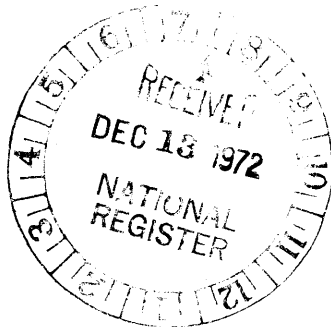

SEE INSTRUCTIONS

9. MAJOR BIBLIOGRAPHICAL REFERENCES

Indianapolis city directories, 1865-1878 and 1882-1915  
 Dunn, Jacob Piatt, Greater Indianapolis, Vol. I, Chicago, 1910.  
 Hyman, Max, Handbook of Indianapolis, Indianapolis, 1897.

10. GEOGRAPHICAL DATA

LATITUDE AND LONGITUDE COORDINATES DEFINING A RECTANGLE LOCATING THE PROPERTY			O R	LATITUDE AND LONGITUDE COORDINATES DEFINING THE CENTER POINT OF A PROPERTY OF LESS THAN TEN ACRES						
CORNER	LATITUDE			LATITUDE			LONGITUDE			
	Degrees	Minutes	Seconds	Degrees	Minutes	Seconds	Degrees	Minutes	Seconds	
NW	0	'	"	39	0	46	15	86	09	00
NE	0	'	"							
SE	0	'	"							
SW	0	'	"							

NO UTM  
CX

APPROXIMATE ACREAGE OF NOMINATED PROPERTY: 1/4

LIST ALL STATES AND COUNTIES FOR PROPERTIES OVERLAPPING STATE OR COUNTY BOUNDARIES

STATE:	CODE	COUNTY	CODE
Indiana		Marion	
STATE:	CODE	COUNTY:	CODE
STATE:	CODE	COUNTY:	CODE
STATE:	CODE	COUNTY:	CODE

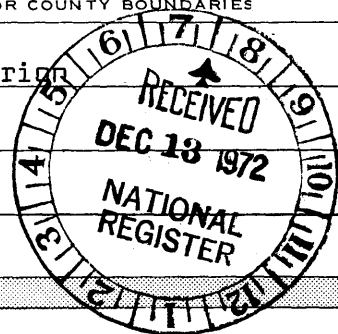

SEE INSTRUCTIONS

11. FORM PREPARED BY

NAME AND TITLE: Wesley I. Shank - Architectural Historian

ORGANIZATION: Historic American Buildings Survey DATE: August 1971

STREET AND NUMBER: 3402 Boulevard Place

CITY OR TOWN: Indianapolis STATE: Indiana CODE: \_\_\_\_\_

12. STATE LIAISON OFFICER CERTIFICATION

As the designated State Liaison Officer for the National Historic Preservation Act of 1966 (Public Law 89-665), I hereby nominate this property for inclusion in the National Register and certify that it has been evaluated according to the criteria and procedures set forth by the National Park Service. The recommended level of significance of this nomination is:

National  State  Local

Name: Donald Durfee  
 Title: State Liaison Officer  
 Date: 12-6-72

NATIONAL REGISTER VERIFICATION

I hereby certify that this property is included in the National Register.

Robert Utley  
 Chief, Office of Archeology and Historic Preservation

Date: 2/20/73

ATTEST: W. Muntz  
 Keeper of The National Register  
 Date: 2-16-73

Form 10-300a  
(July 1969)

UNITED STATES DEPARTMENT OF THE INTERIOR  
NATIONAL PARK SERVICE

**NATIONAL REGISTER OF HISTORIC PLACES  
INVENTORY - NOMINATION FORM**

(Continuation Sheet)

STATE	
Indiana	
COUNTY	
Marion	
FOR NPS USE ONLY	
ENTRY NUMBER	DATE
	FEB 20 1973

(Number all entries)

E 13TH ST

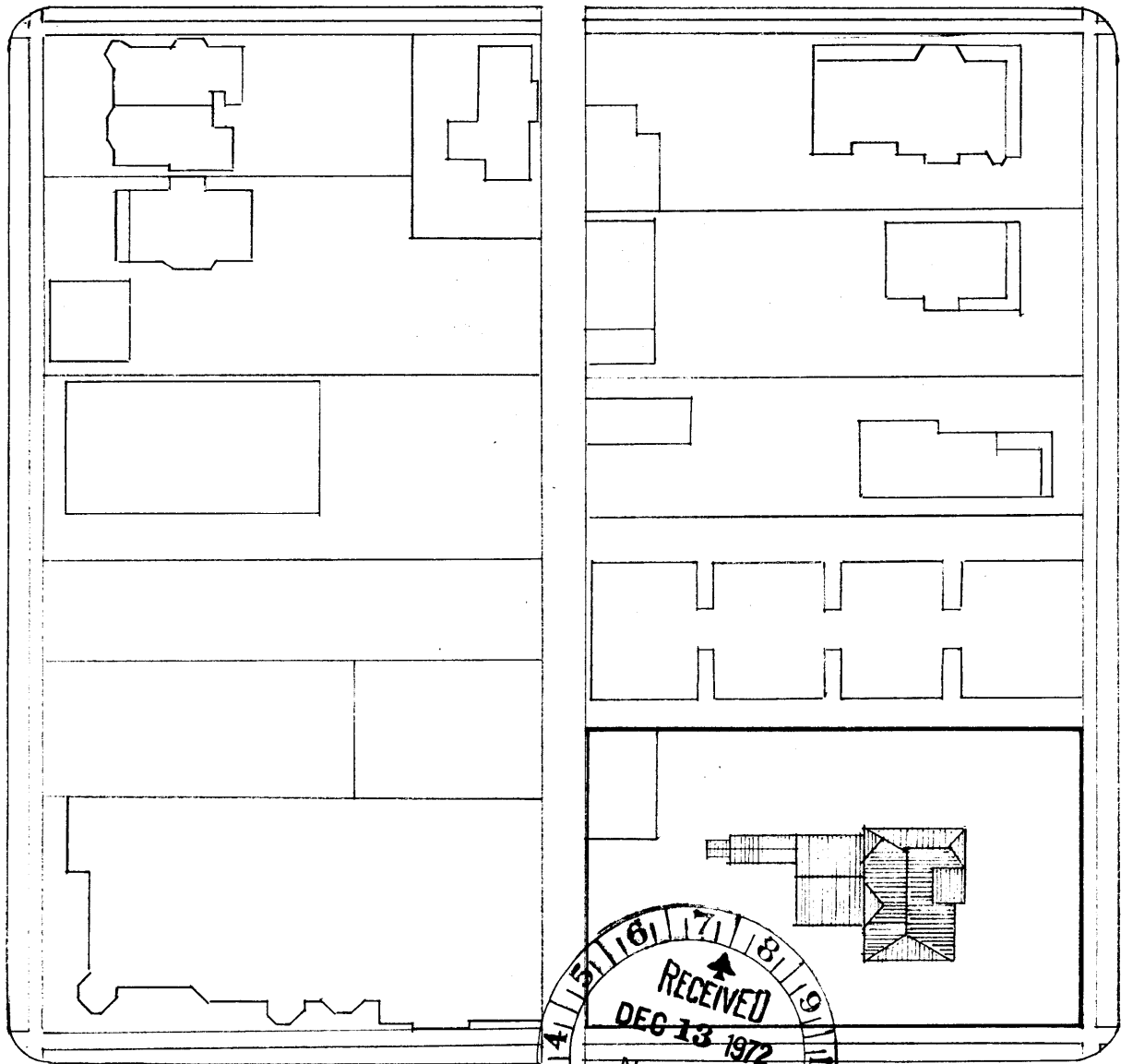

N PARK AVE.

E 12TH ST.

