

UNITED STATES DEPARTMENT OF THE INTERIOR  
NATIONAL PARK SERVICE

**NATIONAL REGISTER OF HISTORIC PLACES  
INVENTORY -- NOMINATION FORM**

FOR FEDERAL PROPERTIES

<b>FOR NPS USE ONLY</b>	
RECEIVED	NOV 27 1984
DATE ENTERED	

SEE INSTRUCTIONS IN *HOW TO COMPLETE NATIONAL REGISTER FORMS*  
TYPE ALL ENTRIES -- COMPLETE APPLICABLE SECTIONS

**1 NAME**

HISTORIC U. S. Post Office, Marysville, California  
AND/OR COMMON Marysville Main Post Office

**2 LOCATION**

STREET & NUMBER 407 C Street  
CITY, TOWN Marysville NA NOT FOR PUBLICATION CONGRESSIONAL DISTRICT 2  
STATE California CODE 06 COUNTY Yuba CODE 074

**2 CLASSIFICATION**

CATEGORY	OWNERSHIP	STATUS	PRESENT USE
<input type="checkbox"/> DISTRICT	<input checked="" type="checkbox"/> PUBLIC	<input checked="" type="checkbox"/> OCCUPIED	<input type="checkbox"/> AGRICULTURE <input type="checkbox"/> MUSEUM
<input checked="" type="checkbox"/> BUILDING(S)	<input type="checkbox"/> PRIVATE	<input type="checkbox"/> UNOCCUPIED	<input type="checkbox"/> COMMERCIAL <input type="checkbox"/> PARK
<input type="checkbox"/> STRUCTURE	<input type="checkbox"/> BOTH	<input type="checkbox"/> WORK IN PROGRESS	<input type="checkbox"/> EDUCATIONAL <input type="checkbox"/> PRIVATE RESIDENCE
<input type="checkbox"/> SITE	<b>PUBLIC ACQUISITION</b>	<b>ACCESSIBLE</b>	<input type="checkbox"/> ENTERTAINMENT <input type="checkbox"/> RELIGIOUS
<input type="checkbox"/> OBJECT	NA IN PROCESS	<input type="checkbox"/> YES: RESTRICTED	<input checked="" type="checkbox"/> GOVERNMENT <input type="checkbox"/> SCIENTIFIC
	<input type="checkbox"/> BEING CONSIDERED	<input checked="" type="checkbox"/> YES: UNRESTRICTED	<input type="checkbox"/> INDUSTRIAL <input type="checkbox"/> TRANSPORTATION
		<input type="checkbox"/> NO	<input type="checkbox"/> MILITARY <input type="checkbox"/> OTHER:

**4 AGENCY**

REGIONAL HEADQUARTERS: *(If applicable)*  
U. S. Postal Service, Western Regional Office  
STREET & NUMBER 850 Cherry Avenue  
CITY, TOWN San Bruno NA VICINITY OF STATE California 94099

**5 LOCATION OF LEGAL DESCRIPTION**

COURTHOUSE, REGISTRY OF DEEDS, ETC. Yuba County Courthouse  
STREET & NUMBER 400 5th Street  
CITY, TOWN Marysville STATE CA

**6 REPRESENTATION IN EXISTING SURVEYS**

TITLE None  
DATE  
DEPOSITORY FOR SURVEY RECORDS  
CITY, TOWN STATE

\_\_FEDERAL \_\_STATE \_\_COUNTY \_\_LOCAL

## 7 DESCRIPTION

CONDITION		CHECK ONE	CHECK ONE
<input checked="" type="checkbox"/> EXCELLENT	<input type="checkbox"/> DETERIORATED	<input checked="" type="checkbox"/> UNALTERED	<input checked="" type="checkbox"/> ORIGINAL SITE
<input type="checkbox"/> GOOD	<input type="checkbox"/> RUINS	<input type="checkbox"/> ALTERED	<input type="checkbox"/> MOVED
<input type="checkbox"/> FAIR	<input type="checkbox"/> UNEXPOSED		DATE <u>NA</u>

---

DESCRIBE THE PRESENT AND ORIGINAL (IF KNOWN) PHYSICAL APPEARANCE

The Marysville post office is located two blocks east of the commercial center of the town, and is surrounded by several 19th century buildings. Marysville and Yuba County have no locally designated historic districts, and the property is not within a designated National Register district.

The post office is in excellent structural condition and is being well maintained.

Extensive additions were made in 1978-1981, though the original facade and south elevations were unaffected. The lobby was re-modeled during the same period. The remodeling extensively damaged the historic integrity of the interior. The original service windows were removed and replaced with a service counter, and the original lobby lights were replaced with fluorescent fixtures. The exterior additions were more sensitive to the original style of the building. The new concrete walls are faced with brick matching the color and texture of the original, and casts of the terracotta ornament over the original windows were placed on the new walls.

The original building is an early example of the Starved Classical style. The facade is rigidly symmetrical, about an axis centered in the front entrance, and is divided into three parts. The central portion containing the front entrance is recessed about two feet from the wings on either side. A large terracotta relief is placed over the door and depicts an eagle perched on a stylized Corinthian capital. The front entrance is flanked by two windows on each side, each of which has a geometric terracotta moulding topped by a hexagonal terracotta plaque. The plaques, from north to south, depict three airplanes, a sailing ship, a steam ship and a locomotive. All of the sculpture is rendered in the conservative, art-deco inspired abstraction characteristic of the OSA. A window is placed in each of the projecting wings and is topped with an hexagonal plaque containing an eagle. The cornice is marked with a terracotta belt course, moulded with a triangular motif. The top portion of the belt course contains large, stylized "dentils" reminiscent of the dentil mouldings of Greek and Roman Architecture.

## 8 SIGNIFICANCE

PERIOD	AREAS OF SIGNIFICANCE -- CHECK AND JUSTIFY BELOW			
<input type="checkbox"/> PREHISTORIC	<input type="checkbox"/> ARCHEOLOGY-PREHISTORIC	<input type="checkbox"/> COMMUNITY PLANNING	<input type="checkbox"/> LANDSCAPE ARCHITECTURE	<input type="checkbox"/> RELIGION
<input type="checkbox"/> 1400-1499	<input type="checkbox"/> ARCHEOLOGY-HISTORIC	<input type="checkbox"/> CONSERVATION	<input type="checkbox"/> LAW	<input type="checkbox"/> SCIENCE
<input type="checkbox"/> 1500-1599	<input type="checkbox"/> AGRICULTURE	<input type="checkbox"/> ECONOMICS	<input type="checkbox"/> LITERATURE	<input checked="" type="checkbox"/> SCULPTURE
<input type="checkbox"/> 1600-1699	<input checked="" type="checkbox"/> ARCHITECTURE	<input type="checkbox"/> EDUCATION	<input type="checkbox"/> MILITARY	<input type="checkbox"/> SOCIAL/HUMANITARIAN
<input type="checkbox"/> 1700-1799	<input type="checkbox"/> ART	<input type="checkbox"/> ENGINEERING	<input type="checkbox"/> MUSIC	<input type="checkbox"/> THEATER
<input type="checkbox"/> 1800-1899	<input type="checkbox"/> COMMERCE	<input type="checkbox"/> EXPLORATION/SETTLEMENT	<input type="checkbox"/> PHILOSOPHY	<input type="checkbox"/> TRANSPORTATION
<input checked="" type="checkbox"/> 900-	<input type="checkbox"/> COMMUNICATIONS	<input type="checkbox"/> INDUSTRY	<input type="checkbox"/> POLITICS/GOVERNMENT	<input type="checkbox"/> OTHER (SPECIFY)
		<input type="checkbox"/> INVENTION		

SPECIFIC DATES **Began 1932/occupied 1934** BUILDER/ARCHITECT **James A. Wetmore/OSA**

### STATEMENT OF SIGNIFICANCE

Though the building has been the victim of recent additions and alterations, the structure retains significant integrity of location, design, setting, association and feeling. It is an excellent example of the early Starved Classical style and contains notable examples of craftsmanship, particularly in its brickwork. In addition, the building has considerable local importance as the first federal building in Marysville. The decorative terracotta panels appear to have been designed in the office of the Supervising Architect and are craftsmanly executed in a style of the design output of the office in the early thirties.

# 9 MAJOR BIBLIOGRAPHICAL REFERENCES

See Cover Document

## 10 GEOGRAPHICAL DATA

ACREAGE OF NOMINATED PROPERTY Less than 1

UTM REFERENCES

A	1,0	62,22,4,0	4,33,29,6,5	B			
	ZONE	EASTING	NORTHING		ZONE	EASTING	NORTHING
C				D			

VERBAL BOUNDARY DESCRIPTION

The original structure is bounded on the south by Fourth Street and on the west by C Street. The original lot has a uniform depth of 160' from each frontage. The Yuba County assessor records the site as lots 1 & 2, block 243, of the "Old City" subdivision.

LIST ALL STATES AND COUNTIES FOR PROPERTIES OVERLAPPING STATE OR COUNTY BOUNDARIES

STATE	NA	CODE	NA	COUNTY	NA	CODE	NA
STATE	NA	CODE	NA	COUNTY	NA	CODE	NA

## 11 FORM PREPARED BY

NAME / TITLE

Doug Robertson, Planner

7/25/84

ORGANIZATION

Beland/Associates Inc.

DATE

(818) 796-8093

STREET & NUMBER

16 South Oakland Street

TELEPHONE

CITY OR TOWN

Pasadena

STATE

California

## 12 CERTIFICATION OF NOMINATION

STATE HISTORIC PRESERVATION OFFICER RECOMMENDATION

YES \_\_\_ NO \_\_\_ NONE \_\_\_

STATE HISTORIC PRESERVATION OFFICER SIGNATURE

In compliance with Executive Order 11593, I hereby nominate this property to the National Register, certifying that the State Historic Preservation Officer has been allowed 90 days in which to present the nomination to the State Review Board and to evaluate its significance. The evaluated level of significance is \_\_\_ National \_\_\_ State \_\_\_ Local.

FEDERAL REPRESENTATIVE SIGNATURE

TITLE

DATE

FOR NPS USE ONLY

I HEREBY CERTIFY THAT THIS PROPERTY IS INCLUDED IN THE NATIONAL REGISTER

DATE

DIRECTOR, OFFICE OF ARCHEOLOGY AND HISTORIC PRESERVATION

ATTEST:

DATE

KEEPER OF THE NATIONAL REGISTER

UNITED STATES DEPARTMENT OF THE INTERIOR  
NATIONAL PARK SERVICE

FOR NPS USE ONLY

RECEIVED

DATE ENTERED

**NATIONAL REGISTER OF HISTORIC PLACES  
INVENTORY -- NOMINATION FORM**

CONTINUATION SHEET    Marysville    ITEM NUMBER 10    PAGE 1

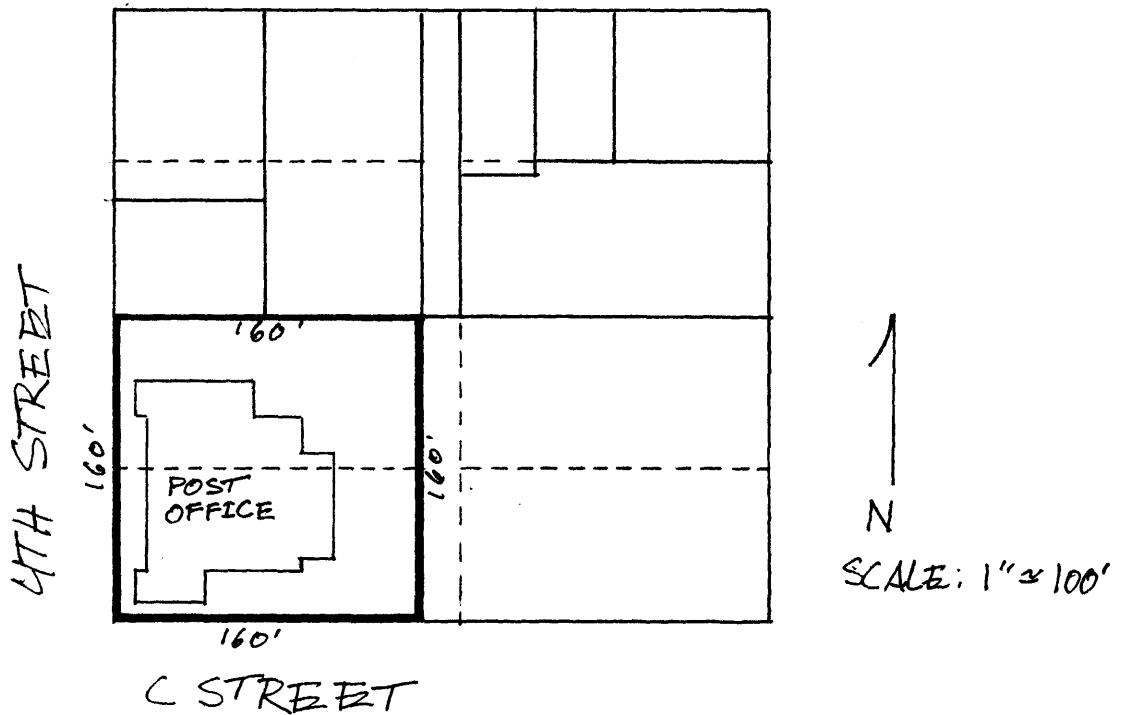

Note: Post Office Historic Boundary Outlined in Red.

Source: U.S. Postal Service and Yuba County Assessor