

KENTUCKY HISTORIC RESOURCES INVENTORY

Site No. Bk 181

1. Historic Name(s) <u>Hubbard Williams house</u>		22. ADD/County <u>Bluegrass 1 Bourbon</u>	
Original Owner <u>Hubbard Williams</u>		23. U.S.G.B. Quadrant (15'/75') <u>Millersburg v. 3</u> G.I.S. Mod. <input type="checkbox"/>	
2. Present Name <u>(Lowe Valley Farm) Barton house Hubbard Williams</u>		24. UTM Reference <u>16 746060 4249600</u>	
3. Location <u>4/10 mi NE of 32-36, on lane commencing KY 32/36 1 mi S of Celville Road</u>		Zone Easting Northing	
4. Owner's Name <u>Roy Allen Lowe</u>		25. Coordinate Accuracy <input type="checkbox"/>	
5. Owner's Address <u>Route 3, Paris, Ky. 40361</u>		26. Prehistoric Site Object Historic Site Structure Building <input checked="" type="checkbox"/> Other	
6. Open to Public Yes <input type="checkbox"/> No <input checked="" type="checkbox"/>	7. Visible from road Yes <input type="checkbox"/> No <input checked="" type="checkbox"/>	8. Ownership Private <input checked="" type="checkbox"/> Local <input type="checkbox"/> State <input type="checkbox"/> Federal <input type="checkbox"/>	
9. Local Contact/Organization		27. National Register District Name: <input type="checkbox"/>	
10. Site Plan with North Arrow <u>See attached boundary form</u>		28. Significance Evaluation <input type="checkbox"/>	
11. Architect		29. Status Date	
12. Builder <u>Thomas Metcalf</u>		National Landmark <input type="checkbox"/>	
13. Date <u>late 18th</u> A. <input checked="" type="checkbox"/> B. <input type="checkbox"/>		National Register <input type="checkbox"/>	
14. Style A. <u>Federal</u> <input checked="" type="checkbox"/> B. <input type="checkbox"/>		Landmark Certificate <input type="checkbox"/>	
15. Original Use <u>residence</u> <input checked="" type="checkbox"/>		Kentucky Survey <input type="checkbox"/>	
16. Present use <u>residence</u>		Local Landmark <input type="checkbox"/>	
17. Condition <u>excellent</u> <input checked="" type="checkbox"/>		HABS/HAER <input type="checkbox"/>	
18. Description <u>2 story 3 bay hall parlor dry stone house with 1 story stone ell on rear. Atypically, house has only 1 chimney on main block - on S end, exterior. Unusually fine masonry, 9 stone voussairs, pegged frames, oval trim. Enclosed entrance to cellar</u> (Continue on Back) <u>(over)</u>		30. Historic Theme Primary <u>Architecture</u> <input checked="" type="checkbox"/> C Secondary <u>Settlement</u> <input checked="" type="checkbox"/> K Other <u>distilling</u> <input checked="" type="checkbox"/> N	
No. Stories <u>2</u> <input checked="" type="checkbox"/>		31. Endangered Yes <input type="checkbox"/> No <input checked="" type="checkbox"/>	
Single Pile <input checked="" type="checkbox"/> NA <input type="checkbox"/>		32. Preservation Project Status <input type="checkbox"/>	
Double Pile <input type="checkbox"/>		Actual Cost in \$1,000s <input type="checkbox"/>	
Floor Plan <u>hall-parlor</u> <input checked="" type="checkbox"/>		33. ATTACH PHOTO <u>in attached envelope</u>	
Structural Fabric <u>stone</u> A. <input checked="" type="checkbox"/> B. <input type="checkbox"/>		Roll No. _____	
Decorative Fabric <u>voussairs</u> A. <input checked="" type="checkbox"/> B. <input type="checkbox"/>		Picture No. _____	
<u>diagonal fascia</u> B. <input checked="" type="checkbox"/>		Direction _____	
Roof Form <u>gable</u>		34. Prepared by: <u>C.M. Wooley</u>	
19. History <u>House built between 1792-1804 by Hubbard Williams of Penn. on land awarded for Revolutionary service. He fought under Washington at the Battle of Trenton and weathered the awful winter at Valley Forge.</u>		35. Organization _____	
20. Significance <u>Very good, very early stone house built by Thos Metcalf for prominent family. Site of a leading whiskey distillery in the country. 1st glass windows in Ky.</u>		36. Date <u>1982</u>	
21. Source of Information <u>18. inspection</u> <u>19. R. A. Lowe, owner</u> <u>Wilson, This Old House, "John Williams house"</u> <u>12. Mrs. W. H. Whitley</u>		37. Revision Dates _____ 38. Staff Review _____	

18. cont.:

on N end of house, of stone with gable roof. Single attic window in N end, taller than usual. Had angled fascia covering ends of roof rafters (as at Shakerlawn), (also Str 64), still on cellar entrance roof. (photo 3)

Interior has included corner stair arising from rear of parlor (N) on interior wall; board wall below handrail upstairs instead of balusters; square newell. Upstairs ceiling and entire attic finished with beaded boards, raw walnut in attic. Fine breakfast sunburst mantel in dining room (ell). (photo 6) (photo 7) (photo 8)

Changes: hall & parlor mantels replaced; hipped roof front porch added; frame extension and enclosed shed porch added to ell; original pointing mostly removed from masonry joints and replaced with concrete, detracting from the quality of the stonework; eaves widened, ell window enlarged.

On N side of yard is a hewn frame smoke house with pegged rafters and collar beams, circular sawn flooring, vertical board siding. (photo 9)

House located on side of low hill facing a branch of Hinkston's Creek. Williams family cemetery across creek. 150 yards downstream is the covered spring house which furnished water for the distillery (photo 10)

19. cont.:

He was a descendant of Roger Williams, founder of R.I., and of Patrick Henry. Son John, built the - 149.

Land (1200 acres clear to Hinkston) bought by Josh Barton mid 19th C. Barton family owned it over 80 years during which time Very Old Barton whiskey was produced here. Purchased by family of present owner 1941.

Early road to Cepthiana ran in front of house along creek.

VERBAL BOUNDARY DESCRIPTION & JUSTIFICATION

Beginning at A at the SW corner of the yard, thence with fence around yard, 165 ft N, 222 ft E, 165 ft S, and 222 ft W to the beginning, containing the stone house and smoke house, about 8/10 acre. Barns on site are later.

SKETCH MAP OF SITE SHOWING BOUNDARIES AND KEY BUILDINGS AND FEATURES WITH NORTH ARROW.

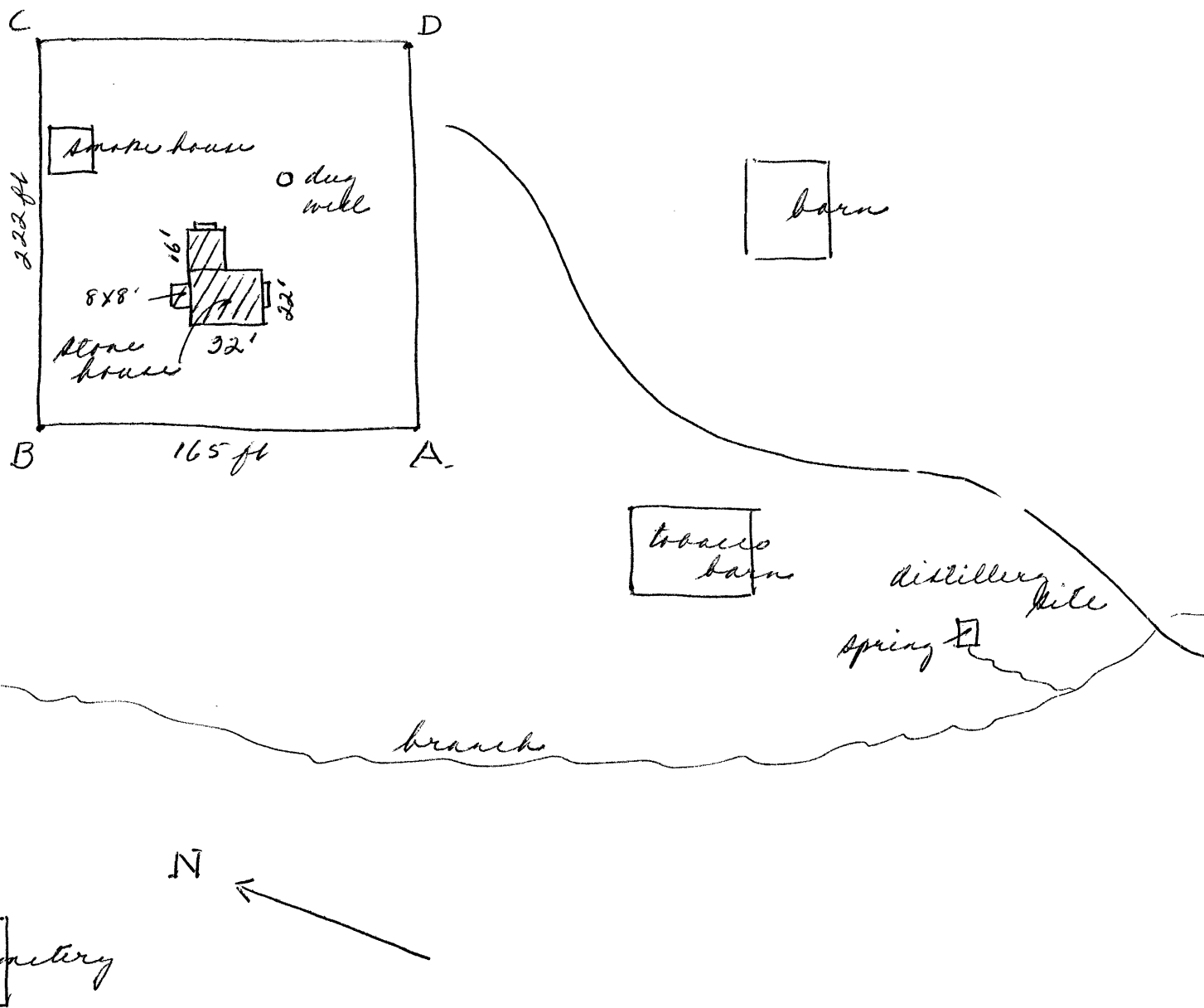

KENTUCKY HISTORIC RESOURCES INVENTORY

Site No. Bk 181

1. Historic Name(s) <u>Hubbard Williams house</u>		22. ADD/County <u>Bluegrass / Bourbon</u>	
Original Owner <u>Hubbard Williams</u>		23. U.S.G.B. Quadrant (15'/75') <u>Millersburg v. 3</u> G.I.S. Mod. <input type="checkbox"/>	
2. Present Name <u>(Lowe Valley Farm) Barton house Hubbard Williams</u>		24. UTM Reference <u>16 746060 4249600</u>	
3. Location <u>4/10 mi NE of 32-36, on lane commencing KY 32/36 1 mi S of Calville Road</u>		Zone Easting Northing	
4. Owner's Name <u>Roy Allen Lowe</u>		25. Coordinate Accuracy <input type="checkbox"/>	
5. Owner's Address <u>Route 3, Paris, Ky. 40361</u>		26. Prehistoric Site Object Historic Site Structure Building <input checked="" type="checkbox"/> Other	
6. Open to Public Yes <input type="checkbox"/> No <input checked="" type="checkbox"/>	7. Visible from road Yes <input type="checkbox"/> No <input checked="" type="checkbox"/>	27. National Register District Name: <input type="checkbox"/>	
8. Ownership Private <input checked="" type="checkbox"/> Local <input type="checkbox"/> State <input type="checkbox"/> Federal <input type="checkbox"/>		28. Significance Evaluation <input type="checkbox"/>	
9. Local Contact/Organization		29. Status National Landmark <input type="checkbox"/> Date _____ National Register <input type="checkbox"/> Landmark Certificate <input type="checkbox"/> Kentucky Survey <input type="checkbox"/> Local Landmark <input type="checkbox"/> HABS/HAER <input type="checkbox"/>	
10. Site Plan with North Arrow <u>See attached boundary form</u>		30. Historic Theme Primary <u>Architecture</u> <input type="checkbox"/> <u>C</u> Secondary <u>Settlement</u> <input type="checkbox"/> <u>K</u> Other <u>Distilling</u> <input type="checkbox"/> <u>N</u>	
11. Architect		31. Endangered Yes <input type="checkbox"/> No <input checked="" type="checkbox"/>	
12. Builder <u>Thomas Metcalf</u>		32. Preservation Project Status <input type="checkbox"/>	
13. Date <u>late 18th</u> A. <input checked="" type="checkbox"/> B. <input type="checkbox"/>		Actual Cost in \$1,000s <input type="checkbox"/>	
14. Style A. <u>Federal</u> <input checked="" type="checkbox"/> B. <input type="checkbox"/>		33. ATTACH PHOTO <u>in attached envelope</u>	
15. Original Use <u>residence</u> <input checked="" type="checkbox"/> <u>A</u>			
16. Present use <u>residence</u>			
17. Condition <u>excellent</u> <input checked="" type="checkbox"/> <u>A</u>			
18. Description <u>2 story 3 bay hall parlor dry stone house with 1 story stone ell on rear. Atypically, house has only 1 chimney on main block - on S end, exterior. Unusually fine masonry, 9 stone voussairs, pegged frames, oval trim. Enclosed entrance to cellar</u> (Continue on Back) <u>(over)</u>		No. Stories <u>2</u> <input checked="" type="checkbox"/> <u>C</u>	
		Single Pile <input checked="" type="checkbox"/> NA <input type="checkbox"/>	
		Double Pile <input type="checkbox"/>	
		Floor Plan <u>hall-parlor</u> <input checked="" type="checkbox"/> <u>E</u>	
		Structural Fabric <u>stone</u> A. <input checked="" type="checkbox"/> B. <input type="checkbox"/>	
		Decorative Fabric <u>voussairs</u> A. <input checked="" type="checkbox"/> B. <input type="checkbox"/>	
		<u>diagonal fascia</u> B. <input checked="" type="checkbox"/>	
		Roof Form <u>gable</u>	
19. History <u>House built between 1792-1804 by Hubbard Williams of Penn. on land awarded for Revolutionary service. He fought under Washington at the Battle of Trenton and weathered the awful winter at Valley Forge.</u>		Roll No. _____	
		Picture No. _____	
		Direction _____	
		34. Prepared by: <u>C.M. Wooley</u>	
		35. Organization _____	
		36. Date <u>1982</u>	
		37. Revision Dates _____ 38. Staff Review _____	
20. Significance <u>Very good, very early stone house built by Thos Metcalf for prominent family. Site of a leading whiskey distillery in the country. 1st glass windows in Ky.</u>			
21. Source of Information <u>18. inspection</u>			
<u>19. R. A. Lowe, owner</u>			
<u>Wilson, This Old House, "John Williams house"</u>			
<u>12. Mrs. W. H. Whitley</u>			

18. cont.:

on N end of house, of stone with gable roof. Single attic window in N end, taller than usual. Had angled fascia covering ends of roof rafters (as at Shakerlawn), (also Str 64), still on cellar entrance roof. (photo 3)

Interior has included corner stair arising from rear of parlor (N) on interior wall; board wall below handrail upstairs instead of balusters; square newell. Upstairs ceiling and entire attic finished with beaded boards, raw walnut in attic. Fine breakfast sunburst mantel in dining room (ell). (photo 6) (photo 7) (photo 8)

Changes: hall & parlor mantels replaced; hipped roof front porch added; frame extension and enclosed shed porch added to ell; original pointing mostly removed from masonry joints and replaced with concrete, detracting from the quality of the stonework; eaves widened, ell window enlarged.

On N side of yard is a hewn frame smoke house with pegged rafters and collar beams, circular sawn flooring, vertical board siding. (photo 9)

House located on side of low hill facing a branch of Hinkston's Creek. Williams family cemetery across creek. 150 yards downstream is the covered spring house which furnished water for the distillery (photo 10)

19. cont.:

He was a descendant of Roger Williams, founder of R.I., and of Patrick Henry. Son John, built the - 149.

Land (1200 acres clear to Hinkston) bought by Josh Barton mid 19th C. Barton family owned it over 80 years during which time Very Old Barton whiskey was produced here. Purchased by family of present owner 1941.

Early road to Cepthiana ran in front of house along creek.

VERBAL BOUNDARY DESCRIPTION & JUSTIFICATION

Beginning at A at the SW corner of the yard, thence with fence around yard, 165 ft N, 222 ft E, 165 ft S, and 222 ft W to the beginning, containing the stone house and smoke house, about 8/10 acre. Barns on site are later.

SKETCH MAP OF SITE SHOWING BOUNDARIES AND KEY BUILDINGS AND FEATURES WITH NORTH ARROW.

