

# Towers Historic District Narragansett, R.I.

- Federal
- ▨ Early Victorian (1860-1881)
- ▧ Late Victorian (1882-1910)
- ▩ Early 20th Century (1910-1930)
- Non-Contributing

*Sketch Plan - not to scale*

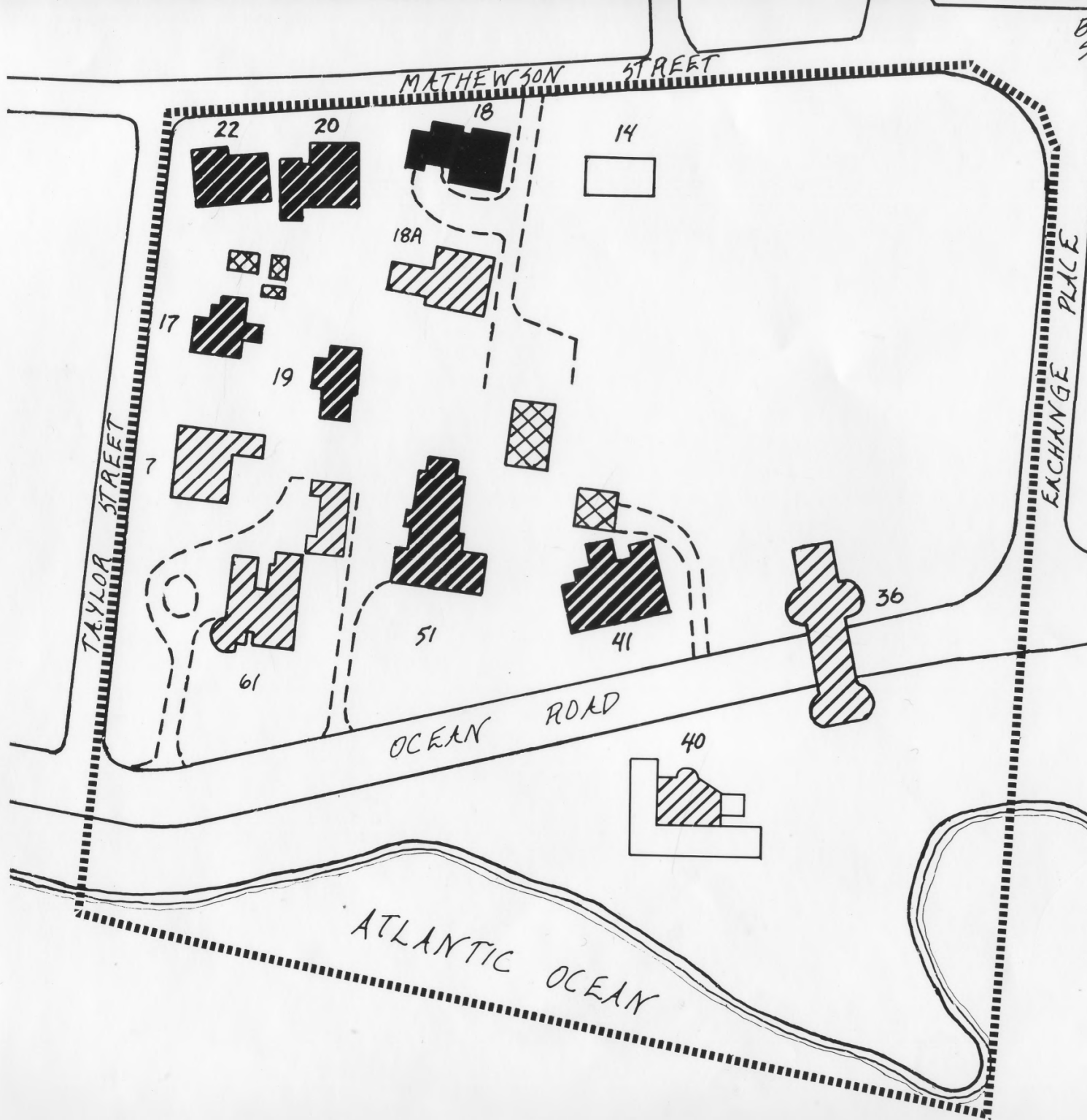

MAY 1982  
RHODE ISLAND HISTORICAL  
PRESERVATION COMMISSION



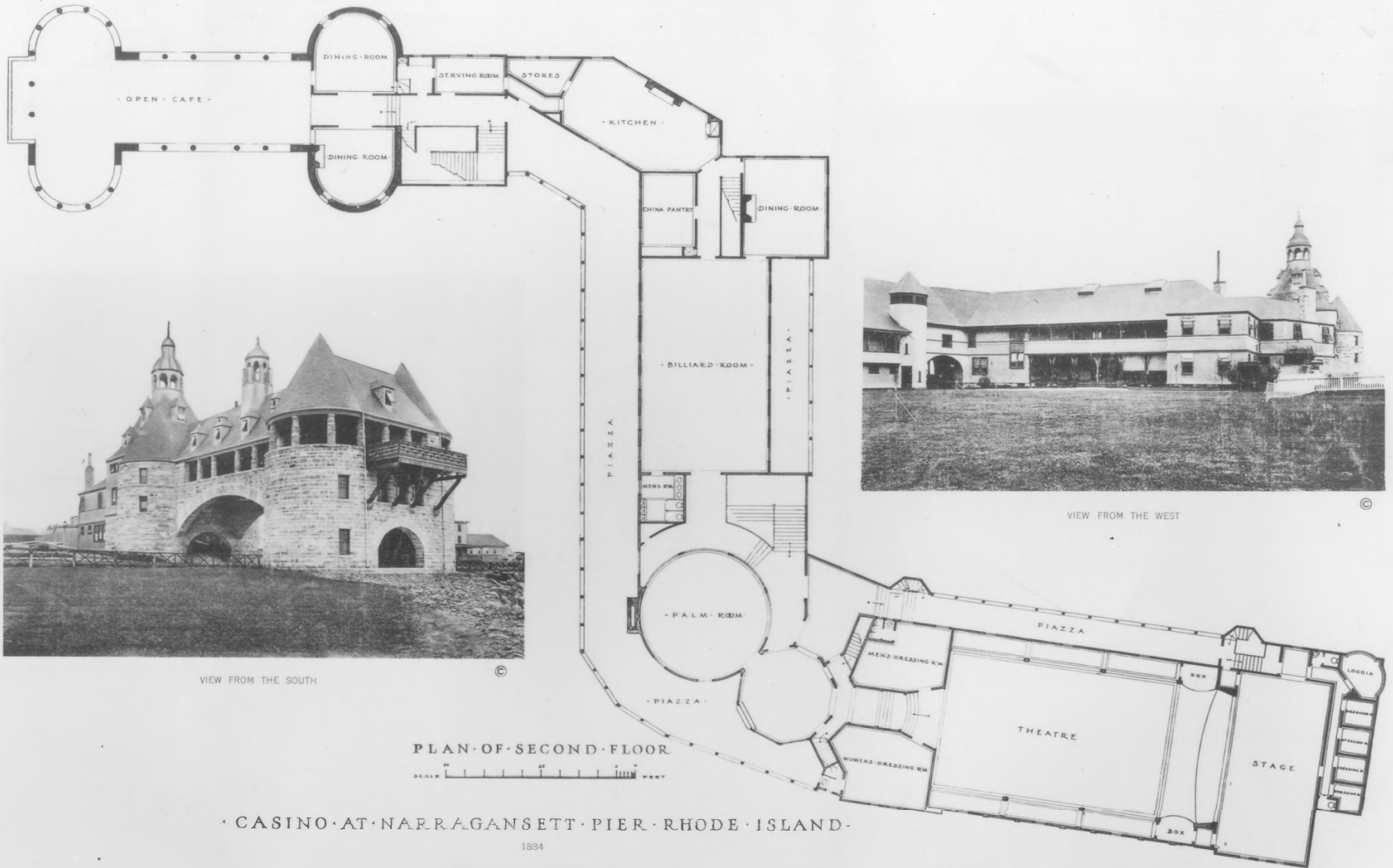

VIEW FROM THE SOUTH

VIEW FROM THE WEST

PLAN OF SECOND FLOOR

SCALE 1" = 10' WEST

CASINO AT NARRAGANSETT PIER, RHODE ISLAND

1884

The Towers Historic District  
Narragansett Pier, RI

Photo credit: from A Monograph of the Works of  
McKim, Mead & White

Date: ca. 1885

Negative filed at: Rhode Island Historical  
Preservation Commission

Plan and view of the Casino as originally constructed.

Photo #19



Memorial Park -- site of Narragansett Casino  
The Towers Historic District  
Narragansett Pier, RI

Photographer: Charlene Roise  
Date: March 1981

Negative filed at: Rhode Island Historical  
Preservation Commission

From northwest corner. World War II memorial at  
left; the Towers in background center; the former  
Coast Guard Life Saving Station in background right.

Photo #20



The Towers Historic District  
Narragansett Pier, RI

Photographer: Charlene Roise  
Date: March 1981

Negative filed at: Rhode Island Historical  
Preservation Commission

View looking north on Ocean Road: The Towers  
(left) and the former Coast Guard Life Saving  
Station (right).

Photo #21





18 Mathewson Street  
The Towers Historic District  
Narragansett Pier, RI

Photographer: Charlene Roise  
Date: March 1981

Negative filed at: Rhode Island Historical  
Preservation Commission

"Wagon Wheel" viewed from northwest.

Photo #22



The Towers Historic District  
Narragansett Pier, RI

Photographer: Charlene Roise  
Date: March 1981

Negative filed at: Rhode Island Historical  
Preservation Commission

View northwest from corner of Taylor Avenue and  
Ocean Road: 7 Taylor Avenue on left, "Miramar"  
(61 Ocean Road) center, "Hopewell" (51 Ocean Road)  
on right.

Photo #23