

# MONTANA HISTORICAL AND ARCHITECTURAL INVENTORY

Site #	8	
Legal Description:	S 7, T 21n, R29w	
Address:	13 Pond Street	
Ownership: Name:	Irwin C. and Winnifred Puphal	
<input checked="" type="checkbox"/> private <input type="checkbox"/> public	address:	Thompson Falls, MT 59873

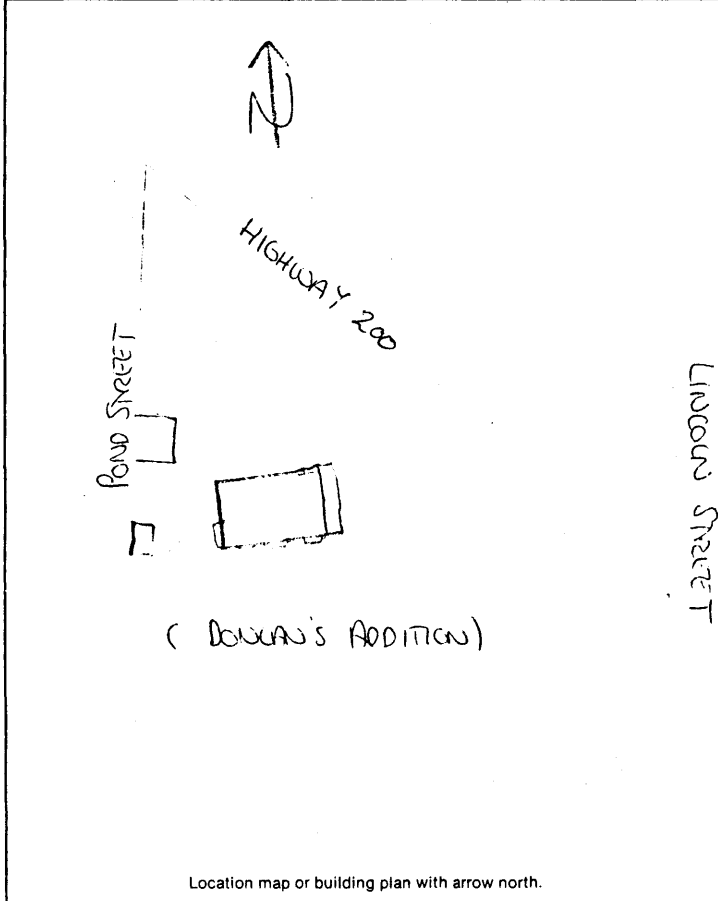

Historic Name:	Norby House
Common Name:	Puphal House
Date of Construction:	1912 <input type="checkbox"/> estimated <input checked="" type="checkbox"/> documented
Architect:	N/A
Builder:	Charles H. Doenges (?)
Original Owner:	Dr. J. B. Norby
Original Use:	residence
Present Use:	residence
<b>RESEARCH SOURCES:</b> Note all records consulted to determine dates of construction, original owners, builders, uses, etc.	
Abstract of Title:	Deedbook 18, p. 494.
Plat Records:	County Plat Book
Tax Records:	1913 Assessment Book
Building Permits:	
Sewer/Water Permits:	
City Directories:	
Sanborn Maps:	
Newspapers:	Sanders County Ledger: 4/12/12
Other:	Montana Power Co. photograph

**PHYSICAL DESCRIPTION:** Describe present appearance of structure/site, then contrast and compare that with it's original appearance, noting additions, alterations, and changes in materials. Discuss significant architectural features.

This wood frame house is sheathed with clapboard siding and has a hipped roof of wood shingles, north and south side roof dormers with a fixed window and comes within, flaired eaves, and rests on a concrete foundation. An interior brick stack reaches down into the basement. Unlike the structures in Thompson Falls, this house is square with the cardinal points. The front (E) features an original enclosed screen porch that hides two large doublehung windows with comes and a wood and beveled glass door. The north side has 3 casement and 2 doublehung with comes windows. The west includes a small open porch, and entrance up a stairway, and a doublehung window. The east features 2 window bays of 3 doublehung windows with comes and a smaller bay of 2 doublehung windows.

A garage and shed built in the 1930s of similar materials are west of the house.

**HISTORICAL INFORMATION:** Describe the persons, important events, and/or historical patterns associated with the structure/site and surrounding area.

J. B. Norby built this house in 1912 after buying the land from the Big Blackfoot Milling Company (an Anaconda Company subsidiary?). Norby may have been related to Everett D. Peek, a local physician, who was starting St. Luke's Hospital, the only hospital in the community, at the time. (See Inventory #28.) Norby left the area in 1914, and sold the house to Dr. I. A. Gates who had recently arrived in the area after buying shares in Dr. Peek's business practice and the hospital. The hospital closed down in the late teens and was sold in the early 1920s. This house came into the possession of the Houghlan family, related by marriage to Peek, in the 1930s. Peek's in-laws, the Prestons, also owned the house for a time. The Puphals bought the house in 1950.

**Footnote Sources:**

Deedbooks: 15, p. 150; 18, p. 494; 17, p. 425; 22, p. 168;  
35, p. 307; 34, p. 598.  
Sanders County Ledger: 4/32/12; 2/13/14; 4/3/14.  
Polk Register, Missoula County, 1915-16, pp. 554 & 556.  
Thompson Falls Development Company pamphlet (1915?), p. 28.  
Interview with Irwin and Winnifred Puphal by John Lazuk

**INTEGRITY:** Assess the degree to which the structure/site, and surrounding area accurately convey the historical associations of the property.

All exterior features are original. A photograph taken shortly after the house was built shows little change from today on the E & S sides. And while no photograph exists of the N & S sides, no signs of alterations can be seen. The interior has been remodeled. Wood arches that separated the living and dining rooms have been removed along with the old radiators. All other features are the same as when the house was

**HISTORICAL and/or ARCHITECTURAL SIGNIFICANCE:** Justify how the persons, important events, or historical patterns associated with structure/site lend the property significance and/or describe the ways in which the structure embodies the distinctive characteristics of a particular period, building type, or style.

(cont.) built: 7 rooms and bath, high ceilings, softwood and hardwood floors (under carpet,) wide moldings, window seats, some lathe and plaster wall covering.

The Norby House is significant under Criterion C as an excellent example of a modest yet very well-preserved Bungalow style house.

The four square, hip roofed Norby House is one of seven Bungalow houses included in this nomination, and represents the most popular style of dwelling built on the west side of Thompson Falls during the first substantial period of growth from 1905-1916. It is one of five Bungalows that are nearly identical in design, three of which have been attributed to the builder Charles Doenges (see also 916 Preston Ave., and 112 Park Street). Doenges was responsible for the construction of at least 17 residences in the community, and appears to have relied on a pattern book for the design. Each of the five Bungalow houses were built between 1911-1914 and were very likely a response to a housing shortage which resulted from increased growth during construction of the hydroelectric dam.

**FORM PREPARED BY:**

Name: John Lazuk  
Address: 350 Strand Ave., Missoula  
Date: October 20, 1984

**GEOGRAPHICAL INFORMATION:**

Acreage: 2.75 acres  
USGS Quad: Thompson Falls, MT  
UTM's: 11/623650/5272575