

KENTUCKY HISTORIC RESOURCES  
Individual Inventory Form

Resource # SH-117  
Shelby County

1. Name of Resource:  
Cross Keys Kitchen and Quarters

2. Original Owner:  
Adam Middleton

3. Other Names:

4. Prehistoric Site \_\_\_\_\_ Building  Object  
Historic Site \_\_\_\_\_ Structure \_\_\_\_\_ Other \_\_\_\_\_

5. Location: north side of U.S. 60 at Cross  
Keys Road, near Shelbyville

6. Owner's Name:  
Lorena White [ P ]

7. Owner's Address:  
Route #3  
Shelbyville, Kentucky

8. Evaluation: [ G ]

9. Recognition & Date:  
Nat.Landmark \_\_\_\_\_ Local Landmark \_\_\_\_\_  
Nat.Register \_\_\_\_\_ HABS/HAER \_\_\_\_\_  
Highway Marker \_\_\_\_\_ KY Inventory  \_\_\_\_\_  
KY Landmark Certificate \_\_\_\_\_

10. N.R.Status & Date:

11. N.R.Group:  
District Name: [ ]  
Mult.Resource Area: [ ]  
Thematic Name: Early Stone Building [ ]

12. Historical Themes:  
Primary: Architecture [030 ]  
Secondary: Highway Inn [05H ]  
Other: [ ]

13. Statement of Significance:  
The stone kitchen is a good example of the kind of kitchen that was often built to service a large house or inn. The group of servants' quarters depicts living accommodations at the inn; while several early inns remain, none of the others retain the [ ]

14. History:  
Adam Middleton, from Virginia, bought a log structure and operated an inn and blacksmith shop on this site ca. 1800, before he built Cross Keys Tavern. The tavern was an impressive Green Revival building of commodious size, used as main stopping place on stage route between Louisville and Lexington, Harrodsburg and Frankfort. Guest list included Henry Clay, Andrew Jackson, and General Lafayette.

15. Source of historical information and/or contact  
Person: Kentucky Heritage Council Files

16. Date:  
Original Building 1st 1/4 19th C. [ 8 ]  
Addition [ ]

17. Style: Federal [ 21 ]  
[ ]

18. Architect/Builder: Not Known

19. No. of Stories: One [ 1.0 ]

20. Original Floor Plan: Rectangular Pen [ 1R ]

21. Single Pile  Double Pile N.A.

22. Roof Form & Material: Original \_\_\_\_\_  
Gable Not Original \_\_\_\_\_

23. Structural Material: Stone [ S ]

24. Exterior Material: Stone [ S ]  
[ ]

25. Foundation Material: Stone [ S ]

26. Major Alterations: Moved/Rebuilt None  
Additions Other

27. Special Features:

28. Outbuildings: quarters, root cellar [ 2 ]

29. Original Function: Kitchen [ 01C ]

30. Present Use: Residence [ 01A ]

31. Condition: Good [ G ]

32. Endangered: Yes \_\_\_\_\_  
No  \_\_\_\_\_

33. Attach Photos:  
Roll: 9 Photo Nos: 1-11 No. of Slides:

34. Prepared by: Carolyn Murray-Wooley

35. Organization: Kentucky Heritage Council

36. Date: January 1984

37. New Survey \_\_\_\_\_ Resurvey  \_\_\_\_\_

KENTUCKY HISTORIC RESOURCES  
Individual Inventory Form

Resource # SH-117

38. UTM Point of Primary Building:	Zone	Easting	Northing	39. G.I.S. Mod.	[ ]
Quadrant: <u>Shelbyville</u>	<u>1 6</u>	<u>6 6 4 1 6 0</u>	<u>4 2 2 9 2 0 0</u>	40. Coordi.Accuracy	[ ]

41. UTM Points of Boundary (for N. R. eligible sites only):

A.	---	-----	-----	D.	---	-----	-----
B.	---	-----	-----	E.	---	-----	-----
C.	---	-----	-----	F.	---	-----	-----

42. Total Acreage in Present Property: 43. Acreage included in proposed N.R. boundary: 3.4 acres

44. Site Plan (and boundary description and justification for N.R. sites):

See Attached

13. Statement of Significance: (Continued)

original quarters for the help. The cellar is a good example of a type common in Kentucky.

14. History: (Continued)

Tavern and farm were operated by two sons of Adam Middleton and their wives (sisters) and remained in the family until 1919. Was used as an inn in the 1930s when it burned.

45. Description and House Plan:

Single-cell, one-story, dry-stone kitchen, ca. 18 x 22 feet. Has exterior shouldered chimney on north gable end, off-centered and with small attic window west of chimney; one window west side of building, off-centered to north, one door in south end off-centered to west, one door east side. Coursed masonry, heavier at corners, of fossiliferous limestone. Roof probably rebuilt and extended on south gable end to form porch. Masonry repointed with concrete, and whitewashed on two sides (original mortar was rather flat also). Window has square log sill; new trim around window and door.

Just northwest of the kitchen is a stone cellar. Interior dimension nine feet. Circular room, stone-lined, walls covered with concrete; cellar covered by earth mound, round on three sides. Entrance wall vertical, of tooled stone, with concrete repointing, doorway in center, five steps descend to earth floor, two iron bars for lintel, stone slabs form ceiling of stairway. Good examples of typical cellar.

Four independent dwellings were built in line with the kitchen. They abutt each other but do not interconnect. They are frame and log buildings; the second one has a central chimney. All are irregularly offset from each other. They are all sheathed with weatherboard or siding.

The cut stone foundation is the remains of the very large and grand frame Greek Revival inn which burned in the 1930s. The site depicts the relationship of the inn and dependencies.

**KENTUCKY HISTORIC RESOURCE INVENTORY SUPPLEMENT  
BOUNDARY AND LOCATION INFORMATION**

Historic Property Name Cross Keep Tavern Site # Sh-117  
 Multiple Resource/Thematic Nomination Title kitchen and quarters

U.T.M. Coordinates - List multiple UTMs if property is ten or more acres.

A. 16 664160 4229200 D. \_\_\_\_\_  
 B. \_\_\_\_\_ E. \_\_\_\_\_  
 C. \_\_\_\_\_ F. \_\_\_\_\_

Verbal Boundary Description \_\_\_\_\_ Acreage 3.4 acres

Beginning at A, at the intersection of Old US 60 and Cross Keep Road, thence W. 420 ft w. road to B, just past the drive, thence parallel to Cross Keep Rd, N 355 ft to C, thence parallel to A-B, E 420 ft to D at Cross Keep Road, thence S w road 355 ft to the beginning, containing the stone kitchen, log-frame quarters, town foundations, and cellar. 5 contributing buildings, 1 contributing structure.

Sketch of Site Plan (Showing outbuildings, structures, landscape features and the site boundary as described above.)

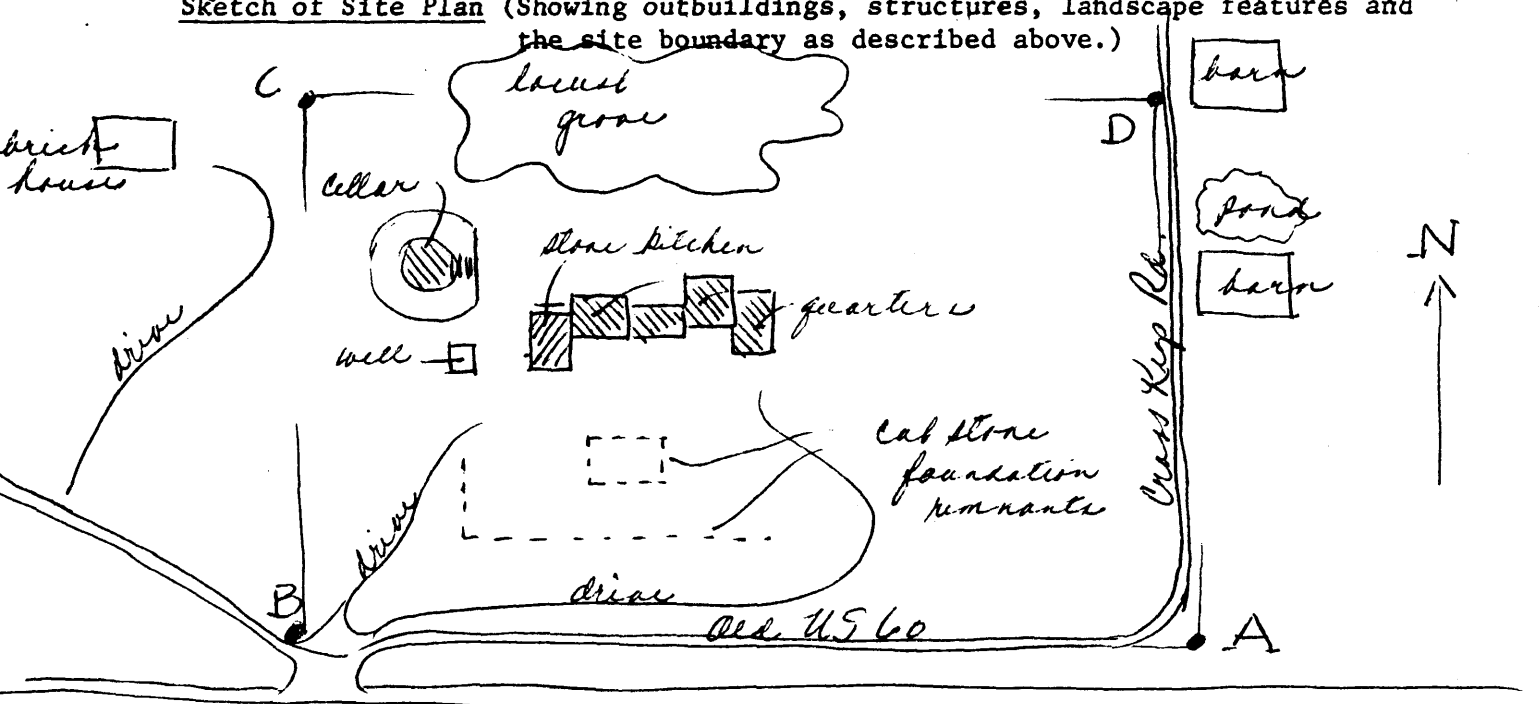

Official Courthouse Property Reference: