



United States Department of the Interior

NATIONAL PARK SERVICE

1849 C Street, N.W.
Washington, D.C. 20240

February 28, 2011

Notice to file:

This property has been automatically listed in the National Register of Historic Places. This is due to the fact that the publication of our Federal Register Notice: "National Register of Historic Places: Pending Nominations and Other Actions" was delayed beyond our control to the point where the mandated 15 day public comment period ended after our required 45 day time frame to act on the nomination. If the 45th day falls on a weekend or Federal holiday, the property will be automatically listed the next business day. The nomination is technically adequate and meets the National Register criteria for evaluation, and thus, automatically listed in the National Register of Historic Places.

Edson Beall
Historian
National Register of Historic Places
Phone: 202-354-2255
E-mail: Edson_Beall@nps.gov
Web: www.nps.gov/history/nr

United States Department of the Interior
National Park Service

054



National Register of Historic Places Registration Form

This form is for use in nominating or requesting determinations for individual properties and districts. See instructions in National Register Bulletin, *How to Complete the National Register of Historic Places Registration Form*. If any item does not apply to the property being documented, enter "N/A" for "not applicable." For functions, architectural classification, materials, and areas of significance, enter only categories and subcategories from the instructions. Place additional certification comments, entries, and narrative items on continuation sheets if needed (NPS Form 10-900a).

1. Name of Property

historic name Hi Jolly Monument
other names/site number Hi Jolly Cemetery, Quartzite Cemetery, the Last Camp of Hi Jolly

2. Location

street & number North end of Cemetery Road not for publication
city or town Quartzsite vicinity
state Arizona code AZ county La Paz code 12 zip code 85346

3. State/Federal Agency Certification

As the designated authority under the National Historic Preservation Act, as amended,
I hereby certify that this X nomination request for determination of eligibility meets the documentation standards for registering properties in the National Register of Historic Places and meets the procedural and professional requirements set forth in 36 CFR Part 60.

In my opinion, the property X meets does not meet the National Register Criteria. I recommend that this property be considered significant at the following level(s) of significance:

 national X statewide local

James W. Garrison 10 JANUARY 2011
Signature of certifying official Date

 State Historic Preservation Officer Arizona State Parks
Title State or Federal agency/bureau or Tribal Government

In my opinion, the property meets does not meet the National Register criteria.

 Signature of commenting official Date
 Title State or Federal agency/bureau or Tribal Government

4. National Park Service Certification

I, hereby certify that this property is:

- entered in the National Register determined eligible for the National Register
- determined not eligible for the National Register removed from the National Register
- other (explain:)

Joe Eason H. Beall 2-28-11
Signature of the Keeper Date of Action

Hi Jolly Monument
Name of Property

La Paz AZ
County and State

5. Classification

Ownership of Property
(Check as many boxes as apply)

- private
- public - Local
- public - State
- public - Federal

Category of Property
(Check only one box)

- building(s)
- district
- site
- structure
- object

Number of Resources within Property
(Do not include previously listed resources in the count.)

Contributing	Noncontributing	
		buildings
		district
		site
		structure
1		object
1		Total

Name of related multiple property listing
(Enter "N/A" if property is not part of a multiple property listing)

Pyramidal Monuments in Arizona, 1925-1943

Number of contributing resources previously listed in the National Register

0

6. Function or Use

Historic Functions
(Enter categories from instructions)

FUNERARY/grave

Current Functions
(Enter categories from instructions)

FUNERARY/grave

7. Description

Architectural Classification
(Enter categories from instructions)

NO STYLE

Materials
(Enter categories from instructions)

foundation: CONCRETE, STONE

walls:

roof:

other: BRONZE, STEEL

Hi Jolly Monument

Name of Property

La Paz AZ

County and State

Narrative Description

(Describe the historic and current physical appearance of the property. Explain contributing and noncontributing resources if necessary. Begin with a **summary paragraph** that briefly describes the general characteristics of the property, such as its location, setting, size, and significant features.)

Summary Paragraph

The Hi Jolly Monument was constructed in 1935 for the gravesite of Philip Thedro, also known as Hadiji Ali, and best known to Arizona history as "Hi Jolly." It is located in the town cemetery of Quartzite, Arizona, on high, flat ground between La Cholla Wash and Tyson Wash. The main center of the town of Quartzite is located eastward on the east side of Tyson Wash.

The Hi Jolly monument is pyramidal in shape, nine feet by nine feet at its base and eight feet high, constructed of stone and concrete, with an attached bronze plaque and topped with a decorative steel silhouette of a camel. The structure possesses strong integrity of location, design, setting, materials, workmanship, feeling, and association.

Narrative Description

The Hi Jolly Monument is a stone pyramid measuring nine feet on each side of its base, with a height of eight feet. On its apex is attached a silhouette of a camel two feet in height, constructed of cold-rolled steel, facing towards the west. The pyramid's four sides face the cardinal points. The stone monument sits atop a concrete foundation located above the grave of Hi Jolly (Philip Thedro, aka, Hadji Ali) in the pioneer cemetery of Quartzsite, Arizona. The cemetery contains the graves of numerous town pioneers and later residents and is characterized by a desert setting with native plants.

The pyramid is constructed of native stone materials, cemented in a series of six courses, with each course consisting of distinct rock materials. The first course, resting upon a four-inch foundation, measures one-foot, four-inches in height, and is composed of volcanic black malapai. The second course is a single band of gold-bearing quartz, nine-inches in height. The third course consists of petrified wood, measuring approximately twelve-inches in high, with the grain primarily laid horizontally. The fourth course is formed of blue rock and is about one-foot thick. The fifth course is of quartz, measuring twenty-one inches in height. The sixth and final course is of eight-inches of red rock, culminating in the apex of cement measuring fourteen-inches, which supports the bronze painted, steel camel cutout on a horizontal bar, commemorating Hi Jolly's role as a camel driver during the U.S. military survey expedition in 1857 across what would later become northern Arizona.

Hi Jolly Monument
Name of Property

La Paz AZ
County and State

A bronze plaque (photographs 1 & 4) is attached to the monument with the following text:

THE LAST CAMP
OF
HI JOLLY
BORN SOMEWHERE IN SYRIA
ABOUT 1828
DIED AT QUARTZSITE
DECEMBER 16 1902
CAME TO THIS COUNTRY
FEBRUARY 10 1856
CAMELDRIVER – PACKER
SCOUT – OVER THIRTY
YEARS A FAITHFUL AID
TO THE U.S. GOVERNMENT

ARIZONA
HIGHWAY DEPARTMENT
1935

Below the plaque (photographs 1 & 4) is a locked tube offering access to an interior vault in which a 1936 time capsule is housed. The monument was formally dedicated on January 5, 1936. Except for the opening of the vault/time capsule on January 27, 1976 to view and reinstall its contents the monument has never been moved, remodeled or reconstructed. It is periodically cleaned. It retains its original appearance and continues its undisturbed historical association with the community as a source of visitor fascination and as a venue for public celebrations.

While it is the smallest of the four pyramidal monuments described in the Pyramidal Monuments in Arizona, 1925-1943 Multiple Property Documentation Form, the Hi Jolly Monument is the most decorative in two features, its colorful stonework and its camel silhouette.

The Quartzite Hi Jolly Cemetery is located in the northwest section of the Town of Quartzsite. The earliest burial recorded is that of Hi Jolly in 1902. The cemetery sits in a natural desert setting with the monument as a centerpiece in the Pioneer Section, with graves spread out on all four of its sides. A kiosk memorializing Hi Jolly and the camel expedition of 1857 is positioned at the entrance to the Pioneer Section of the cemetery. A rustic wood post and wire cable fence acres as a boundary line to separate the Pioneer Section from the public parking area and newer sections of the cemetery to the west. The cemetery continues in use for burials and was deeded to the Town of Quartzsite by the Bureau of Land Management in 2009. Apart from the Hi Jolly Monument itself, the cemetery is not included in this nomination.

Hi Jolly Monument
Name of Property

La Paz AZ
County and State

8. Statement of Significance

Applicable National Register Criteria

(Mark "x" in one or more boxes for the criteria qualifying the property for National Register listing)

- A Property is associated with events that have made a significant contribution to the broad patterns of our history.
- B Property is associated with the lives of persons significant in our past.
- C Property embodies the distinctive characteristics of a type, period, or method of construction or represents the work of a master, or possesses high artistic values, or represents a significant and distinguishable entity whose components lack individual distinction.
- D Property has yielded, or is likely to yield, information important in prehistory or history.

Areas of Significance

(Enter categories from instructions)

ARCHITECTURE

Period of Significance

1935

Significant Dates

1935

Significant Person

(Complete only if Criterion B is marked above)

Cultural Affiliation

Architect/Builder

James Edwards

Criteria Considerations

(Mark "x" in all the boxes that apply)

Property is:

- A owned by a religious institution or used for religious purposes.
- B removed from its original location.
- C a birthplace or grave.
- D a cemetery.
- E a reconstructed building, object, or structure.
- F a commemorative property.
- G less than 50 years old or achieving significance within the past 50 years.

Hi Jolly Monument
Name of Property

La Paz AZ
County and State

Period of Significance (justification)

The period of significance for the property, which is nominated for its architectural significance, is taken as the single year, 1935, the year of its construction.

Criteria Considerations (explanation, if necessary)

The Hi Jolly Monument is a object built to mark the gravesite of Hi Jolly (Haiji Ali/Philip Thedro). It meets National Register Criterion Considerations C and F, as a grave and as a commemorative property, because its primary significance is its architectural merit, as described in the associated Pyramidal Monuments in Arizona, 1925-1943 Multiple Property Documentation Form.

Statement of Significance Summary Paragraph (provide a summary paragraph that includes level of significance and applicable criteria)

The monument not only commemorates the memory of Hi Jolly, but also serves as a town landmark popular with visitors. It is one of four pyramidal monuments in Arizona exhibiting an Egyptian influence, and one of three constructed of native stone and concrete. The monument is nominated to the National Register of Historic Places under Criterion C as an example of a pyramidal monument as described in the Multiple Property Documentation Form "Pyramidal Monuments in Arizona, 1925-1943." It is nominated at the State level of significance as one of four such monuments known to exist in the state.

Narrative Statement of Significance (provide at least one paragraph for each area of significance)

The Hi Jolly Monument is significant under Criterion C in the area of architecture as an example of an Egyptian Revival monument in Arizona as documented in the Multiple Property Documentation Form "Pyramidal Monuments in Arizona, 1925-1943". It was constructed in 1935 and was the third of the four known pyramidal monuments constructed. Its primary character-defining feature (design) and overall appearance have been preserved, with its native stone construction unchanged since its construction. This monument is the only one of the four with a decorative feature, a silhouette of a camel in steel on top of the peak of the pyramid. This decoration honors Hi Jolly's association with the camel driving expedition of 1857 across what would become northern Arizona and is described further in the additional historic context information below.

The Pyramidal Monuments in Arizona, 1925-1943 Multiple Property Documentation Form describes the general architectural context of Egyptian Revival influenced, primarily funerary monuments that were constructed in the United States in the 19th and early 20th centuries, and in Arizona in the second quarter of the 20th century. Specific references to the Hi Jolly Monument can be found in the document's Section E, pages 13-15.

Hi Jolly Monument
Name of Property

La Paz AZ
County and State

Developmental history/additional historic context information (if appropriate)

A sign (photograph #6) at the Quartzsite Cemetery reads:

HI JOLLY

The famous camel herd with which the name of Hi Jolly is linked constitutes an interesting sidelight of Arizona history...Jefferson Davis (afterward president of the Southern Confederacy), as Secretary of War, approved a plan to experiment with camels for freighting and communication in the arid Southwest...Major Henry C. Wayne of the U.S. Army and Lt. D.D. Porter (later a distinguished admiral in the Civil War) visited the Levant with the storeship *Supply* and procured 33 camel which were landed at Indianola, Texas, February 19, 1856. 41 were added on a second voyage...With the first camels came, as caretaker, Haiji Ali whose Arabic name was promptly changed to "Hi Jolly" by the soldiers, and by this name he became universally known. His Greek (?) name was Philip Tedro...On the Beale expedition in 1857 to open a wagon road across Arizona from Fort Defiance to California, the camels under Hi Jolly's charge, proved their worth. Nevertheless, the War Department abandoned the experiment and the camels were left on the Arizona desert to shift for themselves, chiefly roaming this particular section. They survived for many years creating interest and exciting...Officially the camel experiment was a failure, but both Lt. Beale and Major Wayne were enthusiastic in praise of the animals. A fair trial might have resulted in complete success.

The impact Haiji Ali made on the town called Tyson's Well (now known as Quartzsite) is a story of great compassion revealing his knowledge and love of camels plus 30 years of dedicated service to the United States Army. In 1935 the Arizona State Highway Commission erected the pyramidal monument that stands today. The Hi Jolly Monument has become a symbol and focal point for the Town of Quartzsite to celebrate every year. Today the Hi Jolly Monument is a highly visited tourist spot in Quartzsite, highlighting a very unusual experiment in U.S. Army history, the United States Camel Corp, and a Greek camel jockey known as Hi Jolly.

9. Major Bibliographical References

Bibliography (Cite the books, articles, and other sources used in preparing this form)

Collins, William S., "Pyramidal Monument in Arizona, 1925-1943," National Register of Historic Places Multiple Property Documentation Form, Arizona State Historic Preservation Office, 2007.

Kathryn Eastlick, "Rediscovering Dad at Hi Jolly's Tomb" Arizona Highways Magazine August 2006.

Previous documentation on file (NPS):

preliminary determination of individual listing (36 CFR 67 has been Requested)
 previously listed in the National Register
 previously determined eligible by the National Register
 designated a National Historic Landmark
 recorded by Historic American Buildings Survey # _____
 recorded by Historic American Engineering Record # _____

Primary location of additional data:

State Historic Preservation Office
 Other State agency
 Federal agency
 Local government
 University
 Other
Name of repository: _____

Hi Jolly Monument
Name of Property

La Paz AZ
County and State

Historic Resources Survey Number (if assigned): _____

10. Geographical Data

Acreage of Property Less than 1
(Do not include previously listed resource acreage)

UTM References

(Place additional UTM references on a continuation sheet)

1	<u>11</u>	<u>756241</u>	<u>3728384</u>	3	_____	_____	_____
	Zone	Easting	Northing		Zone	Easting	Northing
2	_____	_____	_____	4	_____	_____	_____
	Zone	Easting	Northing		Zone	Easting	Northing

Verbal Boundary Description (describe the boundaries of the property)

The boundary of the Hi Jolly Monument encompasses a square with dimensions of eight feet on all sides. The center of the square is situated on the center of the pyramidal monument, with the single UTM coordinate described above.

Boundary Justification (explain why the boundaries were selected)

The boundary includes only the site of the monument itself, without additional land associated with the Quartzsite Cemetery.

11. Form Prepared By

name/title Dinice Ross, Hi Jolly Cemetery, Records; Dick Boss; Jim Turner
organization Town of Quartzsite date July 27, 2010
street & number 465 N. Plymouth / P.O. Box 2812 telephone (928) 927-6593
city or town Quartzsite state AZ zip code 85346
e-mail cemetery@ci.quartzsite.az.us

Additional Documentation

Submit the following items with the completed form:

- **Maps:** A **USGS map** (7.5 or 15 minute series) indicating the property's location.
A **Sketch map** for historic districts and properties having large acreage or numerous resources. Key all photographs to this map.
- **Continuation Sheets**

Hi Jolly Monument
Name of Property

La Paz AZ
County and State

- **Additional items:** (Check with the SHPO or FPO for any additional items)

Photographs:

Submit clear and descriptive photographs. The size of each image must be 1600x1200 pixels at 300 ppi (pixels per inch) or larger. Key all photographs to the sketch map.

Name of Property: Hi Jolly Monument

City or Vicinity: Quartzsite

County: La Paz **State:** AZ

Photographer: Ken Hardies

Date Photographed: May 2010

Description of Photograph(s) and number:

- 1 of 6 . South face of monument, camera facing north
- 2 of 6 . West face of monument, camera facing east
- 3 of 6 . North face of monument, camera facing south
- 4 of 6 . Plaque on the south face of the monument, camera facing north
- 5 of 6 . Hi Jolly Kiosk facing southeast, camera facing northeast
- 6 of 6 . Hi Jolly Sign facing southwest, camera facing northeast

Property Owner:

name Town of Quartzsite
street & number 465 N. Plymouth Ave. telephone (928) 927-6593
city or town Quartzsite state AZ zip code 85346

Paperwork Reduction Act Statement: This information is being collected for applications to the National Register of Historic Places to nominate properties for listing or determine eligibility for listing, to list properties, and to amend existing listings. Response to this request is required to obtain a benefit in accordance with the National Historic Preservation Act, as amended (16 U.S.C.460 et seq.).
Estimated Burden Statement: Public reporting burden for this form is estimated to average 18 hours per response including time for reviewing instructions, gathering and maintaining data, and completing and reviewing the form. Direct comments regarding this burden estimate or any aspect of this form to the Office of Planning and Performance Management, U.S. Dept. of the Interior, 1849 C. Street, NW, Washington, DC.

UNITED STATES DEPARTMENT OF THE INTERIOR
NATIONAL PARK SERVICE

NATIONAL REGISTER OF HISTORIC PLACES
EVALUATION/RETURN SHEET

REQUESTED ACTION: NOMINATION

PROPERTY NAME: Hi Jolly Monument

MULTIPLE NAME: Pyramidal Monuments in Arizona MPS

STATE & COUNTY: ARIZONA, La Paz

DATE RECEIVED: 1/13/11

DATE OF PENDING LIST:

DATE OF 16TH DAY:

DATE OF 45TH DAY:

2/28/11

DATE OF WEEKLY LIST:

REFERENCE NUMBER: 11000054

REASONS FOR REVIEW:

APPEAL: N DATA PROBLEM: N LANDSCAPE: N LESS THAN 50 YEARS: N
OTHER: N PDIL: N PERIOD: N PROGRAM UNAPPROVED: N
REQUEST: N SAMPLE: N SLR DRAFT: N NATIONAL: N

COMMENT WAIVER: N

ACCEPT RETURN REJECT 2-28-11 DATE

ABSTRACT/SUMMARY COMMENTS:

Entered in
The National Register
of
Historic Places

RECOM./CRITERIA _____

REVIEWER _____

DISCIPLINE _____

TELEPHONE _____

DATE _____

DOCUMENTATION see attached comments Y/N see attached SLR Y/N

If a nomination is returned to the nominating authority, the nomination is no longer under consideration by the NPS.



THE LAST CAMP
OF
HI JOLLY
BORN FOUNDLING IN SYRIA
ABOUT 1868
DIED AT QUARTZSITE
DECEMBER 18 1902
CAME TO THIS COUNTRY
FEBRUARY 10 1894
CAMELDIVER - PACKER
SCOUT - OVER THIRTY
YEARS A FAITHFUL AID
TO THE U.S. GOVERNMENT
ARIZONA
HIGHWAY DEPARTMENT
1929



Photo #1
AZ-LaPaz County - Hi Jolly Monument
Photographer - Ken Hardies
Date 5/2010
South Face of Pyramid
Camera facing North



Photo 2
AZ. La Paz County - H. Jolly Monument
Photographer - Ken Hardie
Date 5/2010
West Face of Pyramid
Camera facing East



Photo 3
AZ. La Paz County - Hijo
Monument

Photographer Ken Hardies

Date 5/2010

North Face of Pyramid
Camera facing South

THE LAST CAMP
OF

HI JOLLY

BORN SOMEWHERE IN SYRIA
ABOUT 1828

DIED AT QUARTZSITE
DECEMBER 16 1902

CAME TO THIS COUNTRY
FEBRUARY 10 1856

CAMELDRIVER - PACKER
SCOUT - OVER THIRTY
YEARS A FAITHFUL AID
TO THE U.S. GOVERNMENT

ARIZONA
HIGHWAY DEPARTMENT
1955

Photo 4

AZ - La Paz County - Hi Jolly Monument
Photographer Ken Hardies

Date 5/2010

South Face of pyramid - plaque of
"The Last Camp of Hi Jolly"
Camera facing North

HI JOLLY CEMETERY

FOR INFORMATION CONTACT:

Tysons Wells Stage Station Museum
151 W. Main St., P.O. Box 331
Quartzsite, Arizona 85346
Phone (928) 927-9229
©2003 HOOPER/STARR DESIGN

Quartzsite Public Library
465 N. Plymouth Ave., P.O. Box 2812
Quartzsite, Arizona 85346
Phone (928) 927-6593



LEGEND

The camel atop the Pyramid symbolizes the legend of The Bad Chieftan that roamed the desert, sometimes men and beast with what amounted to a corpse tied to his back.

Legend also has it that the ashes of Tyson, Hi Jolly's favorite camel and companion are also placed in the bronze stone capsule.



Photo 5

AZ - La Paz County - Hi Jolly Monument

Photographer - Ken Hardies

Date 5/2010

Hi Jolly kiosk + signage Facing Southeast
Camera facing Northwest.

HI JOLLY

THE FAMOUS CAMEL HERD WITH WHICH THE NAME OF HI JOLLY IS LINKED CONSTITUTES AN INTERESTING SIDELIGHT OF ARIZONA HISTORY.... JEFFERSON DAVIS (AFTERWARD PRESIDENT OF THE SOUTHERN CONFEDERACY) AS SECRETARY OF WAR APPROVED A PLAN TO EXPERIMENT WITH CAMELS FOR FREIGHTING AND COMMUNICATION IN THE ARID SOUTHWEST.... MAJOR HENRY C. WAYNE OF THE U.S. ARMY AND LT. D.D. PORTER (LATER A DISTINGUISHED ADMIRAL IN THE CIVIL WAR) VISITED THE LEVANT WITH THE STORESHIP SUPPLY AND PROCURED 33 CAMELS WHICH WERE LANDED AT INDIANOLA, TEXAS, FEBRUARY 10, 1856. 41 WERE ADDED ON A SECOND VOYAGE.... WITH THE FIRST CAMELS CAME AS CARETAKER, HAIJI ALI WHOSE ARABIC NAME WAS PROMPTLY CHANGED TO 'HI JOLLY' BY THE SOLDIERS, AND BY THIS NAME HE BECAME UNIVERSALLY KNOWN. HIS GREEK (?) NAME WAS PHILIP TEDRO.... ON THE BEALE EXPEDITION IN 1857 TO OPEN A WAGON ROAD ACROSS ARIZONA FROM FORT DEFIANCE TO CALIFORNIA, THE CAMELS UNDER HI JOLLY'S CHARGE, PROVED THEIR WORTH. NEVERTHELESS, THE WAR DEPARTMENT ABANDONED THE EXPERIMENT AND THE CAMELS WERE LEFT ON THE ARIZONA DESERT TO SHIFT FOR THEMSELVES. CHIEFLY ROAMING THIS PARTICULAR SECTION, THEY SURVIVED FOR MANY YEARS CREATING INTEREST AND EXCITEMENT.... OFFICIALLY THE CAMEL EXPERIMENT WAS A FAILURE, BUT BOTH LT. BEALE AND MAJOR WAYNE WERE ENTHUSIASTIC IN PRAISE OF THE ANIMALS. A FAIR TRIAL MIGHT HAVE RESULTED IN COMPLETE SUCCESS.

Photo 6

AZ - La Paz County - Hi Jolly Monument

Photographer - Ken Hardies

Date 5/2010

Hi Jolly Site Facing Southwest

Camera facing North east

Jolly
pyramidal
monument
LTM
one 11
756241
3728384





January 11, 2011

Carol Shull
Keeper of the National Register
National Park Service
1201 Eye Street, NW 8th Floor (MS2280)
Washington, D.C. 2005-5905



**RE: Hi Jolly Monument
Quartzsite, La Paz, AZ**

Janice K. Brewer
Governor

State Parks
Board Members

Chair
Reese Woodling
Tucson

Tracey Westerhausen
Phoenix

Larry Landry
Phoenix

Walter D. Armer, Jr.
Vail

Arlan Colton
Tucson

William C. Scalzo
Phoenix

Maria Baier
State Land
Commissioner

Renée E. Bahl
Executive Director

Arizona State Parks
1300 W. Washington
Phoenix, AZ 85007

Tel & TTY: 602.542.4174
AZStateParks.com

800.285.3703 from
(520 & 928) area codes

General Fax:
602.542.4180

Director's Office Fax:
602.542.4188

Dear Ms. Shull:

I am pleased to submit the National Register of Historic Places Registration Form for the property referenced above.

Accompanying documentation is enclosed, as required. Should you have any questions or concerns please contact me at vstrang@azstateparks.gov or at 602.542.4662.

Sincerely,

Vivia Strang, CPM
National Register Coordinator
State Historic Preservation Office

Enclosures

VS:vs

Arizona®
State Parks



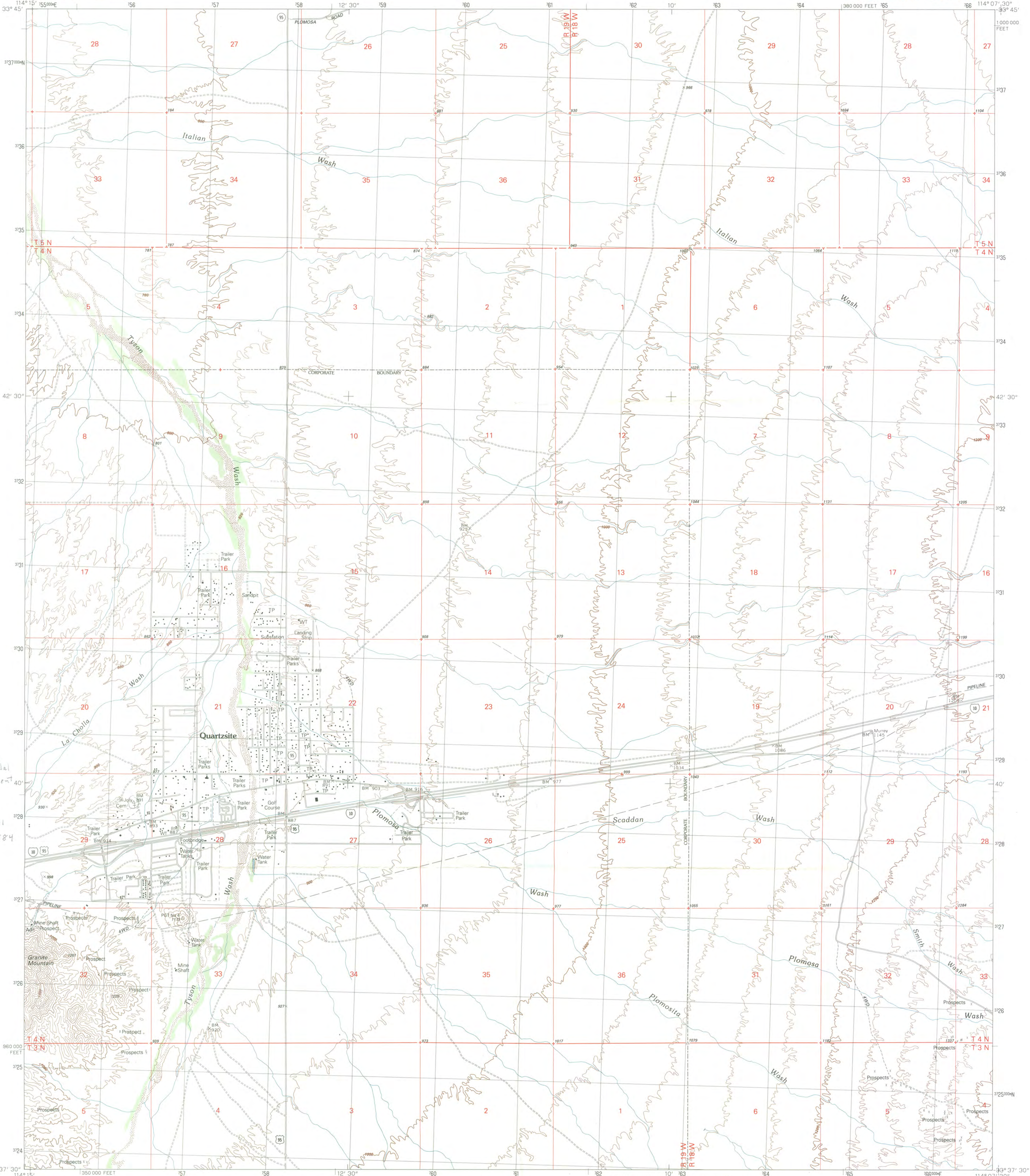

Hi Jolly
Pyramidal
Monument
UTM
Zone 11
756241
3728384

PRODUCED BY THE UNITED STATES GEOLOGICAL SURVEY
CONTROL BY USGS, NOS/NOAA
COMPILED FROM AERIAL PHOTOGRAPHS TAKEN 1951 AND 1960
FIELD CHECKED 1962
LIMITED REVISION FROM AERIAL PHOTOGRAPHS TAKEN 1985
FIELD CHECKED 1987
MAP EDITED 1990
PROJECTION TRANSVERSE MERCATOR
GRID 1000-METER UNIVERSAL TRANSVERSE MERCATOR ZONE 11
2000-FOOT STATE GRID TICKS ARIZONA, WEST ZONE
UTM GRID DECLINATION 134° EAST
1990 MAGNETIC NORTH DECLINATION 13° EAST
VERTICAL DATUM NATIONAL GEODETIC VERTICAL DATUM OF 1929
HORIZONTAL DATUM 1983 NORTH AMERICAN DATUM
To place on the predicted North American Datum of 1983,
move the projection lines as shown by dashed corner ticks
(2 meters south and 72 meters east)
There may be private inholdings within the boundaries of any
Federal and State Reservations shown on this map
Public Land Survey System is shown as published in 1962 and
verified or supplemented in 1987

PROVISIONAL MAP
Produced from original
manuscript drawings. Informa-
tion shown as of date of
field check.

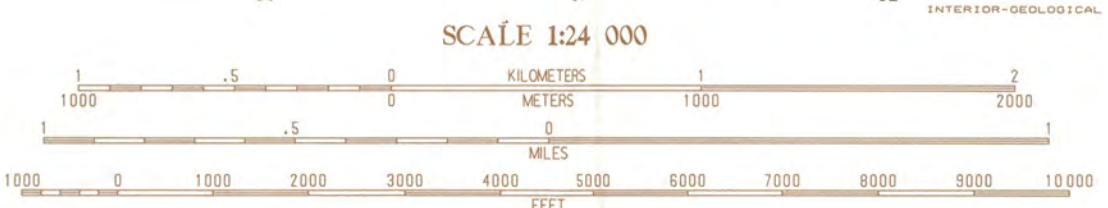

QUADRANGLE LOCATION

1	2	3	4	5	6	7	8
1 Moon Mountain SE	2 Bone SW	3 Dix Peak	4 Middle Camp Mountain	5 Plomosa Pass	6 Cunningham Mountain	7 South of Quartzsite	8 Crystal Hill

ADJOINING 7.5 QUADRANGLE NAMES

ROAD LEGEND
Improved Road
Unimproved Road
Trail
Interstate Route U.S. Route State Route

QUARTZSITE, ARIZONA
PROVISIONAL EDITION 1990

33114-P2-TT-024

