

4. State/Federal Agency Certification

As the designated authority under the National Historic Preservation Act of 1966, as amended, I hereby certify that this x nomination request for determination of eligibility meets the documentation standards for registering properties in the National Register of Historic Places and meets the procedural and professional requirements set forth in 36 CFR Part 60. In my opinion, the property x meets does not meet the National Register criteria.
 See continuation sheet.

Barbara Sudler

6-15-89

Signature of certifying official
State Historic Preservation Officer
State or Federal agency or bureau

Date

In my opinion, the property meets does not meet the National Register criteria. See continuation sheet.

Signature of commenting or other official

Date

State or Federal agency or bureau

5. National Park Service Certification

I, hereby, certify that this property is:

entered in the National Register
 See continuation sheet

 determined eligible for the National Register. See continuation sheet

 determined not eligible for the National Register.

 removed from the National Register
 other, (explain:)

Allene Byers

8/3/89

Signature of the Keeper

Date

6. Functions or Use

Historic Functions
(enter categories from instructions)
DOMESTIC/single dwelling
DOMESTIC/secondary structure

Current Functions
(enter categories from instructions)
DOMESTIC/single dwelling
DOMESTIC/secondary structure

7. Description

Architectural Classification
(enter categories from instructions)

Materials
(enter categories from instructions)

OTHER: VERNACULAR WOOD FRAME

foundations: STONE
walls: WOOD/weatherboard
WOOD/log
roof: METAL
other: _____

Describe present and historic physical appearance.

The William D. Parry house is included in the "Historic Resources of Marble, Colorado, and Vicinity" multiple property listing under the historic context of "Settlement and Development of the Town of Marble, Colorado, 1881-1917." Because the William D. Parry House and its associated secondary structures were (1) privately constructed within the 1881-1917 period of significance, and (2) reflect their original design, workmanship, materials, and setting, they meet the registration requirements of the "Private Residences of Marble, Colorado" property type.

Typical of the lots in the town of Marble, the Parry house is on a heavily-forested site; the landscaping is natural vegetation. The building faces Main Street. The town's commercial center was originally located one block east of the house, but nearly all the commercial buildings are gone. At the end of the block, to the east, is the Marble City State Bank. There are nine buildings on the property: The Parry House and eight contributing outbuildings.

The William D. Parry house is a front-gabled, one-and-a-half story, vernacular, wood frame building. The building has a center, paneled, front door with a transom, flanked by narrow double-hung windows with simple wooden surrounds. The front gable end has decorative wood shingles and a small, square window. The vergeboard on the front gable end is decorated with vertical wooden slats. The full-width, front, shed porch has chamfered post supports, a stickwork balustrade, a wooden porch floor, a porch frieze with wooden slats, and a small triangular-shaped pediment above the center bay.

X See continuation sheet

United States Department of the Interior
National Park Service

NATIONAL REGISTER OF HISTORIC PLACES
CONTINUATION SHEET

Section number 7 Page 1 William D. Parry House

The building has board and batten siding. Most of the wood is unpainted, although the front of the building has been painted white with green trim, the colors of the Colorado-Yule Marble Company. The side elevations have four over four windows with simple wood surrounds. The building has a corrugated metal roof, with the remains of a brick chimney. A shed addition is located in the rear.

Eight secondary structures are located behind the Parry house. Winifred VanOver, the granddaughter of William Parry, recalled that her grandfather and father never wanted any of their machinery exposed to the elements so they built numerous sheds on the property. The main house and secondary structures are connected by wooden sidewalks. Some of the secondary structures have stone foundations; others have no foundation.

Following is a list of the William D. Parry secondary structures. The numbers are keyed to the sketch map which accompanies this nomination:

- 1) A front-gabled outbuilding, with board and batten and vertical plank siding. This building is shown on the 1914 Sanborn map as a residence.
- 2) A shed with vertical board siding and a corrugated metal roof.
- 3) A false front building with board and batten siding attached to a dilapidated log structure. This building served as the home of William Parry, after his son married and lived with his wife and family in the main house.
- 4) A log shed, in deteriorated condition.
- 5) A privy with vertical board siding.
- 6) A partially collapsed shed with vertical board siding used as a garage.
- 7) A garage with vertical board siding, barn doors, and a metal roof.
- 8) A privy with vertical board siding.

8. Statement of Significance

Certifying official has considered the significance of this property in relation to other properties: ___ nationally ___ statewide X locally

Applicable National Register Criteria X A ___ B X C ___ D
Criteria Considerations (Exceptions) ___ A ___ B ___ C ___ D ___ E ___ F ___ G

Areas of Significance

(enter categories from instructions)

ARCHITECTURE

EXPLORATION/SETTLEMENT

Period of Significance

Significant Dates

1891

1891-1917

Cultural Affiliation

N/A

Significant Person

N/A

Architect/Builder

William D. Parry

State significance of property, and justify criteria, criteria considerations, and areas and periods of significance noted above.

The William D. Parry house was built in 1891 by one of the pioneers of Marble, Colorado. In 1881, William D. Parry, together with William Wood, founded the town of Marble which, by the early twentieth century, had become the center of one of the most significant marble quarrying regions in the United States. Because it is associated with the founding and settlement of Marble, the William D. Parry House is eligible to the National Register of Historic Places under criterion A. Because it is a rare and well-preserved representation of the town's settlement-era architecture, the Parry House is also eligible to the National Register under criterion C. The Parry house is included in the "Historic Resources of Marble, Colorado, and Vicinity," multiple property listing under the historic context of "Settlement and Development of the Town of Marble, 1881-1917." The house meets the registration requirements of the "Private Residences of Marble, Colorado" property type.

William Parry was born 10 May 1856 in Wales, where, as a boy, he worked as a carpenter. At the age of sixteen, Parry emigrated to the United States, settling in Boston. In 1879, he came to Cripple Creek, and later worked as a miner in the mining towns of Leadville, Georgetown, Schofield, and Gothic, Colorado.

In 1881, W. F. Mason and John Mobley founded the town of Clarence at the junction of Carbonate Creek and Yule Creek in the Crystal River Valley. At

X See continuation sheet

927

NPS Form 10-900
(Rev. 8/86)
NPS/WHS Word Processor Format
(Approved 03/88)

OMB No. 1024-0018

United States Department of the Interior
National Park Service

JUN 28 1989

NATIONAL REGISTER

NATIONAL REGISTER OF HISTORIC PLACES
REGISTRATION FORM

This form is for use in nominating or requesting determinations of eligibility for individual properties or districts. See instructions in Guidelines for Completing National Register Forms (National Register Bulletin 16). Complete each item by marking "x" in the appropriate box or by entering the requested information. If an item does not apply to the property being documented, enter "N/A" for "not applicable." For functions, styles, materials, and areas of significance, enter only the categories and subcategories listed in the instructions. For additional space use continuation sheets (Form 10-900a). Type all entries. Use letter quality printers in 12 pitch. Use only 25% or greater cotton content bond paper.

1. Name of Property

historic name: William D. Parry House

other names/site number: N/A

2. Location

street & number: 115 Main Street not for publication

city, town: Marble vicinity

state: Colorado code: CO county: Gunnison code: 051 zip code: 81623

3. Classification

| Ownership of Property | Category of Property | No. of Resources within Property | |
|---|---|----------------------------------|-------------------------------------|
| <input checked="" type="checkbox"/> private | <input checked="" type="checkbox"/> building(s) | contributing | noncontributing |
| <input type="checkbox"/> public-local | <input type="checkbox"/> district | <u>9</u> | <input type="checkbox"/> buildings |
| <input type="checkbox"/> public-State | <input type="checkbox"/> site | <input type="checkbox"/> | <input type="checkbox"/> sites |
| <input type="checkbox"/> public-Federal | <input type="checkbox"/> structure | <input type="checkbox"/> | <input type="checkbox"/> structures |
| | <input type="checkbox"/> object | <input type="checkbox"/> | <input type="checkbox"/> objects |
| | | <u>9</u> | <u>0</u> Total |

Name of related multiple property listing: Historic Resources of Marble, Colorado, and Vicinity
No. of contributing resources previously listed in the National Register

United States Department of the Interior
National Park Service

NATIONAL REGISTER OF HISTORIC PLACES
CONTINUATION SHEET

Section number 8 Page 1 William D. Parry House

approximately the same time, William Woods and William Parry, who had been prospecting for precious metals in the area, plotted the town of Marble immediately west of Clarence. On 1 October 1885, Parry, together with John McKay and G. D. Griffith, located two 1500 by three hundred foot marble lode claims on the west side of Yule Creek. These two claims, the London and the New Discovery--along with the Blue Marble and the White Marble claims which were located in July, 1886, by Parry, McKay, Griffith, and A. A. Johnson--soon became the center of marble operations on Yule Creek.

In the spring of 1887, Parry married Mary Elizabeth Foulkes, a native of Liverpool, England. Parry had met Foulkes during a trip to Wales, and they were married in New York. Although Parry had founded Marble, he and his wife originally lived in a cabin he built near the Penny Hot Springs close to Redstone, Colorado. The Parry's only child, Wilfred C. Parry, was born in 1888.

In 1891, the Parrys moved to Marble, at which time William Parry built this house at 115 Main Street. Elizabeth Parry died in 1917. After his son Wilfred Parry married Minnie Crist, William Parry moved into one of the secondary buildings on the property, leaving the family house to his son. The false-fronted secondary building in which William Parry lived until his death in 1917, is still standing behind the main house. Wilfred and Minnie Parry lived in the house until Wilfred's death in 1950. In 1952, the home was purchased by Mary and Paul Ganley.

The William Parry House has retained a high degree of architectural integrity, and is an excellent representation of the town's settlement-era architecture. Like many of the town's historic private residences, the William Parry House is a front-gabled, vernacular wood frame building with simple ornamentation. The building has a center door, flanked by narrow double-hung windows with simple wooden surrounds. The front gable end has decorative wood shingles, and a vergeboard decorated with vertical wooden slats. The front porch has chamfered post supports, a stickwork balustrade, a porch frieze with wooden slats, and a small triangular-shaped pediment above the center bay.

9. Major Bibliographical References

McCollum, Duncan. Self-Guided Walking Tour, Marble, Colorado. Marble, Colo.: The Marble Historical Society, n.d.

VanOver, Winifred. Glenwood Springs, Colorado. Telephone interview, March, 1989.

Previous documentation on file (NPS): See continuation sheet

preliminary determination of individual listing (36 CFR 67) has been requested

previously listed in the National Register

previously determined eligible by the National Register

designated a National Historic Landmark

recorded by Historic American Buildings Survey # _____

recorded by Historic American Engineering Record # _____

Primary location of additional data:

State Historic Preservation Office

Other State agency

Federal agency

Local government

University

Other

Specify Repository: _____

10. Geographical Data

Acreage of property: less than one acre

UTM References

A 1/3 3/1/0/6/6/0 4/3/2/6/8/4/0 B / / / / / / / / / /

Zone Easting Northing Zone Easting Northing

See continuation sheet

Verbal Boundary Description

The William D. Parry property is located on lots 18-24 of block 20, Town of Marble.

See continuation sheet

Boundary Justification

The boundaries include all of the property that was historically associated with the William D. Parry house.

See continuation sheet

11. Form Prepared By

name/title: Christine Whitacre and R. Laurie Simmons

organization: Front Range Research Associates, Inc. date: March, 1989

street & number: 3635 W. 46th Avenue telephone: (303) 477-7597

city or town: Denver state: CO zip code: 80211

United States Department of the Interior
National Park Service

NATIONAL REGISTER OF HISTORIC PLACES
CONTINUATION SHEET

Section number photographs Page 1 William D. Parry House

Property: William D. Parry House
115 Main Street
Marble, Colorado 81623

Photographer: Roger Whitacre

Date: October, 1988

Negative Location: Colorado Office of Archaeology and Historic Preservation
1300 Broadway
Denver, Colorado 80203

| <u>Photo Number</u> | <u>View</u> |
|---------------------|--|
| 1 | William D. Parry House (facade) Camera Orientation: north |
| 2 | William D. Parry House (outbuildings) Camera Orientation: northwest |

William D. Parry House
Marble, Colorado

Sketch Map - Not to
scale

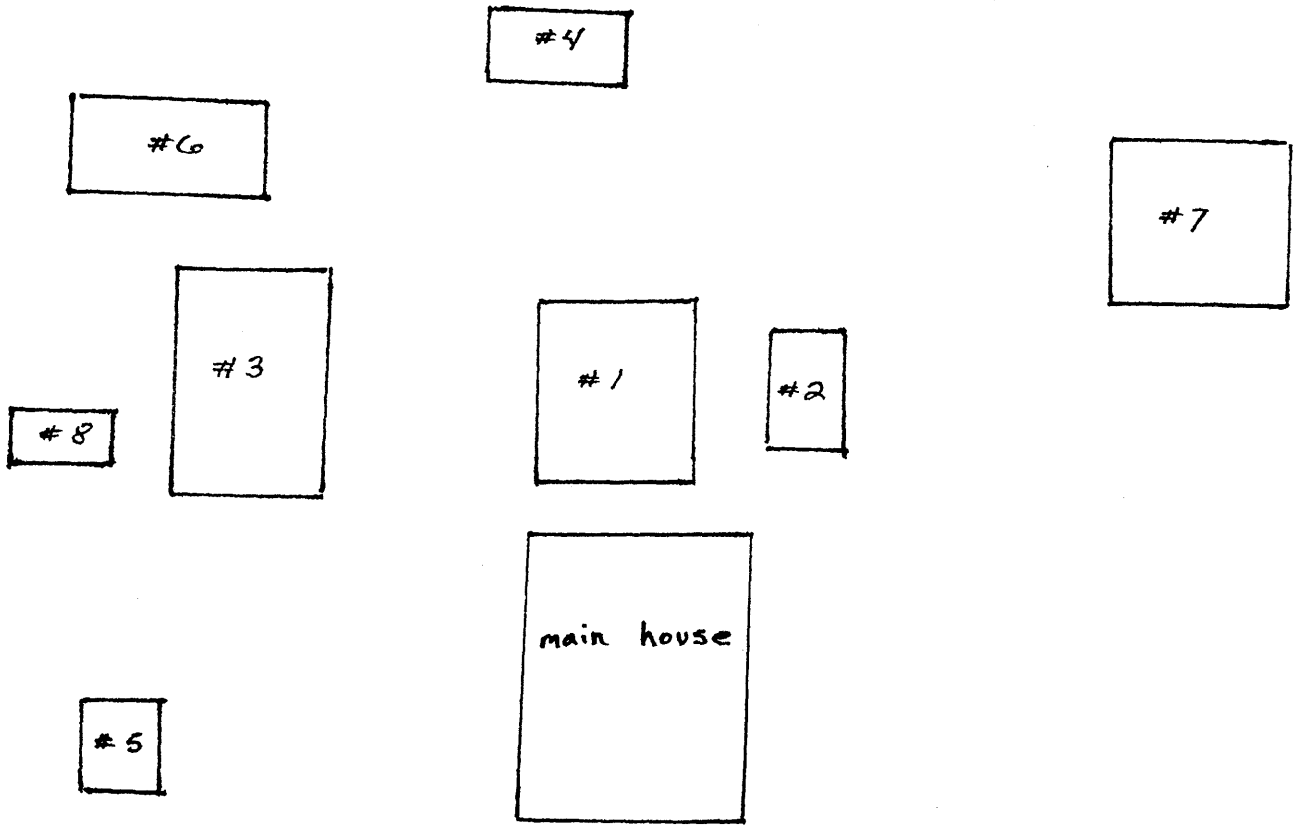

Main Street
