

MAR 19 1984

KENTUCKY HISTORIC RESOURCES INVENTORY

Site No. Tm-70

1. Historic Name(s) Page House		22. ADD/County No. Ky./Trimble 112	
Original Owner Robert G. Page		23. U.S.G.S. Quadrant (15'/75') Madison West G.I.S. Mod. 112	
2. Present Name		24. UTM Reference 16 637640 4287720 Zone Easting Northing	
3. Location Cooper's Bottom Road		25. Coordinate Accuracy <input type="checkbox"/>	
4. Owner's Name Harold Alsup		26. Prehistoric Site Object Historic Site Structure (Building) Other	
5. Owner's Address Route #2, Milton, Kentucky 40045		27. National Register District Name: Historic Resources of Trimble County	
6. Open to Public Yes <input type="checkbox"/> No XX	7. Visible from road Yes XX No <input type="checkbox"/>	8. Ownership Private <input checked="" type="checkbox"/> Local <input type="checkbox"/> State <input type="checkbox"/> Federal <input type="checkbox"/>	28. Significance Evaluation National Register <input checked="" type="checkbox"/>
9. Local Contact/Organization Rodney Ulsep		29. Status _____ Date _____ National Landmark <input type="checkbox"/> National Register <input type="checkbox"/> Landmark Certificate <input type="checkbox"/> Kentucky Survey <input type="checkbox"/> Local Landmark <input type="checkbox"/> HABS/HAER <input type="checkbox"/>	
10. Site Plan with North Arrow		30. Historic Theme Primary Architecture <input checked="" type="checkbox"/> Secondary _____ Other _____	
11. Architect		31. Endangered Yes <input type="checkbox"/> No XX	
12. Builder Robert Page		32. Preservation Project Status <input type="checkbox"/>	
13. Date ca. 1896 A. <input checked="" type="checkbox"/> B. <input type="checkbox"/>		Actual Cost in \$1,000s 11111	
14. Style A. Vernacular <input checked="" type="checkbox"/> B. <input type="checkbox"/>		33. ATTACH PHOTO	
15. Original Use Dwelling <input checked="" type="checkbox"/>			
16. Present use Vacant			
17. Condition Excellent <input checked="" type="checkbox"/>		Roll No. 49	
18. Description Situated on a slight rise overlooking the Ohio River, the Page House is a two-story frame structure with a one and one-half story frame ell. Fenestration is five-bays with a central entrance enhanced with a one-pane transom and five-pane sidelights. The entranceway is accented by a one-story, one-bay portico supported by four Doric Order columns. The facade is further enhanced by a center (Continue on Back)		Picture No. 1 - 15	
No. Stories Two <input checked="" type="checkbox"/>		Direction _____	
Single Pile _____ NA _____		34. Prepared by: William Gus Johnson Sr. Historian & Photographer	
Double Pile XX		35. Organization Kentucky Heritage Council	
Floor Plan Center Passage <input checked="" type="checkbox"/>		36. Date Fall 1982	
Structural Fabric Frame A. <input checked="" type="checkbox"/> B. <input type="checkbox"/>		37. Revision Dates _____	
Decorative Fabric Vergeboard A. <input checked="" type="checkbox"/> B. <input type="checkbox"/>		38. Staff Review _____	
Roof Form			
19. History The dwelling was built for Robert Page ca.1896. Page originally planned to build a three-story house, but he ran out of funds. In 1914 the house and farm were acquired by Gus Shimfessel, originally from Clark County.			
20. Significance Architecture: A well-designed and well-preserved illustration of local vernacular architecture in the county. The Page House is one of the best examples			
21. Source of Information			

18. gable pierced by a nine-pane lancet door. Windows are 6/6 pane. Off-center ridgeline chimneys arise from the gable roof of the main block, while the ell has an interior gable-end chimney. The dwelling rests on a limestone foundation. Vergeboard trim embellish all sides of the structure. The high quality of the interior woodwork is reflected in the pedimented trim. Original wide plank hardwood floors remain intact. Associated with the dwelling are two outbuildings, a one-story frame meathouse and one and one-half story frame barn.

20. of late nineteenth century vernacular architecture in Trimble County, and exhibits qualities of excellent workmanship in both exterior and interior details.

KENTUCKY HISTORIC RESOURCE INVENTORY SUPPLEMENT
BOUNDARY AND LOCATION INFORMATION

Historic Property Name Page House Site # Tm-70

Multiple Resource/Thematic Nomination Title Historic Resources of Trimble County

U.T.M. Coordinates - List multiple UTMs if property is ten or more acres.

A. 16 637640 4287720 D. _____

B. _____ E. _____

C. _____ F. _____

Verbal Boundary Description 1
Acreage 1

Beginning at the intersection of the farm lane and Cooper's Bottom Road proceed 200' in a northeastward direction along Cooper's Bottom Road; thence 200' in a southeastward direction; thence 200' in a southwestward direction; thence 200' in a northwestward direction along the farm lane to the point of origin.

Sketch of Site Plan (Showing outbuildings, structures, landscape features and the site boundary as described above.)

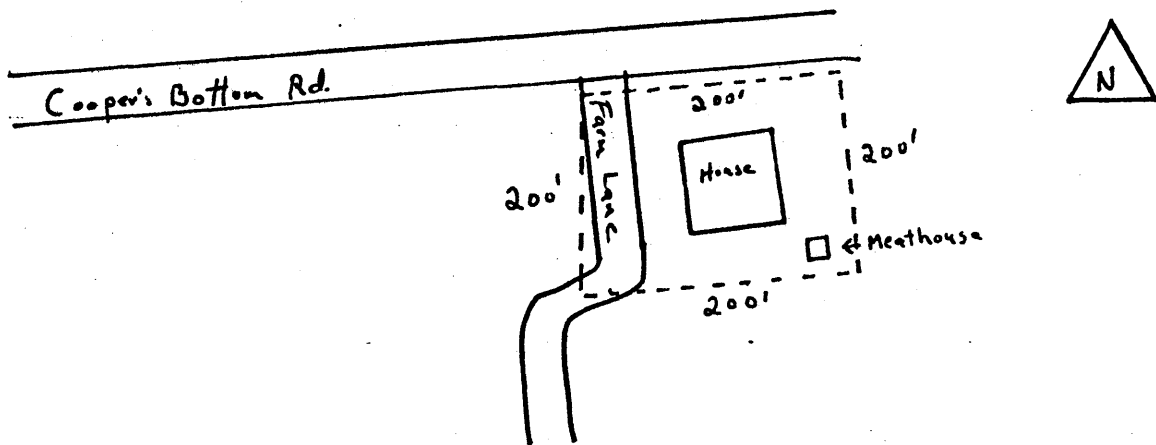

Not to scale

Official Courthouse Property Reference: