

9. LITTLEBERRY PIPPEN HOUSE  
431 Springfield Street

Mr. and Mrs George N. Clark, Jr.  
203 Pickens St.  
Eutaw, AL 35462

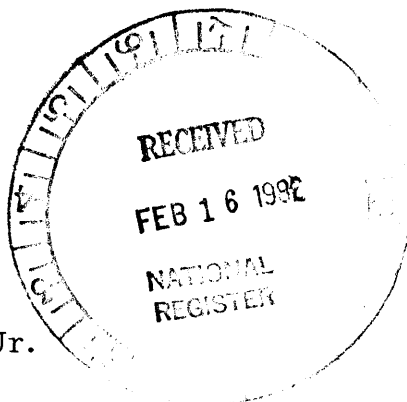

Lot: 130 Tax Map 35-18-33-1-14-1

1.85 acres (138' Pickens, 404.58'  
Springfield Rd, 218' deep)

Latitude: 32° 50' 31"

Longitude 87° 53' 9"

Early 1840's Builder/Architect unknown  
alterations uncertain date

SIGNIFICANCE: With strong Greek Revival modifications, this is one of the three similar houses of Creole Cottage inspiration.

DESCRIPTION: This resembles the Vaughan House in its shape, porch arrangement and roof form; but in place of slender colonnetts it has square piers, which, like the pilastered doorway, are in the Greek Revival style. The frontispiece is centered in the east wall, making this clearly the front of the house. The porch has seven posts across, so that the doorway is on axis with the fourth intercolumniation. The entrance opens into a developed hall. The room at the southeast corner is like its counterpart in the Vaughan House in the arrangement of its door and windows, only in reversed walls. Windows are 18-paned, except for the pair flanking the north chimney, having 21 smaller panes.

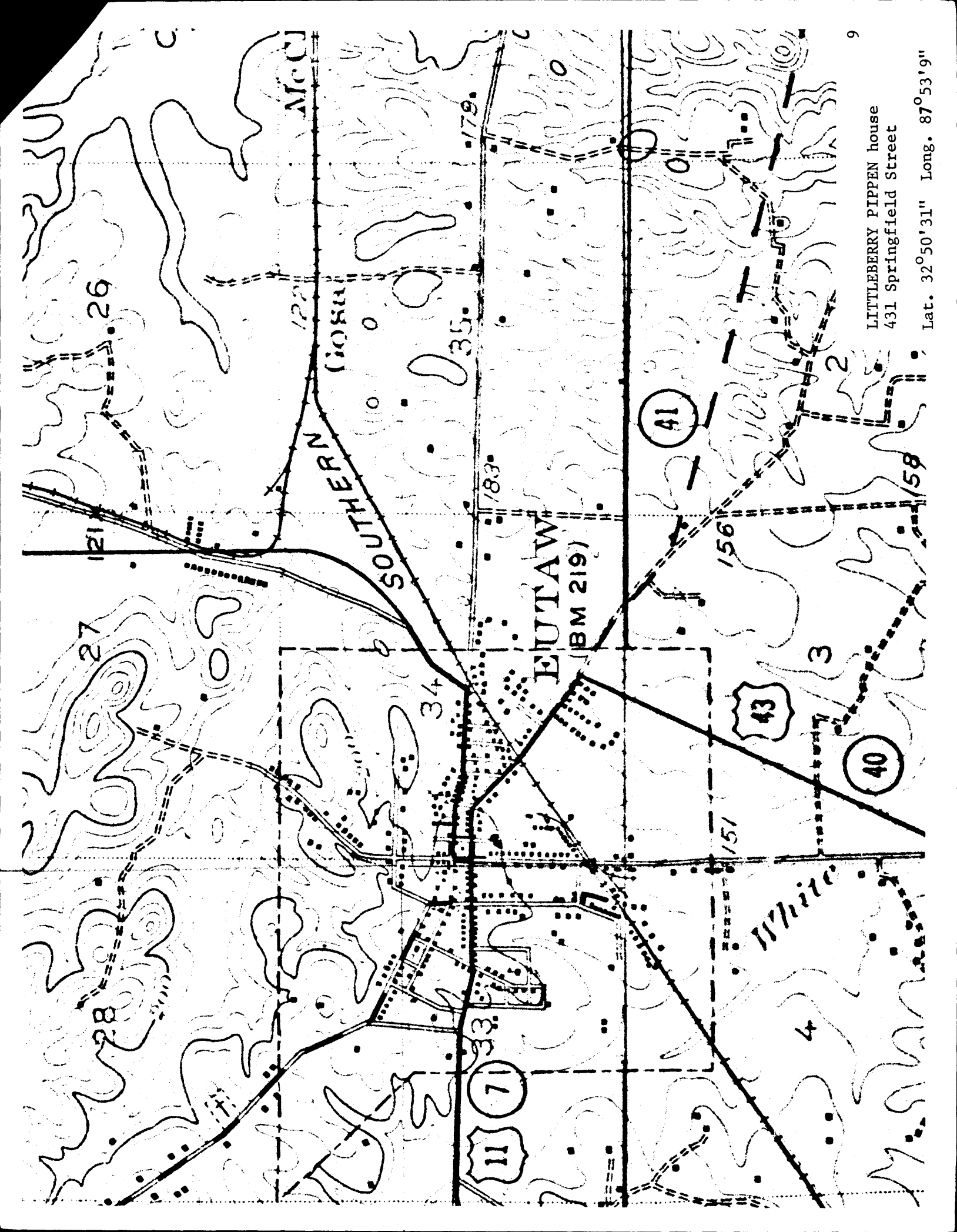

LITTLEBERRY PIPPEN house  
431 Springfield Street

Lat. 32°50'31" Long. 87°53'9"