

United States Department of the Interior
National Park Service

National Register of Historic Places
Inventory—Nomination Form

For NPS use only

received

date entered

Continuation sheet

Item number 1,2,4,7,8,10 Page 50

1. Name: Jesus Valencia House, survey number 95
2. Location: approximately 100' east of Highway 61 and 1.5 miles north of San Juan
4. Owner: Refugio Valencia, San Lorenzo, N.M. 88057
7. Description: Photos 52,53; map 12; rectangular plan; foundation unknown; stuccoed adobe; corrugated metal hipped roof; 2/2 double hung windows, one with sidelights; 2 single doors. Out buildings: unstuccoed adobe, wood frame with vertical plank or wood frame with corrugated metal siding; corrugated metal gable and hipped roofs; single doors; one with widows.
8. Significance: Built in 1911, and unmodified since, this house meets Criterion C as a good example of the incorporation of rectangular plans into the New Mexico Vernacular vocabulary which occurred generally across the state after about 1910.
10. Geographical Data: Approximate Acreage: less than one.
Quadrangle Name: San Lorenzo, N.M. Scale: 1: 62,500
UTM References: 13 227000 3630200
Verbal boundary: A rectangle, roughly 155' by 80', as shown in map 12 formed by lines parallel to and ten feet from the north side of the house, the east side of the eastern most shed, the south side of the southernmost shed and the west side of the southernmost shed. Since this is an unplatted area, this boundary has been created to include only the buildings.

12. Jesus Valencia House (95)
Historic Resources of the
Mimbres Valley, 1987

N ← Photo  →

Not to scale

Boundary - - - - -

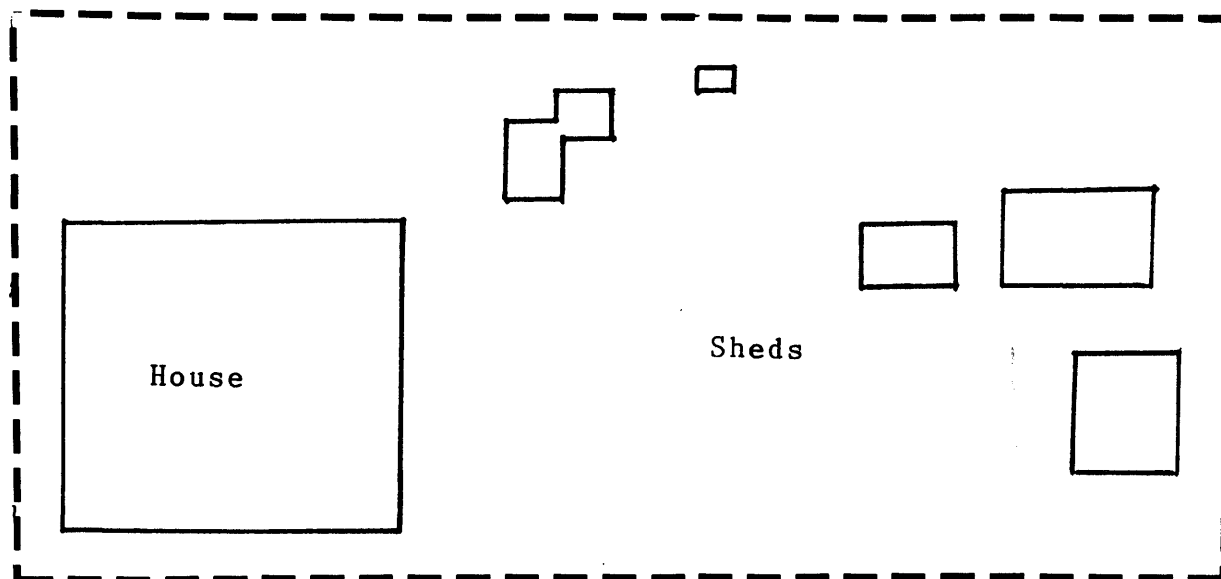

United States Department of the Interior
National Park Service

**National Register of Historic Places
Continuation Sheet**

Section number 4 Page 6

Clyde A. Bloodgood House

Joyce Biebelle
Route 15, Box 1850
San Lorenzo, NM 88057

Luciana B. Grijalva House

John Justus
Box 38
Peralta, NM 87042

Menard-Galaz House

Robert Galaz
Route 15, Box 2375
San Lorenzo, NM 88057

Acklin Store

Santa Fe Mountaineering Center
Route 4, Box 34c
Santa Fe, NM 87501

Antonio Torres House

Antonio Torres
1310 E. Belmont Ave.
Anaheim, Ca. 98205

Mauricio Portillo Homestead

Santiago & Bersabe V. Hinojosa
Box 121
Hanover, NM 88041

Jesus Valencia House

Refugio Valencia
San Lorenzo, NM 88057

George O. Perrault Compound

Charles Disert
Route 15, Box 800
San Lorenzo, NM 88057

San Juan Teacherage

Charles Disert
Route 15, Box 800
San Lorenzo, NM 88057

NAN Ranch

W.B. Hinton, NAN Ranch
Route 15, Box 1425
Faywood, NM 88034

APR 1 1988

United States Department of the Interior
National Park Service

National Register of Historic Places
Continuation Sheet

Section number _____ Page _____

Multiple Resource Area
Thematic Group

Name Mimbres Valley MRA
State Grant County, NEW MEXICO

Nomination/Type of Review Date/Signature

DOE/OWNER OBJECTION

- | | | | | | |
|-----|-----------------------------|----------------------------------|--------|---|----------------|
| 11. | Bloodgood, Clyde A., House | Entered in the National Register | Keeper | <u>Determined Eligible</u>
<u>Eligible - Beth Boland</u> | <u>5/16/88</u> |
| | | Substantive Review | Attest | _____ | _____ |
| 12. | Grijalva, Luciana B., House | Entered in the National Register | Keeper | <u>Melrose Byers</u> | <u>5/16/88</u> |
| | | | Attest | _____ | _____ |
| 13. | Menard--Galaz House | Entered in the National Register | Keeper | <u>Melrose Byers</u> | <u>5/16/88</u> |
| | | | Attest | _____ | _____ |
| 14. | Acklin Store | Entered in the National Register | Keeper | <u>Melrose Byers</u> | <u>5/16/88</u> |
| | | | Attest | _____ | _____ |
| 15. | Torres, Antonio, House | Entered in the National Register | Keeper | <u>Melrose Byers</u> | <u>5/16/88</u> |
| | | | Attest | _____ | _____ |
| 16. | Portillo, Mauricio, House | Substantive Review | Keeper | <u>Beth Boland</u> | <u>5/16/88</u> |
| | | | Attest | _____ | _____ |
| 17. | Valencia, Jesus, House | Entered in the National Register | Keeper | <u>Melrose Byers</u> | <u>5/16/88</u> |
| | | | Attest | _____ | _____ |
| 18. | Perrault, George O., House | Entered in the National Register | Keeper | <u>Melrose Byers</u> | <u>5/16/88</u> |
| | | | Attest | _____ | _____ |
| 19. | San Juan Teacherage | Entered in the National Register | Keeper | <u>Melrose Byers</u> | <u>5/16/88</u> |
| | | | Attest | _____ | _____ |
| 20. | NAN Ranch | Entered in the National Register | Keeper | <u>Melrose Byers</u> | <u>5/16/88</u> |
| | | | Attest | _____ | _____ |