

FORM B - BUILDING

MASSACHUSETTS HISTORICAL COMMISSION  
80 BOYLSTON STREET  
BOSTON, MA 02116

AREA	FORM NO.
	1194

Newton, Mass. MRA  
Town Newton (Newton Corner)

Address 15 Bigelow Terrace

Historic Name Henry Bigelow House

Photo (3"x3" or 3"x5", black and white) Indicate address of property on back of photo. Staple to left side of form.

Use: Present dwelling

Original dwelling

DESCRIPTION

Date c. 1845

Source Jackson Homestead Public.

Style Greek Revival

Architect unknown

Exterior Wall Fabric clapboard

Outbuildings none

Major Alterations (with dates) \_\_\_\_\_

20th c. porch added

Condition Very good

from 334 Washington Street

Moved yes Date 1895

Acreage less than one acre; 5100 sq

Setting urban residential

Sketch Map: Draw map showing property's location in relation to nearest cross streets and/or geographical features. Indicate all buildings between inventoried property and nearest intersection(s). Indicate north

(SEE ATTACHED MAP)

UTM REFERENCE 19.319880.4691750

USGS QUADRANGLE NEWTON, MASS.

SCALE 1:25,000

Recorded by Kathlyn Hatch

Organization Newton Historical Comm.

Date 1/5/77; rev. 3/86 by H. White

NATIONAL REGISTER CRITERIA STATEMENT (if applicable)

Because of its associations with Dr. Henry Bigelow, chairman of the school committee during a period when the Newton school system was widely recognized as one of the most progressive in the country, the Bigelow House meets Criterion B of the National Register of Historic Places.

ARCHITECTURAL SIGNIFICANCE Describe important architectural features and evaluate in terms of other buildings within the community.

The Bigelow House is a three-bay, end-gabled residence. The wide eaves entablature, paneled corner pilasters, cornice returns, and sidelights at the entrance of this well-preserved house are characteristic of Greek revival detailing. The uneven spacing of the front windows, however, is unusual considering the rigid classical symmetry adhered to during the period.

HISTORICAL SIGNIFICANCE Explain the role owners played in local or state history and how the building relates to the development of the community.

Henry Bigelow was a prominent educator and also a patron of the Newton Free Library. The Bigelow School in Newton Corner was named after him, and Bigelow Terrace apparently received its name from the Bigelow family.

BIBLIOGRAPHY and/or REFERENCES

Friends of the Jackson Homestead. Newton's Older Houses: Nonantum & Newton Corner (1976), p. 12.

United States Department of the Interior  
National Park Service

National Register of Historic Places  
Inventory—Nomination Form

For NPS use only  
received 7/23/86  
date entered

Continuation sheet

Item number

Page

Multiple Resource Area  
Thematic Group

Name Newton MRA  
State Middlesex County, MA

Nomination/Type of Review

Date/Signature

21. West Newton Hill  
Historic District

Substantive Review

Keeper

Patrick Anderson 9/4/86

Attest

Betty L. Savage 9/4/86

22. Adams, Amos, House

Substantive Review

Keeper

Patrick Anderson 9/4/86

Attest

Betty L. Savage 9/4/86

23. Adams, Seth, House

Entered in the  
National Register

Keeper

Helena Byers 9/4/86

Attest

24. Auburndale Congregational  
Church

Entered in the  
National Register

Keeper

Helena Byers 9/4/86

Attest

25. Bartlett--Hawkes Farm

Entered in the  
National Register

Keeper

Helena Byers 9/4/86

Attest

26. Bayley House

Entered in the  
National Register

Keeper

Helena Byers 9/4/86

Attest

27. Bemis Mill

Entered in the  
National Register

Keeper

Helena Byers 9/4/86

Attest

28. Bigelow, Henry, House

Entered in the  
National Register

Keeper

Helena Byers 9/4/86

Attest

29. Blodgett, William,  
House

Entered in the  
National Register

Keeper

Helena Byers 9/4/86

Attest

30. Brackett House

Entered in the  
National Register

Keeper

Helena Byers 9/4/86

Attest

NATIONAL REGISTER OF HISTORIC PLACES  
EVALUATION/RETURN SHEET

Bigelow, Henry, House (Newton MRA)  
Middlesex County  
MASSACHUSETTS

Working No. JUL 23 1986  
Fed. Reg. Date: 2/3/87  
Date Due: 8/21/86 - 9/6/86  
Action:  ACCEPT 9/4/86  
 RETURN  
 REJECT  
Federal Agency: \_\_\_\_\_

Incorporated in the  
**National Register**

- resubmission
- nomination by person or local government
- owner objection
- appeal

Substantive Review:  sample  request  appeal  NR decision

Reviewer's comments:

Recom./Criteria \_\_\_\_\_  
Reviewer \_\_\_\_\_  
Discipline \_\_\_\_\_  
Date \_\_\_\_\_  
\_\_\_\_\_ see continuation sheet

Nomination returned for: \_\_\_\_\_ technical corrections cited below  
\_\_\_\_\_ substantive reasons discussed below

1. Name

2. Location

3. Classification

Category	Ownership	Status	Present Use
	Public Acquisition	Accessible	

4. Owner of Property

5. Location of Legal Description

6. Representation in Existing Surveys

Has this property been determined eligible?  yes  no

7. Description

Condition  excellent  good  fair

deteriorated  ruins  unexposed

Check one  unaltered  altered

Check one  original site  moved date \_\_\_\_\_

Describe the present and original (if known) physical appearance

- summary paragraph
- completeness
- clarity
- alterations/integrity
- dates
- boundary selection

---

**8. Significance**

Period \_\_\_\_\_ Areas of Significance—Check and justify below

Specific dates \_\_\_\_\_ Builder/Architect \_\_\_\_\_

Statement of Significance (*in one paragraph*)

- summary paragraph
- completeness
- clarity
- applicable criteria
- justification of areas checked
- relating significance to the resource
- context
- relationship of integrity to significance
- justification of exception
- other

---

**9. Major Bibliographical References**

---

**10. Geographical Data**

Acreage of nominated property \_\_\_\_\_

Quadrangle name \_\_\_\_\_

UTM References \_\_\_\_\_

---

Verbal boundary description and justification

---

**11. Form Prepared By**

---

**12. State Historic Preservation Officer Certification**

The evaluated significance of this property within the state is:

\_\_\_\_ national      \_\_\_\_ state      \_\_\_\_ local

State Historic Preservation Officer signature

title \_\_\_\_\_ date \_\_\_\_\_

---

**13. Other**

- Maps
- Photographs
- Other

Questions concerning this nomination may be directed to \_\_\_\_\_

Signed \_\_\_\_\_ Date \_\_\_\_\_ Phone: \_\_\_\_\_



Bigelow, Henry, Has

Newton, Mass: MRA

15 Bigelow Terr, Newton Corner  
- 77-A-1 (2) -

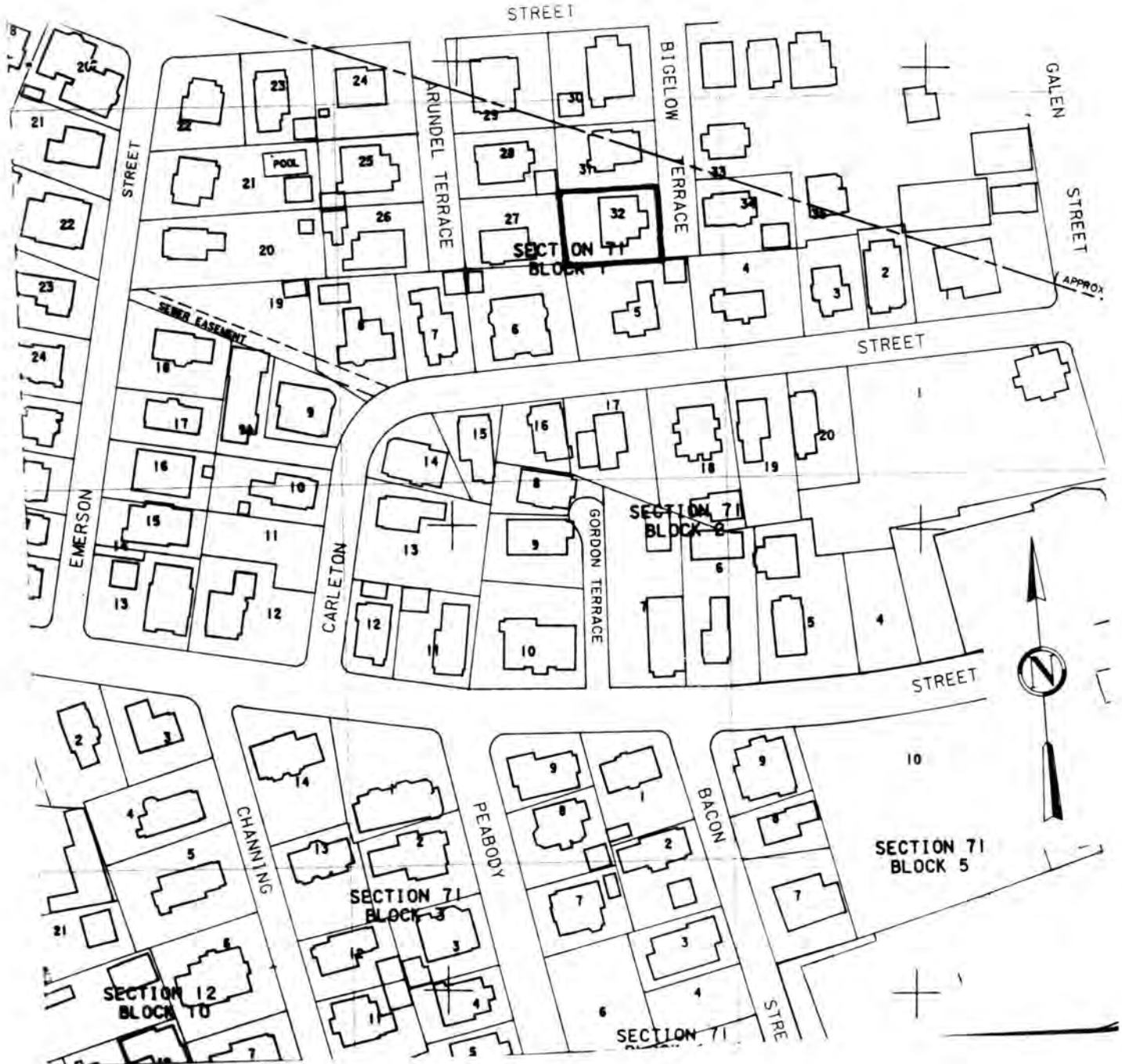

City of Newton Assessor's Maps. Sheet 20  
 Metric Series. 1979  
 Scale: UTM grid line interval = 100 meters (328 feet)

Newton, Mass. M.R.A.  
 15 Bigelow Terrace, Newton Corner  
 Henry Bigelow House  
 71-1-32