

KENTUCKY HISTORIC RESOURCES INVENTORY

Site No. FEB 12 1986

MAR 28 1986

1. Historic Name(s) Corbin Bank Building		22. ADD/County Cumberland Valley	
Original Owner Corbin Bank Company		23. U.S.G.S. Quadrant (15'/75') Corbin	
2. Present Name		24. UTM Reference 16 758520 4092950	
3. Location 101 Centre Street		Zone Easting Northing	
4. Owner's Name Dr. Starr Steele		25. Coordinate Accuracy	
5. Owner's Address 709 West 5th St., Corbin, KY 40701		26. Prehistoric Site Historic Site Building <input checked="" type="checkbox"/>	
6. Open to Public Yes <input checked="" type="checkbox"/> No	7. Visible from road Yes <input checked="" type="checkbox"/> No	8. Ownership Private <input checked="" type="checkbox"/> Local State Federal	
9. Local Contact Organization City of Corbin		27. National Register District Name:	
10. Site Plan with North Arrow		28. Significance Evaluation NR Criteria <input checked="" type="checkbox"/> D	
		11. Architect Unknown	
		12. Builder Unknown	
		13. Date 1902 A <input checked="" type="checkbox"/> B	
		14. Style A. Class. Revival <input checked="" type="checkbox"/> M B.	
		15. Original Use Offices <input checked="" type="checkbox"/> E	
		16. Present use Vacant	
		17. Condition Fair <input checked="" type="checkbox"/> C	
14. Description Two story 4 bay (Centre St.) 4 bay (North Main St.) Office building; brick with stone facade first story on Centre St. side, Limestone sills and lintels second story; brick corbelling in cornice; stone foundation.		29. Status National Landmark National Register Landmark Certificate Kentucky Survey Local Landmark HABS/HAER	
(Continue on Back)		30. Historic Theme Primary Architecture <input checked="" type="checkbox"/> Secondary Commerce Other	
		31. Endangered Yes No	
		32. Preservation Project Status Actual Cost in \$1,000s	
19. History The Corbin Bank Co. was organized and incorporated in October 1901. In less than a year, it built and occupied one of the first brick buildings in Corbin. The first board of directors included Joe Doody, Ike Adair, (cont.)		33. ATTACH PHOTO  Roll No. 2:28,33 Picture No. Direction	
20. Significance The Corbin Bank Building is significant under Criteria A and C. It was the most elaborate building of the era in its craftsmanship of stone and brickwork. It (CONT.)		34. Prepared by: Helen Powell	
21. Source of Information Kentucky Heritage Council from Mrs. Edward Sheils Sandborn Insurance Maps, 1913, 1923		35. Organization Carman & Powell, Inc. 36. Date 1984 37. Revision Dates 38. Staff Review	

19 (cont.)

Dr. E.H. Steele, J.H. Mitchell, R.H. Wigington, W.H. Worsham, Dr. J.F. Wilder, and Oscar Bishop. The present owner has occupied building since 1929.

20 Significance (CONT.)

was important as well as a bank in the period from 1902 to 1929.

FEB 12 1986

KENTUCKY HISTORIC RESOURCE INVENTORY SUPPLEMENT  
BOUNDARY AND LOCATION INFORMATION

Historic Property Name Corbin Bank Building Site # \_\_\_\_\_

Multiple Resource/Thematic Nomination Title MULTIPLE RESOURCES OF CORBIN

U.T.M. Coordinates - List multiple UTMs if property is ten or more acres.

A. \_\_\_\_\_ D. \_\_\_\_\_

B. \_\_\_\_\_ E. \_\_\_\_\_

C. \_\_\_\_\_ F. \_\_\_\_\_

Verbal Boundary Description Acreage .025

From a point in the NE corner of the intersection of E. Centre Street and N. Main Street; then south 47 feet to a point; then east 24 feet to a point; then north 47 feet to a point; then west 24 feet to the point of beginning.

Sketch of Site Plan (Showing outbuildings, structures, landscape features and the site boundary as described above.)

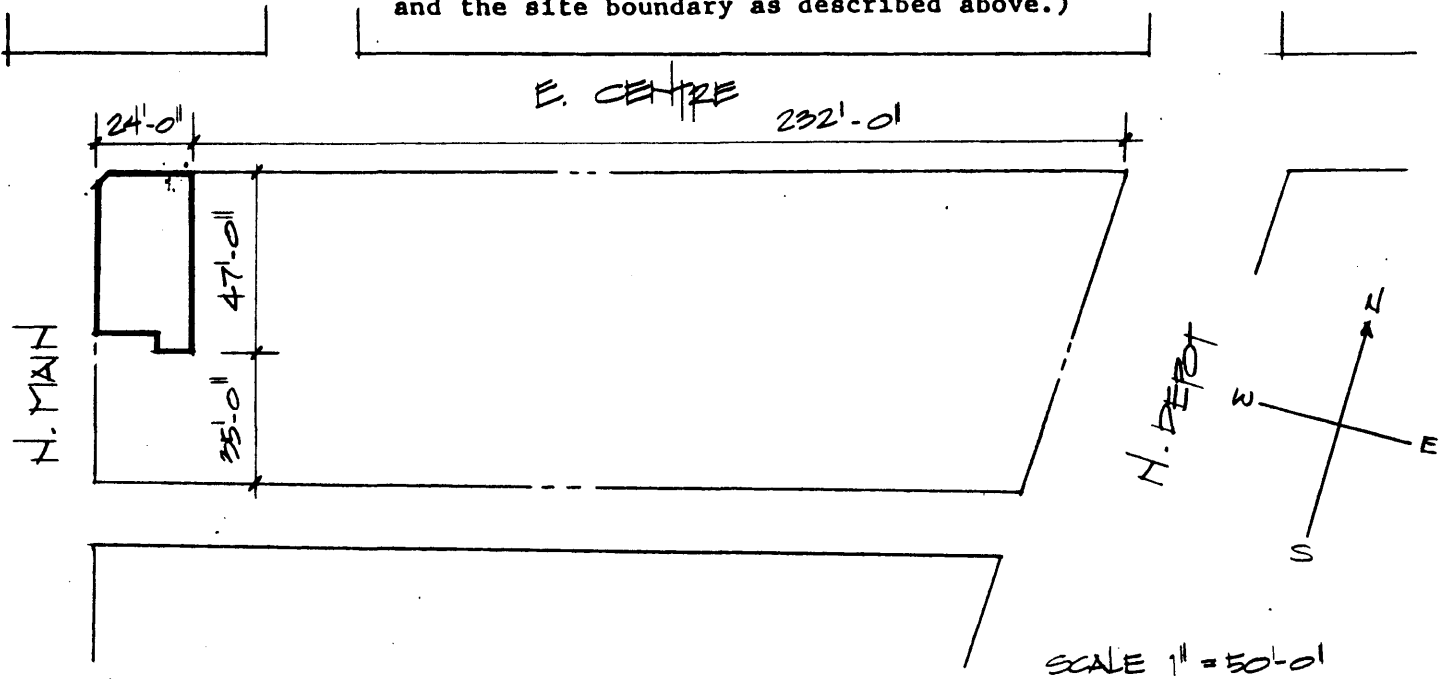

Official Courthouse Property Reference: