



UNITED STATES DEPARTMENT OF THE INTERIOR
NATIONAL PARK SERVICE

NATIONAL REGISTER OF HISTORIC PLACES
PROPERTY PHOTOGRAPH FORM

(Type all entries - attach to or enclose with photograph)

1. NAME		
COMMON	AND/OR HISTORIC	NUMERIC CODE (Assigned by NPS)
First Presbyterian Church		DEC 30 1974
2. LOCATION		
STATE	COUNTY	TOWN
Kentucky	Fayette	Lexington
STREET AND NUMBER		
174 North Mill Street		
3. PHOTO REFERENCE		
PHOTO CREDIT	DATE	NEGATIVE FILED AT
Tom Woods Photography	August 20, 1974	Tom Woods' Photography 838 East High Street Lexington, Kentucky 40502
4. IDENTIFICATION		
DESCRIBE VIEW, DIRECTION, ETC.		

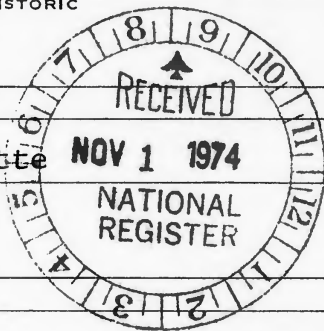

Exterior of church from southwest.

#1 of 6

PROPERTY OF THE NATIONAL REGISTER

Print No. 1



UNITED STATES DEPARTMENT OF THE INTERIOR
NATIONAL PARK SERVICE

NATIONAL REGISTER OF HISTORIC PLACES
PROPERTY PHOTOGRAPH FORM

(Type all entries - attach to or enclose with photograph)

1. NAME

COMMON

AND/OR HISTORIC

NUMERIC CODE (Assigned by NPS)

First Presbyterian Church

DEC 30 1974

2. LOCATION

STATE

COUNTY

TOWN

Kentucky

Fayette

RECEIVED
NOV 1 1974

Lexington

STREET AND NUMBER

174 North Mill Street

3. PHOTO REFERENCE

PHOTO CREDIT

DATE

NEGATIVE FILED AT

Tom Woods Photography

August 20, 1974

Tom Woods Photograph
838 East High Street
Lexington, Ky. 40502

4. IDENTIFICATION

DESCRIBE VIEW, DIRECTION, ETC.

View of east end interior from entrance (lighting fixtures modern).

#2 of 6

PROPERTY OF THE NATIONAL REGISTER

Print No. 2



1
131
482

UNITED STATES DEPARTMENT OF THE INTERIOR
NATIONAL PARK SERVICE

NATIONAL REGISTER OF HISTORIC PLACES
PROPERTY PHOTOGRAPH FORM

(Type all entries - attach to or enclose with photograph)

1. NAME		
COMMON	AND/OR HISTORIC	NUMERIC CODE (Assigned by NPS)
First Presbyterian Church		
2. LOCATION		
STATE	COUNTY	TOWN
Kentucky	Fayette	Lexington
STREET AND NUMBER		
174 North Mill Street		
3. PHOTO REFERENCE		
PHOTO CREDIT	DATE	NEGATIVE FILED AT
Tom Woods Photography	August 20, 1974	Tom Woods Photography 838 East High Street Lexington, Ky. 40502
4. IDENTIFICATION		
DESCRIBE VIEW, DIRECTION, ETC.		

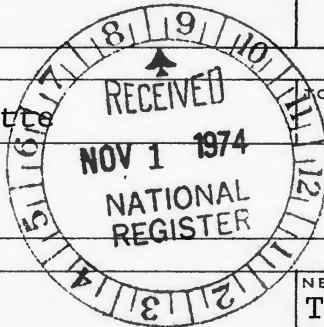

DEC 30 1974

Detail of Sanctuary showing original parapet, altar and five major chairs.

PROPERTY OF THE NATIONAL REGISTER

Print No. 3

#3 of 6



UNITED STATES DEPARTMENT OF THE INTERIOR
NATIONAL PARK SERVICE

NATIONAL REGISTER OF HISTORIC PLACES
PROPERTY PHOTOGRAPH FORM

(Type all entries - attach to or enclose with photograph)

1. NAME

COMMON

AND/OR HISTORIC

NUMERIC CODE (Assigned by NPS)

First Presbyterian Church

DEC 30 1974

2. LOCATION

STATE

COUNTY

TOWN

Kentucky

Fayette

Lexington

STREET AND NUMBER

174 North Mill Street



3. PHOTO REFERENCE

PHOTO CREDIT

DATE

NEGATIVE FILED AT

Tom Woods Photography

August 20, 1974

Tom Woods Photography
838 East High Street

4. IDENTIFICATION

DESCRIBE VIEW, DIRECTION, ETC.

Lexington, Ky. 40502

View of west end interior from Sanctuary, showing gallery with original niche for organ.

#4 of 6

PROPERTY OF THE NATIONAL REGISTER

Print No. 4



UNITED STATES DEPARTMENT OF THE INTERIOR
NATIONAL PARK SERVICE

NATIONAL REGISTER OF HISTORIC PLACES
PROPERTY PHOTOGRAPH FORM

(Type all entries - attach to or enclose with photograph)

1. NAME

COMMON

AND/OR HISTORIC

NUMERIC CODE (Assigned by NPS)

First Presbyterian Church

DEC 30 1974

2. LOCATION

STATE

Kentucky

COUNTY

Fayette

TOWN

Lexington

STREET AND NUMBER

174 North Mill Street



3. PHOTO REFERENCE

PHOTO CREDIT

DATE

NEGATIVE FILED AT

Tom Woods Photography

August 20, 1974

Tom Woods' Photography
838 East High Street

4. IDENTIFICATION

DESCRIBE VIEW, DIRECTION, ETC.

Lexington, Ky. 40502

Northwest corner of gallery, showing original glass, plasterwork, and pews.

PROPERTY OF THE NATIONAL REGISTER

Print No. 5

#5 of 6

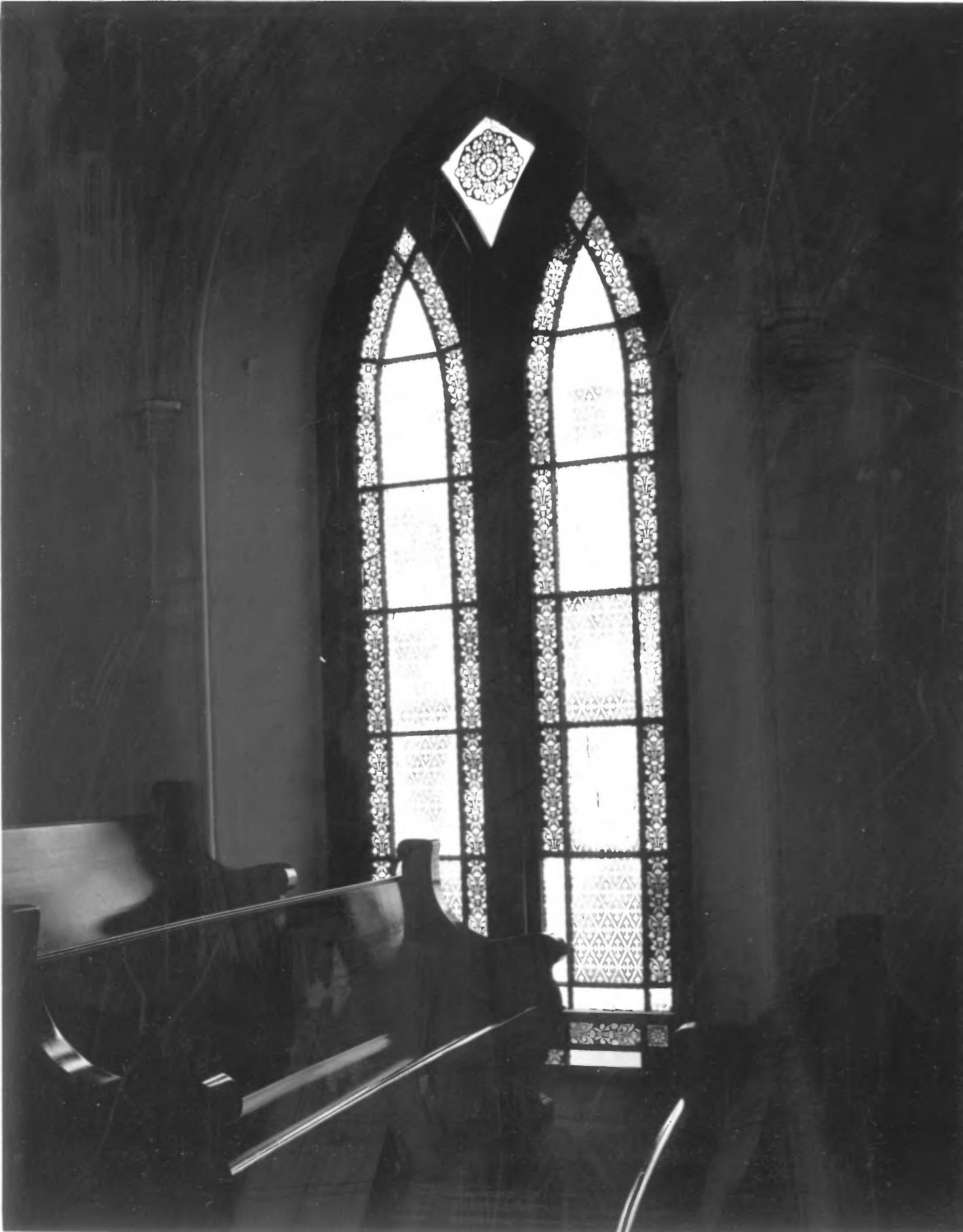

UNITED STATES DEPARTMENT OF THE INTERIOR
NATIONAL PARK SERVICE

NATIONAL REGISTER OF HISTORIC PLACES
PROPERTY PHOTOGRAPH FORM

(Type all entries - attach to or enclose with photograph)

1. NAME

COMMON

AND/OR HISTORIC

NUMERIC CODE (Assigned by NPS)

First Presbyterian Church

DEC 30 1974

2. LOCATION

STATE

COUNTY

TOWN

Kentucky

Fayette

Lexington

STREET AND NUMBER

174 North Mill Street

3. PHOTO REFERENCE

PHOTO CREDIT

DATE

NEGATIVE FILED AT

Tom Woods Photography

August 20, 1974

Tom Woods Photography
838 East High Street
Lexington, Ky. 40502

4. IDENTIFICATION

DESCRIBE VIEW, DIRECTION, ETC.

Original stencilled glass window in gallery.

#6 of 6

PROPERTY OF THE NATIONAL REGISTER

Print No. 6



Fayette County
First Presbyterian Church
Lat: 38° 02' 56"
Long: 84° 29' 48"

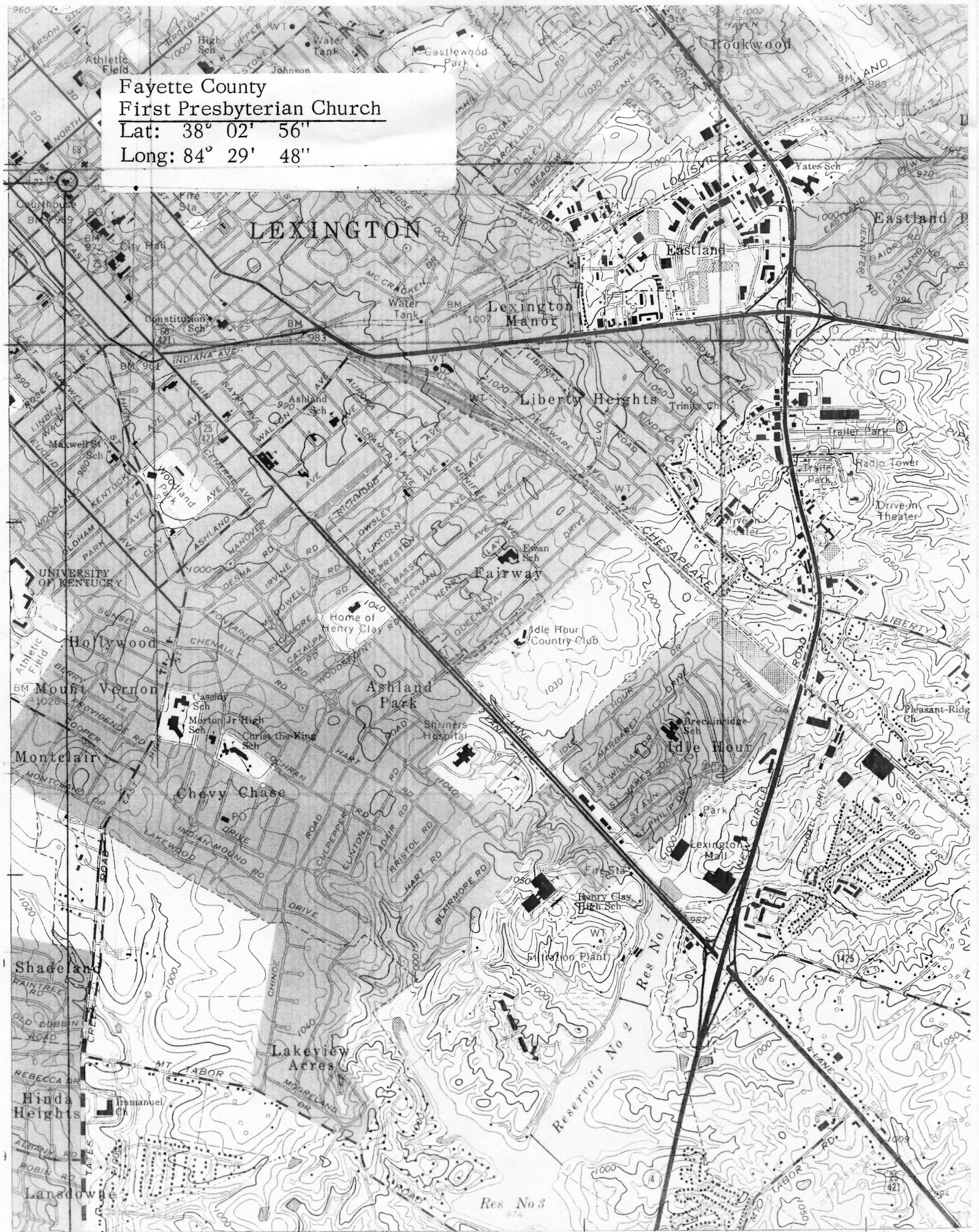

1:930 000 FEET
JONESTOWN 1.4 MI.
271
272
2.7 MI. TO U.S. 27
273 27'30"
1.5 MI. TO KY. 418
CLAYS FERRY 10 MI.