

HISTORIC NAME: Faribault Historic Commercial District

COUNTY: Rice

CURRENT NAME:

CITY/TWP.: Faribault

LEGAL DESC.:

See continuation sheet - page 4

ADDRESS:

Central Avenue between 2nd and 3rd  
Streets

CLASSIFICATION:	CONDITION:	SIGNIFICANCE:	THEME/S:
Building _____	Excellent _____	Local <u>X</u>	Primary <u>Commerce</u>
Structure _____	Good <u>X</u>	State _____	Secondary <u>Architecture</u>
Object _____	Fair _____	National _____	Others _____
District <u>X</u>	Deteriorated _____		

OPEN TO THE PUBLIC: Yes X No \_\_\_\_\_ Restricted XPRESENT USE:  
CommercialVISIBLE FROM THE ROAD: Yes X No \_\_\_\_\_OCCUPIED: Yes X No \_\_\_\_\_

DATE CONSTRUCTED: 1870s - ca.1895

ORIGINAL USE: Commercial

ORIGINAL OWNER: N/A see individual forms

ARCHITECT/BUILDER: see individual forms

OWNER'S NAME AND ADDRESS: Multiple - see attached list

ACREAGE: Less than one acre \_\_\_\_\_  
approx. 4 acresLOCAL CONTACT/ORG.: Rice County Historical Society,  
P.O. Box 5, Faribault, MN 55105UTM REFERENCE:  
Faribault Quad. 7.5

FORM PREPARED BY: Britta Bloomberg

15 / 478610 / 4904230

DATE: April 1981

## DESCRIPTION:

The Faribault Historic Commercial District is a remarkably intact concentration of late nineteenth century commercial buildings constructed between 1870 and 1898 in the heart of Faribault's central business district. The District consists of a one block area of Central Avenue (formerly Main Street) between Second and Third Streets NW. Together, the assemblage of two and three story buildings displays the stylistic variations of "Main Street" commercial architecture during the period the area was developed. Commercial Italianate and Queen Anne are the predominate styles utilized.

Only one building in the District is considered intrusive. Exterior alterations have primarily affected the street level storefronts, and many are easily reversible.

The individual buildings are listed below. The historic name (earliest traceable tenant or the historic name for the building) is stated first, followed by the year of construction, the current name, and a description.

200 Block, west side

#202, Lieb Block, 1882 (now The Money Shop). Two stories; painted brick with seven bay symmetrical facade; windows separated by pilasters featuring arched hoods and keystones; corbelling beneath cornice; bracketted cornice with half round projection carrying name in center bay; original storefront partially intact.

#206, Batchelder and Buckham Building, c.1880 (now Astro Lighting). Three stories; painted brick; three bay symmetrical facade with paired windows in center bay; decorative hoods and cornice; altered storefront and upper sash infill.

#208, Union Block, 1883 (now Mahler's Hardware). Three stories; red brick with highly ornamental surface; decorative treatment including contrasting stone, terra cotta tiles and panels, and patterned brickwork; symmetrical seven bay facade with center bay accentuated by projecting pilasters and triangular pediment; metal cornice; altered storefront.

#214, Cavanaugh and Co. Hardware, Stoves and Tinware, c.1870 (now Star Tailors). Two stories; painted brick; three second story windows with hoods and original sash; cornice with brackets and modillions; altered storefront with metal awning.

(see continuation sheet)

Description - continued

#216-218, Wolf Building, 1878 (now B. & J. Sewing Center and Employment Office). Three stories; buff colored brick with stone sills, hoods, and cornice; two three-bay sections with paired windows and single hood in center bays on both floors; upper stories' windows intact; broken pediment projecting from cornice with date plate and finial; storefront partially intact behind metal awning.

#220, Fred Fleckenstein Men's Furnishing Goods, c.1870 (now Missy'n More and Outlet Store). Two stories; painted brick; two three-bay sections separated by center pilaster strip; arched second story windows with decorative hoods; brackets and modillions at cornice; altered storefront.

#226, Loyhed Block, c.1870 (now Sears). Two stories; painted brick; seven arched second story windows with decorative hoods and stone sills; band of ornamental brickwork above windows; altered storefront and second story window infill.

#230, Masonic Building, 1875/78 (now Poirier Drug). Three stories; recent red brick sheathing obliterating historic surface; windows exposed on first and second floors only.  
INTRUSIVE

200 Block, east side

#201, Kaul Block, c.1898 (now Modern Bar). Two stories; painted brick; eight arched second story windows with brick hoods; textural brickwork in panel around arches; decorative brickwork in parapet; altered storefront.

#205, Mortenson and Wachlin, Harnessmakers, c.1880 (now Fette Electronics). Two stories; red brick; three second story hooded windows with keystones; corbelled cornice; storefront partially intact; design identical to #207.

#207, Carpenter & Smith Tailors and Clothiers, c.1880 (now Thorp Financial Services). Two stories; painted brick; three second story hooded windows with keystones; corbelled cornice; altered storefront and second story sash and infill; design identical to #205.

#209, Felt Confectionery, c.1880 (now B. & J. Fabrics). Two stories; painted brick; three second story rectilinear windows with stone sills and lintels; decorative brick band at cornice; storefront partially intact.

#211, Books and Stationery, c.1880 (now Holiday Cafe). Two stories; painted brick; three bays separated by pilasters; decorative brickwork at cornice; altered storefront.

#213, Stevens & Co. Druggists, c.1880 (now attorneys' offices). Two stories; red brick; three second story windows with continuous stone sill; decorative brickwork at cornice; altered storefront.

#217, Hill Block, 1874 (now The Arcade). Three stories; painted brick; six bays separated into three sections by pilaster strips; hooded second and third story windows, with altered infill on third floor; elaborate cornice with brackets and modillions; storefront partially intact.

#219, Post Block, c.1874 (now Jandro Office Machines). Three stories; buff colored brick; three bays with hooded second and third story windows; altered infill in upper arched portion; decorative cornice with corner brackets and modillions; storefront partially intact.

(see continuation sheet)

Description - page 3

#221-223, Kinsey Dry Goods and Pike and Monroe Tailors, c.1870 (now Dusek's Bakery and Dentist's office). Two stories; painted brick; two three-bay sections with hooded second story windows; brackets and modillions at cornice; north storefront basically intact; south storefront altered.

#225, C.E. Smith Books and Stationery, c.1870 (now H & R Block Income Tax Service). Two stories; painted brick; three second story hooded windows; cornice removed; storefront partially intact beneath awning.

#227, Dandeleet Dry Goods, c.1882 (now Dandeleet Jewelry). Two stories; red brick with stone sills and lintels; three bays; corbelled cornice; altered storefront.

#229, Citizen's National Bank Building, c.1890 (now Hour Glass Cleaners). Two stories; red brick with stone trim sills, lintels, and rusticated water table; two bays on Central by eight bays on Third Street with angled corner entry rectilinear second floor windows separated by paired pilasters; first floor windows set in wide arches with keystones; storefront basically intact with large signs covering arches on windows flanking entry.

The continuity and integrity of the 200 block distinguishes it from the adjacent areas of Central Avenue in the downtown area.

SIGNIFICANCE:

The Faribault Historic Commercial District is significant as a remarkably well-preserved concentration of late nineteenth century commercial buildings located in a regionally important center of trade and commerce. All of the buildings in the District were constructed between 1870 and 1900 and provide a visible link to Faribault's period of greatest commercial development and economic independence. Faribault's strategic location between several major nineteenth century cities in southern Minnesota contributed greatly to its commercial and industrial growth and gained for it a reputation as a regionally important trade and manufacturing center. As the railroad links to Minneapolis and St. Paul, Owatonna, Albert Lea, Mankato, and Red Wing were completed during the mid to late nineteenth century, Faribault's economy flourished. A four block business district grew up along Central Avenue to support the commercial needs of the growing population; the 200 block of Central Avenue is the best preserved segment of the business district that developed. Here were located businesses that span the wide range of nineteenth century commercial establishments: hardware stores, drug stores, books and stationery stores, men and women's clothing stores, dry goods stores, a harness shop, and confectioneries, as well as office facilities for area professionals on the second and third floors of the buildings. Here also were halls for some of Faribault's societies, including the Masons and the Faribault Scandinavian Harmonia Society. The survival quality of the block as a whole makes it possible to observe the variations of popular designs in commercial buildings during the late nineteenth century in both the modest two story structures and the large commercial blocks. As an area distinguished for its continuity in period, materials, design, and integrity and for its continued utilization by small individual commercial establishments, the Faribault Historic Commercial District is an important link to Faribault's commercial development.

Legal Description:

Part of Blocks 56 and 57, Original Town of Faribault, described as follows. Begin at the northeast corner of lot 6, block 56; commence Sly to the southeast corner of lot 8, block 56; thence Wly 49 ft.; thence Sly 132 ft.; thence Wly 100 ft. to southwest corner of block 56; continue Wly across Central Avenue to southeast corner of block 57; thence Wly 130 ft.; thence Nly 66 ft.; thence Wly 19 ft.; thence Nly 220 ft.; thence Ely 22 ft.; thence Nly 44 ft.; thence Ely 127 ft. to northeast corner of lot 5, block 57; continue Ely across Central Avenue to northwest corner of block 56 and thence Ely 149 ft. to point of beginning.

Bibliography:

Faribault Republican

Polk and Co.'s Rice County Directory 1907-08, St. Paul: 1908.

Minnesota Historical Society Photo Collection, Audio-Visual Department, St. Paul.

Sanborn Insurance Company maps, 1884, 1889, 1893, 1899, 1903, 1905, 1914, 1921, 1930.

Faribault Historic Commercial District: Ownership List

Rice County  
Faribault, MN

230 Central Masonic Block	Masonic Building Association 7A NW 3rd Street Faribault, MN 55021
226 Central Loyhed Block	Joseph Bachrach 858 SW 8th Street Faribault, MN 55021
220 Central Fred Fleckenstein Mens Furnishings Goods	Darrel Smith Rt. 3 Northfield, MN 55057
216 Central Wolf Building	Darrell D. Jensen RR 5 Faribault, MN 55021
214 Central Cavanaugh & Co. Hardware	Rodney A. Mahler 826 SW 10th Avenue Faribault, MN 55021
208 Central Union Block	Rodney A. Mahler 826 SW 10th Avenue Faribault, MN 55021
206 Central Batchelder & Buckham Building	Clarence H. Kennelly 4356 Sandstone Drive Eagan, MN 55122
202 Central Lieb Block	Gary Sander 1734 Logan Avenue South Minneapolis, MN 55403
229 Central Citizens National Bank Buiding	B.C. Burdick 426 Lake Street Excelsior, MN 55331
227 Central Dandelet Dry Goods	Elizabeth Dandelet c/o Dandelet Jewelry 227 Central Faribault, MN 55021
225 Central Smith Books and Stationery	Mae J. Huber 625 SW 4th Avenue Faribault, MN 55021
221 Central Kinsey Dry Goods and Pilce and Monroe Tailors	Lawrence W. Becker Rt. 5, Box 91 Faribault, MN 55021
219 Central Post Block	John N. & Joan W. Petroff 219 Central Avenue Faribault, MN 55021

Faribault Historic Commercial District: Ownership List - page 2  
Rice County; Faribault, MN

217 Central Hill Block	Thomas A. Winkley 15 Mitchell Drive Faribault, MN 55021
213 Central Stevens & Co. Druggists	Edward J. Duffney 213 Central Faribault, MN 55021
211 Central Books & Stationery	Howard E. Walter 327 SW 8th Avenue Faribault, MN 55021
209 Central Felt Confectionery	John Dudley Box 836 Faribault, MN 55021
207 Central Carpenter & Smith Tailors & Clothiers	Richard F. Fette c/o Fette Electronics 205 Central Faribault, MN 55021
205 Central Mortenson & Wachlin Harness Shop	Richard F. Fette c/o Fette Electronics 205 Central Faribault, MN 55021
201 Central Kaul Block	Mike G. Koutavus RR 2 Faribault, MN 55021

# FARIBAULT HISTORIC COMMERCIAL DISTRICT

← Third Street NW →

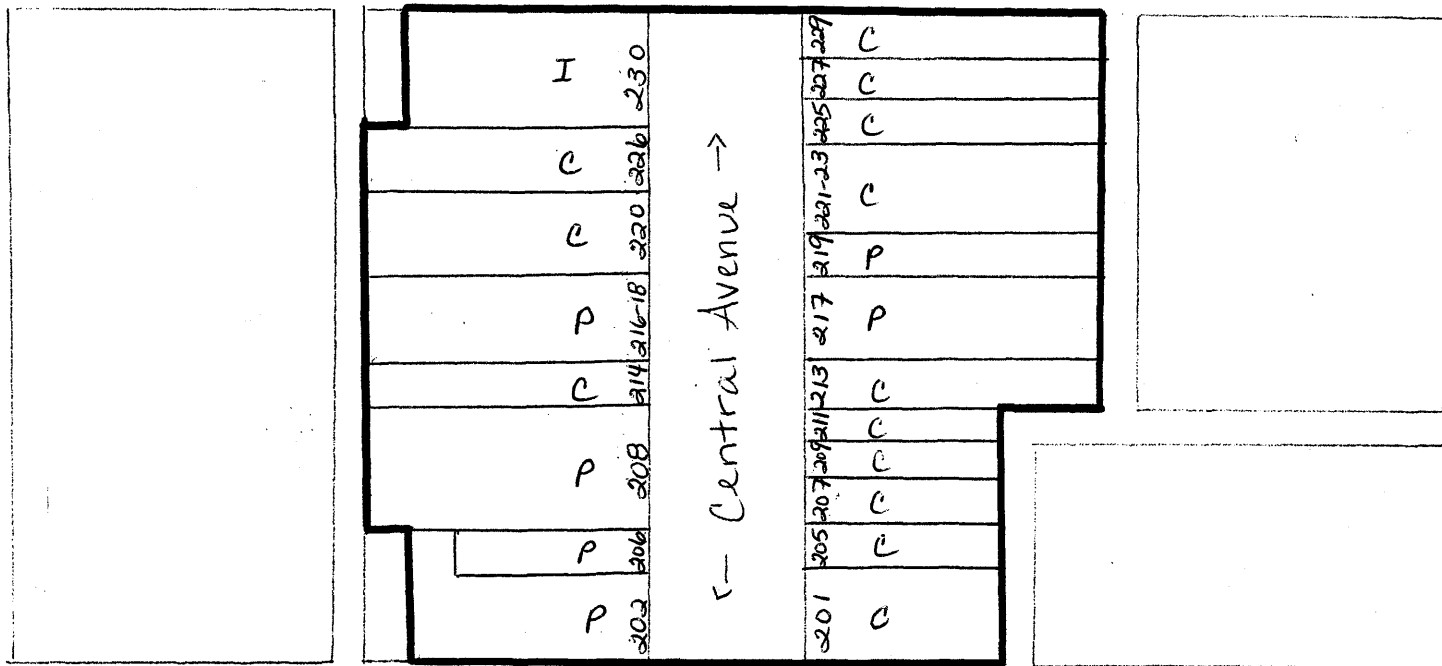

← Second Street NW →

Key:

- District Boundaries
- P Pivotal
- C Contributing
- I Intrusive

