

1655

United States Department of the Interior
National Park Service

SEP 15 1989

National Register of Historic Places
Registration Form

NATIONAL
REGISTER

34

This form is for use in nominating or requesting determinations of eligibility for individual properties or districts. See instructions in *Guidelines for Completing National Register Forms* (National Register Bulletin 16). Complete each item by marking "x" in the appropriate box or by entering the requested information. If an item does not apply to the property being documented, enter "N/A" for "not applicable." For functions, styles, materials, and areas of significance, enter only the categories and subcategories listed in the instructions. For additional space use continuation sheets (Form 10-900a). Type all entries.

1. Name of Property

historic name Charles A. Lindbergh State Park WPA/Rustic Style Historic Resources
other names/site number Charles A. Lindbergh State Park

2. Location

street & number off County Highway 52 not for publication N/A
city, town Pike Creek Township Little Falls vicinity
state Minnesota code MN county Morrison code 097 zip code 56345

3. Classification

Ownership of Property	Category of Property	Number of Resources within Property	
		Contributing	Noncontributing
<input type="checkbox"/> private	<input type="checkbox"/> building(s)	<u>2</u>	<u> </u> buildings
<input type="checkbox"/> public-local	<input checked="" type="checkbox"/> district	<u> </u>	<u> </u> sites
<input checked="" type="checkbox"/> public-State	<input type="checkbox"/> site	<u>2</u>	<u> </u> structures
<input type="checkbox"/> public-Federal	<input type="checkbox"/> structure	<u>2</u>	<u> </u> objects
	<input type="checkbox"/> object	<u>6</u>	<u>0</u> Total

Name of related multiple property listing:
Minnesota State Park CCC/WPA/Rustic Style
Historic Resources

Number of contributing resources previously
listed in the National Register 0

4. State/Federal Agency Certification

As the designated authority under the National Historic Preservation Act of 1966, as amended, I hereby certify that this nomination request for determination of eligibility meets the documentation standards for registering properties in the National Register of Historic Places and meets the procedural and professional requirements set forth in 36 CFR Part 60. In my opinion, the property meets does not meet the National Register criteria. See continuation sheet.

Nina M. Archabal 9/15/89
Signature of certifying official Nina M. Archabal Date
State Historic Preservation Officer
State or Federal agency and bureau Minnesota Historical Society

In my opinion, the property meets does not meet the National Register criteria. See continuation sheet.

Signature of commenting or other official _____ Date _____
State or Federal agency and bureau _____

5. National Park Service Certification

I, hereby, certify that this property is:

- entered in the National Register.
 See continuation sheet.
- determined eligible for the National Register. See continuation sheet.
- determined not eligible for the National Register.
- removed from the National Register.
- other, (explain:)

Shelores Byers 10/25/89
Signature of the Keeper Date of Action

Signature of the Keeper

Date of Action

6. Function or Use

Historic Functions (enter categories from instructions)

Recreation/Outdoor Recreation
Landscape/State Park

Current Functions (enter categories from instructions)

Recreation/Outdoor Recreation
Landscape/State Park

7. Description

Architectural Classification

(enter categories from instructions)

Other: NPS Rustic Architecture

Materials (enter categories from instructions)

foundation Stone
walls Stone/Log

roof Shingle
other _____

Describe present and historic physical appearance.

See Continuation Sheets

United States Department of the Interior
National Park ServiceNational Register of Historic Places
Continuation SheetSection number 7 Page 1DESCRIPTION

Charles A. Lindbergh State Park WPA/Rustic Style Historic Resources include 2 buildings, 2 objects, and 2 structures which are nominated as an historic district. The historic district consists of a small concentrated use area representing the sole development during the period of significance. Architects for the park project were from both the National Park Service Central Design Office and the Design Office within the Minnesota Division of State Parks.

1. Building: Picnic Shelter 3-105 Builder: WPA
Architect: H. Nielsen & L. Taylor Date: 1938

The Picnic Shelter is a T-shaped structure constructed with peeled logs with saddle-notched corners resting on a stone faced concrete foundation. The main area of the shelter is 44' by 24' with a 12' by 16' projection to the rear for the kitchen. Both sections are covered with intersecting gable roofs. The main entrance features an 8' by 16' porch with a projecting shed roof supported by log posts.

The interior features a massive stone fireplace with a 4'0" by 2'6" opening which separates the shelter area from the kitchen. The kitchen still retains four original cast iron wood cook stoves and the original sink.

Although the building was constructed in 1938, doors and eight light casement windows were not installed until 1939. At that time a refectory (concession) was added in the main section of the shelter. This 14' by 7' addition included a 9' counter and was constructed with log cabin siding with a 7" exposure.

The design of this building was repeated at Lake Bemidji State Park

2. Structure: Water Tower 3-106 Builder: WPA
Architect: Agnich & O. Newstrom Date: 1938

The main section of the Water Tower is formed by a 16' square which rises 37'6" from the base to the peak of the hip roof. The lower section is constructed with native stone rising 23'6" with a 6" batter. Four

United States Department of the Interior
National Park ServiceNational Register of Historic Places
Continuation SheetSection number 7 Page 2

openings, each 12" by 9" are placed within the stonework on each of the tower's facades. The next 10 feet are constructed with 10" half logs laid horizontally. Three rectangular louvered openings are placed on each of the four sides of this upper section. The hip roof rises an additional 4 feet above the log faced section which conceals the 5,000 gallon steel water tank.

A one story 12' by 12' projection is also constructed with native stone and is topped with a gable roof. The south elevation contains a massive stone lintel above three six light casement windows.

The tower's entrance door is constructed with wooden planks and steel strap hinges.

3. Building: Latrine 3-108 Builder: WPA
Architect: L. Taylor Date: 1939

The rectangular Latrine building is constructed with peeled logs with saddle-notched corners resting on a stone faced foundation. Plank entrance doors are located on each end. One small casement window is located on each end wall and two are found on each of the side facades.

The dimensions of the building are 26' x 11' but the horizontal logs on the principal facade originally extended an additional eight feet on each side in order to provide entrance screens. With the screens intact, the building was 42' long.

During a 1963 remodeling the projecting log ends and purlins were cut, trimmed or replaced. The log screens were apparently removed at that time as well and the original wooden shingles were replaced with asphalt.

4. Object: Drinking Fountains Builder: WPA
Architect: N. Averill Date: 1938

Two stone Drinking Fountains are located adjacent to the Picnic Shelter. Both fountains rest on 10'3" by 10'3" platforms constructed with native stone flagging. The fountains are 2'5" by 2'5" at the base and rise 3'0" with a slight batter. A faucet is located at the side while the bubbler is placed on the top of the fountain. A 1'6" by 1'0" step is also placed on one side to allow children to reach the fountain.

United States Department of the Interior
National Park Service

**National Register of Historic Places
Continuation Sheet**

Section number 7 Page 3

5. Structure: Retaining Wall Builder: WPA
 Architect: Unknown Date: c1938

A long stone retaining wall is located on the east bank of Pike Creek and to the west of the public use area of the park. Resembling riprapping, the stonework is laid without mortar and is now quite overgrown.

8. Statement of Significance

Certifying official has considered the significance of this property in relation to other properties:

nationally statewide locally

Applicable National Register Criteria A B C D

Criteria Considerations (Exceptions) A B C D E F G

Areas of Significance (enter categories from instructions)

Architecture
Recreation
Government

Period of Significance

1938-39

Significant Dates

1938

Cultural Affiliation

N/A

Significant Person

N/A

Architect/Builder

National Park Service
State of Minnesota
WPA

State significance of property, and justify criteria, criteria considerations, and areas and periods of significance noted above.

See Continuation Sheets

United States Department of the Interior
National Park Service

National Register of Historic Places Continuation Sheet

Section number 8 Page 1

STATEMENT OF SIGNIFICANCE

Charles A. Lindbergh State Park WPA/Rustic Style Historic Resources are historically significant for their association with the with the social, political, and economic impact of the Great Depression and the subsequent development of the various Federal Relief Programs, namely the Works Progress Administration, which was responsible for their construction. These buildings are also historically significant for their association with the development of the Minnesota State Park System. The park is the only example in the state park system of a recreational facility which was constructed at a site which includes the home of a well known individual. The Charles A. Lindbergh WPA/Rustic Style Historic Resources are architecturally significant as outstanding examples of rustic style log and stone design which have remained remarkably unchanged since construction. These buildings are characterized by nonintrusive and environmentally sensitive designs based on National Park Service design philosophy and master planning.

The park was established in 1931 when 110 acres were donated to the state in memory of Charles A. Lindbergh, Sr. by his family. Lindbergh was a progressive Republican Congressman who represented central Minnesota from 1907 to 1917 and was an unsuccessful candidate for governor in 1918 with the support of the Nonpartisan League, one of the forerunners of the Farmer Labor Party. Charles A. Lindbergh, Jr., world renowned for his trans-Atlantic solo flight in 1927, ran the family farm from 1918 to 1920 on land that would eventually become the state park.

When W.P.A. projects were being contemplated for the park, the Lindbergh family requested that development be kept to a minimum. As a result, intensive use areas for swimming or camping were not constructed. W.P.A. workers also restored furniture at the Lindbergh home in addition to park construction. The Lindbergh home is a National Historic Landmark.

9. Major Bibliographical References

Brookins, Jean A. and Homquist, June D. Minnesota's Major Historic Sites. St. Paul: Minnesota Historical Society, rev. ed., 1972.
Department of Natural Resources. Working Drawings and Specifications for Structures at Charles A. Lindbergh State Park. Bureau of Engineering. St. Paul, Minnesota.
Fridley, Russell W. "Lindbergh State Park." Conservation Volunteer. Sept.-Oct., 1957.
State of Minnesota. Lindbergh State Park Management Plan. St. Paul: Department of Natural Resources, 1981.

See continuation sheet

Previous documentation on file (NPS):

- preliminary determination of individual listing (36 CFR 67) has been requested
- previously listed in the National Register
- previously determined eligible by the National Register
- designated a National Historic Landmark
- recorded by Historic American Buildings Survey # _____
- recorded by Historic American Engineering Record # _____

Primary location of additional data:

- State historic preservation office
- Other State agency
- Federal agency
- Local government
- University
- Other

Specify repository: _____

10. Geographical Data

Acreeage of property 9 Acres

UTM References

A 15 392300 5090040
 Zone Easting Northing

C _____

B _____
 Zone Easting Northing

D _____

See continuation sheet

Verbal Boundary Description

The boundary for Charles A. Lindbergh State Park WPA/Rustic Style Resources is shown as the heavy line on the accompanying map entitled Charles A. Lindbergh State Park. It is defined by County Highway 52 to the east, Pike Creek to the west, the northern edge of the parking lot to the north, and a line 300 feet to the south of the latrine to the south. The line is crosshatched.

See continuation sheet

Boundary Justification

The boundary includes the buildings and structures that have been historically associated with the property and that maintain historic integrity. The boundary includes the concentrated use area of the park developed by the WPA.

See continuation sheet

11. Form Prepared By

name/title Rolf T. Anderson
 organization N/A date September 9, 1988
 street & number 3632 Park Avenue South telephone 612-824-7807
 city or town Minneapolis state Minnesota zip code 55407

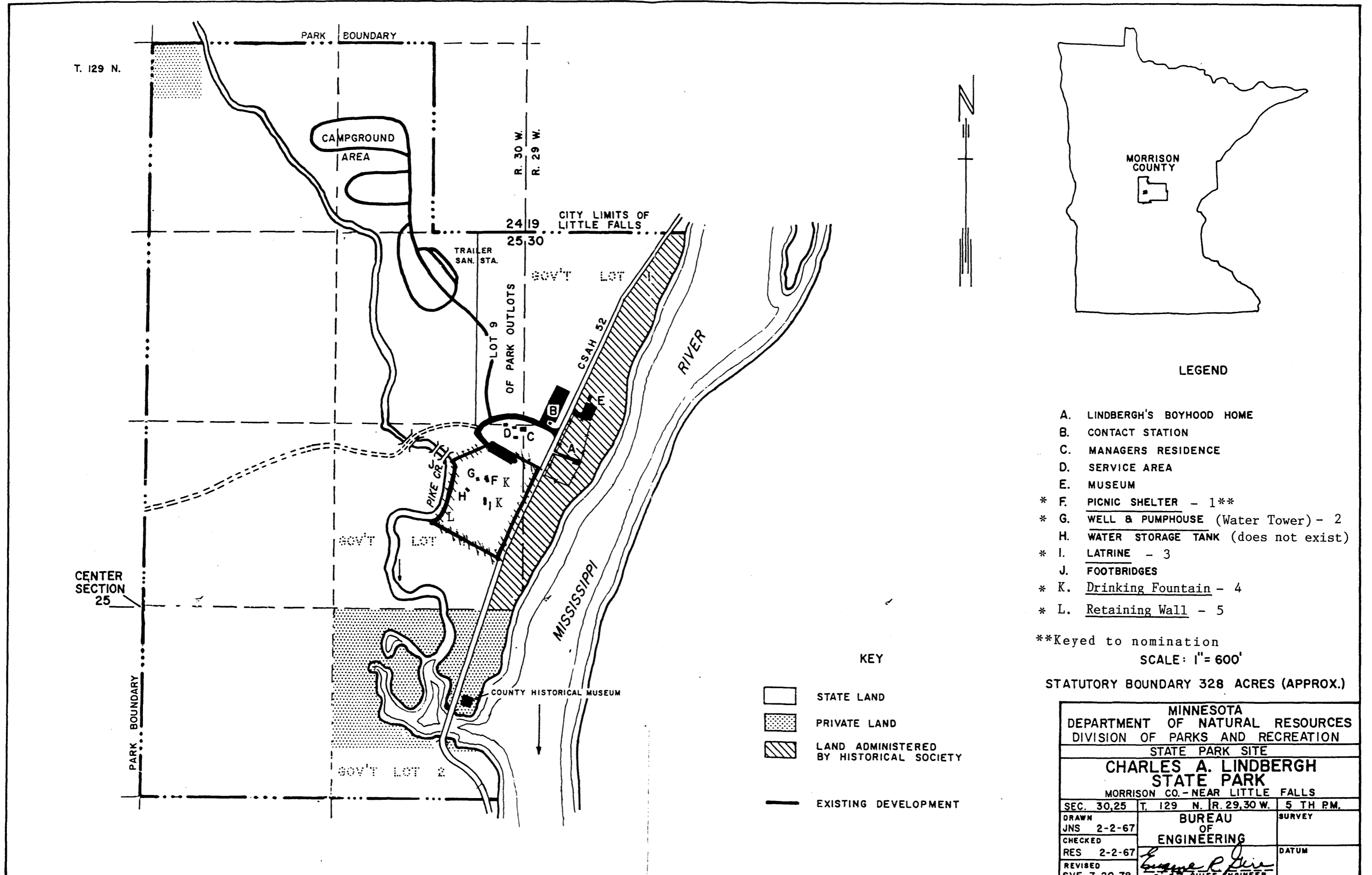

LEGEND

- A. LINDBERGH'S BOYHOOD HOME
- B. CONTACT STATION
- C. MANAGERS RESIDENCE
- D. SERVICE AREA
- E. MUSEUM
- * F. PICNIC SHELTER - 1**
- * G. WELL & PUMPHOUSE (Water Tower) - 2
- H. WATER STORAGE TANK (does not exist)
- * I. LATRINE - 3
- J. FOOTBRIDGES
- * K. Drinking Fountain - 4
- * L. Retaining Wall - 5

**Keyed to nomination
 SCALE: 1" = 600'
 STATUTORY BOUNDARY 328 ACRES (APPROX.)

KEY

- STATE LAND
- PRIVATE LAND
- LAND ADMINISTERED BY HISTORICAL SOCIETY
- EXISTING DEVELOPMENT

MINNESOTA DEPARTMENT OF NATURAL RESOURCES DIVISION OF PARKS AND RECREATION		
STATE PARK SITE		
CHARLES A. LINDBERGH STATE PARK		
MORRISON CO. - NEAR LITTLE FALLS		
SEC. 30,25	T. 129 N. R. 29,30 W.	5 TH P.M.
DRAWN JNS 2-2-67	BUREAU OF ENGINEERING	
CHECKED RES 2-2-67	DATUM	
REVISED SVF 7-20-78	<i>James R. Gier</i> CHIEF ENGINEER	