

962

NPS Form 10-900
(Rev. 10-90)

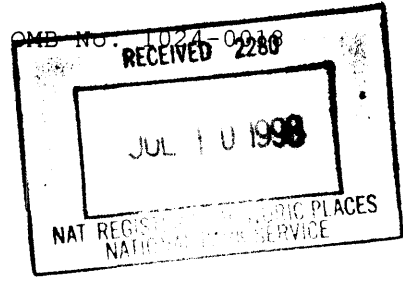

United States Department of the Interior
National Park Service

NATIONAL REGISTER OF HISTORIC PLACES
REGISTRATION FORM

This form is for use in nominating or requesting determinations for individual properties and districts. See instructions in How to Complete the National Register of Historic Places Registration Form (National Register Bulletin 16A). Complete each item by marking "x" in the appropriate box or by entering the information requested. If any item does not apply to the property being documented, enter "N/A" for "not applicable." For functions, architectural classification, materials, and areas of significance, enter only categories and subcategories from the instructions. Place additional entries and narrative items on continuation sheets (NPS Form 10-900a). Use a typewriter, word processor, or computer, to complete all items.

1. Name of Property

historic name House at 1233 Wentworth Avenue

other names/site number _____

2. Location

street & number 1233 Wentworth Avenue not for publication N/A
city or town Pasadena vicinity N/A
state California code CA county Los Angeles code 037
zip code 91106

3. State/Federal Agency Certification

As the designated authority under the National Historic Preservation Act of 1986, as amended, I hereby certify that this x nomination _____ request for determination of eligibility meets the documentation standards for registering properties in the National Register of Historic Places and meets the procedural and professional requirements set forth in 36 CFR Part 60. In my opinion, the property X meets _____ does not meet the National Register Criteria. I recommend that this property be considered significant _____ nationally _____ statewide X locally. (_____ See continuation sheet for additional comments.)

[Signature]
Signature of certifying official

June 23, 1998
Date

State Historic Preservation Officer
State or Federal agency and bureau

USDI/NPS NRHP Registration Form
House at 1233 Wentworth Ave.
Los Angeles County, CA

The Residential Architecture of Pasadena, CA, 1895-1918:
The Influence of the Arts and Crafts Movement

(Page 2)

In my opinion, the property _____ meets _____ does not meet the National Register criteria. (_____ See continuation sheet for additional comments.)

Signature of commenting or other official _____ Date _____

State or Federal agency and bureau _____

=====

4. National Park Service Certification

=====

I, _____ hereby certify that this property is _____

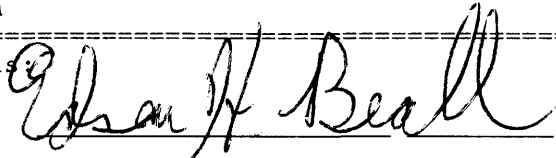

- entered in the National Register _____
_____ See continuation sheet.
determined eligible for the National Register _____
- See continuation sheet.
determined not eligible for the National Register _____
- removed from the National Register _____
- other (explain): _____

 _____ Date 9-6-96
Signature of Keeper of Action

=====

5. Classification

=====

Ownership of Property (Check as many boxes as apply)

- private
- public-local
- public-State
- public-Federal

Category of Property (Check only one box)

- building(s)
- district
- site
- structure
- object

Number of Resources within Property

Contributing	Noncontributing
<u>2</u>	_____ buildings
_____	_____ sites
<u>1</u>	<u>1</u> structures
_____	_____ objects
<u>3</u>	<u>1</u> Total

Number of contributing resources previously listed in the National Register N/A

Name of related multiple property listing: The Residential Architecture of Pasadena, CA, 1895-1918: The Influence of the Arts and Crafts Movement

8. Statement of Significance

Applicable National Register Criteria (Mark "x" in one or more boxes for the criteria qualifying the property for National Register listing)

- A Property is associated with events that have made a significant contribution to the broad patterns of our history.
- B Property is associated with the lives of persons significant in our past.
- C Property embodies the distinctive characteristics of a type, period, or method of construction or represents the work of a master, or possesses high artistic values, or represents a significant and distinguishable entity whose components lack individual distinction.
- D Property has yielded, or is likely to yield information important in prehistory or history.

Criteria Considerations (Mark "X" in all the boxes that apply.)

- A owned by a religious institution or used for religious purposes.
- B removed from its original location.
- C a birthplace or a grave.
- D a cemetery.
- E a reconstructed building, object, or structure.
- F a commemorative property.
- G less than 50 years of age or achieved significance within the past 50 years.

Areas of Significance (Enter categories from instructions)

Architecture

Period of Significance 1917

Significant Dates 1917

Significant Person (Complete if Criterion B is marked above)
N/A

Cultural Affiliation N/A

Architect/Builder Heineman, Alfred S.

Narrative Statement of Significance (Explain the significance of the property on one or more continuation sheets.)

=====
9. Major Bibliographical References
=====

(Cite the books, articles, and other sources used in preparing this form on one or more continuation sheets.)

Previous documentation on file (NPS)

- preliminary determination of individual listing (36 CFR 67) has been requested.
- previously listed in the National Register
- previously determined eligible by the National Register
- designated a National Historic Landmark
- recorded by Historic American Buildings Survey # _____
- recorded by Historic American Engineering Record # _____

Primary Location of Additional Data

- State Historic Preservation Office
- Other State agency
- Federal agency
- Local government
- University
- Other

Name of repository: City of Pasadena, Design and Historic Preservation

=====
10. Geographical Data
=====

Acreage of Property less than 1 acre

UTM References (Place additional UTM references on a continuation sheet)

	Zone	Easting	Northing	Zone	Easting	Northing	
1	0X	399300	3776565	3	11	395520	3776565
2	___	___	___	4	___	___	___

___ See continuation sheet.

Verbal Boundary Description (Describe the boundaries of the property on a continuation sheet.)

Boundary Justification (Explain why the boundaries were selected on a continuation sheet.)

USDI/NPS NRHP Registration Form
House at 1233 Wentworth Ave.
Los Angeles County, CA

The Residential Architecture of Pasadena, CA, 1895-1918:
The Influence of the Arts and Crafts Movement

(Page 6)

=====
11. Form Prepared By
=====

name/title Lauren Bricker, Ph.D., Robert Winter, Ph.D., & Janet Tearnen, M.A.

organization City of Pasadena date February 27, 1998

street & number 175 N. Garfield Avenue telephone 626-744-4228

city or town Pasadena state CA zip code 91109
=====

Additional Documentation
=====

Submit the following items with the completed form:

Continuation Sheets

Maps

A USGS map (7.5 or 15 minute series) indicating the property's location.

A sketch map for historic districts and properties having large acreage
or numerous resources.

Photographs

Representative black and white photographs of the property.

Additional items (Check with the SHPO or FPO for any additional items)

=====
Property Owner
=====

(Complete this item at the request of the SHPO or FPO.)

name Edla and William Scharre, Jr.

street & number 1233 Wentworth Avenue telephone _____

city or town Pasadena state CA zip code 91106
=====

Paperwork Reduction Act Statement: This information is being collected for applications to the National Register of Historic Places to nominate properties for listing or determine eligibility for listing, to list properties, and to amend existing listings. Response to this request is required to obtain a benefit in accordance with the National Historic Preservation Act, as amended (16 U.S.C. 470 et seq.).

Estimated Burden Statement: Public reporting burden for this form is estimated to average 18.1 hours per response including the time for reviewing instructions, gathering and maintaining data, and completing and reviewing the form. Direct comments regarding this burden estimate or any aspect of this form to the Chief, Administrative Services Division, National Park Service, P.O. Box 37127, Washington, DC 20013-7127; and the Office of Management and Budget, Paperwork Reductions Project (1024-0018), Washington, DC 20503.

United States Department of the Interior
National Park Service

NATIONAL REGISTER OF HISTORIC PLACES
CONTINUATION SHEET

Section 7 Page 1

House at 1233 Wentworth Ave.
name of property
Los Angeles County, CA.
county and State
The Residential Architecture of Pasadena,
CA, 1895-1918: The Influence of the Arts
and Crafts Movement
name of multiple property listing

=====
Description

This one- and one-half story bungalow is located on the west side of Wentworth Avenue, two lots north of Pinehurst Drive, within the Oak Knoll subdivision. The dwelling has a deep front yard set-back covered by a grass lawn. A meandering driveway follows the northern property line, concluding at the northwest corner of the property in a wide turn-around access to the historic two-bay automotive garage. Between the garage and house is an historic gazebo, whose three lattice walls are framed by turned wooden columns and a roof of wooden rafters. The garage and gazebo are contributing secondary structures. A non-contributing swimming pool, introduced to the site in 1954, occupies most of the southwest corner of the garden. A concrete block wall located between the house and the garage was added in 1952. Large mature deciduous trees effectively screen the northern edge of the property; a mixture of deciduous and palm trees defines the southern line of the property. A single mature palm tree is planted within the recessed area formed by the two wings projecting from the western facade. The house's foundation planting consists of clipped hedges and exotic flowering plants. The residence, garage, and gazebo have had very little alteration since their construction, and the property retains integrity.

The structure of the house consists of a concrete foundation, hollow tile first story and a wood stud frame partial second story. The dwelling has an irregular shaped plan with extensions projecting from three corners of the central volume. Additionally, a wide and deep front porch with a partial conical roof wraps around the northeast corner of the house, merging with the northern roof plane of the house into a porte-cochere. Stylistically, the dwelling and garage exemplify a California interpretation of the English Cotswold cottage. This architectural imagery is conveyed through the low-lying horizontal form of the dwelling and garage whose arcing and hipped roof planes with rolled eaves are wrapped with wooden shingles. These shingles replace the highly authentic use of thatch that originally covered the roof (by 1928). The gravity-bound quality of the house is further emphasized by the massive entrance porch whose weight is borne by squat brick piers and blocky wooden supports. Other elements contributing to the architectural character of the house are the decorative barge board pattern of the entrance porch, and the use of half-timbering (or black and white work) within the arched gable end of the porch and beneath the soffitt of the octagonal bay windows projecting from the east (front) and south elevations of the second story. Two brick chimneys are visible from the street; the southern and more prominent stack is ornamented by decorative tiles. The paneled entrance door flanked by leaded glass windows is sheltered beneath the porch. Secondary access to the house is provided from recessed porches located within the northern and western facades. A bow window lit by a row of casement windows with transoms is located north of the principal entrance; this is visually balanced on the street facade by a three-part window with a large central pane of glass flanked by casement windows. A variety of window types are used throughout the house. The first story is sheathed in stucco; wooden shingles clad the second story. The only notable exterior alteration is the enclosure of

United States Department of the Interior
National Park Service

NATIONAL REGISTER OF HISTORIC PLACES
CONTINUATION SHEET

Section 7 Page 2

House at 1233 Wentworth Ave.
name of property
Los Angeles County, CA.
county and State
The Residential Architecture of Pasadena,
CA, 1895-1918: The Influence of the Arts
and Crafts Movement
name of multiple property listing

=====
porch located at the southeast corner of the house (date unknown). This is not visible from the street, and is barely detectable from the rear of the house. One of the most exceptional features of the interior is a large Batchelder-designed fireplace in the living room. The dining room retains its historic wood paneling, paneled pocket doors, and built-in cabinetry. The design of the staircase, which rises from the entrance hall, refers to the classical tradition of eighteenth century England more than to the medieval forms of the Cotswold cottage.

United States Department of the Interior
National Park Service

NATIONAL REGISTER OF HISTORIC PLACES
CONTINUATION SHEET

Section 8 Page 3

House at 1233 Wentworth Ave.
name of property
Los Angeles County, CA.
county and State
The Residential Architecture of Pasadena,
CA, 1895-1918: The Influence of the Arts
and Crafts Movement
name of multiple property listing

=====
Statement of Significance

Built in 1917, the house at 1233 Wentworth Avenue was designed for Lydia C. Edmonds, a widow, by the architect Arthur S. Heineman. The dwelling represents the property type "Arts and Crafts Single-Family Residences in Pasadena," and is an excellent example of a Cotswold cottage (English influenced) within the subtype "one-and-one-half-story bungalow." It meets the registration requirements under Criterion C, as it exemplifies the values of design, craftsmanship, and materials which embody the philosophy and practice of Arts and Crafts period residential architecture in Pasadena, and the property retains integrity. Distinguishing features associated with the Cotswold cottage include the shingle-clad roof with rolled eaves, low lying horizontal form emphasized by a wide entrance porch/porte-cochere, decorative barge board, and half-timbering.

United States Department of the Interior
National Park Service

NATIONAL REGISTER OF HISTORIC PLACES
CONTINUATION SHEET

Section 9,10 Page 4

House at 1233 Wentworth Ave.
name of property
Los Angeles County, CA.
county and State
The Residential Architecture of Pasadena,
CA, 1895-1918: The Influence of the Arts
and Crafts Movement
name of multiple property listing

=====
Major Bibliographical References

Pasadena, City of:
Assessor's Records
Building Permits
Sewer Maps

Pasadena City Directories.

Sanborn Fire Insurance Company Maps, Pasadena, 1910-1928; 1931 corrected to 1958.

Verbal Boundary Description

That portion of Lot 7 Oak Knoll, sheet "A", in the City of Pasadena, County of Los Angeles, State of California, as per map recorded in Book 10, pages 114 and 115 of Maps in the office of the County Recorder of said County, described as follows: Beginning at a point on the easterly line of said Lot 7, distant South 8 degrees 40'00" East, 100.00 feet, as measured along said easterly line from the northeasterly corner of said lot; thence along said easterly line North 8 degrees 40'00" West, 100.00 feet to said northeasterly corner; thence along the northerly line of said lot 7 South 81 degrees 20'00" West, 262.83 feet to the northwesterly corner of said lot; thence along the westerly line of said lot, South 1 degree 26'40" West, 101.47 feet and North 81 degrees 21'18" East, a distance of 280.64 feet to the Point of Beginning. Los Angeles County Assessor's Book No. 5325-027-014.

Boundary Justification

The boundary is the portion of Lot 7 of Oak Knoll as described above which has been historically associated with the property and includes the house at 1233 Wentworth Avenue, garage, and gazebo.

Location Map

House at 1233 Wentworth Avenue

Pasadena

Los Angeles County, CA

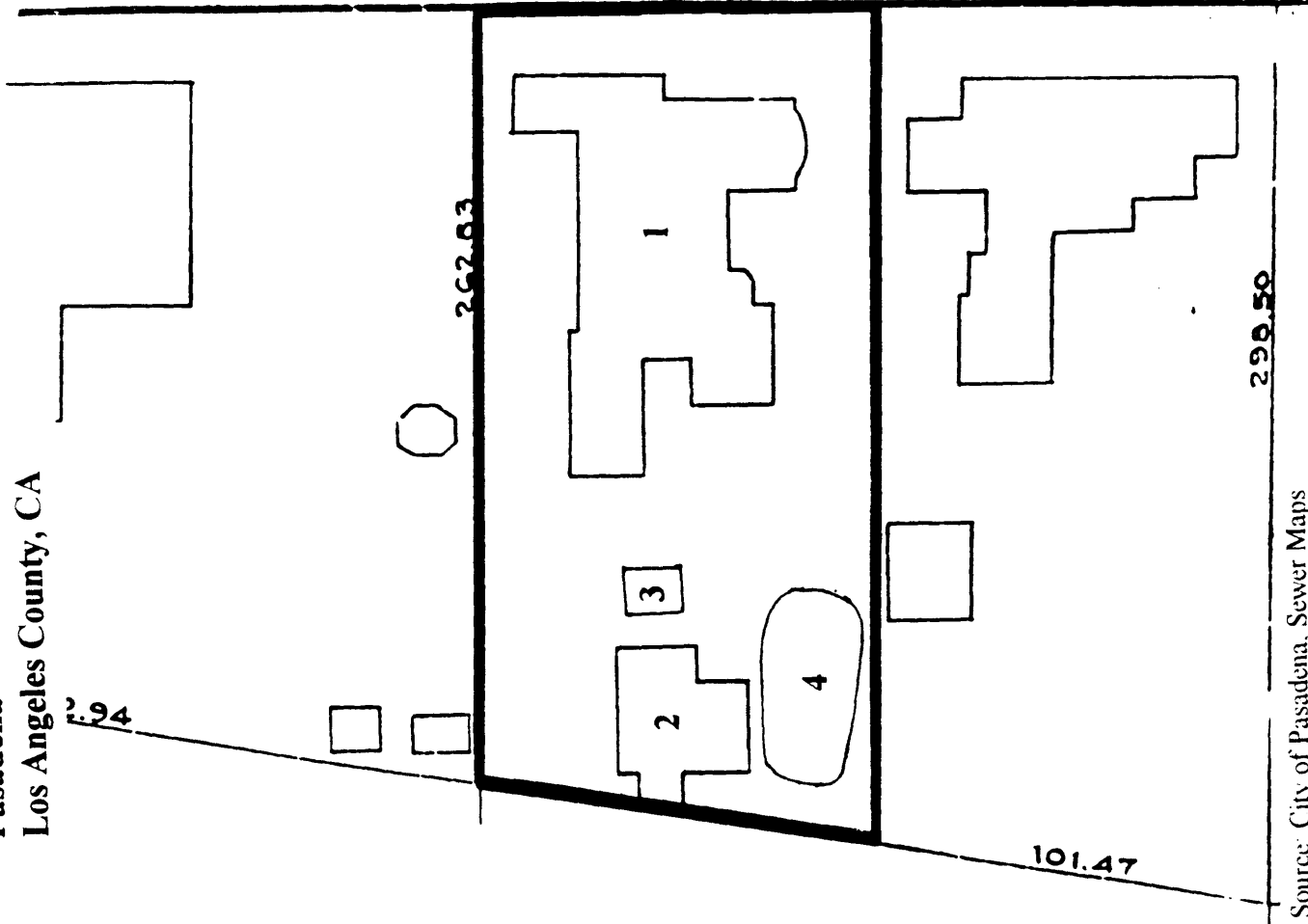

Wentworth Avenue

Contributing Buildings

1- House

2- Garage

Contributing Structure

3- Gazebo

Non-Contributing Structure

4- Swimming Pool