

KENTUCKY HISTORIC RESOURCES
Individual Inventory Form

Resource # 153
Shelby County

1. Name of Resource:
Moxley Farm (Hall House)

2. Original Owner:
Woodford J. Hall

3. Other Names:
Maplehurst

4. Prehistoric Site Building Object
Historic Site Structure Other

5. Location: East side Zaring Mill Road, south
side of I-64

6. Owner's Name:
Fraser Bryan Wilkins [P]

7. Owner's Address:
P.O. Box 395
Shelbyville, KY 40065

8. Evaluation: National Register [N]

9. Recognition & Date:
Nat.Landmark _____ Local Landmark _____
Nat.Register _____ HABS/HAER _____
Highway Marker _____ KY Inventory 8-15-80
KY Landmark Certificate

10. N.R.Status & Date:

11. N.R.Group:
District Name: []
Mult.Resource Area: Shelby County []
Thematic Name: []

12. Historical Theme:
Primary: Architecture [030]
Secondary: []
Other: []

13. Statement of Significance:
This property is significant under criterion C as a unique example of domestic rural architecture in Shelby County. The original 1812 structure appears to have been either a side-passage of hall-parlor (two-room) plan. The handsome 1902 additions, while [C]

14. History:

16. Date:
Original Building 1812 [8]
Addition 1902 [4]

17. Style:
Federal [21]
Colonial Revival [51]

18. Architect/Builder:
Unknown

19. No. of Stories: 2 [2.0]

20. Original Floor Plan:
Side passage (?) [SP]

21. Single Pile Double Pile N.A.

22. Roof Form & Material: Original
Gable, asphalt shingle Not Original

23. Structural Material:
Brick/Wood frame [B/W]

24. Exterior Material: Brick [B]
Sawn weatherboard [W]

25. Foundation Material:
Stone [S]

26. Major Alterations: None
Moved/Rebuilt Other
 Additions

27. Special Features: Garden, outbuildings,
original plan and additions

28. Outbuildings: stone cellar, frame smokehouse
greenhouse, tenant house, slave house 5]

29. Original Function:
Residential/Domestic, single dwell [01A]

30. Present Use:
As above [01A]

31. Condition:
Excellent [E]

32. Endangered: Yes
No

33. Attach Photos:
Roll: Photo Nos: No. of Slides:
15 11 - 29

15. Source of historical information and/or contact person:

34. Prepared by: C. Worsham

35. Organization: V, Shelby Co. Hist. Society

36. Date: April 1986

37. New Survey _____ Resurvey

KENTUCKY HISTORIC RESOURCES
 Individual Inventory Form

Resource # 153

UTM Point of Primary Building: Quadrant: <u>Shelbyville</u>	Zone <u>16</u>	Easting <u>6 5 4 9 0 0</u>	Northing <u>4 2 2 7 2 0 0</u>	39. G.I.S. Mod. []	40. Coordi.Accuracy []
--	-------------------	-------------------------------	----------------------------------	---------------------	-------------------------

UTM Points of Boundary (for N. R. eligible sites only):

A. ---	D. ---
B. ---	E. ---
C. ---	F. ---

Total Acreage in Present Property: 270 43. Acreage included in proposed N.R. boundary: 7.2
 Site Plan (and boundary description and justification for N.R. sites): see page 4 for plan

Beginning at point A, proceeding 650' east on line corresponding to stile at northernmost point of wood fence north of house, following line of fence and drive to point B, thence south 350' along fence and line corresponding to fence to point C, thence 650' west along fruit tree line and corresponding stone wall to point D, thence north 490' along wood fence to point of origin. The boundaries were chosen to include the house and unusually extensive and elaborate garden, as well as domestic-related space including significant outbuildings, all enclosed by fences, drives and clearly demarked tree lines. The nominated acreage includes four contributing outbuildings and ancillary garden structures and walls.

Point A is located near the northern side of the drive in a line extending northward from the western yard fence, and is 49 feet north of the terminus of this fenceline and 284 feet northeast of the northeastern corner of the dwelling's west wing.

Description and House Plan: see page 5 for plan

Exterior: The original 2-story, brick hall-parlor (two-room) plan house with advanced two-bay one-story brick wings has been heavily altered in an ambitious expansion in 1902. The structure had a Flemish bond principal (north) facade, jack arches over 9/6 sash windows, slightly projecting chimneys, box cornice, tapered beaded rakeboards. The secondary facades were 6-course common bond. A brick 1-story kitchen stood six feet from the southeast corner of the east wing and was reached along a porch on the south wall of the east wing, which was supported on a chamfered square post. In 1902 a new range of rooms was added in front of the central section in a hip-roofed 2-story, 3-bay frame section. At the same time a one-story brick bath was added behind the west wing and a frame rear (south) wing added which contained a second floor bedroom supported on stone piers and wood columns. The porch along the rear of the east wing was enlarged and glassed in.

Interior: Most of the original section of the house featured reeded trim (intact); several doors and windows were altered or added in 1902. The central room (hall) contains a reeded mantel surround with bulls eye corner blocks. The east wing has an original built-in cabinet, molded architrave trim and a shelf and architrave mantel as does the second floor room over the central section. A stair has been inserted in the former "parlor" space. The original stair location is unknown. The west wing has a 1902 metal mantel. In the north addition the trim has bulls eye corner blocks. An elaborate molded brick Colonial Revival fireplace stands in the entry hall, as well as a built-in

13. Statement of Significance: (continued)

leaving the 19th century house clearly identifiable as such, transformed the site into an exceptional Colonial Revival complex, unparalleled in the county. The elaborate and extensive gardens are another unique feature adding to the significance of the site as a turn-of-the-century "country estate". Outbuildings and garden structures depict the property's use and form through times from an early 19th century

45. Description and House Plan: (continued) farm to an early 20th century estate.

window seat in a projecting bay on the west wall. The bedroom over the rear porch contains a corner fireplace and a corresponding corner closet, both on the west wall. The kitchen has been little altered, and contains a federal mantel with colonettes. The interior is furnished as it was in 1902, with wicker furniture and grass matting in the upper bedrooms.

Outbuildings:

The outbuildings include a domed deep circular stone "dairy" & a 20th century frame smokehouse to the immediate southeast of the kitchen. Further to the east are located an early 20th century frame tenant house, and a reputed "slave house" made of vertical planks, said to be one of an entire row, all of the above reached by stone walks.

Garden: Two large (300' x 200' each) gardens are located south of the house. One of them is partially surrounded by a massive undulating stone wall, containing a pair of parterres, a stone pool, a large stone pier pergola, and a fountain. On axis with the pergola and pool, a gate opens to a walnut lined alleè. It leads through a former bedding garden to an off-center greenhouse with a stucco headhouse (not included in the nomination). A grove of trees to the northwest is bordered by a stone front walk leading from the north front to a stile in a wooden fence surrounding the house on the west and north. The stile contains a pair of benches on an elevated platform. The contributing outbuildings included in the nomination are: the stone "dairy" (cellar), the frame smokehouse, the frame tenant house, and the "slave house".

There are five contributing buildings and five contributing structures.

Moxley Hall Sh-153

surveyed 1986

G. Worsham
C. Worsham

all dimensions paced.
NOT TO SCALE

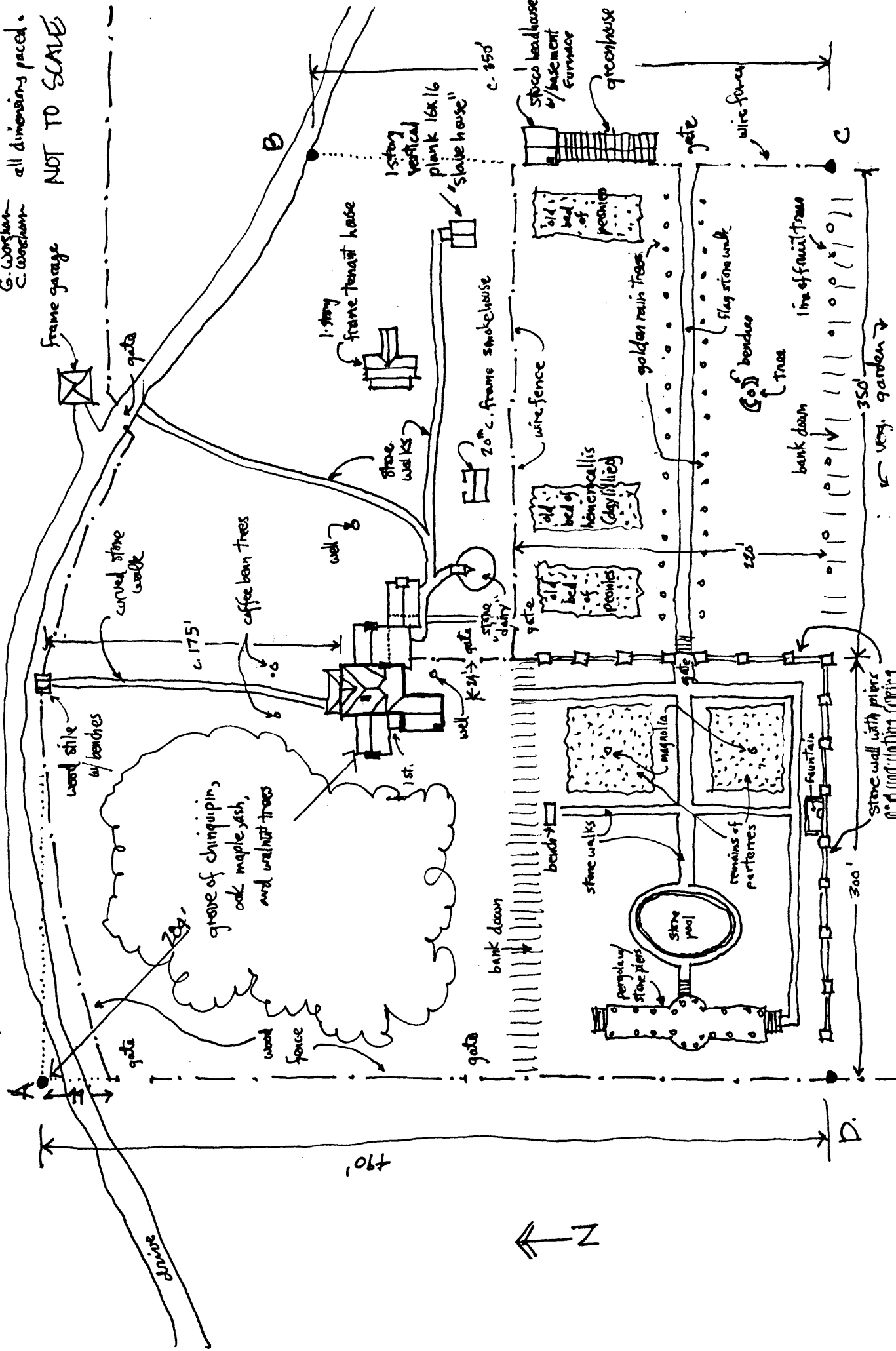

Moxley Hall Sh-153

Surveyed 1986
G. Worsham
C. Worsham

all dimensions are paced.
NOT TO SCALE

