

2/27/89

United States Department of the Interior
National Park Service

National Register of Historic Places
Registration Form

This form is for use in nominating or requesting determinations of eligibility for individual properties or districts. See instructions in *Guidelines for Completing National Register Forms* (National Register Bulletin 16). Complete each item by marking "x" in the appropriate box or by entering the requested information. If an item does not apply to the property being documented, enter "N/A" for "not applicable." For functions, styles, materials, and areas of significance, enter only the categories and subcategories listed in the instructions. For additional space use continuation sheets (Form 10-900a). Type all entries.

1. Name of Property

historic name Levillain/Letton House
other names/site number S0504

2. Location

street & number 229 South Harbor Drive N/A not for publication
city, town Venice N/A vicinity
state Florida code FL county Sarasota code FL115 zip code 34293

3. Classification

Ownership of Property	Category of Property	Number of Resources within Property	
<input checked="" type="checkbox"/> private	<input checked="" type="checkbox"/> building(s)	Contributing	Noncontributing
<input type="checkbox"/> public-local	<input type="checkbox"/> district	<u>1</u>	<u>0</u> buildings
<input type="checkbox"/> public-State	<input type="checkbox"/> site	_____	_____ sites
<input type="checkbox"/> public-Federal	<input type="checkbox"/> structure	_____	_____ structures
	<input type="checkbox"/> object	_____	_____ objects
		<u>1</u>	<u>0</u> Total

Name of related multiple property listing: Venice Multiple Property Group
Number of contributing resources previously listed in the National Register N/A

4. State/Federal Agency Certification

As the designated authority under the National Historic Preservation Act of 1966, as amended, I hereby certify that this nomination request for determination of eligibility meets the documentation standards for registering properties in the National Register of Historic Places and meets the procedural and professional requirements set forth in 36 CFR Part 60. In my opinion, the property meets does not meet the National Register criteria. See continuation sheet.

[Signature] State Historic Preservation Officer 2/13/89
Date
Florida State Historic Preservation Officer, Bureau of Historic Preservation
State or Federal agency and bureau

In my opinion, the property meets does not meet the National Register criteria. See continuation sheet.

Signature of commenting or other official Date

State or Federal agency and bureau

5. National Park Service Certification

I, hereby, certify that this property is:

entered in the National Register.
 See continuation sheet.

determined eligible for the National Register. See continuation sheet.

determined not eligible for the National Register.

removed from the National Register.

other, (explain:)

Amy Schlager 4/12/89
Signature of the Keeper Date of Action

6. Function or Use

Historic Functions (enter categories from instructions)
DOMESTIC/single dwelling

Current Functions (enter categories from instructions)
DOMESTIC/single dwelling

7. Description

Architectural Classification
(enter categories from instructions)

SPANISH COLONIAL REVIVAL

Materials (enter categories from instructions)

foundation concrete
walls hollow clay tile
stucco
roof concrete barrel tiles
other

Describe present and historic physical appearance.

8. Statement of Significance

Certifying official has considered the significance of this property in relation to other properties:

nationally statewide locally

Applicable National Register Criteria A B C D

Criteria Considerations (Exceptions) A B C D E F G

Areas of Significance (enter categories from instructions)

Social History

Architecture

Period of Significance

1925-1928

Significant Dates

1925

Significant Person

N/A

Architect/Builder

Unknown

State significance of property, and justify criteria, criteria considerations, and areas and periods of significance noted above.

See continuation sheet

United States Department of the Interior
National Park Service

**National Register of Historic Places
Continuation Sheet**

Section number 7 Page 1 Levillain/Letton House

The structure located at 229 South Harbor Drive, constructed in 1925, contributes to the Venice Multiple Property Group under Associated Property Type F1, Buildings of Venice. The two story residence is typical of the Housing Facilities, Category, Medium-sized Residence, Subcategory.

The structure located at 229 South Harbor Drive is a two story Mediterranean Revival style residence constructed of textured cast stucco over hollow clay tile. The four bay plan is rectangular with a one bay wing on the right(south) side. The structure has a concrete foundation. The gable roof is clad in concrete barrel tile of the period. Windows are single and paired 6/6 and 4/4 double hung wood sash. A circular louvered gable vent is located on the south elevation. The first story bays of the side wing are arched and screened. The structure is in good condition. Alterations are limited to replacement aluminum windows at the front lower elevation.

The property contains several palmettoes and ornamental trees planted at the time of construction. Overgrown border plants obstructs the view of the elevations. The "broken" sidewalk and curbing on South Harbor Drive are also from the historic period.

United States Department of the Interior
National Park Service

National Register of Historic Places Continuation Sheet

Section number 8 Page 1 Levillain/Letton House

The Mediterranean Revival style residence at 229 South Harbor Drive is significant at the local level under Criterion C as a good example of the Mediterranean Revival style as applied to a medium-sized residence. The house contributes to the Venice Multiple Property Group under Associated Historic Context: Initial Period of Development of the City of Venice, Florida 1925-1928, and Associated Property Type-F1-Buildings of Venice under Category/Subcategory-Housing Facilities, Medium-sized Residences.

The residence built at 229 South Harbor Drive is one of the original medium-sized residences planned for Venice by John Nolen in 1925. The structure was built in the Mediterranean Revival style that was required by the developers of the plan, the Brotherhood of Locomotive Engineers. Located between Venezia Park and Menendez Park (Armada Drive area), the Levilain/Letton House conforms to the standards imposed by both the city planner and the developer in the completion of residential neighborhoods for medium income families. Unlike the larger residences of the executive officers, the property lacks a garage and the more ornamental landscaping. In contrast, the lot provides a comfortable sized yard and is landscaped, unlike those found in the Edgewood Subdivision for the lower income families.

The property is a good example of the use of the Mediterranean Revival style and retains its historic integrity through location, design, setting, materials, workmanship, feeling and association. Although not of high style, the residence reflects the ability of the style to conform to modest residences. This was part of the significance of the Nolen Plan in Venice as it was able to provide for comprehensive planning under the auspices of one universal architectural style. By doing so, the development of Venice was directly linked to the architectural style of the historic period and reflects the implementation of the Nolen Plan by the Brotherhood of Locomotive Engineers.

SOUTH HARBOR DRIVE

PEDRO STREET

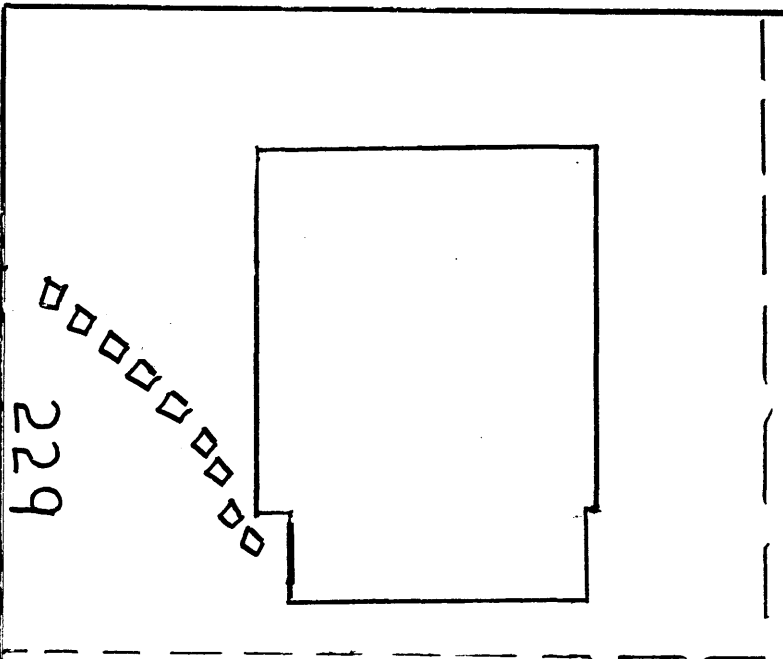

229

241

Levillain/Letton House

Venice, FL



Levillain/Letton House
Venice, FL

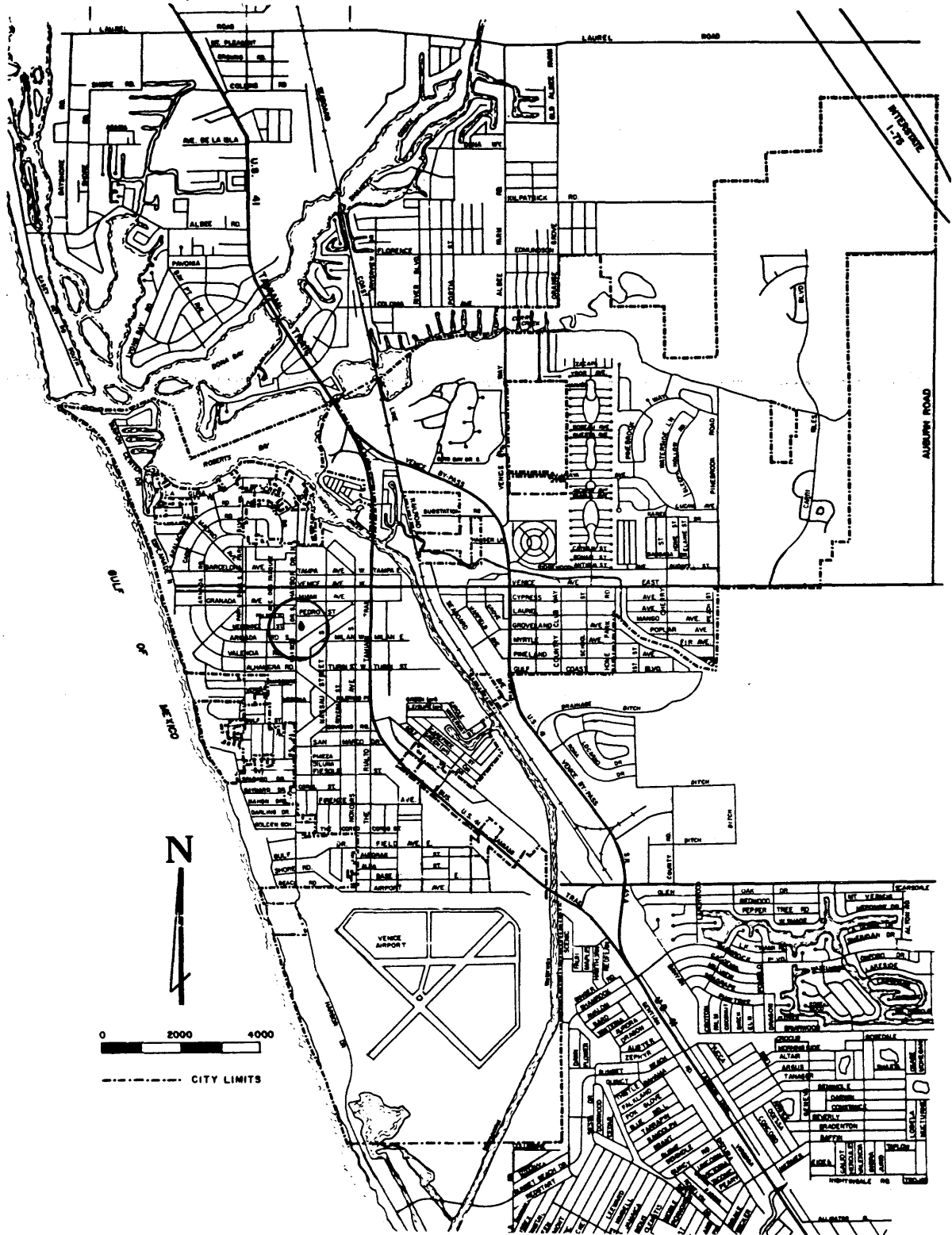

229 S. Harbor Drive