

ARCHITECTURAL / HISTORICAL SURVEY

DAVENPORT, IOWA

The Architects Office

Wehner, Nowysz, Pottschiull and Pfiffner
301 day building Iowa city Iowa 52240

DAVENPORT COMMUNITY DEVELOPMENT DEPARTMENT
IOWA DIVISION OF HISTORIC PRESERVATION

SITE # 82-10- BR-425 MAP # 1

HIST. DIST. _____

NAME Philip Worley House H C

ADDRESS 425 Brady Street

LEGAL DES. LeClaire's 2nd 55 4
SUB-DIVISION BLOCK PARCEL SUB-PARCEL

UTM 4 15 710,214,301 4,519,915,80 ACREAGE -1 ZONE C-4
EASTING NORTHING

OWNER Ronald L. Bellomy
425 Brady St., Davenport, IA 52801

TITLE H. Milbert W. Reemtsma
(IF DIFF)

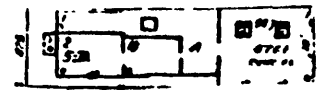

SITE SHEET

DESCRIPTION

FORM 2 story, 3-bay side gable house CONST. DATE c. 1860

MATERIALS Brick ARCH STYLE Vernac. Greek Revival

FENESTRATION 2/2 and 4/4 D.H.S. - rectangular - 1st floor windows tall & narrow

DIST. FEATURES Greek Revival entrance, window cornices

ALTERATIONS Porch added - garage added N. side - sash replaced?

SITE & RELATED STR. In row of mixed commercial buildings north of CBD

STATEMENT

This house is a good example of Davenport's Greek Revival domestic architecture. Notable features include retention of 3 of possibly four chimneys, a handsome entrance with sidelights, and simple molded cornices at windows. Despite the garage wall at the north, this is one of the better preserved examples of its kind in the city.

ARCHITECTURE

SOURCES

SIGNIFICANCE

HISTORY

DESCRIPTION

This residence was probably built in 1860 by Dr. Philip A. Worley, a homeopathic physician. Worley had his office and residence at this location. By the late 1870's Worley had a physician partner and by the mid-1880's Charles H. Worley operated a livery stable from an adjacent building while residing at 425 Brady Street. The functional link between 425 and 427 Brady continues today with the buildings use as an antique shop.

SOURCES

City Directories, 1858-59, 1860, 1863, 1866, 1870-71, 1874-75, 1880, 1884-85, 1888-89, 1890

ARCHITECTURAL HISTORIAN: Martha Bowers | HISTORIAN: MARLYS SVENDSEN - ROESLER | SURVEY COMP 1981

EVALUATION

ARCHITECTURAL

- I. ARCH. EVALUATION Good
- II. ENVIR. STATURE Tissue
- III. INT. OF CONTEXT Fair
- IV. INT. OF FABRIC Good

LEVEL OF SIGNIFICANCE:

- NAT. STATE LOCAL N. ELIG.

HISTORICAL

I. THEME(S) OF SIGNIFICANCE:

- A. PRIMARY _____
- B. SECONDARY _____

II. LEVEL OF SIGNIFICANCE:

- NAT. STATE LOCAL

III. N.R.H.P.

- ELIGIBLE NOT ELIGIBLE

HISTORIC DISTRICT CLASSIFICATION

- A. B. C.

FOR DIVISION OF HISTORIC PRESERVATION USE ONLY

1. DATE RECEIVED _____

2. DATE OF STAFF EVALUATION _____

- | | | |
|---------------------------|--------------------------|--------------------------|
| | A. ARCHITECTURAL | B. HISTORICAL |
| ELIGIBLE FOR N.R.H.P. | <input type="checkbox"/> | <input type="checkbox"/> |
| NOT ELIGIBLE FOR N.R.H.P. | <input type="checkbox"/> | <input type="checkbox"/> |

3. N.R.H.P. ACTION

- | | | | | |
|-----------------------|-------------------------------|----------------------------------|---------------------------------|------------|
| A. STATE REVIEW COMM. | APP. <input type="checkbox"/> | DISAPP. <input type="checkbox"/> | TABLED <input type="checkbox"/> | DATE _____ |
| B. FEDERAL REVIEW | APP. <input type="checkbox"/> | DISAPP. <input type="checkbox"/> | TABLED <input type="checkbox"/> | DATE _____ |

4. D.H.P. SOURCES

- COUNTY RESOURCES
- W'SHIELD SURVEY
- N.R.H.P.
- GRANT _____

- DET. OF ELIGIBILITY
- R. & C. _____
- DAVENPORT A/M SURVEY
- _____
- _____

5. SUBJECT TRACES

6. PHOTO

1729, 2
 W. elevation