

KENTUCKY HISTORIC RESOURCES
Individual Inventory Form

Resource # SH 241
SHELBY County

1. Name of Resource:
ELI JACKSON HOUSE

2. Original Owner:
ELI O. JACKSON

3. Other Names:

| 4. Prehistoric Site | Building X Historic Site | Object Structure | Other |
|---|-----------------------------|---------------------|-------|
| 5. Location: EMINENCE QUAD; SW CORNER OF CLORE-- JACKSON AND KY 55 INTERSECTION | | | |
| 6. Owner's Name: PINE PARK PLACE PARTNERS LABAN JACKSON [P] | | | |
| 7. Owner's Address: 11 RIVER HILL ROAD LOUISVILLE, KENTUCKY 40207 | | | |
| 8. Evaluation: N.R. POTENTIAL [N] | | | |
| 9. Recognition & Date: Nat.Landmark _____ Local Landmark _____ Nat.Register _____ HABS/HAER _____ Highway Marker _____ KY Inventory 1984 _____ KY Landmark Certificate _____ | | | |
| 10. N.R.Status & Date: | | | |
| 11. N.R.Group: District Name: [] Mult.Resource Area: FOC SHELBY CO [] Thematic Name: [] | | | |
| 12. Historical Theme: Primary: ARCHITECTURE [030] Secondary: [] Other: [] | | | |
| 13. Statement of Significance: The property is significant on a local level under criteria c; as one of two examples of Classical Revival or Neoclassical domestic architecture in rural Shelby County built in the early 20th Century. | | | |
| [C] | | | |

16. Date:
Original Building ca. 1915 [4]
Addition []

17. Style:
CLASSICAL REVIVAL [52]
[]

18. Architect/Builder:
Barry Construction, Eminence

19. No. of Stories: TWO [2.0]

20. Original Floor Plan:
ORIGINAL [00]

21. Single Pile Double Pile N.A. X

22. Roof Form & Material: Original _____
GABLE/ASPHALT SHINGLE Not Original X

23. Structural Material:
FRAME [W]

24. Exterior Material: CLAPBOARD [W]
[]

25. Foundation Material:
CONCRETE BLOCK [C]

26. Major Alterations: None X
Moved/Rebuilt Other

27. Special Features:
MONUMENTAL PORTICO

28. Outbuildings:
NONE CONTRIBUTING [NC]

29. Original Function:
RESIDENTIAL [01A]

30. Present Use:
RESIDENTIAL [01A]

31. Condition:
FAIR-POOR [F]

32. Endangered: Yes _____
No X

33. Attach Photos:
Roll# Photo Nos: 12- No. of Slides:
17

14. History:
The house is located on the farmland originally owned by H. Curtis that supported one of the oldest hereford herds in the county. In 1914, Eli O. Jackson purchased the farm from Curtis. The original residence, a two story frame, burned shortly after the transaction. Jackson hired Barry Construction of Eminence in Henry County to build a new house of "similar form and plan" to the one that burned.¹ From the present form, it is assumed that the original house was a two story, double pile, center passage plan.

15. Source of historical information and/or contact person:
① Laban Jackson; Shelby County Clerk and Recorder

34. Prepared by: CHRISTINE AMOS
35. Organization: SHELBY CO. HIST. SOC.
36. Date: 6/1986
37. New Survey X **Resurvey** _____

KENTUCKY HISTORIC RESOURCES
 Individual Inventory Form

Resource # SH 241

38. UTM Point of Primary Building: Zone Easting Northing 39. G.I.S. Mod. []
 Quadrant: Eminence 16 657560 4241720 40. Coordi.Accuracy []

41. UTM Points of Boundary (for N. R. eligible sites only):

| | |
|--------|--------|
| A. --- | D. --- |
| B. --- | E. --- |
| C. --- | F. --- |

42. Total Acreage in Present Property: 244 43. Acreage included in proposed N.R. boundary: 2

44. Site Plan (and boundary description and justification for N.R. sites):

The property is an early 20th Century Classical Revival residence, sited about 650' feet east of the Eminence Pike (KY 55) in the southwest quadrant of the intersection with the Clore Jackson Road. All of the historic farm buildings associated with the house have been replaced or altered and some of the surrounding terrain has been recontoured and new post and plank fences have been added. Because of loss of integrity of setting and associated buildings, the site perimeters include only the house, and the boundary forms a regular rectangle around it. Fences to the north and south of the entry drive form the north and south boundaries; the east line is drawn 200 east of the front of the house and includes the spruce trees that align the drive; and the west boundary is drawn between the two fences 50 feet behind the rear wall of the house. Beginning at point A, on the northern fence line, about 350' west of the west edge of the Eminence Pike; then 375' south to point B on the south fence line; then 300' west along the fence line to point C, 50' beyond the rear wall of the building; then north 375' to point D on the north fence; then east 300' along the fence line to the point of origin.

45. Description and House Plan:

The property is a large, two story, frame, Classical Revival or Neoclassical house, located at the end of a long drive off the Eminence Pike in north-central Shelby County (photo 7-13). The house is in only fair condition due to neglect, but it maintains good integrity of design and materials, and is only one of two such rural homes in the county that has maintained any large degree of integrity (photos 7;12,14-16). Design and material features include symmetrical five bay front with a monumental pedimented portico on round wood columns; gable roof; extended eave with corbel blocks; plain architrave with dentil band; six-over-six sash windows; eight and six light casements; a subordinate single story, screened porch with ballustered flat roof; brick south end shouldered chimney through the eave with flanking quarter lights; a Palladian window in the opposite attic gable end; concrete block foundation; and elaborate central entry bay which features a solid door flanked by decorative sidelights and elliptical fanlight, and balcony above with multi light door and windows (photo 7-17). ONE CONTRIBUTING BUILDING.

SH241
ELI JACKSON HOUSE: □ SITE PLAN AND BOUNDARY MAP

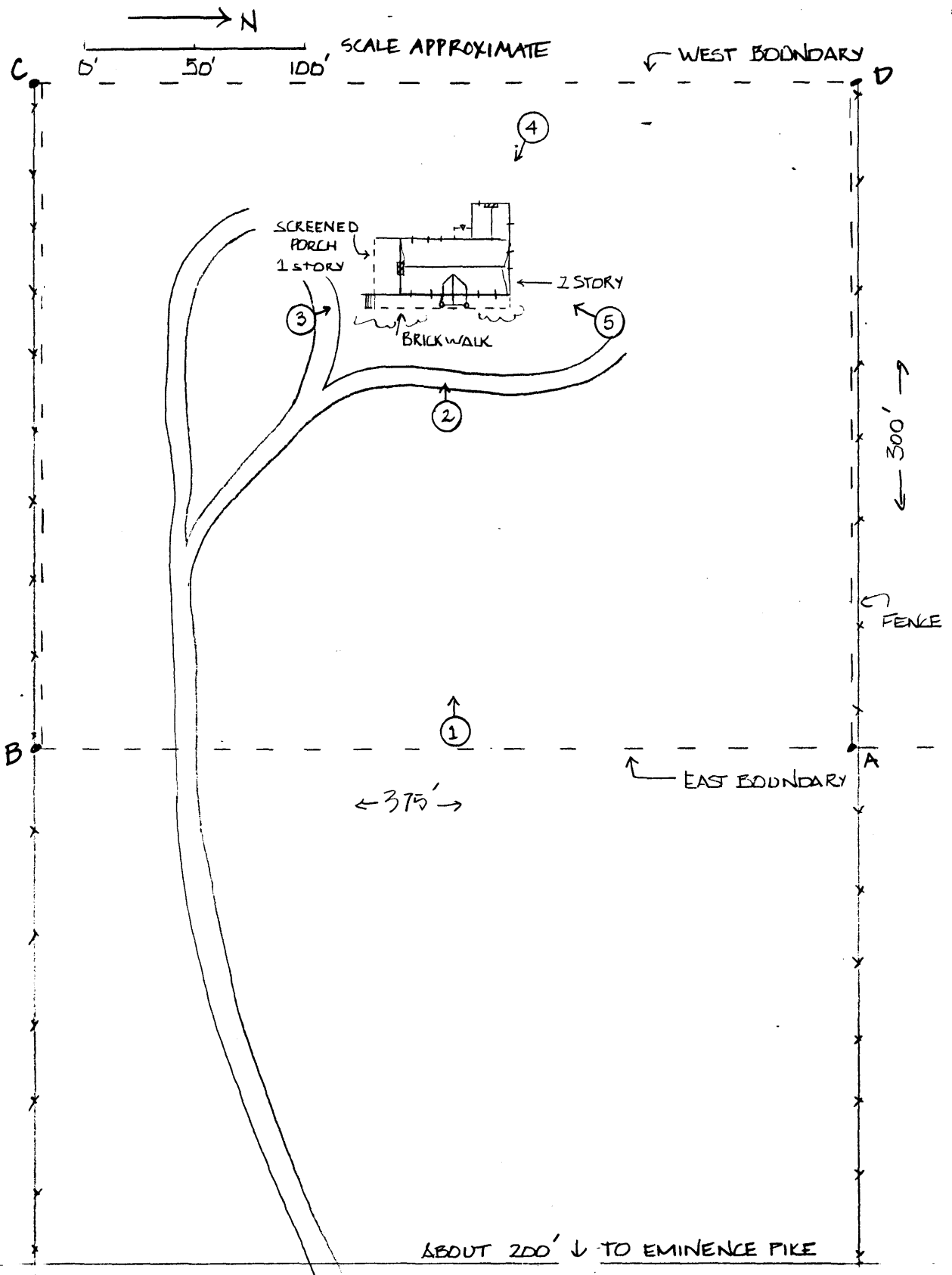

↑ PHOTOS