

HISTORIC PRESERVATION UNIT
DEPARTMENT of CULTURE & HISTORY
SCIENCE & CULTURE CENTER
CHARLESTON, WEST VIRGINIA 25305

File No: _____
Theme(s): 18.
Neg No(s): _____
USGS Quad: _____
UTM Ref: _____
17/451630/4346360

DISTRICT . SITE . BUILDING . STRUCTURE . OBJECT

1. NAME(S), historic/common: Elks Club *(Sorentown Parkersburg WVA)*

2. LOCATION, street/road: 515 Juliana St.

TAX MAP - LOT #

92-18 city/town: Parkersburg, WV 26101
(Incorporated/unincorporated)

3. USE/FUNCTION, present: social club

(public/private, restricted)

original: social club

4. OWNER/ADDRESS, present: Parkersburg Lodge #198 B.P.O.E.
address above

(public/private)

original:

5. PHOTO/SKETCH OF: 8112-R2-F9-10

7. PLAN (include approx. dimensions):



78x180

6. LOCALE/ENVIRONMENT (map):

8. ACREAGE (approx):

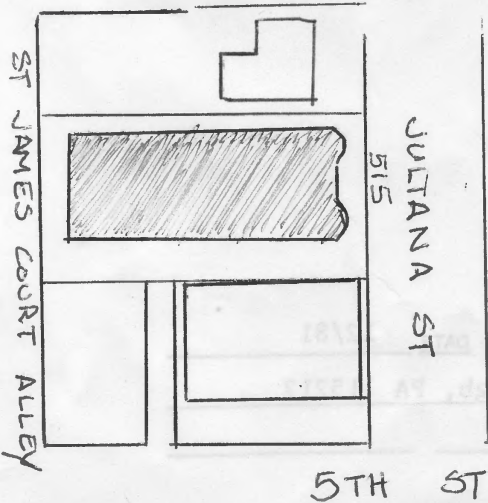

COUNTY: Wood
Survey Region: _____
Planning District: _____

9. DESCRIPTION (clarify as appropriate): See attached

a. Exterior Fabric

stone trim _____
 brick red _____
 concrete _____
 stucco _____
 weatherboard _____
 clapboard _____
 board & batten _____
 shingle _____
 other _____

b. Structural System

masonry _____ X
 frame _____
 log _____
 metal _____
 other _____
 foundation _____

c. Roofing Material

wood _____
 metal _____
 slate _____
 tile _____
 asphalt _____ X
 composition _____
 other _____

d. Associated Structures (use/type):

outbuildings _____

 dependencies _____

 other _____

e. Integrity (include dates):

original site/relocated _____
 alterations _____

 additions rear wing _____

f. Condition:

excellent _____
 good _____ X
 fair _____
 deteriorated _____
 abandoned _____

g. Threats:

None apparent.

10. SIGNIFICANCE (use additional sheet if necessary):

a. Architect/Builder/Engineer:

William Howe Patton, Arch.

b. Style/Period: Classical

c. Date(s): 1903

A handsome Classical design, this is the only known work in ^{downtown} Parkersburg by one of only four architects listed in the 1898 City Directory.

The Elks Club building is an accomplished piece of classical genre architecture (elements of Beaux Arts Classicism) by William Howe Patton of Parkersburg who gained notice among professional architects in West Virginia in the early 20th century. Patton used fine stone, metal and brick detailing to highlight the elliptical-style bays of the entrance facade. Patton regarded this building with special pride, though other of his numerous Parkersburg commissions include the magnificent McKinley School (1904) on Dudley Avenue.

11. BIBLIOGRAPHY:

Letter from Rodney Collins to Eliza Smith, January 21, 1982.

1898 City Directory.

12. FORM PREPARED BY Eliza Smith, Christina Mann ; DATE 12/81

a. Address Allegheny Square West, Parkersburg, PA 15212

b. Organization Landmarks Planning, Inc.

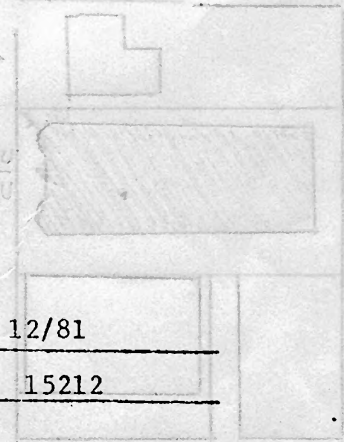

Elks Club
515 Juliana St.
92-18

Sited in the center of a block along a major thoroughfare, this is a 3 story Classical building roughly 3 bays square with a rear (NW) wing. It reads as a 2 story building with corner quoins, crowned by an added 3rd story. The flat roof is surrounded by a low brick parapet with a dentiled modillion cornice below. Each bay of the 3rd story, separated by symbolic medallions, contains a pair of 2/2 windows framed by engaged colonettes; in the side elevations they are not paired. Projecting out from the 3rd story is another low parapet and box cornice above the 2nd story. The 2 outer bays on the SE contain 2 rounded bays. The 1st and 2nd story windows are d/s (1/1), with Gibbs surrounds on the front (SE). The central SE bay contains a 3 window system with cornice and Gibbs surround on the 2nd story and a Classical doorway on the 1st, framed by engaged columns, a plain cornice, and extended voussoirs. The raised basement is banded below a stone water table. The rear section has an irregular fenestration system; many windows have been boarded up.



Eike Glop
515 Julian St.
02-18

Sited in the center of a block along a major thoroughfare, this is a 3 story classical building roughly 3 bays square with a rear (W) wing. It reads as a 2 story building with corner quoins, crowned by an eaved 3rd story. The flat roof is surrounded by a low brick parapet with a detailed modulation cornice below. Each bay of the 3rd story, separated by symbolic medallions, contains a pair of 3/2 windows framed by engaged colonettes; in the side elevations they are not paired. Projecting out from the 3rd story is another low parapet and box cornice above the 2nd story. The 2 gable bays on the SE contain 2 rounded bays. The 1st and 2nd story windows are 4x6 (1/1), with cills surrounded on the front (SE). The central SE bay contains a 3 window system with cornice and cills around on the 2nd story and a classical doorway on the 1st, framed by engaged columns, a plain cornice, and extended voussiers. The raised basement is banded below a stone water table. The rear section has an irregular fenestration system; many windows have been boarded up.

