

**NATIONAL REGISTER OF HISTORIC PLACES
INVENTORY - NOMINATION FORM**

(Type all entries - complete applicable sections)

STATE: Minnesota	
COUNTY: Hennepin	
FOR NPS USE ONLY	
ENTRY NUMBER 70.10.22.0019	DATE 10/9/70

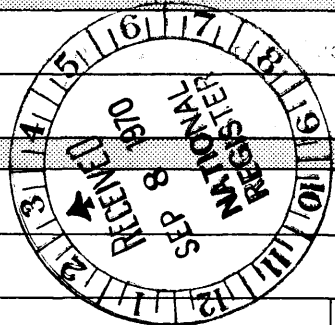

1. NAME

COMMON:
Grange Hall

AND/OR HISTORIC:

2. LOCATION

STREET AND NUMBER:
Eden Avenue at Highway #100

CITY OR TOWN:
Edina

STATE Minnesota	CODE 55436	COUNTY: Hennepin	CODE 053
---------------------------	----------------------	----------------------------	--------------------

3. CLASSIFICATION

CATEGORY (Check One)	OWNERSHIP	STATUS	ACCESSIBLE TO THE PUBLIC
<input type="checkbox"/> District <input type="checkbox"/> Site <input type="checkbox"/> Object <input checked="" type="checkbox"/> Building <input type="checkbox"/> Structure	<input type="checkbox"/> Public <input checked="" type="checkbox"/> Private <input type="checkbox"/> Both	<input checked="" type="checkbox"/> Occupied <input type="checkbox"/> Unoccupied <input type="checkbox"/> Preservation work in progress <input checked="" type="checkbox"/> In Process <input type="checkbox"/> Being Considered	Yes: <input checked="" type="checkbox"/> Restricted <input type="checkbox"/> Unrestricted <input type="checkbox"/> No

PRESENT USE (Check One or More as Appropriate)

<input type="checkbox"/> Agricultural	<input type="checkbox"/> Government	<input type="checkbox"/> Park	<input type="checkbox"/> Transportation	<input type="checkbox"/> Comments
<input type="checkbox"/> Commercial	<input type="checkbox"/> Industrial	<input type="checkbox"/> Private Residence	<input checked="" type="checkbox"/> Other (Specify)	
<input type="checkbox"/> Educational	<input type="checkbox"/> Military	<input type="checkbox"/> Religious	Fraternal	
<input type="checkbox"/> Entertainment	<input type="checkbox"/> Museum	<input type="checkbox"/> Scientific		

4. OWNER OF PROPERTY

OWNER'S NAME:
Minnehaha Grange No. 398

STREET AND NUMBER:
4801 West 50th Street

CITY OR TOWN:
Edina

STATE: Minnesota	CODE 22
----------------------------	-------------------

5. LOCATION OF LEGAL DESCRIPTION

COURTHOUSE, REGISTRY OF DEEDS, ETC.:
Register of Deeds, Hennepin County Courthouse

STREET AND NUMBER:
5th Street

CITY OR TOWN:
Minneapolis

STATE: Minnesota	CODE 22
----------------------------	-------------------

6. REPRESENTATION IN EXISTING SURVEYS

TITLE OF SURVEY:
None

DATE OF SURVEY:
 Federal State County Local

DEPOSITORY FOR SURVEY RECORDS:

STREET AND NUMBER:

CITY OR TOWN:

STATE:	CODE:
--------	-------

SEE INSTRUCTIONS

STATE: Minnesota	ENTRY NUMBER 70.10.22.0019	DATE 10/9/70
COUNTY: Hennepin	FOR NPS USE ONLY	

7. DESCRIPTION

CONDITION	(Check One)					
	<input type="checkbox"/> Excellent	<input checked="" type="checkbox"/> Good	<input type="checkbox"/> Fair	<input type="checkbox"/> Deteriorated	<input type="checkbox"/> Ruins	<input type="checkbox"/> Unexposed
	(Check One)			(Check One)		
	<input checked="" type="checkbox"/> Altered	<input type="checkbox"/> Unaltered		<input checked="" type="checkbox"/> Moved	<input type="checkbox"/> Original Site	

DESCRIBE THE PRESENT AND ORIGINAL (if known) PHYSICAL APPEARANCE

The Grange Hall is one of the few remaining buildings of this type in the State of Minnesota.

The building is a simple one-story structure (26 ft. x 50 ft.) with a full basement and small balcony (26 ft. x 12 ft.) at the end of the hall.

The original building was one-story with a crawl space. In 1935 the building was moved to a location on Normandale Road (Highway #100) and Eden Avenue. A basement was constructed at that time along with the side and rear entrances.

The foundation of the building on its original site at the southeast corner of West 50th Street and Wooddale Avenue was Minnesota limerock. This material was also used as a facing on the foundation at the Normandale site.

The exterior of the building is lap siding painted white. The front gable of the hall is embellished with a lattice work of wood supported on three wood brackets over the central window. A carved wood moulding flanks the brackets on either side below the lattice work. Unfortunately, much of this work is now covered by a large wood sign on the front of the building. Wood car siding is used diagonally in panels below the balcony windows. This same treatment was also used on the original front entrance door which has been replaced by a later five-panel wood door.

The original front entry shed was removed in 1935 and replaced by a gabled entry porch. The millstones from the old Edina Mill were embedded in the stone sidewalls of this entry porch.

The white wood shutters covering the windows were replaced in 1935 by the present green wood shutters. A wood flagpole extending approximately 12 ft. above the ridge of the roof over the main entrance was removed in 1935. A ground mounted swaged steel pole was installed in front of the building. The base of this pole was cast from concrete using the same forms as used for the balusters of the Third Avenue Bridge in Minneapolis.

The brick chimney was replaced in 1935. The original wood shingle roof has been covered by successive layers of an asphalt roll roofing and asphalt shingles.

The interior walls and ceiling of the main meeting room are of matched pine car siding that has been left unfinished. A low platform extends along both sides of this room and there is a stage across the east end of the hall.

Heating of the Grange Hall was originally by means of two wood-burning stoves in the main meeting room. These are still in place. A warm air furnace was installed in 1935.

Electric lights were installed in 1926. The kerosene chandeliers in the main meeting room were electrified at that time and remain.

SEE INSTRUCTIONS

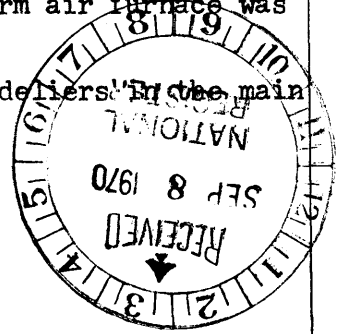

SIGNIFICANCE

PERIOD (Check One or More as Appropriate)

- | | | | |
|--|---------------------------------------|--|---------------------------------------|
| <input type="checkbox"/> Pre-Columbian | <input type="checkbox"/> 16th Century | <input type="checkbox"/> 18th Century | <input type="checkbox"/> 20th Century |
| <input type="checkbox"/> 15th Century | <input type="checkbox"/> 17th Century | <input checked="" type="checkbox"/> 19th Century | |

SPECIFIC DATE(S) (If Applicable and Known) 1879

AREAS OF SIGNIFICANCE (Check One or More as Appropriate)

- | | | | |
|--|--------------------------------------|---|--|
| <input type="checkbox"/> Aboriginal | <input type="checkbox"/> Education | <input type="checkbox"/> Political | <input type="checkbox"/> Urban Planning |
| <input type="checkbox"/> Prehistoric | <input type="checkbox"/> Engineering | <input type="checkbox"/> Religion/Philosophy | <input type="checkbox"/> Other (Specify) |
| <input type="checkbox"/> Historic | <input type="checkbox"/> Industry | <input type="checkbox"/> Science | _____ |
| <input checked="" type="checkbox"/> Agriculture | <input type="checkbox"/> Invention | <input type="checkbox"/> Sculpture | _____ |
| <input checked="" type="checkbox"/> Architecture | <input type="checkbox"/> Landscape | <input checked="" type="checkbox"/> Social/Humanitarian | _____ |
| <input type="checkbox"/> Art | <input type="checkbox"/> Literature | <input type="checkbox"/> Theater | _____ |
| <input type="checkbox"/> Commerce | <input type="checkbox"/> Military | <input type="checkbox"/> Transportation | _____ |
| <input type="checkbox"/> Communications | <input type="checkbox"/> Music | | _____ |
| <input type="checkbox"/> Conservation | | | _____ |

STATEMENT OF SIGNIFICANCE

Minnehaha Grange No. 398 is the oldest subordinate Grange in the State of Minnesota. Organized on December 12, 1873, it is the only subordinate Grange in the State, and one of the few in the United States, to continue actively from the date of its organization to the present.

During the pioneer days of the Village of Edina when the area was wholly agricultural, the Minnehaha Grange was the center of much of the social and civic activity in the community.

The Grange Hall was one of four pioneer buildings erected in the settlement of Edina Mills in the vicinity of Wooddale Avenue and West 50th Street. The Edina Mill or Waterville Mill erected in 1857 was the center of this community. A wagon and blacksmith shop, a country store and the Grange Hall completed the settlement. Of these four buildings only the Grange Hall remains today.

The formative meetings leading to the incorporation of the Village of Edina were held in the Grange Hall. Following incorporation in 1888, the Village of Edina rented the Grange Hall for its Council Meetings, elections and general Village purposes until the first village hall was built.

Members of the Minnehaha Grange were active in State affairs. In 1895 they offered a resolution to the State Legislature "to permit the facilities of the School of Agriculture (University of Minnesota) to be extended for the use of Female students." Other members exerted influence with the National Grange to purchase the farm house of Oliver Hudson Kelley, founder of the Grange, and to restore and refurnish it. In 1962 the home and farm near Elk River were turned over to the Minnesota Historical Society.

In 1935 the ground lease for the property on which the Grange Hall was built expired. The building was moved to Village property on Normandale Road (Highway #100) and Eden Avenue. Highway construction forced relocation of the building again in 1969 when the Grange Hall was moved several hundred feet east to the present site in the Edina Historical Park. Restoration is planned so that the rich heritage of this building and its contents can be preserved and interpreted to future generations.

SEE INSTRUCTIONS



9 MAJOR BIBLIOGRAPHICAL REFERENCES

A History of Minnehaha Grange No. 398, 1963
The Grange Hall, Mrs. Elvira H. Vinson
Excerpts from Minutes of Minnehaha Grange, 1873-1927, Mrs. Elvira H. Vinson
"The Edina Grange and its History", H. W. Heller, The Crier, August 1930, p.8
"Settler Fleeing Indians Used Building on Grange Hall Site", Mrs. E.H. Vinson,
The Crier, December 1934, p. 4.
"Grange Hall to be Historic Spot", The Crier, May 1935, p. 1.
"Old Edina Landmark Moved to New Site, The Crier, March 1935, p. 5.

10 GEOGRAPHICAL DATA

LATITUDE AND LONGITUDE COORDINATES DEFINING A RECTANGLE LOCATING THE PROPERTY			OR	LATITUDE AND LONGITUDE COORDINATES DEFINING THE CENTER POINT OF A PROPERTY OF LESS THAN TEN ACRES		
CORNER	LATITUDE	LONGITUDE		LATITUDE	LONGITUDE	
	Degrees Minutes Seconds	Degrees Minutes Seconds		Degrees Minutes Seconds	Degrees Minutes Seconds	
NW	° ' "	° ' "		44° 54' 46"	109° 21' 1.6"	
NE	° ' "	° ' "				
SE	° ' "	° ' "				
SW	° ' "	° ' "				

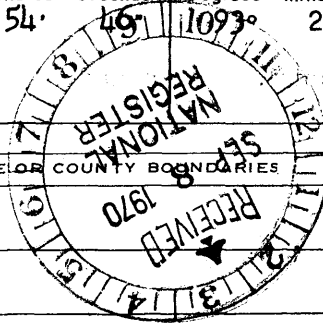

APPROXIMATE ACREAGE OF NOMINATED PROPERTY: 0.619

LIST ALL STATES AND COUNTIES FOR PROPERTIES OVERLAPPING STATE OR COUNTY BOUNDARIES

STATE:	CODE	COUNTY	CODE
STATE:	CODE	COUNTY:	CODE
STATE:	CODE	COUNTY:	CODE
STATE:	CODE	COUNTY:	CODE

11 FORM PREPARED BY

NAME AND TITLE:
Brooks Cavin, A.I.A.

ORGANIZATION: Cavin & Page DATE: July 31, 1970

STREET AND NUMBER:
102 Hubbard Building, 2675 University Avenue

CITY OR TOWN: St. Paul STATE: Minnesota CODE: 22

12 STATE LIAISON OFFICER CERTIFICATION **NATIONAL REGISTER VERIFICATION**

As the designated State Liaison Officer for the National Historic Preservation Act of 1966 (Public Law 89-665), I hereby nominate this property for inclusion in the National Register and certify that it has been evaluated according to the criteria and procedures set forth by the National Park Service. The recommended level of significance of this nomination is:

National State Local

Name: Russell W. Fridley
 Title: Director, Minnesota Historical Society
 Date: _____

I hereby certify that this property is included in the National Register.

Ernest Allen Connolly
 Chief, Office of Archeology and Historic Preservation

OCT 9 1970

Date: _____

ATTEST:
William J. Mustang
 Keeper of The National Register

Date: **OCT 6 1970**

SEE INSTRUCTIONS

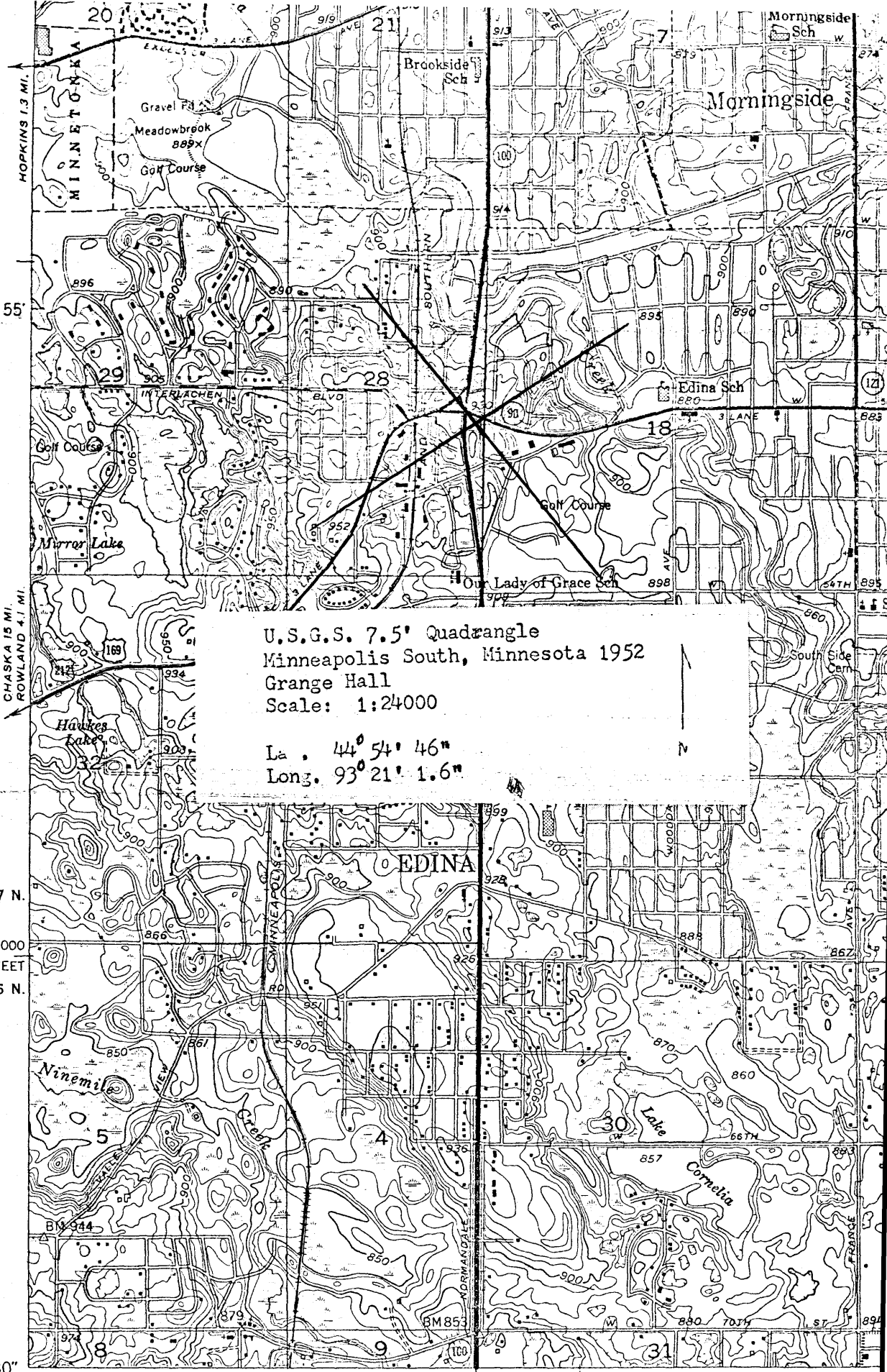

U.S.G.S. 7.5' Quadrangle
 Minneapolis South, Minnesota 1952
 Grange Hall
 Scale: 1:24000

Lat. $44^{\circ} 54' 46''$
 Long. $93^{\circ} 21' 1.6''$

T. 117 N.
 690 000
 FEET
 T. 116 N.

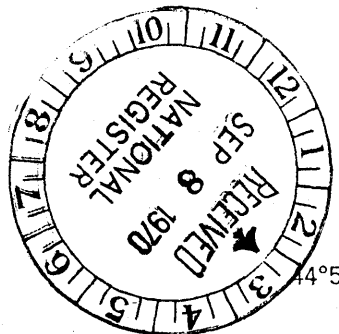

MINNEAPOLIS 1:62,500

$44^{\circ} 52' 30''$ $93^{\circ} 22' 30''$ R. 21 W. 0.9 MI. TO MINN. 5 12 170 000 FEET R. 24 W. 20'

Mapped, edited, and published by the Geological Survey

Control by USGS, USC&GS, and USCE

Topography from aerial photographs by Kelsh plotter
 Aerial photographs taken 1947. Field check 1952

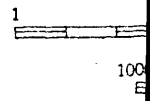

United States Department of the Interior
National Park Service

National Register of Historic Places Continuation Sheet

Section number _____ Page _____

ADDITIONAL INFORMATION

for Keeper Melvin Lyman
1/19/89

United States Department of the Interior
National Park Service

National Register of Historic Places Continuation Sheet

Section number _____ Page _____

**Note: These changes apply to
Grange Hall in Hennepin County,
Minnesota.**

REFERENCE NUMBER: 70000914

STATE: MINNESOTA

COUNTY: Hennepin

RESOURCE NAME (HISTORIC): Minnehaha Grange Hall

CITY:

VICINITY OF:

ADDRESS:

CERTIFICATION DATE:

REMOVED DATE:

COMMENTS:

Nina M. Archabal

Nina M. Archabal
State Historic Preservation Officer

JUN 17 1988

Date