

KENTUCKY HISTORIC RESOURCES INVENTORY

Site No. Gn-16

| | | | |
|---|---|--|--|
| 1. Historic Name(s) Keltner Home (Green County M.R.A.) Original Owner | | 22. ADD/County Lake Cumberland/Green 0 4 4 | |
| 2. Present Name | | 23. U.S.G.S. Quadrant (15'/75') Gresham | |
| 3. Location N. side Ky 1913; 1 m. E of Haskingsville vic, | | 24. UTM Reference Zone Easting Northing | |
| 4. Owner's Name James E. Keltner | | 25. Coordinate Accuracy | |
| 5. Owner's Address Route 5, Greensburg, Ky. 42743 | | 26. Prehistoric Site Object Historic Site Structure Building <u> </u> Other <u> </u> | |
| 6. Open to Public Yes <u> </u> No <input checked="" type="checkbox"/> | 7. Visible from road Yes <input checked="" type="checkbox"/> No <u> </u> | 8. Ownership Private <input checked="" type="checkbox"/> Local <u> </u> State <u> </u> Federal <u> </u> | |
| 9. Local Contact/Organization | | 27. National Register District Name: | |
| 10. Site Plan with North Arrow <p style="text-align: center; font-weight: bold;">See attached.</p> | | 28. Significance Evaluation Eligible for NR B | |
| 11. Architect | | 29. Status Date | |
| 12. Builder | | National Landmark <u> </u> National Register <u> </u> Landmark Certificate <u> </u> Kentucky Survey <input checked="" type="checkbox"/> 8-15-80 Local Landmark <u> </u> HABS/HAER <u> </u> | |
| 13. Date 1826-1850 A. 3 B. <u> </u> | | 30. Historic Theme Primary architecture C Secondary <u> </u> Other <u> </u> | |
| 14. Style A. Federal B B. <u> </u> | | 31. Endangered Yes <u> </u> No <input checked="" type="checkbox"/> | |
| 15. Original Use Sing. Fam. Res. A | | 32. Preservation Project Status | |
| 16. Present use same | | Actual Cost in \$1,000s | |
| 17. Condition excellent A | | 33. ATTACH PHOTO | |
| 18. Description 1-story, 5 bay frame; central passage plan; exterior end chimneys; original 2 tiered portico on square piers rises through cornice to gable-dormer; upper level of portico, now enclosed, entered from door at landing of square, open-well staircase; portico originally balustraded at both levels; chairrails throughout; W (Continue on Back) (OVER) | | Roll No. <u>13</u> Picture No. <u> </u> Direction <u> </u> | |
| 19. History | | 34. Prepared by: Joe DeSpain | |
| 20. Significance Architecture: the house is one of the best examples of the stylistic transition between Federal and Greek Revival styles in the county. | | 35. Organization Green Co. Historical Soc., Inc. | |
| 21. Source of Information | | 36. Date <u>1984</u> | |
| 22. | | 37. Revision Dates 38. Staff Review | |

W. State of Illinois

James E. Walker

Louis E. Greenbaum, No. 42343

18. Description (cont.)

mantel Federal w/colonettes - E mantel an eccentric design; detached frame kitchen originally sep. by breezeway, now connected to house and surrounded by additions.

Visible for

08-7-8

1870-1880

See attached.

Federal

Architects

John W. ...

1870

excellent

... of square, ... through cornice ...

... of square, ... through cornice ...

John W. ...

... of the ...

KENTUCKY HISTORIC RESOURCE INVENTORY SUPPLEMENT
BOUNDARY AND LOCATION INFORMATION

Historic Property Name Keltner Home Site # GN-16

Multiple Resource/Thematic Nomination Title Green County

U.T.M. Coordinates - List multiple UTMs if property is ten or more acres.

A. 16 643940 4117410 D. _____

B. _____ E. _____

C. _____ F. _____

Verbal Boundary Description Acreage .35 ACRES

Beginning at point A on the N side of Hwy 1913, in line with a fence running N-S, 60' from the SE corner of the house; thence along said fence N 160' to point B; thence W along a fence 30' N of the house and an imaginary line created by the extension of said fence to point C 100'; thence S 160' along the W edge of a road or driveway to the house to point D on the N edge of Hwy 1913; thence along said Hwy. to the beginning.

Sketch of Site Plan (Showing outbuildings, structures, landscape features and the site boundary as described above.)

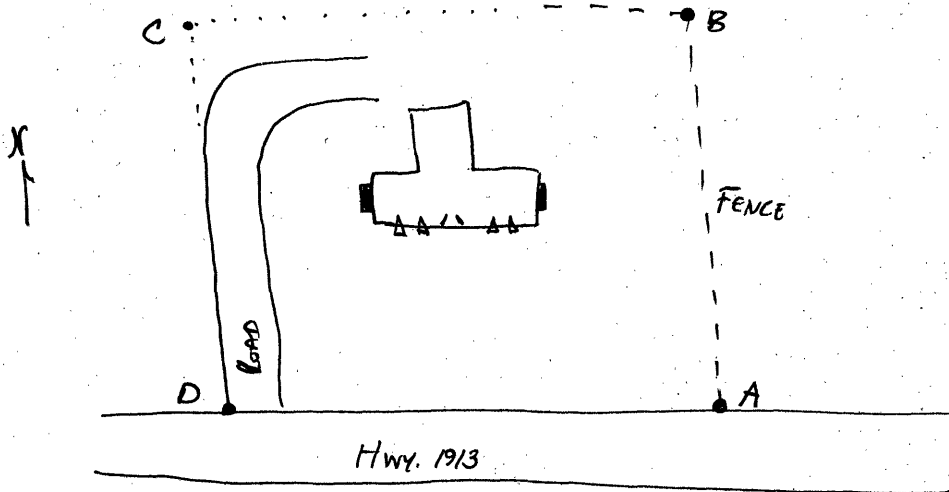

Official Courthouse Property Reference: