

United States Department of the Interior
National Park Service

RECEIVED

JUL 26 1988

National Register of Historic Places
Registration Form

NATIONAL
REGISTER

This form is for use in nominating or requesting determinations of eligibility for individual properties or districts. See instructions in *Guidelines for Completing National Register Forms* (National Register Bulletin 16). Complete each item by marking "x" in the appropriate box or by entering the requested information. If an item does not apply to the property being documented, enter "N/A" for "not applicable." For functions, styles, materials, and areas of significance, enter only the categories and subcategories listed in the instructions. For additional space use continuation sheets (Form 10-900a). Type all entries.

1. Name of Property

historic name New Market Presbyterian Church
other names/site number NA

2. Location

street & number 1723 New Market Road NA not for publication
city, town New Market NA vicinity
state Alabama code AL county Madison code 089 zip code 35761

3. Classification

Ownership of Property	Category of Property	Number of Resources within Property	
<input checked="" type="checkbox"/> private	<input checked="" type="checkbox"/> building(s)	Contributing	Noncontributing
<input type="checkbox"/> public-local	<input type="checkbox"/> district	<u>1</u>	<u>1</u> buildings
<input type="checkbox"/> public-State	<input type="checkbox"/> site	_____	_____ sites
<input type="checkbox"/> public-Federal	<input type="checkbox"/> structure	_____	_____ structures
	<input type="checkbox"/> object	_____	_____ objects
		<u>1</u>	<u>1</u> Total

Name of related multiple property listing: NA
Number of contributing resources previously listed in the National Register NA

4. State/Federal Agency Certification

As the designated authority under the National Historic Preservation Act of 1966, as amended, I hereby certify that this nomination request for determination of eligibility meets the documentation standards for registering properties in the National Register of Historic Places and meets the procedural and professional requirements set forth in 36 CFR Part 60. In my opinion, the property meets does not meet the National Register criteria. See continuation sheet.
Signature of certifying official [Signature] Date July 21, 1988
Alabama Historical Commission (State Historic Preservation Office)
State or Federal agency and bureau

In my opinion, the property meets does not meet the National Register criteria. See continuation sheet.
Signature of commenting or other official _____ Date _____
State or Federal agency and bureau _____

5. National Park Service Certification

I, hereby, certify that this property is:
 entered in the National Register. See continuation sheet.
 determined eligible for the National Register. See continuation sheet.
 determined not eligible for the National Register.
 removed from the National Register.
 other, (explain:) _____

[Signature] 8/25/88

Signature of the Keeper Date of Action

6. Function or Use

Historic Functions (enter categories from instructions)

Religious structure

Current Functions (enter categories from instructions)

Religious structure

7. Description

Architectural Classification

(enter categories from instructions)

Late Gothic Revival

Materials (enter categories from instructions)

foundation brick

walls weatherboard

roof tin

other

Describe present and historic physical appearance.

One-story, clapboarded, fish-scale shingle gabled, rectangular rural late Gothic Revival church building with six lancet side windows and lancet-toplighted double entrance doors. Small semi-octagonal projection for Chancel. No entry porch. Small narthex. Nave with decorative-pattern barrel-vaulted wood ceiling in seven radial planes. Crawl space under floor enlarged for classrooms in 1947 abandoned in 1966 upon construction of an adjacent classroom and social function structure.

The building is in near-original condition, including the clear cylinder-glass of the lancet windows. The wooden flooring was covered in circa 1980 with new 5-inch planks. The Gothic style pews are about 1920's vintage and were originally in the Maysville, Alabama, Presbyterian Church. The suspended brick stove flue in the center of the middle aisle was removed in circa 1980 when concealed central heating and cooling was installed, utilizing the later basement space for ducts and equipment.

The decorative seven-plane barrel-vaulted wooden ceiling, said to be a gift from the contractor, consists of narrow (double-beaded) boards in large half-bond rectangles divided by wide borders of the same material in herringbone and "soldier" patterns. The rectangles conform to the seven radial planes of the ceiling. This wood, like all the other interior wood, is natural in finish and is varnished.

The Nave walls are painted plaster, above a chair-rail and dado of the same material and finish as the ceiling. The window frames are varnished. The tall, narrow sashes are painted and tilt at mid-stile pivots for ventilation.

At the Chancel, the decorative patterns of the double-beaded boards is quite elaborate, with the chair-rail raking up and around the Chancel walls to provide emphasis to the Gothic-style wooden pulpit, which is thought to be original. Nine scroll-sawn pendils drop from the crown of the paneled Chancel walls, and a Gothic three-sided plastered vault tops the rear of the Chancel.

The small narthex is 8-sided and has decorative wood walls and ceilings similar to the Nave. Two small rooms, whose original purpose is unknown, open off the Narthex. The 5 door-openings are topped with lancet transoms.

There is a noncontributing education building built in 1966 east of the sanctuary.

See continuation sheet

8. Statement of Significance

Certifying official has considered the significance of this property in relation to other properties:

nationally statewide locally

Applicable National Register Criteria A B C D

Criteria Considerations (Exceptions) A B C D E F G

Areas of Significance (enter categories from instructions)
Architecture

Period of Significance
1888

Significant Dates
1888

Cultural Affiliation
NA

Significant Person
NA

Architect/Builder
Lem Teague, builder

State significance of property, and justify criteria, criteria considerations, and areas and periods of significance noted above.

This structure is an excellent and little-altered example of a rapidly vanishing type in north Alabama; the small clapboarded rural Gothic Revival late-19th-century church building. Built in 1888 by Lem Teague, a member of this church, this is the oldest surviving essentially intact religious structure in northeast Madison County. The design reflects the unpretentious but solid dignity that might be expected of a late 19th-century rural Presbyterian congregation. The lancet openings and high, steep roof are the exterior features which indicate that the effect desired was simplicity rather than parsimony. Inside, the high segmental barrel-vaulted ceiling sheathed in diagonal and square patterns of varnished woodwork impart a feeling of spare good quality to the nave.

9. Major Bibliographical References

The New Market Presbyterian Church U.S.A. Committee. "History of New Market." pp. 18,20-23,27-28,36-37.

Norris, Dr. George and Dr. Francisco Rice. History of New Market. Reprinted by New Market Presbyterian Church U.S.A. pp. 17-18.

Volunteer Fire Department. "Memories and History of New Market, Alabama." pp. 36-42.

Statement by Mr. Calvin Davis on a loose sheet found in Church Session Record Book beginning in 1893. Book is in possession of Mrs. Robert Davis, New Market, Alabama 35761.

Previous documentation on file (NPS):

- preliminary determination of individual listing (36 CFR 67) has been requested
- previously listed in the National Register
- previously determined eligible by the National Register
- designated a National Historic Landmark
- recorded by Historic American Buildings Survey # _____
- recorded by Historic American Engineering Record # _____

See continuation sheet

Primary location of additional data:

- State historic preservation office
- Other State agency
- Federal agency
- Local government
- University
- Other

Specify repository: _____

10. Geographical Data

Acreage of property 0.63 acres

UTM References

A

1	6	5	5	2	1	3	0
---	---	---	---	---	---	---	---

3	8	6	3	0	3	0
---	---	---	---	---	---	---

Zone Easting Northing

B

--	--	--	--	--	--	--

--	--	--	--	--	--	--

Zone Easting Northing

C

--	--	--	--	--	--	--

--	--	--	--	--	--	--

D

--	--	--	--	--	--	--

--	--	--	--	--	--	--

See continuation sheet

Verbal Boundary Description

166 ft. east & west, fronting on New Market Road along the South frontage. 164 ft. north & south along Depot Street on the west of Church Street on the east boundary. Adjoins residential property to the north. See line drawn on attached base map.

See continuation sheet

Boundary Justification

The boundary described above is the entire property owned by the New Market Presbyterian Church

See continuation sheet

11. Form Prepared By

name/title Harvie P. Jones, F.A.I.A. date 13 January, 1988
 organization Historic Huntsville Foundation telephone (205) 539-0765
 street & number 104 Jefferson Street city or town Huntsville state AL zip code 35801

United States Department of the Interior
National Park Service

National Register of Historic Places
Continuation Sheet

Section number photo-
graphs Page 1

No. 1 - Information in items 1-5 is the same
for nos. 1-13

- 1) New Market Presbyterian Church
- 2) New Market, Alabama
- 3) Mrs. Howard C. Jones, Jr.
- 4) June 1986
- 5) Photographer's residence
- 6) South front
- 7) Photo number 1

No. 2

- 6) South front entry
- 7) Photo number 2

No. 3

- 6) West side. Chancel projection at left
(north end)
- 7) Photo number 3

No. 4

- 6) Typical nave window (west side),
exterior view
- 7) Photo number 4

No. 5

- 6) Typical nave window (west side), interior view
- 7) Photo number 5

No. 6

- 6) Chancel (north end)
- 7) Photo number 6

No. 7

- 6) Chancel and pulpit
- 7) Photo number 7

No. 8

- 6) Chancel, lampstand at left
- 7) Photo number 8

No. 9

- 6) Choir benches, north at right. These choir
benches are believed to be original.
- 7) Photo number 9

No. 10

- 6) Segmented barrel-vault ceiling
in double-beaded board pattern
- 7) Photo number 10

No. 11

- 6) Close-up: segmented barrel-
vault ceiling in double-beaded
board pattern
- 7) Photo number 11

No. 12

- 6) Pews (not original) and c. 1970
wood flooring over original wood
flooring
- 7) Photo number 12

No. 13

- 6) Narthex, looking east (entry
doors at right)
- 7) Photo number 13

RESIDENTIAL AREA

166'

164'

ST.

DEPOT

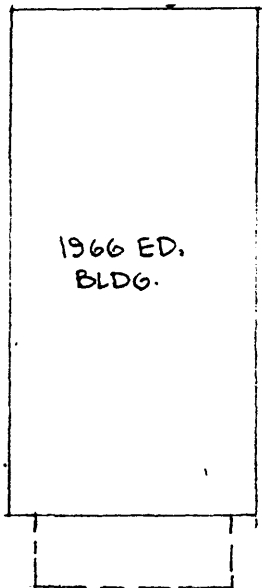
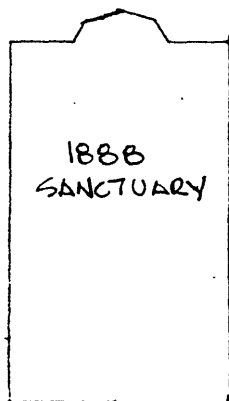

CHURCH ST.

NEW MARKET ROAD



SKETCH SITE PLAN
NEW MARKET PRESBYTERIAN CHURCH
NEW MARKET, AL
1" = 30' APPROX. 9 JAN. 1988
HARVEY P. JONES, F.A.I.A.

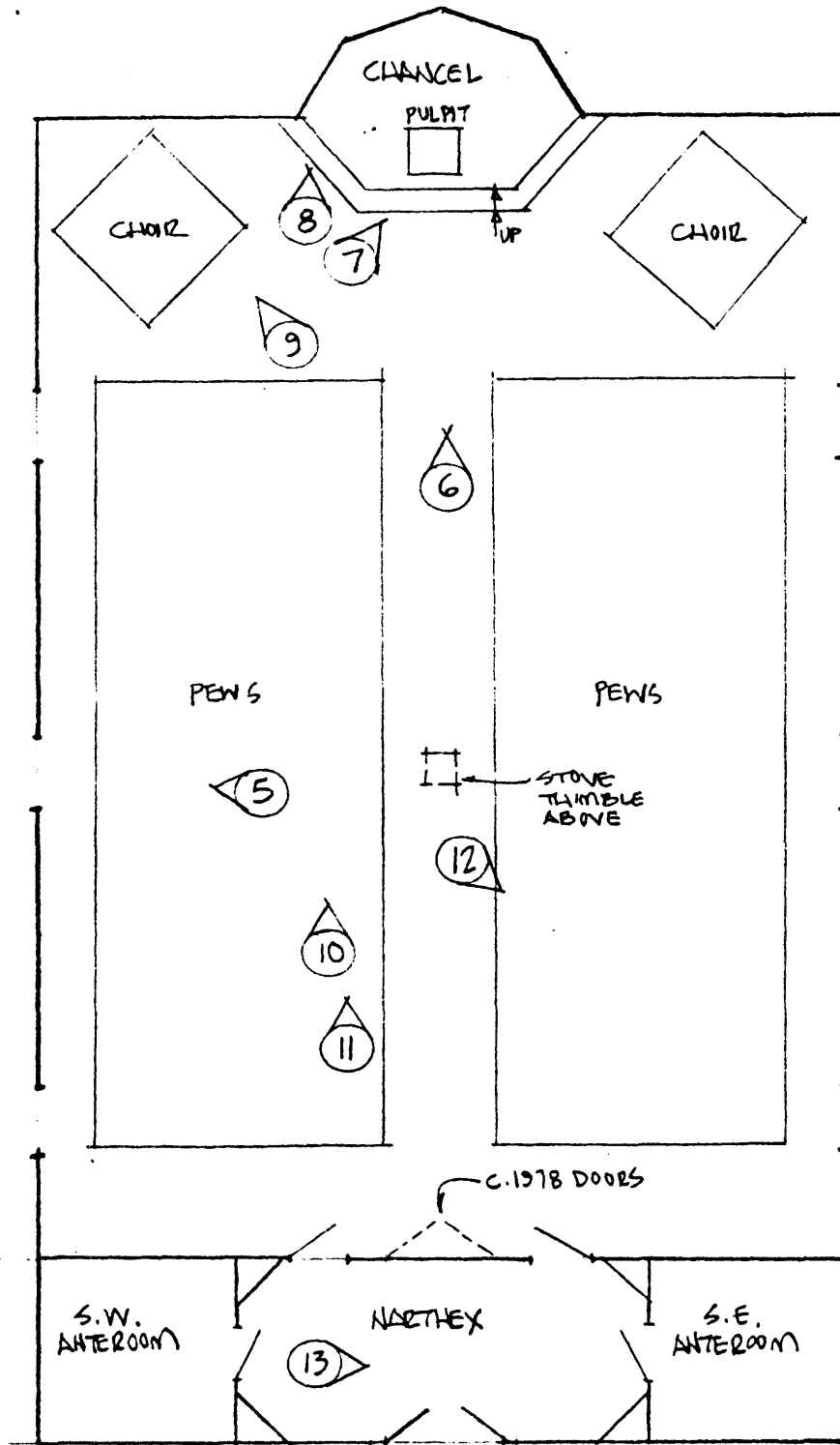

APPROX.
35' x 55'-9"
(OWNER'S MEAS.)

0 5 10 15 20
SCALE IN FEET (APPROX.)

NEW MARKET (AL.)
PRESBYTERIAN CHURCH
1888

SKETCH MAIN FL. PLAN
(LATER BASEMENT BELOW)

HARVIE P. JONES, F.A.I.A.

NEW MARKET RD.

