

5. Classification

Ownership of Property
(Check as many boxes as apply)

- private
- public - Local
- public - State
- public - Federal

Category of Property
(Check only one box)

- building(s)
- district
- site
- structure
- object

Number of Resources within Property
(Do not include previously listed resources in the count.)

Contributing	Noncontributing	
2	0	buildings
		district
		site
		structure
		object
2	0	Total

Name of related multiple property listing
(Enter "N/A" if property is not part of a multiple property listing)

Late 19th/Early 20th Century Development & Architecture in Pasadena

Number of contributing resources previously listed in the National Register

0

6. Function or Use

Historic Functions
(Enter categories from instructions)

DOMESTIC/Single Dwelling

Current Functions
(Enter categories from instructions)

DOMESTIC/Single Dwelling

7. Description

Architectural Classification
(Enter categories from instructions)

LATE VICTORIAN/Shingle Style

Materials
(Enter categories from instructions)

foundation: CONCRETE

walls: WOOD

roof: ASPHALT

other: _____

Narrative Description

Summary Paragraph

This two-and-one-half story, 4,648 square-foot Shingle Style house was designed by architect Joseph J. Blick and built in 1903. The flat site is on the east side of South Grand Avenue between Arbor Street and Locke Haven Street, in a neighborhood of large, stately single-family houses on large lots. The house, at the front of the lot, is set back approximately 60 feet from the sidewalk, similar to other houses on the street. A detached one-and-one-half story garage, originally built as a carriage house, is at the rear of the property, and is a contributing feature. A concrete driveway in the north side yard connects the rear yard with the garage to the street.

Narrative Description

The two-and-one-half story Shingle Style house has an irregular plan and a shallowly sloped cross-gabled roof. Gable ends have no eaves, but the eaves on the sides of the gables are deep and have exposed rafters with rounded ends. Attached to the north end of the west (street-facing) elevation is a two-story flat-roofed polygonal bay. To the south of the bay is a partial-width front porch with a shed roof where it connects to the bay and a hipped roof at the opposite end supported by heavy square posts topped with four stylized and elongated brackets, an Arts and Crafts feature, one on each side of each post. The porch is bordered by a simple wood railing which extends to the concrete stairs and ends in newel posts. The attic window of the front elevation has a horizontal grouping of four recessed windows set between curved walls. The house has a composition shingle roof; walls clad in rectangular wood shingles; a brick foundation; wood casement and double-hung windows, many grouped in twos, threes or fours, as well as fixed-pane windows in wood-framed openings; and a wide wood front door with multi-pane lights in a wood-framed opening. The north elevation has a projecting rectangular shed roof bay and, separately, a rectangular oriel with corbels below.

To the rear of the house is a carriage house, now on a separate legal lot with an address of 358 S. Grand Avenue, with a rectangular plan, a steeply sloped hipped roof with a central projecting gable, multi-light windows and walls clad in rectangular wood shingles. The gable end has a hayloft door with a divided light transom and a projecting arm at the peak. City assessor's records indicate that the carriage house may predate the main house, with an estimated (but unverified) construction date of 1898.

A small addition at the rear of the house was constructed in 2001. The porch railing has also been replaced; photographs in city files from 1986 depict a more open railing with cross-diagonals and, at the stairs, a top and bottom rail only (also likely non-original). The carriage house has new doors with a large horizontally oriented multi-light window at the top that are compatible in design to the house.

8. Statement of Significance

Applicable National Register Criteria

(Mark "x" in one or more boxes for the criteria qualifying the property for National Register listing)

- A Property is associated with events that have made a significant contribution to the broad patterns of our history.
- B Property is associated with the lives of persons significant in our past.
- C Property embodies the distinctive characteristics of a type, period, or method of construction or represents the work of a master, or possesses high artistic values, or represents a significant and distinguishable entity whose components lack individual distinction.
- D Property has yielded, or is likely to yield, information important in prehistory or history.

Areas of Significance

(Enter categories from instructions)

ARCHITECTURE

Period of Significance

1898 - 1903

Significant Dates

1898 – carriage house construction

1903 – house construction

Criteria Considerations

(Mark "x" in all the boxes that apply)

Property is:

- A Owned by a religious institution or used for religious purposes.
- B removed from its original location.
- C a birthplace or grave.
- D a cemetery.
- E a reconstructed building, object, or structure.
- F a commemorative property.
- G less than 50 years old or achieving significance within the past 50 years.

Significant Person

(Complete only if Criterion B is marked above)

N/A

Cultural Affiliation

N/A

Architect/Builder

Blick, Joseph J. (architect)

Period of Significance (justification)

The house at 360 S. Grand Avenue was constructed in 1903. The carriage house was built in 1898.

Criteria Considerations (explanation, if necessary)

N/A

Statement of Significance Summary Paragraph

The George Post House, built in 1903, is a locally significant example of the Shingle Style subtype of the single-family residence property type identified in the Multiple Property Documentation Form "Late 19th/Early 20th Century Development and Architecture in Pasadena." It meets registration requirements listed in the Multiple Property Documentation Form under National Register Criterion C as a notable example of the Shingle Style subtype of the single-family residence property type. The house is also an important example of the work of a prominent local architect, Joseph J. Blick.

Narrative Statement of Significance

The George Post House is locally significant under Criterion C. Under this criterion, the house is a notable example of the Shingle Style subtype of the single-family residence property type identified in the Multiple Property Documentation Form "Late 19th/Early 20th Century Development and Architecture in Pasadena," designed by Pasadena architect Joseph J. Blick. The house exhibits elements of the Shingle Style subtype including two-story height; irregular plan; asymmetrical facades; multi-gabled roofs with a low, broad pitch and no eaves; wood shingle siding; tripartite, bay and double-hung windows with small panes; and inset windows with curved jambs. The house also exhibits features of the two-story Arts and Crafts period house property type identified in the Multiple Property Documentation Form, "Residential Architecture of Pasadena, CA 1895-1918: Influence of the Arts and Crafts Movement" in portions of the roof with deep overhanging eaves and in the large support brackets under the porch roof. It has a high level of architectural integrity through its location, design, setting, materials, and workmanship and feeling. It is in its original location, which is identified in the MPDF as an area with a high concentration of Shingle Style houses, and retains original materials and a carriage house that dates from the late 19th century period. The elements and proportions of the house that represent its design are intact as are the materials used in its original construction. The house exhibits evidence of techniques employed in residential construction in the late 19th century in Pasadena and clearly expresses the historic sense of this time period as designs began to transition to those of the American Arts and Crafts movement.

The alterations are relatively minor and do not adversely impact the overall integrity of the house. The house possesses the essential character-defining features of the Shingle Style subtype including roof form, wall materials, fenestration and decorative detailing.

Joseph J. Blick's career is described in detail in the Multiple Property Documentation Form. He worked in multiple architectural styles and the George Post house is one of his master works of domestic architecture and is one of his earliest extant works. Other later works by Blick include the Star-News Building, the Hall of Justice, the Scottish Rite Cathedral and the Standard Fireproof Storage Company (which has since been substantially altered).

Developmental history/additional historic context information (if appropriate)

N/A – Historic context documented in Multiple Property Documentation Form "Late 19th/Early 20th Century Development and Architecture in Pasadena."

9. Major Bibliographical References

Bibliography

Permit research materials and assessor's records in files, Planning Department, City of Pasadena (referenced in August 2010).

Previous documentation on file (NPS):

preliminary determination of individual listing (36 CFR 67 has been Requested)
 previously listed in the National Register
 previously determined eligible by the National Register
 designated a National Historic Landmark
 recorded by Historic American Buildings Survey # _____
 recorded by Historic American Engineering Record # _____

Primary location of additional data:

State Historic Preservation Office
 Other State agency
 Federal agency
 Local government
 University
 Other
Name of repository: _____

Historic Resources Survey Number (if assigned): N/A

10. Geographical Data

Acreege of Property 0.49

UTM References

(Place additional UTM references on a continuation sheet)

1 11 393020 3778010
Zone Easting Northing

3 _____
Zone Easting Northing

2 _____
Zone Easting Northing

4 _____
Zone Easting Northing

Verbal Boundary Description (describe the boundaries of the property)

The property is bound by South Grand Avenue on the west and property lines of 358 & 360 South Grand Avenue (the rear carriage house is on a separate parcel with the 358 address number) on the east, north and south. The Los Angeles County Assessor's Parcel Numbers for the property are 5714-006-013 & 5714-006-003 and the boundaries are depicted on the attached map.

Boundary Justification (explain why the boundaries were selected)

The boundaries were selected because they encompass the extent of resources associated with the George B. Post House.

11. Form Prepared By

name/title Kevin Johnson, Planner
organization City of Pasadena date August 30, 2010
street & number 175 N. Garfield Avenue telephone 626-744-7806
city or town Pasadena state CA zip code 91101
e-mail kevinjohnson@cityofpasadena.net

Additional Documentation

Submit the following items with the completed form:

- **Maps:** A **USGS map** (7.5 or 15 minute series) indicating the property's location.
A **Sketch map:** "Proposed Individual Houses in Southwest Pasadena"

George B. Post House
Name of Property

Los Angeles County, CA
County and State

Photographs:

The following is the same for all photographs:

Name of Property: George B. Post House
City: Pasadena
County: Los Angeles
State: California
Name of Photographer: Kevin Johnson
Location of Original Digital Files: 175 N. Garfield Avenue, Pasadena, CA 91101

1. Looking east, December 2009
2. Bay detail, looking east, August 2010
3. Entry and porch detail, looking east, August 2010
4. Side elevation looking southeast, August 2010
5. Carriage house, looking east, August 2010

Property Owner:

name Boland & Margaret Morrow
street & number 360 S. Grand Avenue telephone 213-220-6177
city or town Pasadena state CA zip code 91105

Paperwork Reduction Act Statement: This information is being collected for applications to the National Register of Historic Places to nominate properties for listing or determine eligibility for listing, to list properties, and to amend existing listings. Response to this request is required to obtain a benefit in accordance with the National Historic Preservation Act, as amended (16 U.S.C.460 et seq.).
Estimated Burden Statement: Public reporting burden for this form is estimated to average 18 hours per response including time for reviewing instructions, gathering and maintaining data, and completing and reviewing the form. Direct comments regarding this burden estimate or any aspect of this form to the Office of Planning and Performance Management, U.S. Dept. of the Interior, 1849 C. Street, NW, Washington, DC.

SKETCH MAP

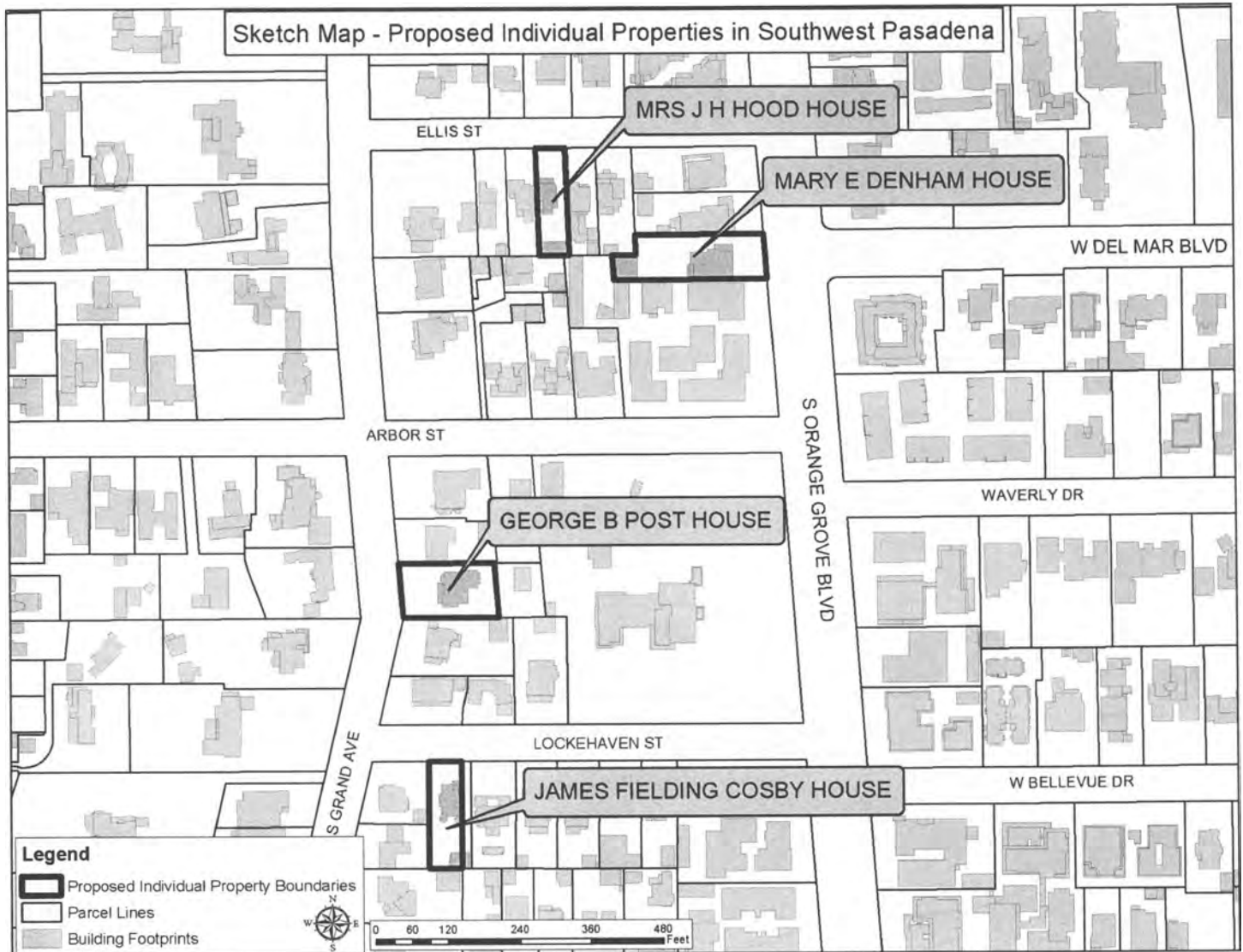

UNITED STATES DEPARTMENT OF THE INTERIOR
NATIONAL PARK SERVICE

NATIONAL REGISTER OF HISTORIC PLACES
EVALUATION/RETURN SHEET

REQUESTED ACTION: NOMINATION

PROPERTY Post, George B., House
NAME:

MULTIPLE Late 19th and Early 20th Century Development and Architectur
NAME: e in Pasadena MPS

STATE & COUNTY: CALIFORNIA, Los Angeles

DATE RECEIVED: 6/24/11 DATE OF PENDING LIST: 7/20/11
DATE OF 16TH DAY: 8/04/11 DATE OF 45TH DAY: 8/09/11
DATE OF WEEKLY LIST:

REFERENCE NUMBER: 11000499

REASONS FOR REVIEW:

APPEAL: N DATA PROBLEM: N LANDSCAPE: N LESS THAN 50 YEARS: N
OTHER: N PDIL: N PERIOD: N PROGRAM UNAPPROVED: N
REQUEST: Y SAMPLE: N SLR DRAFT: N NATIONAL: N

COMMENT WAIVER: N

___ACCEPT ___RETURN ___REJECT _____DATE

ABSTRACT/SUMMARY COMMENTS:

The George B. Post House is locally significant under National Register Criterion C (Architecture). Completed in 1903, the handsome residence is an exceptional local example of Shingle-style residential design by the prominent Pasadena architect, Joseph Blick. The home's overall architectural character can be seen as a transitional form for the locally distinctive Arts & Crafts movement.

RECOM./CRITERIA Accept Criterion C

REVIEWER Paul R. Lusignea DISCIPLINE HISTORIAN

TELEPHONE _____ DATE 8/9/11

DOCUMENTATION see attached comments Y/N see attached SLR Y/N

If a nomination is returned to the nominating authority, the nomination is no longer under consideration by the NPS.

George B. Post House
Pasadena, Los Angeles County, CA



CA_Los Angeles County_George B Post
House_0001



CA_Los Angeles County_George B Post
House_0002

**George B. Post House
Pasadena, Los Angeles County, CA**



**CA_Los Angeles County_George B Post
House_0003**



**CA_Los Angeles County_George B Post
House_0004**

George B. Post House
Pasadena, Los Angeles County, CA



CA_Los Angeles County_George B Post
House_0005

Please refer to the map in the
Multiple Property Cover Sheet
for this property

Multiple Property Cover Sheet Reference Number: 64501116

**OFFICE OF HISTORIC PRESERVATION
DEPARTMENT OF PARKS AND RECREATION**

1725 23rd Street Suite 100
SACRAMENTO, CA 94296-0001
(916) 445-7000 Fax: (916) 445-7053
calshpo@ohp.parks.ca.gov

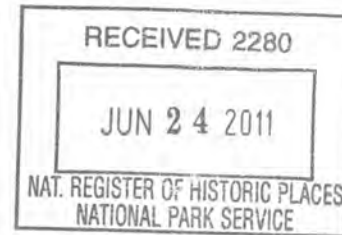

June 21, 2011

Ms. Carol Shull, Keeper
National Register of Historic Places
National Park Service 2280
1201 I (Eye) Street, NW
Washington, DC 20005

Subject: **Late 19th and Early 20th Century Development and Architecture in Pasadena National Register of Historic Places Multiple Property Documentation Form and Nominations**

Dear Ms. Shull:

Enclosed please find the **Late 19th and Early 20th Century Development and Architecture in Pasadena** multiple property documentation form (MPD), and National Register nominations for twelve properties submitted under cover of the MPD. On May 19, 2011, at its regular quarterly meeting, the California State Historical Resources Commission unanimously approved the MPD and the following nominations:

**Mrs. J. H. Hood House
John S. Hartwell House
House at 1360 Lida Street
George B. Post House
Benjamin Jarvis House
New Fair Oaks Historic District**

**Mary E. Denham House
James Fielding Cosby House
Hillmont
Friend Lacey House
Raymond-Summit Historic District
Bristol-Cypress Historic District**

The City of Pasadena is a Certified Local Government (CLG) and also the applicant. The MPD and district nominations were prepared with the assistance of a CLG grant from the California State Historic Preservation Office. Notably, the Historic Preservation Office received no letters of objection for these nominations.

If you have questions regarding this nomination, please contact Jay Correia of my staff at 916-445-7008 or jcorr@parks.ca.gov.

Sincerely,

 Milford Wayne Donaldson

Milford Wayne Donaldson, FAIA
State Historic Preservation Officer

Enclosures