

**United States Department of the Interior  
Heritage Conservation and Recreation Service**

**National Register of Historic Places  
Inventory—Nomination Form**

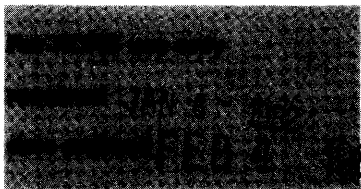

82

See instructions in *How to Complete National Register Forms*

Type all entries—complete applicable sections

**1. Name**

historic Marshall's Grove

and/or common

**2. Location**

AL 22

street & number State Highway 22, 2.5 miles north of intersection of Highway 80 not for publication

city, town Selma vic.  vicinity of congressional district 7th

state Alabama code 01 county Dallas code 047

**3. Classification**

<b>Category</b>	<b>Ownership</b>	<b>Status</b>	<b>Present Use</b>
<input type="checkbox"/> district	<input type="checkbox"/> public	<input checked="" type="checkbox"/> occupied	<input type="checkbox"/> agriculture
<input type="checkbox"/> building(s)	<input checked="" type="checkbox"/> private	<input type="checkbox"/> unoccupied	<input type="checkbox"/> commercial
<input checked="" type="checkbox"/> structure	<input type="checkbox"/> both	<input type="checkbox"/> work in progress	<input type="checkbox"/> educational
<input type="checkbox"/> site	<b>Public Acquisition</b>	<b>Accessible</b>	<input type="checkbox"/> entertainment
<input type="checkbox"/> object	<input type="checkbox"/> in process	<input type="checkbox"/> yes: restricted	<input type="checkbox"/> government
	<input type="checkbox"/> being considered	<input checked="" type="checkbox"/> yes: unrestricted	<input type="checkbox"/> industrial
		<input type="checkbox"/> no	<input type="checkbox"/> military
			<input type="checkbox"/> museum
			<input type="checkbox"/> park
			<input checked="" type="checkbox"/> private residence
			<input type="checkbox"/> religious
			<input type="checkbox"/> scientific
			<input type="checkbox"/> transportation
			<input type="checkbox"/> other:

**4. Owner of Property**

name Mrs. Seleta Llewellyn

street & number Route 4, Box 3

city, town Selma  vicinity of state Alabama

**5. Location of Legal Description**

courthouse, registry of deeds, etc. Dallas County Courthouse

street & number 105 Lauderdale Street

city, town Selma state Alabama

**6. Representation in Existing Surveys**

An Inventory of the Historic Resources of Dallas County, AL Nicholas Holmes, Architect,  
title Nancy N. Holmes, Preservation Con. has this property been determined eligible?  yes  no

date 1979  federal  state  county  local

depository for survey records Selma-Dallas County Historic Preservation Society

city, town 719 Tremont Street Selma state Alabama

---

## 7. Description

---

**Condition**

excellent  
 good  
 fair

deteriorated  
 ruins  
 unexposed

**Check one**

unaltered  
 altered

**Check one**

original site  
 moved date \_\_\_\_\_

---

**Describe the present and original (if known) physical appearance**

The two-story Federal style frame dwelling is located on a knoll, on the west side of a ridge road, now State Highway 22. Mature cedar trees and crepe myrtle bushes screen the house from the road. The house was built in two stages. In 1840 a downstairs room surrounded by porches with a second story room above was built from logs floated down river from Wetumpka and split and hand adzed on the site. In 1842, the front section of two rooms below and two above, forming a T, was completed. The two parts were connected by a breezeway, now enclosed.

The five bay facade has clapboard siding except in the center by where shiplapped siding is used. Here a two level pedimented portico projects from the main block. The gable roof is seamed metal with exterior chimneys on each end of the T,

Square pilasters define the entrance bay, and the pediment is supported by round columns with Doric capitals on both levels. A simple wooden rail, Federal in style, encloses the porches. The replacements steps and porch floor are brick. The single entrance door is set in moulded trim with bullseye corner blocks. The four pane sidelights rest on a paneled spandrel and the transom is of an intercepted multi-pane pattern. The same form is repeated in the opening onto the second level porch,

The windows have six over nine or six over six lites. The facade windows are framed by louvered shutters.

The interior retains the original grained paneled wainscoating and doors, and Federal-style mantels. The walls are horizontal random width painted boards..

A narrow stair to the left of the entrance is contained in the wall which divides the two downstairs rooms of the front section.

The stair in the rear section rise from the front right corner of this earlier portion of the structure.

The detached kitchen is a reproduction of the original one that was located further from the house. A smokehouse in the backyard is yet to be restored.

# 8. Significance

Period	Areas of Significance—Check and justify below			
<input type="checkbox"/> prehistoric	<input type="checkbox"/> archeology-prehistoric	<input type="checkbox"/> community planning	<input type="checkbox"/> landscape architecture	<input type="checkbox"/> religion
<input type="checkbox"/> 1400-1499	<input type="checkbox"/> archeology-historic	<input type="checkbox"/> conservation	<input type="checkbox"/> law	<input type="checkbox"/> science
<input type="checkbox"/> 1500-1599	<input type="checkbox"/> agriculture	<input type="checkbox"/> economics	<input type="checkbox"/> literature	<input type="checkbox"/> sculpture
<input type="checkbox"/> 1600-1699	<input checked="" type="checkbox"/> architecture	<input type="checkbox"/> education	<input type="checkbox"/> military	<input type="checkbox"/> social/ humanitarian
<input type="checkbox"/> 1700-1799	<input type="checkbox"/> art	<input type="checkbox"/> engineering	<input type="checkbox"/> music	<input type="checkbox"/> theater
<input checked="" type="checkbox"/> 1800-1899	<input type="checkbox"/> commerce	<input type="checkbox"/> exploration/settlement	<input type="checkbox"/> philosophy	<input type="checkbox"/> transportation
<input type="checkbox"/> 1900-	<input type="checkbox"/> communications	<input type="checkbox"/> industry	<input type="checkbox"/> politics/government	<input type="checkbox"/> other (specify)
		<input type="checkbox"/> invention		

**Specific dates** 1840-1842 **Builder/Architect** ~~W. H. H. H. H.~~ Dr. Hugh Marshall

**Statement of Significance (in one paragraph)**

Marshall's Grove is significant as a good example of the early plantation houses of Dallas County. Its Federal period styling, its basically unaltered design, and its occupancy by descendants of the original owner make it an important Dallas County landmark.

\*\*\*\*\*

Much of the original furniture is still in use. Dr. Marshall, a native of Charleston, S.C., was a planter as well as a physician. Marshall had migrated to Alabama by 1830. His plantation near the Beech Creek swamp was thought to be unhealthy so his home was built on a 150 acre tract on high ground.

Several years ago the great-granddaughter of Dr. Marshall returned to restore the dwelling which had been vacant for a number of years. Because of the period of vacancy few changes has been made. Mrs. Llewellyn is painstaking in her research and the visitor has a great sense of zeitgeist within both house and grounds.

During the Battle of Selma (1865), Federal General James Harrison Wilson commanded the house. Mrs. Marshall and four daughters were allowed to stay in the front down-stairs bedroom, where meals were served to them. The letters she later received from Federal officers who stayed in the house have been preserved. Once again family tradition holds to the 'Masonic legend' in preventing destruction by the Federal armies. Dr. Marshall's Masonic credentials were displayed in a chart hanging on the wall and thus said to have influenced fellow Masons in the Union forces in the decision not to destroy the house.

# 9. Major Bibliographical References

Correspondence Mrs. S. Llewellyn to Mrs. A. Callaway, July 1979  
 Interview Mrs. S. Llewellyn with N. and N. Holmes, July 28, 1979  
 Morrison, O. S. The Battle of Selma, Selma, Dallas County, Chamber of Commerce, undated.

# 10. Geographical Data

Acreage of nominated property 150 x 400 ft. on approximately 1.377 acres  
 Quadrangle name Selma Quadrangle scale 1:62500

UMT References

A	<u>1</u> <u>6</u>	<u>4</u> <u>9</u> <u>9</u> <u>4</u> <u>0</u> <u>0</u>	<u>3</u> <u>5</u> <u>9</u> <u>1</u> <u>9</u> <u>0</u> <u>0</u>	B			
	Zone	Easting	Northing		Zone	Easting	Northing
C				D			
E				F			
G				H			

**Verbal boundary description and justification** The property extends 150 linear feet along the west R.O.W. of Alabama Highway 22, symmetrically disposed about the center line of the building, by 400 feet deep to the west of the highway right-of-way, total of 1.377 acres; all lying in T17N, R11E of Dallas County, Alabama. See attached map.

List all states and counties for properties overlapping state or county boundaries

state	code	county	code

# 11. Form Prepared By

name/title Nicholas Holmes/FAIA, Nancy N. Holmes/Preservation Consultant

organization Alabama Historical Commission date Nov. 1979

street & number 725 MONROE ST telephone  

city or town MONTGOMERY state ALABAMA

# 12. State Historic Preservation Officer Certification

The evaluated significance of this property within the state is:

national  state  local

As the designated State Historic Preservation Officer for the National Historic Preservation Act of 1966 (Public Law 89-665), I hereby nominate this property for inclusion in the National Register and certify that it has been evaluated according to the criteria and procedures set forth by the Heritage Conservation and Recreation Service.

State Historic Preservation Officer signature Philip B. Soward Jr.

title 5 APS Alabama date 10/6/81

For HCERS use only

I hereby certify that this property is included in the National Register

Selous Byrum Entered in the National Register date 2/4/82

Keeper of the National Register

Attest:   date  

Chief of Registration

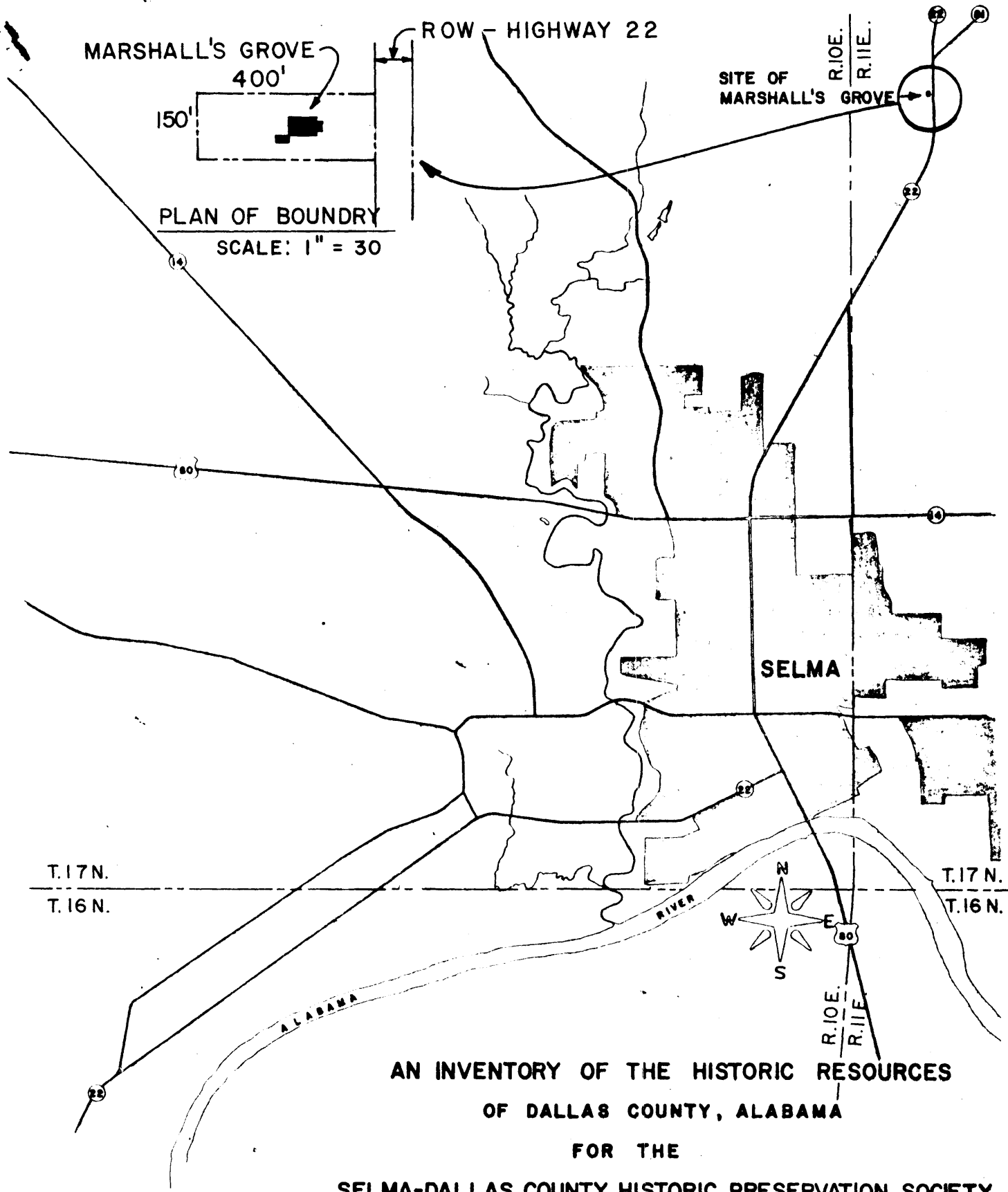

**AN INVENTORY OF THE HISTORIC RESOURCES**  
**OF DALLAS COUNTY, ALABAMA**  
**FOR THE**  
**SELMA-DALLAS COUNTY HISTORIC PRESERVATION SOCIETY**

NICHOLAS H. HOLMES JR. ARCHITECT F.A.I.A.  
 NANCY N. HOLMES PRESERVATION CONSULTANT

1979

