

# KENTUCKY HISTORIC RESOURCES INVENTORY

Site No. \_\_\_\_\_ Bn-236

1. Historic Name(s) <b>G. F. Quigley and Son Grocery</b>			22. ADD/County <b>BRADD/Barren</b>		
Original Owner <b>Robert Barbour</b>			23. U.S.G.S. Quadrant (15'/75') <b>Glasgow North</b>		
2. Present Name _____			24. UTM Reference _____		
3. Location <b>Goodnight</b>			Zone _____ Easting _____ Northing _____		
4. Owner's Name <b>Haskell Quigley</b>			25. Coordinate Accuracy _____		
5. Owner's Address <b>Goodnight</b>			26. Prehistoric Site _____ Object _____ Historic Site _____ Structure _____ Building _____ Other _____		
6. Open to Public Yes _____ No <input checked="" type="checkbox"/>		7. Visible from road Yes <input checked="" type="checkbox"/> No _____		8. Ownership <input checked="" type="checkbox"/>	
9. Local Contact/Organization _____		Private _____ Local _____ State _____ Federal _____		27. National Register District Name: _____	
10. Site Plan with North Arrow _____			11. Architect _____		
			12. Builder _____		
			13. Date <b>1896</b> A. <input type="checkbox"/> B. <input type="checkbox"/>		
			14. Style A. <b>vernacular</b> <input type="checkbox"/> B. <input type="checkbox"/>		
			15. Original Use <b>commercial</b> <input type="checkbox"/>		
			16. Present use <b>abandoned</b>		
			17. Condition <b>fair</b> <input type="checkbox"/>		
			18. Description <b>Window and door openings capped with label molds. Shed style entrance porch.</b>		
			No. Stories <b>one</b> <input type="checkbox"/>		
			Single Pile _____ NA _____ Double Pile _____ Floor Plan <b>single cell</b> <input type="checkbox"/> Structural Fabric <b>frame</b> A. <input type="checkbox"/> B. <input type="checkbox"/> Decorative Fabric <b>label molds</b> A. <input type="checkbox"/> B. <input type="checkbox"/> Roof Form <b>gable</b>		
19. History <b>Built in 1896 as a post office by Robert Barbour. G. F. Quigley bought the store in 1908.</b>			28. Significance Evaluation <b>National Register</b> <input type="checkbox"/>		
20. Significance <b>The Quigley store is one of few intact nineteenth century store buildings which depict the rural way of life in Barren County during that time</b>			29. Status _____ Date _____ National Landmark _____ National Register _____ Landmark Certificate _____ Kentucky Survey _____ Local Landmark _____ HABS/HAER _____		
21. Source of Information _____			30. Historic Theme Primary _____ Secondary _____ Other _____		
_____			31. Endangered Yes _____ No _____		
_____			32. Preservation Project Status _____ Actual Cost in \$ 1,000s _____		
_____			33. ATTACH PHOTO _____		
_____			Roll No. <b>#33</b> Picture No. <b>Photos 109-110</b> Direction _____		
_____			34. Prepared by: <b>Jayne C. Henderson</b>		
_____			35. Organization <b>SCKHS</b>		
_____			36. Date <b>Fall, 1981</b>		
_____			37. Revision Dates _____ 38. Staff Review _____		

(Continue on Back)

KENTUCKY HISTORIC RESOURCE INVENTORY SUPPLEMENT  
BOUNDARY AND LOCATION INFORMATION

Historic Property Name H.S. Quigley and Son Store Site # BN-236  
Multiple Resource/Thematic Nomination Title Barren County Multiple Resource

U.T.M. Coordinates - List multiple UTM's if property is ten or more acres.

A. 16 599 480 4105 560 D. \_\_\_\_\_  
B. \_\_\_\_\_ E. \_\_\_\_\_  
C. \_\_\_\_\_ F. \_\_\_\_\_

Verbal Boundary Description Acreage less than one acre

See Map. 3

The nominated area is an imaginary line 20 feet from, and parallel to the foundation of the building. No outbuildings are included in the nomination. Nominated area in red.

Sketch of Site Plan (Showing outbuildings, structures, landscape features and the site boundary as described above.)

Site location map only -  
Not to scale

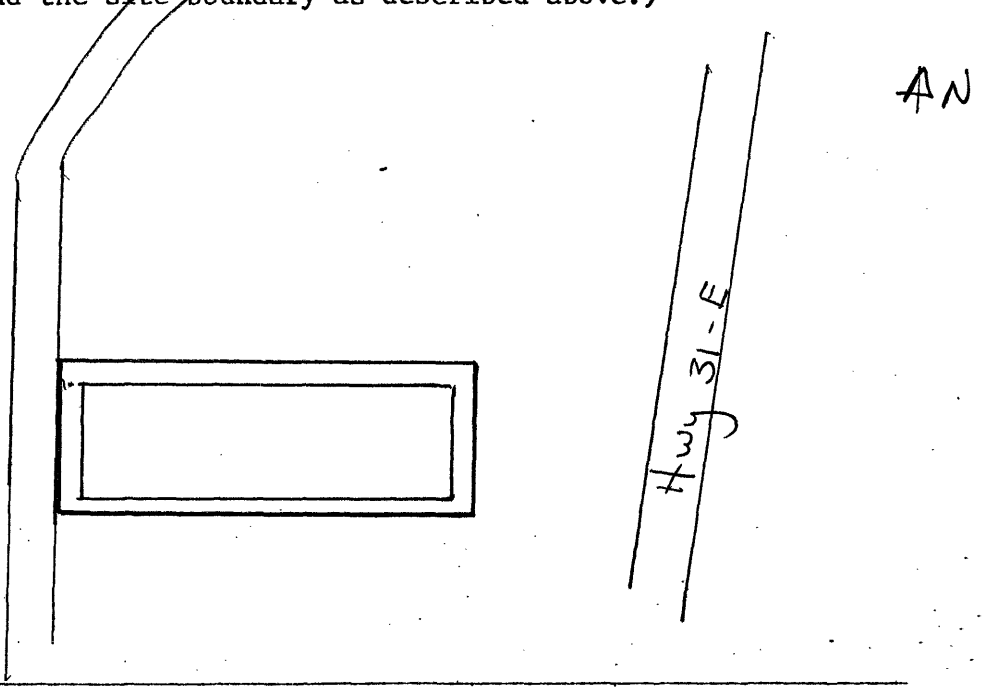

Official Courthouse Property Reference:

# KENTUCKY HISTORIC RESOURCES INVENTORY

Site No. \_\_\_\_\_ Bn-236

1. Historic Name(s) <b>G. F. Quigley and Son Grocery</b>			22. ADD/County <b>BRADD/Barren</b>		
Original Owner <b>Robert Barbour</b>			23. U.S.G.S. Quadrant (15'/75') <b>Glasgow North</b>		
2. Present Name _____			24. UTM Reference _____		
3. Location <b>Goodnight</b>			Zone _____ Easting _____ Northing _____		
4. Owner's Name <b>Haskell Quigley</b>			25. Coordinate Accuracy _____		
5. Owner's Address <b>Goodnight</b>			26. Prehistoric Site _____ Object _____ Historic Site _____ Structure _____ Building _____ Other _____		
6. Open to Public Yes _____ No <input checked="" type="checkbox"/>		7. Visible from road Yes <input checked="" type="checkbox"/> No _____		8. Ownership <input checked="" type="checkbox"/>	
9. Local Contact/Organization _____		Private _____ Local _____ State _____ Federal _____		27. National Register District Name: _____	
10. Site Plan with North Arrow _____			11. Architect _____		
			12. Builder _____		
			13. Date <b>1896</b> A. <input type="checkbox"/> B. <input type="checkbox"/>		
			14. Style A. <b>vernacular</b> <input type="checkbox"/> B. <input type="checkbox"/>		
			15. Original Use <b>commercial</b> <input type="checkbox"/>		
			16. Present use <b>abandoned</b>		
			17. Condition <b>fair</b> <input type="checkbox"/>		
			18. Description <b>Window and door openings capped with label molds. Shed style entrance porch.</b>		
			No. Stories <b>one</b> <input type="checkbox"/>		
			Single Pile _____ NA _____ Double Pile _____ Floor Plan <b>single cell</b> <input type="checkbox"/> Structural Fabric <b>frame</b> A. <input type="checkbox"/> B. <input type="checkbox"/> Decorative Fabric <b>label molds</b> A. <input type="checkbox"/> B. <input type="checkbox"/> Roof Form <b>gable</b>		
19. History <b>Built in 1896 as a post office by Robert Barbour. G. F. Quigley bought the store in 1908.</b>			28. Significance Evaluation <b>National Register</b> <input type="checkbox"/>		
20. Significance <b>The Quigley store is one of few intact nineteenth century store buildings which depict the rural way of life in Barren County during that time</b>			29. Status _____ Date _____ National Landmark _____ National Register _____ Landmark Certificate _____ Kentucky Survey _____ Local Landmark _____ HABS/HAER _____		
21. Source of Information _____			30. Historic Theme Primary _____ Secondary _____ Other _____		
_____			31. Endangered Yes _____ No _____		
_____			32. Preservation Project Status _____ Actual Cost in \$ 1,000s _____		
_____			33. ATTACH PHOTO _____		
_____			Roll No. <b>#33</b> Picture No. <b>Photos 109-110</b> Direction _____		
_____			34. Prepared by: <b>Jayne C. Henderson</b>		
_____			35. Organization <b>SCKHS</b>		
_____			36. Date <b>Fall, 1981</b>		
_____			37. Revision Dates _____ 38. Staff Review _____		

(Continue on Back)

KENTUCKY HISTORIC RESOURCE INVENTORY SUPPLEMENT  
BOUNDARY AND LOCATION INFORMATION

Historic Property Name H.S. Quigley and Son Store Site # BN-236  
Multiple Resource/Thematic Nomination Title Barren County Multiple Resource

U.T.M. Coordinates - List multiple UTM's if property is ten or more acres.

A. 16 599 480 4105 560 D. \_\_\_\_\_  
B. \_\_\_\_\_ E. \_\_\_\_\_  
C. \_\_\_\_\_ F. \_\_\_\_\_

Verbal Boundary Description Acreage less than one acre

See Map. 3

The nominated area is an imaginary line 20 feet from, and parallel to the foundation of the building. No outbuildings are included in the nomination. Nominated area in red.

Sketch of Site Plan (Showing outbuildings, structures, landscape features and the site boundary as described above.)

Site location map only -  
Not to scale

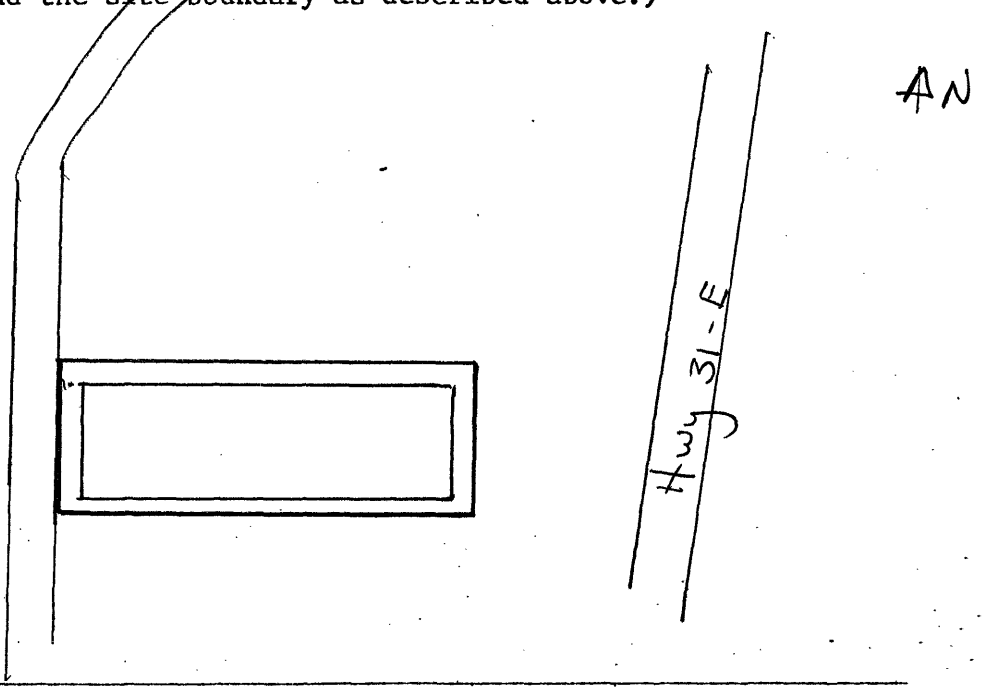

Official Courthouse Property Reference: