

# BERGEN COUNTY STONE HOUSE SURVEY

INDIVIDUAL STRUCTURE SURVEY FORM

33

**GENERAL 17**

HISTORIC NAME: Blackledge-Gair *House*

COMMON NAME:

LOCATION: 111 Madison Avenue  
*(Block 25, Lot 26-29)*

MUNICIPALITY: Cresskill

OWNERSHIP:  Public  Private

OWNER/ADDRESS: Shawn C. Nagle  
(same)

**REFERENCE**

MAP REFERENCES:

Erskine (1778-80)

Hopkins-Corey (1861) J.P. Blackledge

Walker's Atlas (1876) Robert Gair

Bromley (1912) no name

Other

RECOGNITION:

National Register  BCHS Marker

HABS  Bailey

Other

**ENVIRONMENT**

HOUSE ORIENTATION: S12°W

IMPORTANT RELATED STRUCTURES:

old garage

SURROUNDING ENVIRONMENT:

Residential

Commercial

Agricultural

Open Space

Other

COMMENTS:

**THREATS USE**

ORIGINAL: residence

PRESENT: residence

THREATS TO STRUCTURE:

Roads possible

Development

Zoning

Deterioration

Other

No Threat

COMMENTS:

**CONDITION**

CONDITION:

Excellent  Good

Fair  Deteriorated

STATUS:

Occupied

Unoccupied

Work in Progress

ACCESSIBLE:

Yes, Restricted

Yes, Unrestricted

No

a good-looking small house nestled among the trees on a small lot. This may have been the owner of the paperboard company home (Robert Gair)

**PHOTO**



**MAP**

USGS QUAD: Yonkers

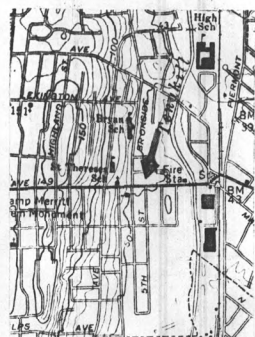

**DESCRIPTION**

**CONSTRUCTION DATE/SOURCE:**

probably Federal period based on architectural evidence. Wing may be older.

**BUILDER:** not known

**FORM/PLAN TYPE:** probably similar to "C", 3 bay, 1 room deep. 29'-10"x19'-3" dp. stone wing to West.

**FRAMING SYSTEM:**

- Intermediate Summer Beam
- Intermediate Bearing Wall
- Clear Span
- Other

**EXTERIOR WALL FABRIC:**

evenly cut sandstone, finely tooled, rougher on wing.

**FENESTRATION:** 12/12 on main  
8/8 on wing

**ENTRANCE LOCATION/TYPE:**

Eastern-most bay of facade, both main and wing. Main door is 35-1/2"x6'-8" and casing is 7'-9" with 4-lite spoke transom.

Interior not accessable

This house is significant for its architecture and its association with the exploration and settlement of the Bergen County, New Jersey area. It is a reasonably well preserved example of the Form/Plan Type as shown and more fully described herein. As such, it is included in the Thematic Nomination to the National Register of Historic Places for the Early Stone Houses of Bergen County, New Jersey.

**NUMBER OF STORIES:** 1-1/2

**CELLAR:**  Yes  
 No

**CHIMNEY FOUNDATION:**

- Stone Arch
- Brick Arch, Stone Foundation
- Other

**FLOOR JOISTS:**

**FIRST FLOOR CEILING HEIGHT:**

**FIRST FLOOR WALL THICKNESS:**

**GARRET FLOOR JOISTS:**

**GARRET:**

- Unfinished Space
- Finished Space

**ROOF:**

- Gable
- Gambrel
- Curb
- Other

**EAVE TREATMENT:**

- Sweeping Overhang
- Supported Overhang
- No Overhang
- Boxed Gutter
- Other

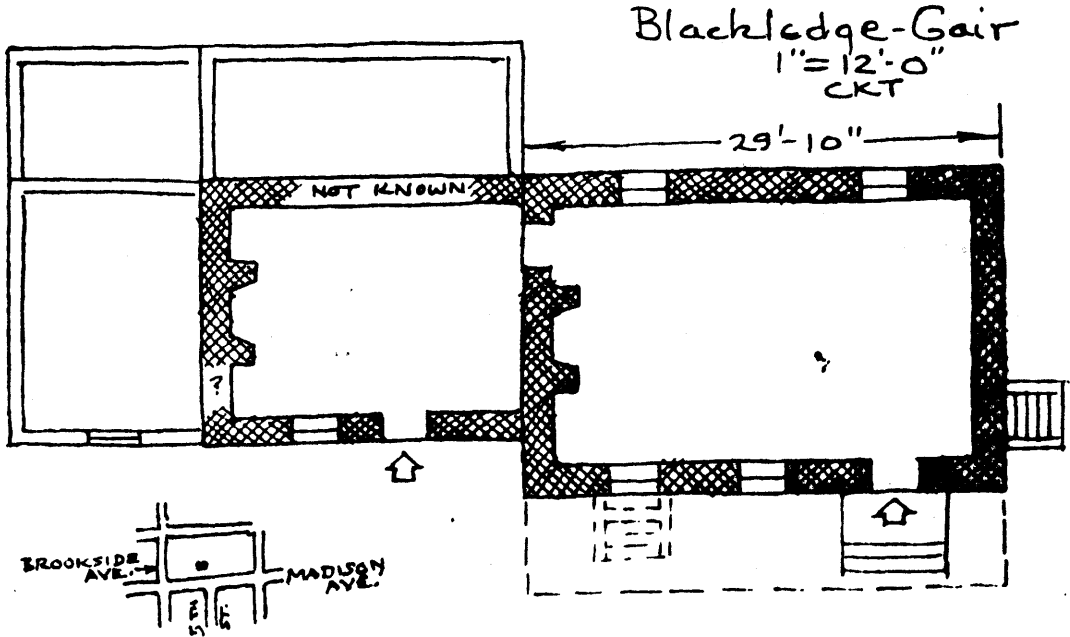

**BACKGROUND INFORMATION**

No known history, except that property was 2 miles wide and 3 miles deep to North and was owned in 1863 by Giles, and in 1964 by Clarence A. Conner, Jr.

VERBAL BOUNDARY DESCRIPTION:

Block 25, Lot 26-29 - Cresskill Tax Map

Less than 1 acre

U.T.M.

18 586 880 4532 600

Yonkers, New Jersey=New York.