

PHOTO 44

**NATIONAL REGISTER OF HISTORIC PLACES
INVENTORY - NOMINATION FORM**

(Type all entries - complete applicable sections)

STATE: Indiana
COUNTY: Wayne
FOR NPS USE ONLY
ENTRY DATE: JUN 28 1974

1. NAME

COMMON:
Old Richmond Historic District

AND/OR HISTORIC:
Old Richmond Historic District

2. LOCATION

STREET AND NUMBER: *roughly bounded by C&O Railroad, South 11, South A, Various, as shown in Richmond City Directory and alley S of South 11 Sts.*

CITY OR TOWN: **Richmond** CONGRESSIONAL DISTRICT: **Tenth**

STATE: **Indiana** CODE: **18** COUNTY: **Wayne** CODE: **177**

3. CLASSIFICATION

CATEGORY (Check One)	OWNERSHIP	STATUS	ACCESSIBLE TO THE PUBLIC
<input checked="" type="checkbox"/> District <input type="checkbox"/> Site <input type="checkbox"/> Object	<input checked="" type="checkbox"/> Public <input type="checkbox"/> Private <input checked="" type="checkbox"/> Both	<input checked="" type="checkbox"/> Occupied <input type="checkbox"/> Unoccupied <input type="checkbox"/> Preservation work in progress	Yes: <input checked="" type="checkbox"/> Restricted <input type="checkbox"/> Unrestricted <input type="checkbox"/> No

PRESENT USE (Check One or More as Appropriate)

<input type="checkbox"/> Agricultural	<input type="checkbox"/> Government	<input checked="" type="checkbox"/> Park	<input type="checkbox"/> Transportation
<input checked="" type="checkbox"/> Commercial	<input checked="" type="checkbox"/> Industrial	<input checked="" type="checkbox"/> Private Residence	<input type="checkbox"/> Other (Specify)
<input checked="" type="checkbox"/> Educational	<input type="checkbox"/> Military	<input checked="" type="checkbox"/> Religious	
<input type="checkbox"/> Entertainment	<input type="checkbox"/> Museum	<input type="checkbox"/> Scientific	

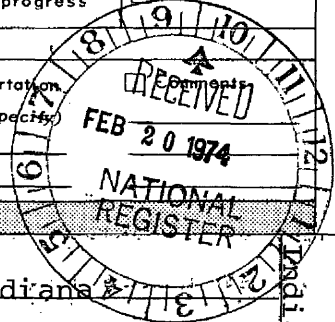

4. OWNER OF PROPERTY

OWNER'S NAME:
As shown in Transfer Books, City of Richmond, Indiana

STREET AND NUMBER:
As shown in Richmond City Directory for area

CITY OR TOWN: **Richmond** STATE: **Indiana**

5. LOCATION OF LEGAL DESCRIPTION

COURTHOUSE, REGISTRY OF DEEDS, ETC.:
Recorder's Office, Wayne County Court House

STREET AND NUMBER:
4th & Main Streets

CITY OR TOWN: **Richmond** STATE: **Indiana** CODE: **18**

6. REPRESENTATION IN EXISTING SURVEYS

TITLE OF SURVEY:
Richmond, Indiana-Toward Architectural Preservation

DATE OF SURVEY: **1969-71** Federal State County Local

DEPOSITORY FOR SURVEY RECORDS:
Plan Commission, City of Richmond, Indiana

STREET AND NUMBER:
Municipal Bldg.

CITY OR TOWN: **Richmond** STATE: **Indiana** CODE: **18**

SEE INSTRUCTIONS

STATE: Indiana
COUNTY: Wayne
ENTRY NUMBER: 177
DATE: JUN 28 1974
FOR NPS USE ONLY

7. DESCRIPTION

CONDITION

(Check One)

 Excellent Good Fair Deteriorated Ruins Unexposed

(Check One)

 Altered Unaltered

(Check One)

 Moved Original Site

DESCRIBE THE PRESENT AND ORIGINAL (If known) PHYSICAL APPEARANCE

1. Old Richmond Historic District consists of 250 acres comprising the Original Plat of Richmond(1816) and several early additions up to 1855. The district is bounded on the west by the C&O Railroad, on the east by South 11th St., on the north by the centerline of South "A" Street, and on the south by the centerline of an alley south of South "E" Street. It was a commercial, industrial and residential neighborhood, occupied at first by Friends, later by German immigrants and free blacks. The squares in Old Richmond Historic District are typical grid-irons, consisting of 3x6 pole lots in the Original Plat, and smaller tracts in Bickel & Laws Addition, Jeremiah Hadley's Addition, and Smith's Outlots.
2. The main commercial district in Old Richmond was South 4th & 5th Streets. Until 1837, South 4th(then Front)Street was Richmond's main commercial artery. The National Road ran along part of South 4th Street until the National Road Bridge was completed in 1837. These streets are lined with federal and Greek Revival detached town houses, interspersed with later early Victorian homes. The 200 block of South 4th Street contains several fine late 19th century homes built by wealthy German-Americans.
3. South 2d, 3rd and 6th Streets were mainly residential neighborhoods, first occupied by English Friends, then by blacks and Germans. The Elijah Coffin Mansion, at 110 S. 3rd is the best house in this classification.
4. South 7th, 8th and 9th Streets were once called "Little Africa". These streets were the heart of Richmond's free black community before the civil war. The neighborhood consists of free standing townhouses and one and one-half story cottages of federal and Grecian style.
5. The following structures are considered of national importance:
 - (a) Bethel A.M.E. Church(1857-remodeled 1895)--center of Underground Railroad activities for eastern Indiana, located at 200 S. 6th St. One of oldest A.M.E. congregations in midwest.
 - (b) William Paul Quinn Home(ca. 1835)--217-19 S. 3rd St. Residence of Bishop William Paul Quinn, evangelist, educator, and Mason, organizer of more than 50 A.M.E churches, and prime mover in black efforts to aid runaway slaves.
6. The following structures are of state importance:
 - (a) Elijah Coffin Mansion(1845-47)--110 S. 3rd St. 2½ story Federal style hip-roofed town home on large lot w/cupola;
 - (b) Henry Davis House(1856)--201 S. 6th St. 2½ story brick gabled town home of excellent design, represents best of local vernacular Grecian architecture;
 - (c) Rankempf Cottage(1855)--402 S. "E"St. 1½ story brick Grecian cottage with gable end to street;
 - (d) Hall Town House(1838)--119 S. 3rd St., 2 story federal style

SEE INSTRUCTIONS

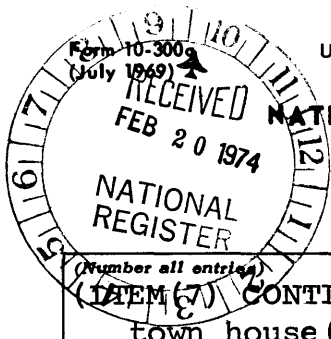

UNITED STATES DEPARTMENT OF THE INTERIOR
NATIONAL PARK SERVICE

NATIONAL REGISTER OF HISTORIC PLACES
INVENTORY - NOMINATION FORM

(Continuation Sheet)

STATE	Indiana	
COUNTY	Wayne	
FOR NPS USE ONLY		
ENTRY NUMBER		DATE
		JUN 28 1974

town house (detached) excellent representative sample;
 (e) Edward Frauman House (1855)--236 S. 3rd St. 1½ story brick town home, gable end to street, excellent vernacular style;
 (f) Lydia Pierce Cottage (1858)--241 S. "B" St., 1 story Dutch gabled cottage with 50° pitch roof. Excellent Germanic vernacular architecture.

7. Old Richmond Historic District consists of 19 city blocks and portions of 15 blocks. It is a homogeneous area containing 2 structures of national importance, 6 of state importance, and 204 structures of local importance, according to National Park Service standards. Of that 212, 64 are of post-colonial style, 106 are of Grecian or Greek Revival style, 27 are of Greco-Italianate style, 12 are purely Italianate, and 1 is Gothic & Italianate composite style. There are several key areas in Old Richmond Historic District:

- (a) 100 Block South 3rd Street-- This block is little changed from mid 1850's. It contains 14 structures, 6 of which are of historic importance, including the James Hall Town House and the Elijah Coffin Mansion;
- (b) 200 Block South 6th Street-- This block contains 21 structures, 1 of national importance, 1 of state importance, and 8 of local importance;
- (c) 200 Block South 3rd Street-- This block contains 21 structures, 1 of national importance (Wm. Paul Quinn house), 1 of state importance (Frauman house) and 8 of local importance;
- (d) 400 Block South 4th Street--This block contains 23 structures, all of which are detached town homes, 12 of local importance;
- (e) 200 Block South 7th Street--This block contains 23 structures, all of which are detached, freestanding homes & cottages. 15 are of local importance;
- (f) 300-400 Block South 10th Street--This block contains 48 structures, 24 of local importance. This is the heart of the German-american residential neighborhood area.

8. Several very significant structures have been destroyed:
 (a) Richmond City Market House (1825-1965)--520 South "A" St. a 7 bay arched post-colonial market house, only extant structure of its type in Indiana. Inventoried HABS I 1936;
 (b) John Meek House (1835-1972)--110 S. 5th St. 2½ story brick town house of high quality destroyed to make way for parking lot;
 (c) St. Andrew's Church (1846-1915)--2 story late federal style brick gabled church with oriel window & Ionic cornice, demolished when new school built.

SIGNIFICANCE

PERIOD (Check One or More as Appropriate)

- Pre-Columbian | 16th Century | 18th Century | 20th Century
 15th Century | 17th Century | 19th Century

SPECIFIC DATE(S) (If Applicable and Known)

AREAS OF SIGNIFICANCE (Check One or More as Appropriate)

- | | | | |
|--|---|---|--|
| <input type="checkbox"/> Aboriginal | <input checked="" type="checkbox"/> Education | <input checked="" type="checkbox"/> Political | <input type="checkbox"/> Urban Planning |
| <input type="checkbox"/> Prehistoric | <input type="checkbox"/> Engineering | <input checked="" type="checkbox"/> Religion/Philosophy | <input checked="" type="checkbox"/> Other (Specify) <u>Black history</u> |
| <input checked="" type="checkbox"/> Historic | <input type="checkbox"/> Industry | <input type="checkbox"/> Science | _____ |
| <input type="checkbox"/> Agriculture | <input type="checkbox"/> Invention | <input type="checkbox"/> Sculpture | _____ |
| <input checked="" type="checkbox"/> Architecture | <input type="checkbox"/> Landscape Architecture | <input checked="" type="checkbox"/> Social/Humanitarian | _____ |
| <input type="checkbox"/> Art | <input type="checkbox"/> Literature | <input type="checkbox"/> Theater | _____ |
| <input checked="" type="checkbox"/> Commerce | <input type="checkbox"/> Military | <input checked="" type="checkbox"/> Transportation | _____ |
| <input type="checkbox"/> Communications | <input type="checkbox"/> Music | | _____ |
| <input type="checkbox"/> Conservation | | | _____ |

STATEMENT OF SIGNIFICANCE

1. Architectural Significance: The Elijah Coffin mansion, if restored, would be one of the better post-colonial mansions of the midwest. It is a 2½ story brick 3x4 bay hip roofed structure with cupola, and attached kitchen wing. Much original wrought ironwork remains, including a fine fence and a secondary wrought iron porch with iron acroteria. It is a sophisticated Quaker townhouse or mansion with detailing in both Grecian and earlier Palladian styles. The James Hall Townhouse, which is intact, is a 2 story brick post-colonial style town house with gabled ends, possessing a frontispiece adapted from LeFever's The Modern Builder's Guide, Pl. 80(Right Side). It is a fine example of midwest townhouse architecture. The Henry Davis house, a 2½ story brick gabled Grecian town home, is largely intact. It represents typical large town house construction in Richmond. The Frauman, Pierce and Rankempff cottages are examples of a local vernacular cottage architecture of high quality. Space considerations preclude discussion of the 212 historic properties in Old Richmond. It suffices to state that each early cottage or town house is part of a rich cultural and architectural scene.

2. Historic Significance: Richmond was incorporated in 1818, and made a city in 1840. Prior to 1840 Richmond was principally what is the Old Richmond Historic District. Upon the completion of the National Road Bridge in 1837, Richmond began to grow east along National Road(Main Street) toward the Ohio line. Old Richmond's original Irish & English Quaker inhabitants moved northeast to newer areas of Richmond, turning over their early townhouse and cottages to German immigrants and to blacks. These two ethnic groups then created much of Old Richmond's history.

The Richmond black community early organized a significant center for educating freed blacks and for harboring runaway slaves, ^{the} Bethel A.M.E Church. Until 1850, Richmond and Old Richmond Historic District was the second largest settlement of free blacks in Indiana. Bethel Church was more than a religious center, it was a social and educational institution for free blacks. Under the leadership of Bishop William Paul Quinn, the Bethel Congregation educated blacks despite anti-

SEE INSTRUCTIONS

9 MAJOR BIBLIOGRAPHICAL REFERENCES

Young, History of Wayne County, Indiana (1872); Plummer, ed., A Directory of the City of Richmond (1857); E.L. Thornborough, The Negro in Indiana (1957); F. Bartel, The Germans in Richmond, (1912) MS Thesis; W. Peat, Indiana Houses of the Nineteenth Century (1962); D. Payne, A History of the Afro M.E. Church (1893) H.C. Fox, ed., Memoirs of Wayne County, Indiana (1912)

10 GEOGRAPHICAL DATA

LATITUDE AND LONGITUDE COORDINATES DEFINING A RECTANGLE LOCATING THE PROPERTY			OR	LATITUDE AND LONGITUDE COORDINATES DEFINING THE CENTER POINT OF A PROPERTY OF LESS THAN TEN ACRES		
CORNER	LATITUDE	LONGITUDE		LATITUDE	LONGITUDE	
NW	Degrees Minutes Seconds 39 ° 49 ' 37 "	Degrees Minutes Seconds 84 ° 54 ' 00 "	Degrees Minutes Seconds ° ' "	Degrees Minutes Seconds ° ' "		
NE	39 ° 49 ' 36 "	84 ° 53 ' 15 "				
SE	39 ° 49 ' 14 "	84 ° 53 ' 15 "				
SW	39 ° 49 ' 14 "	84 ° 53 ' 52 "				

APPROXIMATE ACREAGE OF NOMINATED PROPERTY: **250**

LIST ALL STATES AND COUNTIES FOR PROPERTIES OVERLAPPING STATE OR COUNTY BOUNDARIES

STATE:	CODE	COUNTY	CODE
Not applicable			
STATE:	CODE	COUNTY:	CODE
STATE:	CODE	COUNTY:	CODE
STATE:	CODE	COUNTY:	CODE

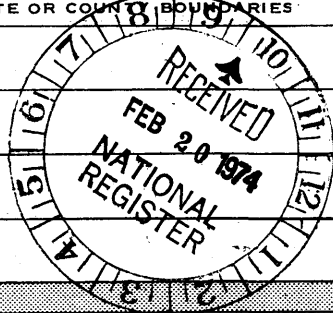

11 FORM PREPARED BY

NAME AND TITLE: **Thomas J. Reed, Consultant**

ORGANIZATION: **Old Richmond, Inc.** DATE: **Nov. 21, 1973**

STREET AND NUMBER: **19 South 9th St.**

CITY OR TOWN: **Richmond** STATE: **Indiana** CODE: **18**

12 STATE LIAISON OFFICER CERTIFICATION NATIONAL REGISTER VERIFICATION

As the designated State Liaison Officer for the National Historic Preservation Act of 1966 (Public Law 89-665), I hereby nominate this property for inclusion in the National Register and certify that it has been evaluated according to the criteria and procedures set forth by the National Park Service. The recommended level of significance of this nomination is:

National State Local

Name: *Joseph D. Cloud*
 Title: **Indiana State Liaison Officer**

Date: **February 13, 1974**

I hereby certify that this property is included in the National Register.

A. A. Montrose
 Director, Office of Archeology and Historic Preservation

Date: *6/28/74*

ATTEST: *Wm J. Montrose*
 Keeper of The National Register

Date: *6-28-74*

NW 10/16/96 90/4410520
 SE 10/16/80 980/4408560
 SEE INSTRUCTIONS

**NATIONAL REGISTER OF HISTORIC PLACES
INVENTORY - NOMINATION FORM**

(Continuation Sheet)

STATE	Indiana
COUNTY	Wayne
FOR NPS USE ONLY	
ENTRY NUMBER	DATE
	JUN 28 1974

(Number all entries)

(ITEM 8 CONTINUED)

literacy laws. It also functioned as a way station for runaway blacks.

The Germans built three churches which formed for them social and economic centers:

- (a) St. Andrew's Catholic Church(1846)--German Catholic church and school system;
- (b) St. Paul Evangelical Lutheran Church(1857)--a merger of Lutheran dissidents and German methodists;
- (c) St. John's Lutheran Church & Academy(1846-54)--largest of all German institutions, possessed a high quality secondary school as part of church operations;

These centers, together with German language newspapers, and the ubiquitous Turnerverein, kept German culture alive until World War I.

3. Important Residents of Old Richmond:

- (a) William Paul Quinn(1785?-1873)--Born in Honduras of black mother and Hispano-Irish father, dealer in mahogany. Emigrated to U.S. ca. 1800, educated by Philadelphia Friends. With Richard Allen at foundation of Afro M.E. Church 1816, licensed to preach thereafter. Sent to Midwest 1836 to evangelize among blacks, Founded Bethel (Richmond A.M.E Church as center for free black community in 1836. Founded more than 50 A.M.E. churches in midwest, organized black communities into underground railway network. Active in founding of Wilberforce University, associated with Daniel Payne in black educational work. Died 1873 in Richmond.
- (b) Samuel Townsend(1843-1913)-- Civil War Veteran(Mass.) black educator and A.M.E. minister. Associated with Timothy Nicholson in Republican Political activities, elected to state legislature 1883-85, first black in Indiana General Assembly. U.S. Commissioner of General Land Office under Benjamin Harrison.
- (c) Elijah Coffin(1796-1862)--Cashier of Indiana State Bank Clerk of Indiana Yearly Meeting of Friends, and important early Indiana financier.

4. Famous Events associated with Old Richmond:

- (a) Completion of National Road through Indiana, 1832;
- (b) Abolitionist movement, 1836-1861;
- (c) Underground railroad through eastern Indiana 1840-60;
- (d) German immigration movement 1837-1849;

**NATIONAL REGISTER OF HISTORIC PLACES
PROPERTY MAP FORM**

(Type all entries - attach to or enclose with map)

STATE INDIANA	
COUNTY Wayne	
FOR NPS USE ONLY	
ENTRY NUMBER	DATE
	JUN 28 1974

SEE INSTRUCTIONS

1. NAME			
COMMON: Old Richmond Historic District			
AND/OR HISTORIC: Old Richmond Historic District			
2. LOCATION			
STREET AND NUMBER: Various			
CITY OR TOWN: Richmond			
STATE: Indiana	CODE 18	COUNTY: Wayne	CODE 177
3. MAP REFERENCE			
SOURCE: Griffing, Stevenson & Co., Atlas of Wayne County, Indiana (1874)			
SCALE: 1 in. equals 330 ft.			
DATE: 1874			
4. REQUIREMENTS			
TO BE INCLUDED ON ALL MAPS			
1. Property boundaries where required.			
2. North arrow.			
3. Latitude and longitude reference.			

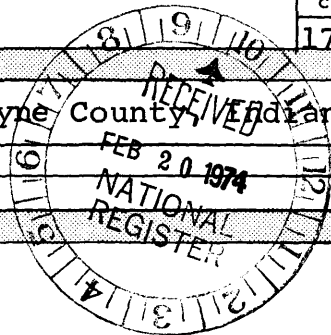

First Ward of RICHMOND

Scale 20 Rods to an Inch

Fourth Ward of RICHMOND

Scale 20 Rods to an inch

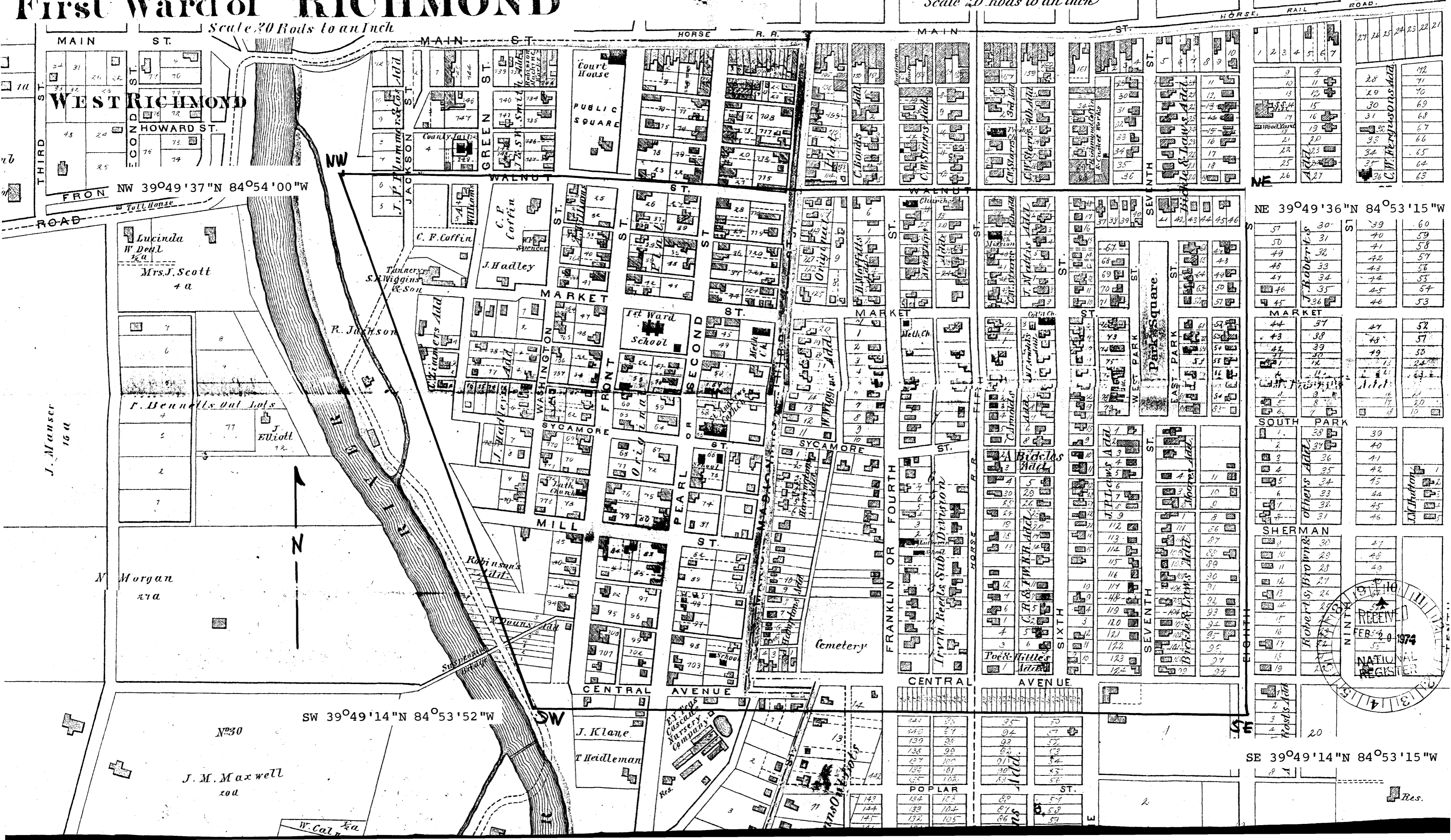

FRON NW 39°49'37"N 84°54'00"W

NE 39°49'36"N 84°53'15"W

SW 39°49'14"N 84°53'52"W

SE 39°49'14"N 84°53'15"W

