



Glynallen

Canfield Rd., Convent Sta., Morris, N.J.

Photographer: D. B. Pickell

Date of Photograph: October, 1985

Location of Negative: General Drafting Co.

Direction from which taken: West

Photograph no. 1 of 28



Glynallen

Canfield Rd., Convent Sta., Morris, N.J.

Photographer: D. B. Pickell

Date of Photograph: October, 1985

Location of Negative: General Drafting Co.

Direction from which taken: West

Photograph no.: 2 of 28



Glynallen

Canfield Rd., Convent Sta., Morris, N.J.

Photographer: D. B. Pickell

Date of Photograph: October, 1985

Location of Negative: General Drafting Co

Direction from which taken: North

Photograph no.: 3 of 28



Glynallen

Canfield Rd., Convent Sta., Morris, N.J.

Photographer: D. B. Pickell

Date of Photograph: October, 1985

Location of Negative: General Drafting Co

Direction from which taken: Southeast

Photograph no.: 4 of 28



Glynallen

Canfield Rd., Convent Sta., Morris, N.J.

Photographer: D. B. Pickell

Date of Photograph: October, 1985

Location of Negative: General Drafting Co.

Direction from which taken: Southeast

Photograph no.: 5 of 28



Glynallen

Canfield Rd., Convent Sta., Morris, N.J.

Photographer: D. B. Pickell

Date of Photograph: October, 1985

Location of Negative: General Drafting Co.

Direction from which taken: South

Photograph no.: 6 of 28



Glynallen

Canfield Rd., Convent Sta., Morris, N.J.

Photographer: D. B. Pickell

Date of Photograph: October, 1985

Location of Negative: General Drafting Co

Direction from which taken: Northeast

Photograph no.: 7 of 28

The Castle



FRONT VIEW OF THE MAIN OFFICE OF
GENERAL ELECTRIC CO., INC., CONYER STATION, NEW JERSEY

Glynallen

Canfield Rd., Convent Sta., Morris, N.J.

Photographer: Unknown

Date of Photograph: circa 1919

Location of Negative: General Drafting Co.

Direction from which taken: West

Photograph no.: 8 of 28

May, 1952

New Jersey

BUILDING CONTRACTOR

OFFICIAL ORGAN OF BUILDING CONTRACTORS ASSOCIATION OF NEW JERSEY



NEW HOME OF THE GENERAL DRAFTING COMPANY AT CONVENT STATION, NEW JERSEY.
RECONSTRUCTION BY JOSEPH DOLBE, INC., BERNARDVILLE.

On the Cover

This month's cover picture shows the new home of the General Drafting Company in Convent Station, New Jersey. The firm is moving into this remodeled estate after the reconstruction work is completed by Joseph Dolbe, Inc. of Bernardville, under the direction of Ray O. Peck, architect.

A small married society of business and light manufacturing firms taking over the old luxurious estates in the upper Somerset County area. The General Drafting Company is a manufacturer of road signs distributed by various gasoline companies. One hundred fifty people will be employed at the site.

Joseph Dolbe, Inc. is extremely well qualified in its remodeling work on these large estates. In 41 years of business the firm has constructed a large percentage of the grand residences found in the Somerset Hills area. These were constructed in what was a different era, of course. The firm also built large homes in Haddon and Princeton, New Jersey. Joseph Dolbe, the founder of the firm, is president of the corporation. The second generation, Harold J. Dolbe, secretary-treasurer of the firm shares the work with his father.

Joseph Dolbe, Inc. was a charter member of the Building Contractors Association of New Jersey and was very active in the founding of the Association.

Also working on the Convent Station, New Jersey project are associate members, Joseph Tomasco, electrician and Edward Chonerson & Son, painting. Other sub-contractors include Frank DePinto, brickwork; Ward Seeds & Co., flooring; and DeVore and Walker, and heating.

Glynallen

Canfield Rd., Convent Sta., Morris, N.J.

Photographer: Unknown

Date of Photograph: circa 1919

Location of Negative: General Drafting Co.

Direction from which taken: West

Photograph no.: 9 of 28



Left, Glynallyn as it appeared in the American Architect, February 4, 1920. The photo below shows the chimney at the extreme left has disappeared. This was removed because workmen were not able to find and repair a leak. Though not visible in these pictures, another chimney at the west end of the house was also removed. Smaller photo was taken January 1953.

In addition to the alterations already described, a stand-by generator was installed. This proved its worth during the 1953 ice storm when the Convent Station- except The Castle- was without light and heat for hours. An oil burner displaced three coal furnaces though one of these was retained for emergencies, and a 6,180-gallon oil tank sunk in the driveway

near the front door. A parking lot was built at the north-east end of the building, and a garage erected in the rear for the company's cars and garden equipment. In the basement a kitchen and an adjoining lounge was created for use of employees. Finally all alterations were completed, and on May 23, 1952, the move to Jersey began.



Glynallen

Canfield Rd., Convent Sta., Morris, N.J.

Photographer: Unknown

Date of Photograph: circa 1919 & 1953

Location of Negative: General Drafting Co.

Direction from which taken: NE & North

Photograph no.: 10 of 28

A COMPARISON . . .
GLYNALLYN AND COMPTON WYNYATES

In some respects the two buildings are similar. Compton Wynyates is set in a richly wooded hollow in rural Warwickshire and Glynallyn's land in Convent Station resembles the old English countryside — even to its ravine. Wynyates, mainly built during the reign of Henry VIII, is partly composed of materials from Fulbrooke Castle ruins. Glynallyn contains some paneling from Compton Wynyates, much stained glass from other old English homes, parts of other old houses and barns.

Both are combinations of brick, timber and stone. The architecture of each is irregular; towers here and there, gables of different heights, uneven roof lines and elaborate carved and moulded chimneys of different designs.

Compton Wynyates' Great Hall and drawing room are echoed in Glynallyn, though not similar. Compton's drawing room paneling and the carving over the fireplace was brought from the gatehouse of Sir John Spencer at Islington. His daughter married the first Baron Compton. Glynallyn's drawing room paneling was made by W. and J. Sloane. In the walls of both "castles" are secret panels, adding to the atmosphere of romance.

While Compton Wynyates is composed entirely of old materials, Glynallyn is built mainly of material so chosen and worked that it appears mellowed with age.

Compton Wynyates is badly arranged and unlivable; the house is no longer used as a residence except for a few days during the summer. It contains only four rooms that could be classed as bedrooms and no guest rooms. In its day, Glynallyn represented all that was necessary for warmth and comfort.

Compton Wynyates was built around a 57 foot square courtyard. Glynallyn has none. Ground and floor plans are dissimilar.

The old furnishings of Compton Wynyates were auctioned off after Spencer, the eighth Earl of Northampton, went into debt during a borough election in 1768. Glynallyn's furniture, too, went under the hammer after the death of the Allens.



From this angle, Compton Wynyates, above, closely resembles the Castle. This view of Compton Wynyates made by Oscar B. Smith, Morristown architect.



Glynallen

Canfield Rd., Convent Sta., Morris, N.J.

Photographer: Oscar B. Smith

Date of Photograph: Unknown

Location of Negative: General Drafting Co

Direction from which taken: Northwest

Photograph no.: 11 of 28



Rear view of Glynallyn made in 1919 by Parker Studio, Morristown,
especially for Mr. Allen.

Glynallen

Canfield Rd., Convent Sta., Morris, N.J.

Photographer: Unknown

Date of Photograph: 1919

Location of Negative: General Drafting Co.

Direction from which taken: Southeast

Photograph no.: 12 of 28



A VIEW OF THE GARDEN OUTSIDE THE WEST PORCH, 1920.



CLOSER VIEW OF SAME GARDEN SEVERAL YEARS LATER.

Glynallen

Canfield Rd., Convent Sta., Morris, N.J.

Photographer: Unknown

Date of Photograph: 1920 and later

Location of Negative: General Drafting Co

Direction from which taken: Various

Photograph no.: 13 of 28



The Little Hall was sparsely furnished.

Another view of the Great Hall shows the long bench before the massive fireplace, an antique Persian rug on the floor, the Jacobean type table - only item of the furnishings which still remains in the building.



This view of the Great Hall, from the American Architect of Feb. 4, 1920, shows the grouping of five windows copied from Compton Wynyates, a closer shot of the table which still stands in the hall.



Dining room, at right, with its Georgian furnishings.



Glynallen

Canfield Rd., Convent Sta., Morris, N.J.

Photographer: Unknown

Date of Photograph: circa 1919

Location of Negative: General Drafting Co.

Direction from which taken: --

Photograph no.: 14 of 28

"Copied from Compton Wynnyates"

Charles I. Allen

CHARLES I. ALLEN, Glynnallyn's architect, was quoted in *Architectural Forum*, Vol. 29 (Dec. 1928) as saying these parts were copied directly from Compton Wynnyates: the main entrance, the grouping of five windows in the Great Hall, the large second-floor bay window and the chimneys. The only difference in the main entrance detail is that Allen's coat-of-arms replaced that of Henry VIII.



Know which entrance is which? Glynnallyn is 1,4 and 2; Compton Wynnyates, 3 and 5. These photos show how the detail was copied.

Glynallen

Canfield Rd., Convent Sta., Morris, N.J.

Photographer: Unknown

Date of Photograph: Unknown

Location of Negative: General Drafting Co.

Direction from which taken: West

Photograph no.: 15 of 28



IN WARWICKSHIRE HOLLOW LIES COMPTON WYNAYATES BEHIND ITS FANCIFUL GARDEN, ITS DISCUSSED MOAT BEYOND.

Grouping of the five windows in Glynallyn's Great Hall was copied from Compton Wynyates, above. This clipping from LIFE, October 1945. To the right, are a closer view of the large window of the Group in the Castle, and above, a smaller photo shows other details.



Glynallen

Canfield Rd., Convent Sta., Morris, N.J.

Photographer: Unknown

Date of Photograph: Unknown

Location of Negative: General Drafting Co.

Direction from which taken:

Photograph no.: 16 of 28



The twisted chimneys of Compton Wynyates, above, are repeated in those atop the Castle, below.



Glynallen

Canfield Rd., Convent Sta., Morris, N.J.

Photographer: Unknown

Date of Photograph: Unknown

Location of Negative: General Drafting Co

Direction from which taken: Various

Photograph no.: 17 of 28



ALL THE
THE BEST
THE BEST

Glynallen

Canfield Rd., Convent Sta., Morris, N.J.

Photographer: D. B. Pickell

Date of Photograph: October, 1985

Location of Negative: General Drafting Co.,

Direction from which taken: —

Photograph no.: 18 of 28

Glynallen

Little Hall

(Entrance Hall)



Glynallen

Canfield Rd., Convent Sta., Morris, N.J.

Photographer: D. B. Pickell

Date of Photograph: October, 1985

Location of Negative: General Drafting Co

Direction from which taken: -

Photograph no.: 19 of 28

Glynallen

16th Century Linen-

Fold Paneling

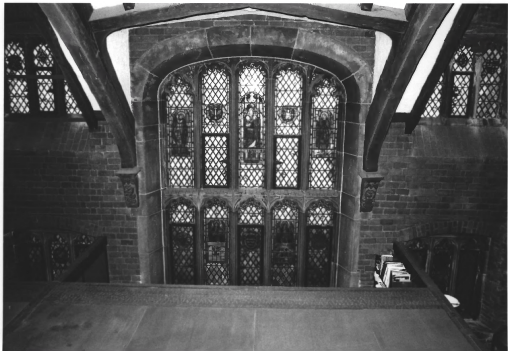

Glynallen
Canfield Rd., Convent Sta., Morris, N.J.
Photographer: D. B. Pickell
Date of Photograph: October, 1985
Location of Negative: General Drafting Co
Direction from which taken: -
Photograph no.: 20 of 28

Glynallen

Stained Glass
Great Hall



Glynallen

Canfield Rd., Convent Sta., Morris, N.J.

Photographer: D. B. Pickell

Date of Photograph: October, 1985

Location of Negative: General Drafting Co

Direction from which taken: -

Photograph no.: 21 of 28

Glynallen

Ceiling Beams

Great Hall



Glynallen

Canfield Rd., Convent Sta., Morris, N.J.

Photographer: D. B. Pickell

Date of Photograph: October, 1985

Location of Negative: General Drafting Co

Direction from which taken: -

Photograph no.: 22 of 28

Glynallen

Minstrel Gallery

Great Hall



Glynallen

Canfield Rd., Convent Sta., Morris, N.J.

Photographer: D. B. Pickell

Date of Photograph: October, 1985

Location of Negative: General Drafting Co.,

Photograph no. 23 of 28

Glynallen

Doorway

"Dungeon"



Glynallen

Canfield Rd., Convent Sta., Morris, N.J.

Photographer: D. B. Pickell

Date of Photograph: October, 1985

Location of Negative: General Drafting Co.

Photograph no. 24 of 28

Glynallen

Carved Mantel-Piece
Drawing-Room



Glynallen

Canfield Rd., Convent Sta., Morris, N.J.

Photographer: D. B. Pickell

Date of Photograph: October, 1985

Location of Negative: General Drafting Co.

Photograph no. 25 of 28

Glynallen

Gallery over
Great Hall

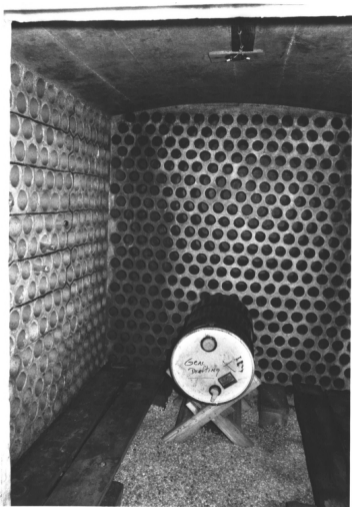

Glynallen

Canfield Rd., Convent Sta., Morris, N.J.

Photographer: D. B. Pickell

Date of Photograph: October, 1985

Location of Negative: General Drafting Co.

Photograph no. 26 of 28

Glynallen

Wine-Cellar

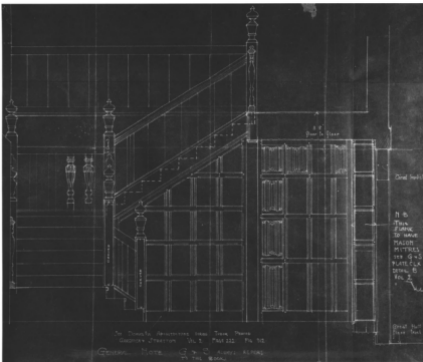

8' 0"
Door to floor

Cast iron

11 1/2"
THIS
FINISH
TO HAVE
MASON
MITRES
SEE G & S
PLATE CL. 2
SETH. B
Vol. 2

Cast iron
Door knob

See Details Architecture from Trade Papers
Geometric Construction Vol. 2, Part 222, Pl. 512

GENERAL NOTE: G & S ALONG ALONG
TO THE EDGE

Glynallen

Canfield Rd., Convent Sta., Morris, N.J.

Photographer: D. B. Pickell

Date of Photograph: October, 1985

Location of Negative: General Drafting Co.,

Photograph no. 27 of 28

Glynallen

Architect's Drawing:
Staircase and wall-
paneling

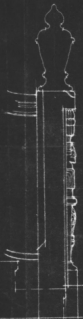

SIDE ELEVATION
OF NEWEL.



ANTIQUE FURNISHED
BY OWNER

FRONT ELEVATION
OF NEWEL.

Scale: 1" = 1'-0"

Glynallen

Canfield Rd., Convent Sta., Morris, N.J.

Photographer: D. B. Pickell

Date of Photograph: October, 1985

Location of Negative: General Drafting Co.

Photograph no. 28 of 28

Glynallen

Architect's Drawing:
Newel-Posts