

KENTUCKY HISTORIC RESOURCES INVENTORY

Site No. Tm-M-27

1. Historic Name(s) <u>House Tm-M-27</u> Original Owner _____		22. ADD/County <u>No. Ky./Trimble</u> 1 1 2	
2. Present Name _____		23. U.S.G.S. Quadrant (15'/75') <u>Madison East</u> G.I.S. Mod. [] [] []	
3. Location <u>KY 36 in Milton</u>		24. UTM Reference [] [] [] [] [] [] [] [] [] [] [] [] Zone Easting Northing	
4. Owner's Name <u>Floyd Baker</u>		25. Coordinate Accuracy []	
5. Owner's Address <u>Box 143, Milton, Kentucky</u>		26. Prehistoric Site _____ Object _____ Historic Site _____ Structure _____ (Building) _____ Other _____	
6. Open to Public Yes _____ No <u>XX</u>		27. National Register District Name: <u>Historic Resources of Trimble County</u> [] [] []	
7. Visible from road Yes <u>XX</u> No _____		28. Significance Evaluation <u>National Register</u> [D]	
8. Ownership Private <u>XX</u> Local [] State [] Federal []		29. Status _____ Date _____ National Landmark [] National Register [] Landmark Certificate [] Kentucky Survey [] Local Landmark [] HABS/HAER []	
9. Local Contact/Organization _____		30. Historic Theme Primary <u>Architecture</u> [C] [] Secondary [] [] Other [] []	
10. Site Plan with North Arrow _____		31. Endangered Yes _____ No <u>XX</u>	
11. Architect _____		32. Preservation Project Status _____	
12. Builder _____		Actual Cost in \$1,000s [] [] [] [] []	
13. Date <u>ca.1840</u> A. [3] B. []		33. ATTACH PHOTO 	
14. Style A. <u>Fed./Greek Rev.</u> [B] B. [C]		Roll No. <u>44</u>	
15. Original Use <u>Dwelling</u> [A]		Picture No. <u>9 - 20</u>	
16. Present use <u>Dwelling</u>		Direction _____	
17. Condition <u>Fair</u> [C]		34. Prepared by: <u>William Gus Johnson</u> <u>Sr. Historian & Photographer</u>	
18. Description A two-story brick house with a two-story brick ell located on State Highway 36 and overlooking the Ohio River. Fenestration is three bays with a side entrance. Windows are 1/1 pane. All bays have limestone lintels and sills. The building was constructed in common bond with a row of headers every seven rows. An ornate projecting cornice with paired brackets, modillions and returns <small>(Continue on Back)</small>		35. Organization <u>Kentucky Heritage Council</u>	
No. Stories <u>Two</u> [C]		36. Date <u>Fall 1982</u>	
Single Pile <u>XX</u> NA _____		37. Revision Dates _____ 38. Staff Review _____	
Double Pile _____			
Floor Plan <u>Side Passage</u> [K]			
Structural Fabric <u>Brick</u> A. [C] B. []			
Decorative Fabric <u>Common Bond</u> A. [E] B. []			
Roof Form <u>Gable</u>			
19. History _____			
20. Significance <u>Architecture: The Baker House is architecturally significant as one of the best examples of the Greek Revival style in Trimble County. The architectural quality of the dwelling makes it the most</u>			
21. Source of Information _____			

18. enhances the facade. The main block has an interior gable end chimney while the ell has a center ridgeline chimney and an interior gable-end chimney. A one-story porch covers the main floor facade bays and extends around the east side of the dwelling. Interior woodwork consists of fluted trim with bull's eye corner blocks. Greek Revival style mantels are exhibited on the main floor, while later Victorian style mantels enhance the second floor. The original wide plank hardwood flooring is intact.

20. important representation of a Greek Revival townhouse in the county.

KENTUCKY HISTORIC RESOURCE INVENTORY SUPPLEMENT
BOUNDARY AND LOCATION INFORMATION

1984

Historic Property Name _____ Site # Tm-M-27

Multiple Resource/Thematic Nomination Title Historic Resources of Trimble County

U.T.M. Coordinates - List multiple UTM's if property is ten or more acres.

A. 16 642040 4287260 D. _____
B. _____ E. _____
C. _____ F. _____

Verbal Boundary Description Acreage .25

Beginning at the intersection of Maple Street and State Highway 36 proceed 50' in a westward direction; thence 200' in a southward direction; thence 50' in an eastward direction; thence 200' in a northward direction to the point of origin.

Sketch of Site Plan (Showing outbuildings, structures, landscape features and the site boundary as described above.)

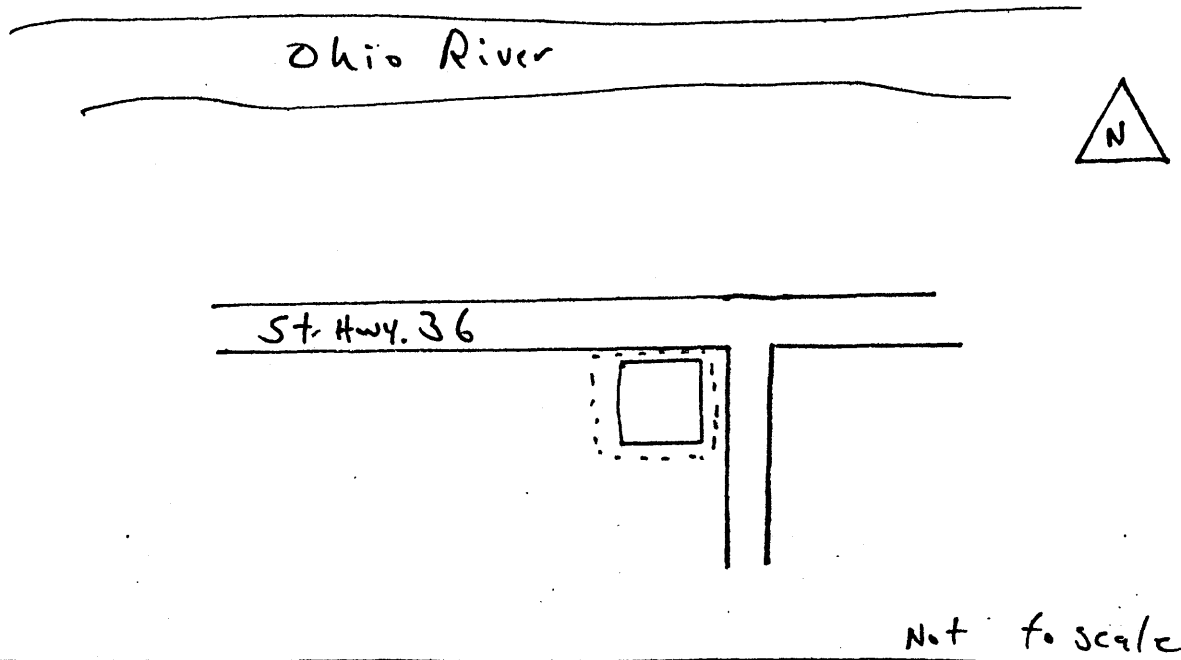

Official Courthouse Property Reference: