

United States Department of the Interior
National Park Service

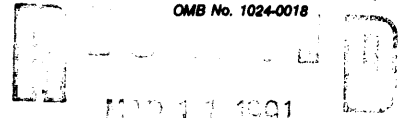

NATIONAL REGISTER

National Register of Historic Places Registration Form

This form is for use in nominating or requesting determinations of eligibility for individual properties or districts. See instructions in *Guidelines for Completing National Register Forms* (National Register Bulletin 16). Complete each item by marking "x" in the appropriate box or by entering the requested information. If an item does not apply to the property being documented, enter "N/A" for "not applicable." For functions, styles, materials, and areas of significance, enter only the categories and subcategories listed in the instructions. For additional space use continuation sheets (Form 10-900a). Type all entries.

1. Name of Property

historic name Chiles, William, House
other names/site number MM-MS-161

2. Location

street & number Eastside of Richmond Road not for publication
city, town Mt. Sterling vicinity
state Kentucky code KY county Montgomery code 173 zip code 40353

3. Classification

Ownership of Property	Category of Property	Number of Resources within Property	
<input checked="" type="checkbox"/> private	<input checked="" type="checkbox"/> building(s)	Contributing	Noncontributing
<input type="checkbox"/> public-local	<input type="checkbox"/> district	<u>2</u>	<u>2</u> buildings
<input type="checkbox"/> public-State	<input type="checkbox"/> site	_____	_____ sites
<input type="checkbox"/> public-Federal	<input type="checkbox"/> structure	_____	_____ structures
	<input type="checkbox"/> object	_____	_____ objects
		<u>2</u>	<u>2</u> Total

Name of related multiple property listing: Mt. Sterling, Ky. MRA
Number of contributing resources previously listed in the National Register 0

4. State/Federal Agency Certification

As the designated authority under the National Historic Preservation Act of 1966, as amended, I hereby certify that this nomination request for determination of eligibility meets the documentation standards for registering properties in the National Register of Historic Places and meets the procedural and professional requirements set forth in 36 CFR Part 60. In my opinion, the property meets does not meet the National Register criteria. See continuation sheet.

Signature of certifying official David L. Morgan Date 3-6-91
State Historic Preservation Officer, Kentucky Heritage Council
State or Federal agency and bureau _____

In my opinion, the property meets does not meet the National Register criteria. See continuation sheet.

Signature of commenting or other official _____ Date _____
State or Federal agency and bureau _____

5. National Park Service Certification

I, hereby, certify that this property is:

entered in the National Register. entered in the National Register
 See continuation sheet. 4/23/91

determined eligible for the National Register. See continuation sheet. _____

determined not eligible for the National Register. _____

removed from the National Register. _____

other, (explain:) _____

for Signature of the Keeper _____ Date of Action _____

6. Function or Use

Historic Functions (enter categories from instructions)

DOMESTIC/ Single Dwelling
DOMESTIC/ Secondary Structure

Current Functions (enter categories from instructions)

Domestic/ Single Dwelling
Domestic/ Secondary Structure

7. Description

Architectural Classification
(enter categories from instructions)

Early Republic/Federal

Materials (enter categories from instructions)

foundation Stone
walls Brick

roof Asphalt
other _____

Describe present and historic physical appearance.

8. Statement of Significance

Certifying official has considered the significance of this property in relation to other properties:

nationally statewide locally

Applicable National Register Criteria A B C D

Criteria Considerations (Exceptions) A B C D E F G

Areas of Significance (enter categories from instructions)

Architecture

Period of Significance

1810-1850

Significant Dates

1810

Cultural Affiliation

N/A

Significant Person

NA

Architect/Builder

N/A

State significance of property, and justify criteria, criteria considerations, and areas and periods of significance noted above.

9. Major Bibliographical References

Beers, D.G. and J. Lanagan. Map of Montgomery County, Kentucky.
Philadelphia: Beers and Lanagan, 1879.

Boyd, Carl B. and Hazel M. Boyd. A History of Mt. Sterling, Ky..
Mt. Sterling: privately printed, 1984.

Deed Books Montgomery County Courthouse.

Sanborn Insurance Maps for Mt. Sterling, Kentucky.

See continuation sheet

Previous documentation on file (NPS):

- preliminary determination of individual listing (36 CFR 67) has been requested
- previously listed in the National Register
- previously determined eligible by the National Register
- designated a National Historic Landmark
- recorded by Historic American Buildings Survey # _____
- recorded by Historic American Engineering Record # _____

Primary location of additional data:

- State historic preservation office
- Other State agency
- Federal agency
- Local government
- University
- Other

Specify repository:

Kentucky Heritage Council

10. Geographical Data

Acreeage of property 6.5

UTM References

A
 Zone Easting Northing

C

B
 Zone Easting Northing

D

See continuation sheet

Verbal Boundary Description

See continuation sheet

Boundary Justification

See continuation sheet

11. Form Prepared By

name/title Helen Powell
 organization H. Powell & Co., Inc. date 12/1/90
 street & number 2230 Idle Hour Center telephone (606) 266-5351
 city or town Lexington state KY zip code 40502

United States Department of the Interior
National Park ServiceNational Register of Historic Places
Continuation SheetSection number 7 Page 1Chiles, William, House
Mt. Sterling, Ky. MRA

The William Chiles House (MM-MS-161) is a complex which includes the main dwelling and one historic outbuilding along with one early twentieth century building and a modern garage. The site consists of two contributing and two non-contributing buildings and is located on the west side of Richmond Avenue in Mt. Sterling, county seat of Montgomery County, Kentucky.

The William Chiles House enjoys a high degree of architectural integrity. The dwelling's setback from Richmond Avenue has been maintained as the approach along a narrow drive which ends in a tear-drop shape outside of the fenced domestic space. Mature pine trees frame the main dwelling. The major site intrusion is a modern (post-1940) garage built southeast of the dwelling.

MM-MS-161: Main Dwelling (contributing building)

The main dwelling built circa 1810 is a one and one-half story, four bay (w,w,d,w) double pile, hall-parlor brick residence on a stone foundation. Each side is flanked by a one-story, two-bay, gable-roofed pavilion with interior gable end chimney. The central entrance has a double-leaf door with a fan light. The central entrance is covered with a flat-roofed porch supported by pairs of fluted Ionic columns.

To the rear facade, several additions have been made which appear to be post-1940. A single, centrally-located, shed-roofed dormer has been added. A one-room, hip-roofed addition has been made to the pavilion on the north side and the gable roof extended on the rear facade of the south pavilion.

MM-MS-161A: Slave Quarters (contributing building)

The mid-nineteenth century slave quarters is located to the southwest of the main residence. It is a rectangular, one-story, two-bay (d,d) brick building with a gable roof. The gable roof has been extended on the north or main facade to form a porch pre-1940.

MM-MS-161 B: Rectangular Outbuilding (non-contributing building)

The rectangular outbuilding dating from the early twentieth century is located south of the slave quarters (MM-MS-161A) and the main residence. It is a one-story, rectangular building with a gable roof. The exterior fabric is wide aluminum siding.

United States Department of the Interior
National Park Service

National Register of Historic Places Continuation Sheet

Section number 7 Page 2

Chiles, William, House
Mt. Sterling, Ky. MRA

MM-MS-161 C: Modern Garage (non-contributing building)
South and east of the main residence is a one-story, gable-
roofed, post-1940, concrete block garage.

United States Department of the Interior
National Park ServiceNational Register of Historic Places
Continuation SheetSection number 8 Page 1Chiles, William, House
Mt. Sterling, Ky. MRA

The William Chiles House in Mt. Sterling, Kentucky is significant under criterion C for its architectural design and group of domestic outbuildings that exemplify early nineteenth century for the domestic complexes. The dwelling was constructed circa 1810 with a hall-parlor plan and federal detailing. The building's original exterior design and detailing has undergone minimal alteration and retains its original architectural character. The building's exterior design is the most notable example of the federal style in Mt. Sterling. The site has the greatest number of intact mid-nineteenth century domestic outbuildings of any property in town.

There are very few extant early nineteenth century hall-parlor plan buildings in Mt. Sterling. Those that do remain are located on sites which have been reduced in size through subsequent subdivisions.

One example of the hall-parlor dwelling is the Jailer's House which is on the National Register as part of the Commercial District. It is a two-story, four-bay, single pile brick building which has been recently restored by the Montgomery Landmark Association. Its outbuildings, however, are no longer extant.

Another example is the Patten-Everett House (MM-MS-74), which is listed on the National Register as part of the Northwest District. The main block of the house dates from the early nineteenth century, but the dwelling underwent extensive remodeling in the late nineteenth century and has the exterior appearance of a late nineteenth century Italianate house. The acreage associated with Patten-Everett House was subdivided in 1906 to create Everett Court and its outbuildings are no longer extant.

The Chiles House and its historic outbuilding provide information about the use of slaves by the merchant class of Mt. Sterling in the early and mid-nineteenth century. The Slave Quarters is located within fifteen feet of the main dwelling and is made of brick suggesting the permanence of the institution, a degree of intimacy with the family in the main dwelling, and the financial investment in the slaves it housed. The living space for the servants at the W.T. Fitzpatrick House (MM-MS-142) built in the late nineteenth century is located in the second story of the buggy house which is a wood building located approximately 50 feet from the main dwelling. The distance of the buggy house from the main dwelling and materials used in its construction suggest a more transient relationship between the family in the main house and the servants than is demonstrated at the William Chiles House.

United States Department of the Interior
National Park Service

**National Register of Historic Places
Continuation Sheet**

Section number 8 Page 2

Chiles, William, House
Mt. Sterling, Ky. MRA

William Chiles who determined the property's overall configuration after he bought the property in 1808 from McMillan. Chiles opened a general store in Mt. Sterling in 1805 and is noted as owning a number of slaves. Chiles sold the property to B.J. Peters in 1847. (DB 4/330 and DB 22/228).

Belvard January Peters who owned the property from 1847 until 1899 came to Mt. Sterling in 1834 after graduating from Transylvania University and reading law with Chief Justice John Boyle. Peters served as county attorney and then as state legislator. He was elected to the Court of Appeals where he sat from 1860 to 1878, serving as Chief Justice from 1876 to 1878. He returned to the practice of law in Mt. Sterling, dying in 1899.

The administrators of Peters' estate sold the property to Strother and Lula Mitchell in 1899 (DB 58/113).

United States Department of the Interior
National Park Service

National Register of Historic Places
Continuation Sheet

Section number 10 Page 1

Chiles, William, House
Mt. Sterling, Ky. MRA

Acreage in property: 3.95 acres

UTM Reference

<u>Zone</u>	<u>Easting</u>	<u>Northing</u>
16	241140	4215520

Verbal Boundary Description

Starting at the point at which the centerline of the driveway intersects the west (on map) right of way of Richmond Avenue; then southwest 140 feet to point A; then west 630 feet to point B; then north 250 feet to point C; then east 670 feet to point D; then 140 feet west south to the point of beginning. The boundary contains approximately 3.95 acres.

Boundary Justification

The boundary has been drawn to include all of the significant domestic architectural historic resources associated with the architecture of the era. The boundary excludes area which do not contribute to our understanding of the architecture during the period of significance.

The nominated area excludes modern residential development to the north and east, and farmland to west and south.

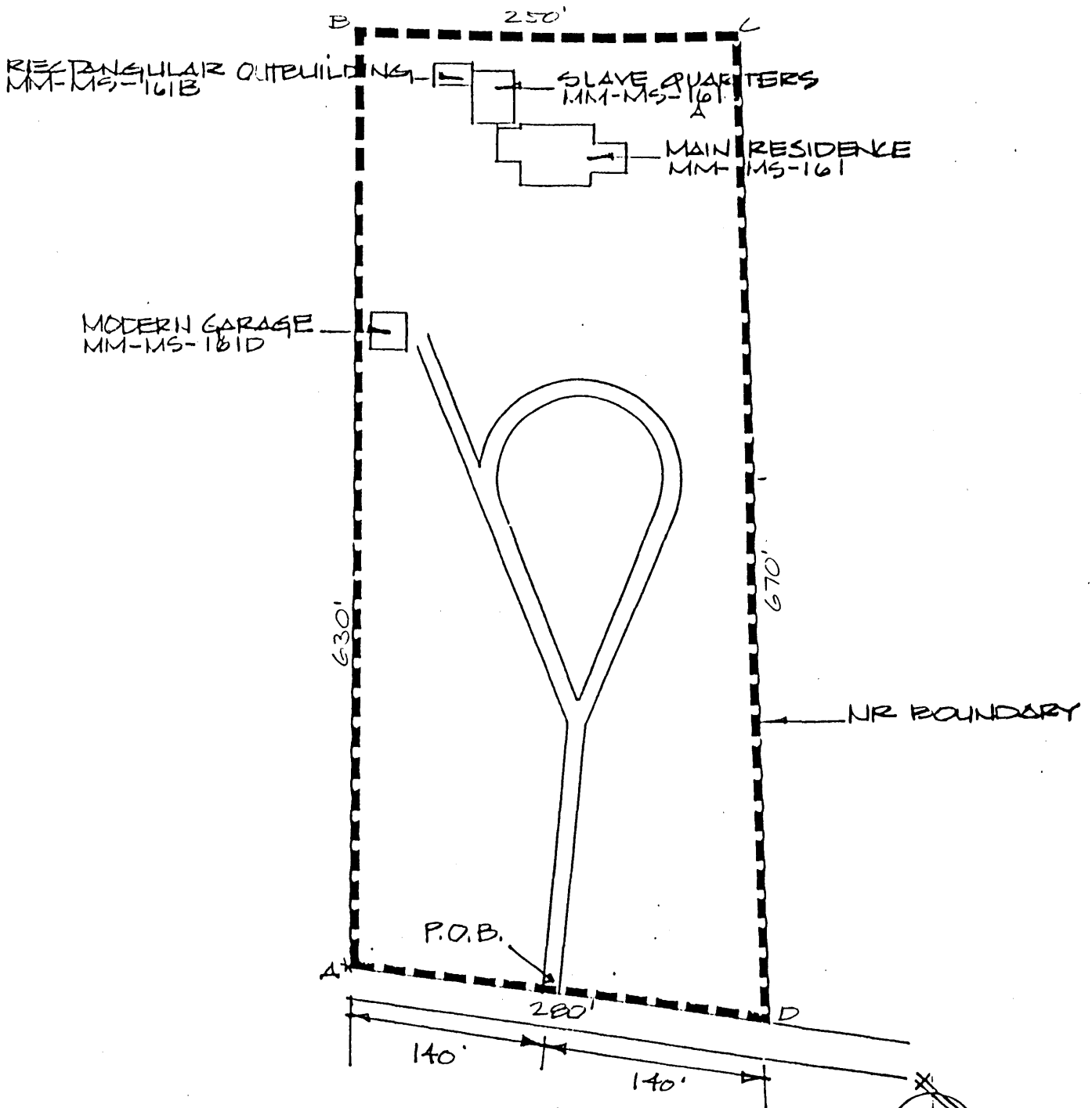

SITE PLAN:
WILLIAM CHILES HOUSE
MM-MS-161

1" = 100'-0"

**United States Department of the Interior
National Park Service**

**National Register of Historic Places
Continuation Sheet**

Section number PHOTOS Page 1 Chiles, William, House
Mt. Sterling, Ky., MRA

For All Photos:

Property Location: East side of Richmond Road
Mount Sterling, Montgomery County, Kentucky
Photographer: Helen Powell
Negative Location: Kentucky Heritage Council
Frankfort, Kentucky
Date Taken: 1990

Photo No.

- | | |
|---|---|
| 1 | Residence, main facade, view to west |
| 2 | Contributing outbuildings behind residence, view to north |
| 3 | Non-contributing garage, view to southwest |