

KENTUCKY HISTORIC RESOURCES INVENTORY

Site No. JF-541

1. Historic Name(s) <b>Horner House</b> Original Owner <b>Charles Horner</b>		22. ADD/County <b>Jefferson/Jefferson</b> <input type="text" value="0"/> <input type="text" value="5"/> <input type="text" value="6"/>	
2. Present Name <b>N/A</b>		23. U.S.G.S. Quadrant (15'/75') <b>Jeffersonville, Ind.</b> <input type="text" value="08"/> <input type="text" value="6"/>	
3. Location <b>3509 Woodside Rd. Louisville, Kentucky</b>		24. UTM Reference <input type="text" value="16"/> <input type="text" value="6,17,94,0"/> <input type="text" value="42,39,9,80"/>	
4. Owner's Name <b>Dr. &amp; Mrs. W. Sterrett Foster</b>		25. Coordinate Accuracy <input type="checkbox"/>	
5. Owner's Address <b>3509 Woodside Rd. Louisville, Kentucky 40222</b>		26. Prehistoric Site <input type="checkbox"/> Object Historic Site <input type="checkbox"/> Structure Building <input checked="" type="checkbox"/> Other <input type="checkbox"/>	
6. Open to Public Yes <input type="checkbox"/> No <input checked="" type="checkbox"/>	7. Visible from road Yes <input type="checkbox"/> No <input checked="" type="checkbox"/>	8. Ownership Private <input checked="" type="checkbox"/> Local <input type="checkbox"/> State <input type="checkbox"/> Federal <input type="checkbox"/>	
9. Local Contact/Organization <b>Jeff. Co. Office of Historic Preservation and Archives</b>		27. National Register District Name: <input type="text"/>	
10. Site Plan with North Arrow 		28. Significance Evaluation <b>meets Nat. Reg. Criteria</b> <input type="checkbox"/> <input checked="" type="checkbox"/>	
Bl.11 Lot 142		29. Status <input type="checkbox"/> Date National Landmark <input type="checkbox"/> National Register <input type="checkbox"/> Landmark Certificate <input type="checkbox"/> Kentucky Survey <input checked="" type="checkbox"/> <b>1977</b> Local Landmark <input type="checkbox"/> HABS/HAER <input type="checkbox"/>	
11. Architect <b>Unknown</b>		30. Historic Theme Primary <b>architecture</b> <input type="text" value="0"/> <input type="text" value="3"/> Secondary <input type="checkbox"/> Other <input type="checkbox"/>	
12. Builder <b>Ale Bornstein</b>		31. Endangered Yes <input type="checkbox"/> No <input checked="" type="checkbox"/>	
13. Date <b>C. 1900</b> 1928 A. <input type="text" value="5"/> B. <input type="text" value="7"/>		32. Preservation Project Status <input type="checkbox"/>	
14. Style A. Vernacular <input type="text" value="22"/> B. Jacobethan Rev. <input type="text" value="23"/>		Actual Cost in \$1,000s <input type="text"/>	
15. Original Use <b>Sing. Fam. Res.</b> <input type="text" value="1"/>		33. ATTACH PHOTO <input type="checkbox"/>	
16. Present use <b>Sing. Fam. Res.</b>		34. Prepared by: <b>Mary Jean Kinsman Researcher</b>	
17. Condition <b>Excellent</b> <input type="text" value="1"/>		35. Organization <b>Jeff. Co. Office of Historic Preservation &amp; Archives</b>	
18. Description <b>see next page</b>		36. Date <b>1977</b>	
No. Stories <b>Two</b> <input type="text" value="C"/> Single Pile <input type="checkbox"/> NA <input checked="" type="checkbox"/> Double Pile <input type="checkbox"/> Floor Plan <b>asymmetrical</b> <input type="text" value="M"/> Structural Fabric <b>frame&amp;brick</b> <input type="text" value="D"/> B. <input type="text" value="C"/> Decorative Fabric <b>Common bond brick</b> A. <input type="text" value="E"/> B. <input type="text"/> Roof Form <b>Multi-gable</b>		37. Revision Dates <b>1983</b>	
19. History <b>see next page</b>		38. Staff Review	
20. Significance <b>see next page</b>		21. Source of Information <b>see next page</b>	

## 18. Description

Two-story frame and brick structure with irregular massing, multi-planed roof, and large brick chimneys. The brick wing has a one-story porch with square piers and a sloping roof slightly curved at the eave. The porch is surrounded by a stone retaining wall. The first story of the brick wing is a large, paneled library with tall, triple windows.

## 19.

### History

In 1923 Charles Horner, president of the Kosmos-Portland Cement Company, bought a tract of land in the Woodside subdivision of Clarence Bate's estate. The site contained a frame house, probably dating from about 1900, which had been owned by Bate's daughter. This is the frame section of the present house. In 1928 the Horners built the two-story brick wing. The first story of this wing is a large library. The Horners had purchased a pre-Georgian paneled room in England and the brick addition was designed to accommodate this interior. The pickled pine paneling was installed under the direction of Joseph Bittner, head of the cabinetmaking department of the Louisville firm of Bittner Brothers.

## 20. Significance

The Horner House is significant as an example of two styles of country house architecture from two building periods. The original frame house (c. 1900) was a vernacular structure, vaguely Colonial Revival, similar to several other structures in the area built as summer homes. (see JF 542, JF 543) The brick wing, added in 1928, exemplifies the influence of English revival styles in the architecture of a number of country houses built in this area from 1900-1930. (See JF 542, JF 556, JF 557 National Register 1980, and JF 547, Glenview Historic District.)

## 21. Source of Information

Jefferson County, Ky. Deed Books

Information from Mrs. Charles Horner, Louisville, Kentucky.

KENTUCKY HISTORIC RESOURCE INVENTORY SUPPLEMENT  
BOUNDARY AND LOCATION INFORMATION

Historic Property Name Horner House Site # JF-541

Multiple Resource/Thematic Nomination Title Jefferson County, Ky MRA

U.T.M. Coordinates - List multiple UTMs if property is ten or more acres.

A. 16 617940 4239980 D. \_\_\_\_\_

B. \_\_\_\_\_ E. \_\_\_\_\_

C. \_\_\_\_\_ F. \_\_\_\_\_

Verbal Boundary Description Acreage 7.6

The nominated property comprises all of Lot 142 in County Block 11 of the Jefferson County Property Valuation Administrator: approximately 7.6 acres.

Sketch of Site Plan (Showing outbuildings, structures, landscape features and the site boundary as described above.)

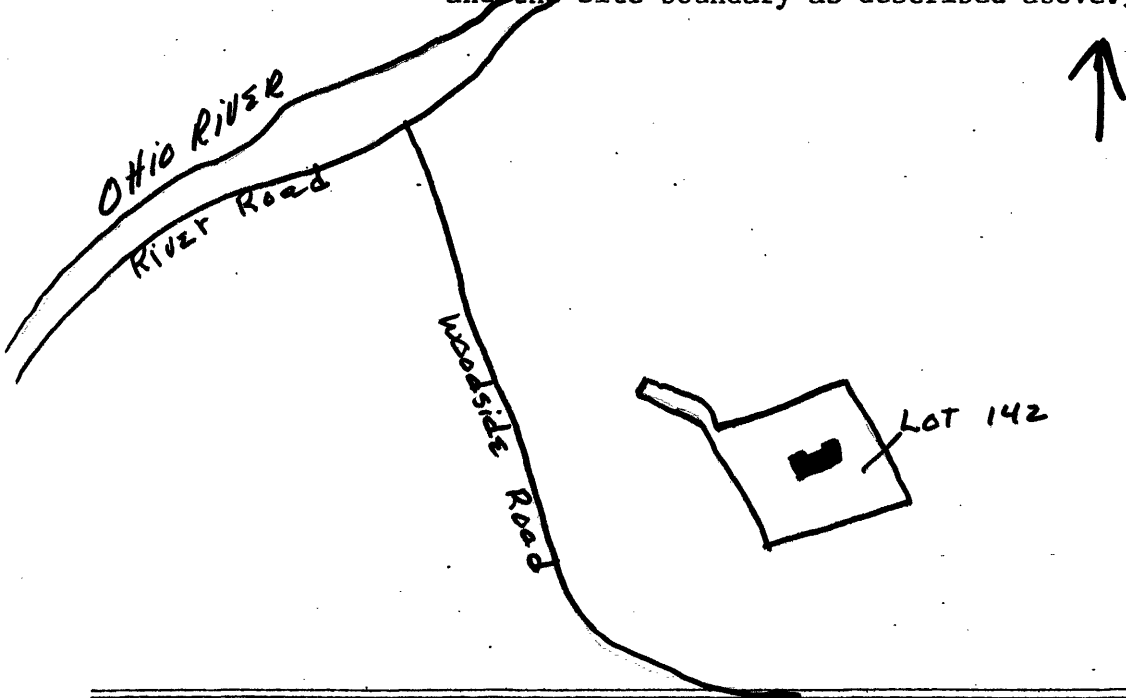

Official Courthouse Property Reference:

Description as recorded in Deed Book 5209 page 685, January 1981.